

Old Town Sidewalk Improvement Program

City of Fairfax
February 2017

Sidewalk Segments Evaluated

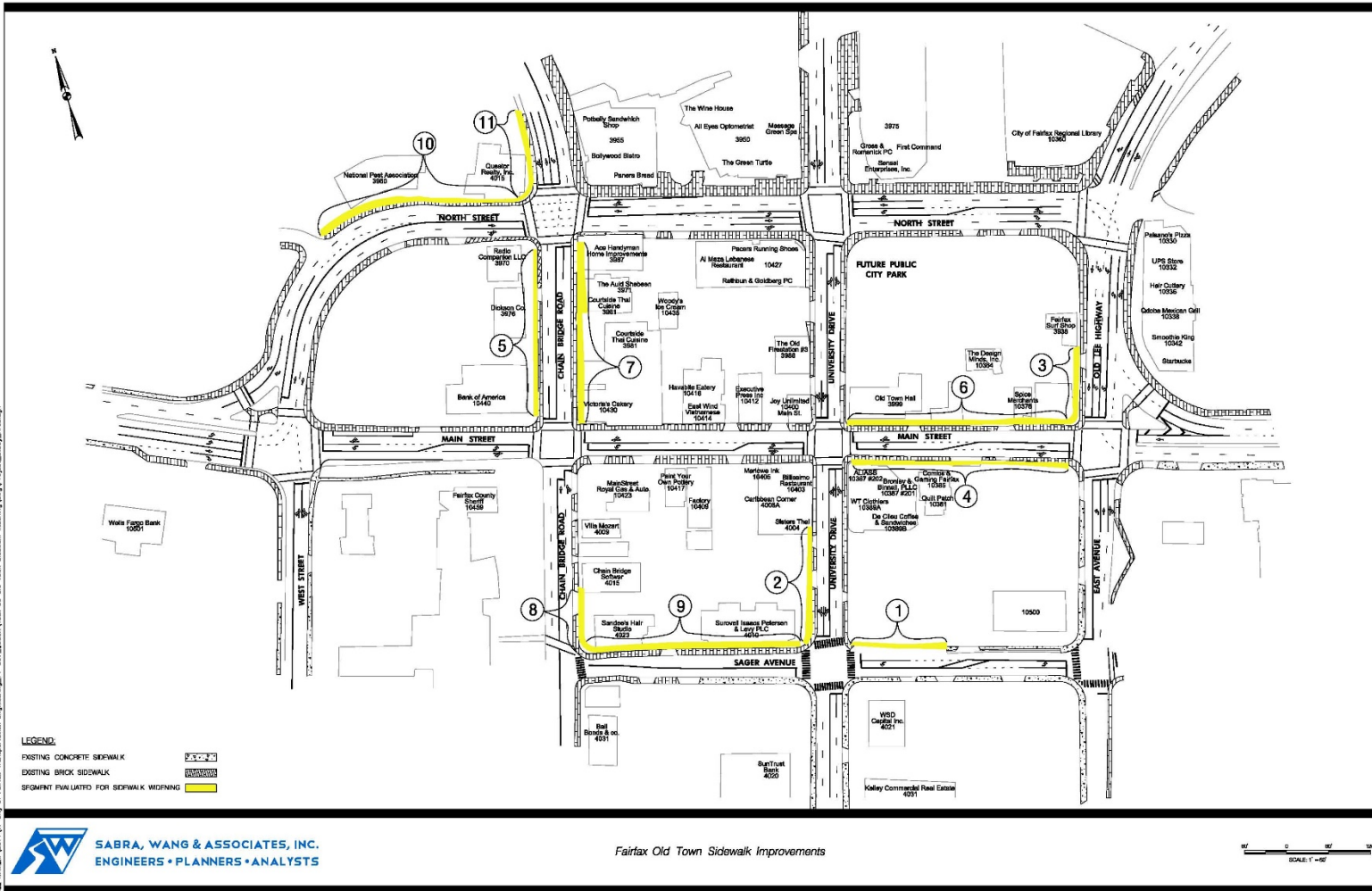

DATE: 11/15/17
 PROJECT: Sabra, Wang & Associates, Inc. 11/15/17
 CLIENT: City of Fairfax, Transportation Engineering, 11/15/17
 PROJECT: Sabra, Wang & Associates, Inc. 11/15/17

Project History & Scope of Work



- Initial field evaluation and discussion with Council regarding improved sidewalk network in late 2015.
- 11 block faces initially identified for potential improvement.
- 7 priority segments advanced into preliminary engineering investigation and constructability review.
- Investigation focused on right-of-way needs, utility impacts, landscaping and overall complexity.

Sager Avenue – Segment 1

north side, east of University Dr.



- Length/ Width : 145' / 6' new sidewalk
- Utility Impacts: Street light poles
- Vegetation Impact: none
- Right-of-way: Construct within existing right of way/ 1 parcel
- Estimated Cost: \$80,000

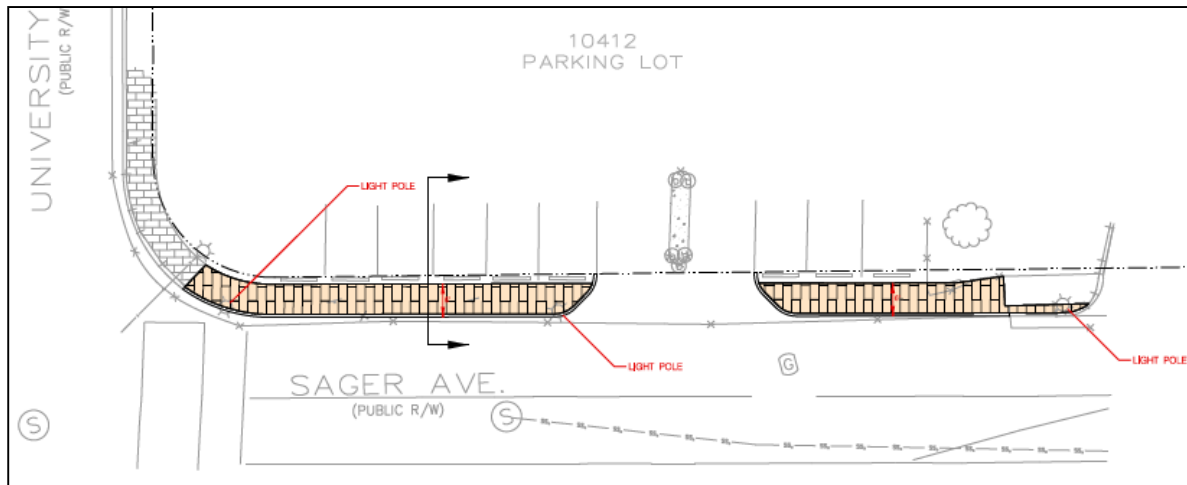

Old Lee Highway – Segment 3

west curb north of Main Street



- Length/ Width: 85' / Widens sidewalk from 5.5' to 10'
- Utility Impacts: street light pole, pedestrian signal pole
- Vegetation Impacts: existing landscaping /shrubs would be removed
- Right-of-Way: 2' required (400 SF) / 1 parcel (10364 Main Street)
- Potential 1' high retaining wall required
- Estimated Cost: \$80,000

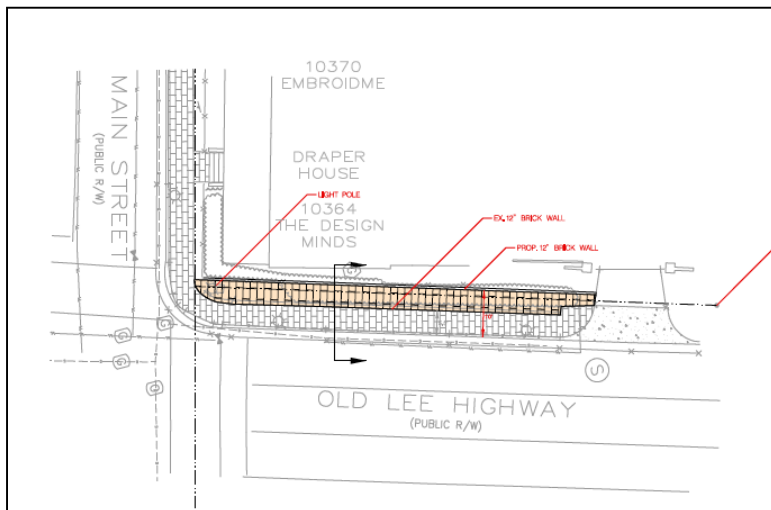

Chain Bridge Road – Segment 7

east side between North St. and Main St.



- Length/ Width: 135' / Widens from 5' to 10'
- Utility Impacts: traffic signal pole, electrical and communication vaults
- Vegetation Impacts: shrub landscaping
- Right-of-Way Impact: 5' required (675 SF) / 3 parcels (10430 Main Street, 3981, 3977 Chain Bridge)
- Estimated Cost: \$90,000

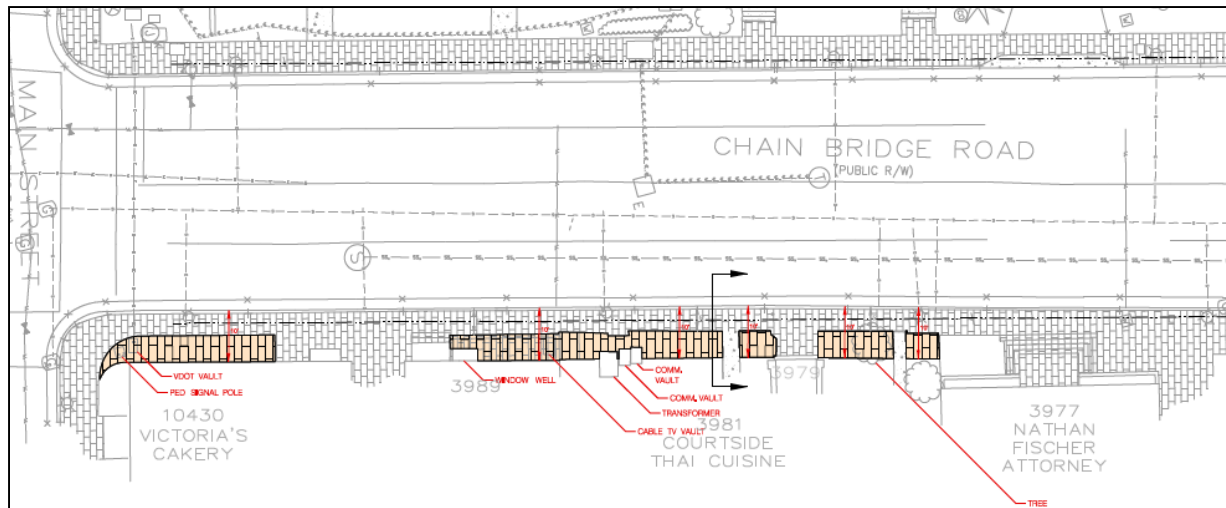

Main Street – Segment 6

north side between University Dr. & Old Lee Hwy



- Length/ Width: 340' / widen from 6' to 8'
- Utility Impacts: fire hydrant, traffic signal, street light, electric vault and water valve
- Vegetation Impacts: tree roots and shrubs
- Right-of-way Impacts: 2' required (680 SF) / 5 parcels (10364, 10370, 10376, 10382 Main Street and 3999 University Drive) one is Old Town Hall
- Estimated Cost: \$110,000

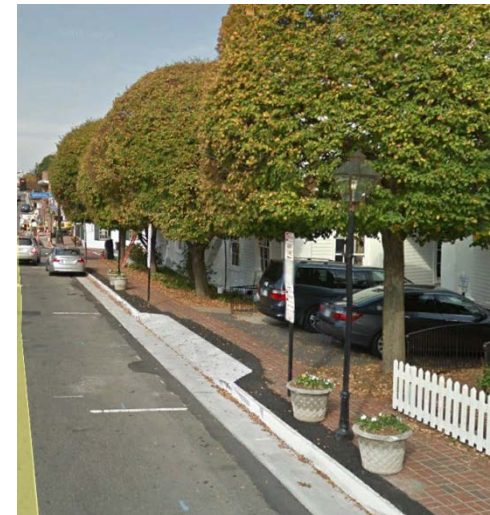
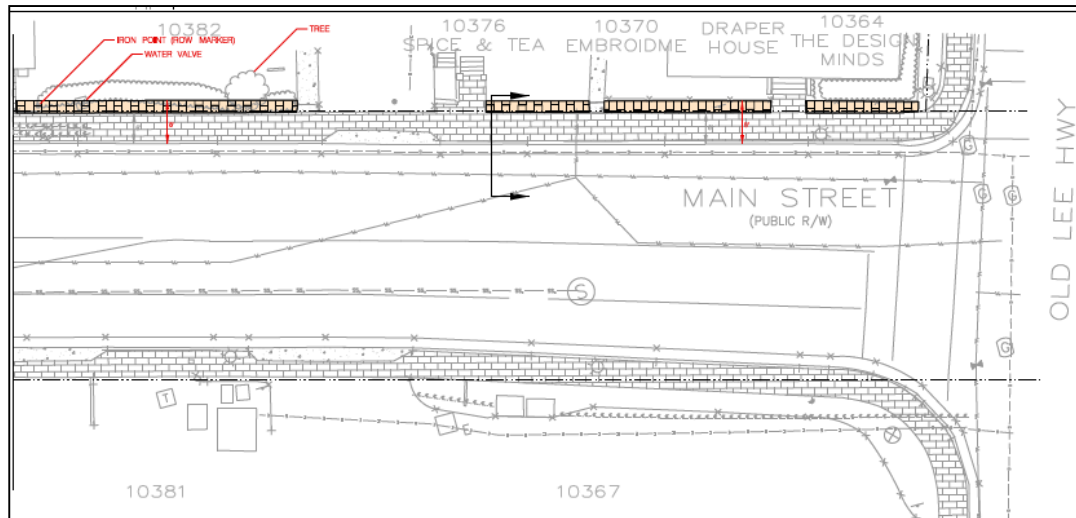

University Drive – Segment 8

west curb, north of Sager Avenue



- Length/ Width: 155' / widen from 6' to 10' or 12'
- Utility Impact: Electric overhead and underground, water, traffic signal poles
- Vegetation Impacts: shrubs
- Right of Way: 2' or 4' required (930 SF)/ 1 parcel (4010 University Drive)
- Estimated Cost: \$130,000

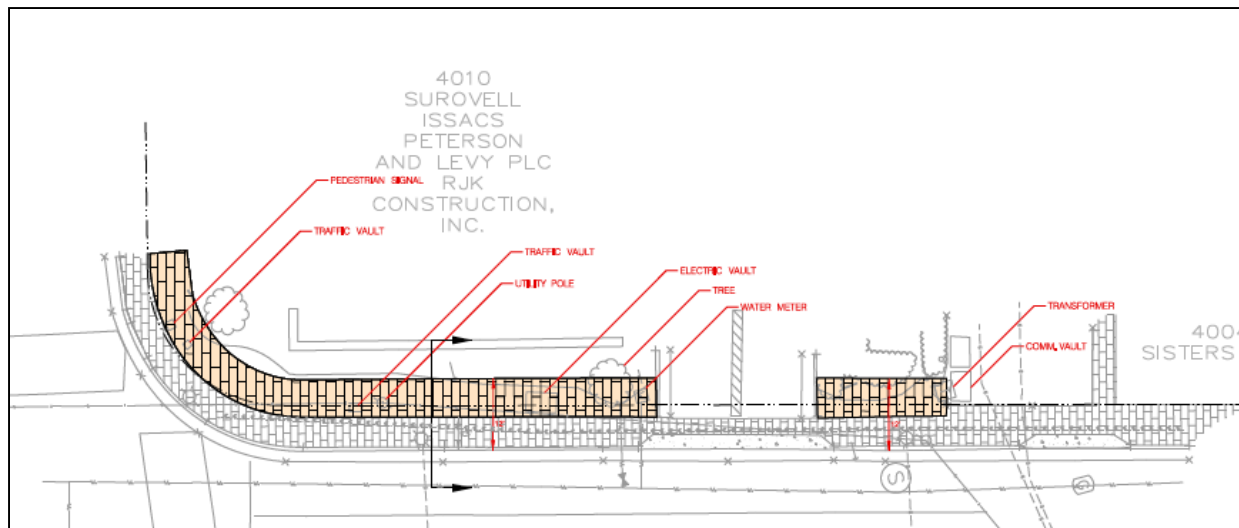

Chain Bridge Road – Segment 5

west side between North St. and Main St.



- Length/ Width: 235' / Widens from 6.5' to 9'
- Utility Impacts: traffic signal vault/cabinet, water valves
- Vegetation Impacts: shrub landscaping
- Right-of-Way Impact: 5' required (675 SF)/ 3 parcels (10440 Main Street, 3976, 3970 Chain Bridge)
- Potential 2' high retaining wall required
- Estimated Cost: \$100,000

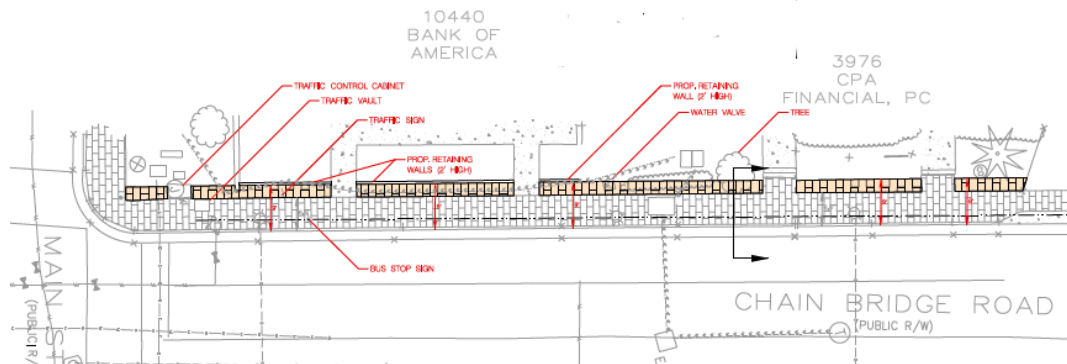

Main Street – Segment 4

south side between University Dr. & Old Lee Hwy



- Length/ Width: 245' / widens from 5.5' to up to 12'
- Utility Impacts: communication/ electrical vaults, water valve
- Vegetation Impacts: none
- Right-of-Way: up to 6' required (2,450 SF) / 4 parcels (10387, 10385, 10381, 10367) one is Town owned parking lot
- Estimated Cost: \$160,000

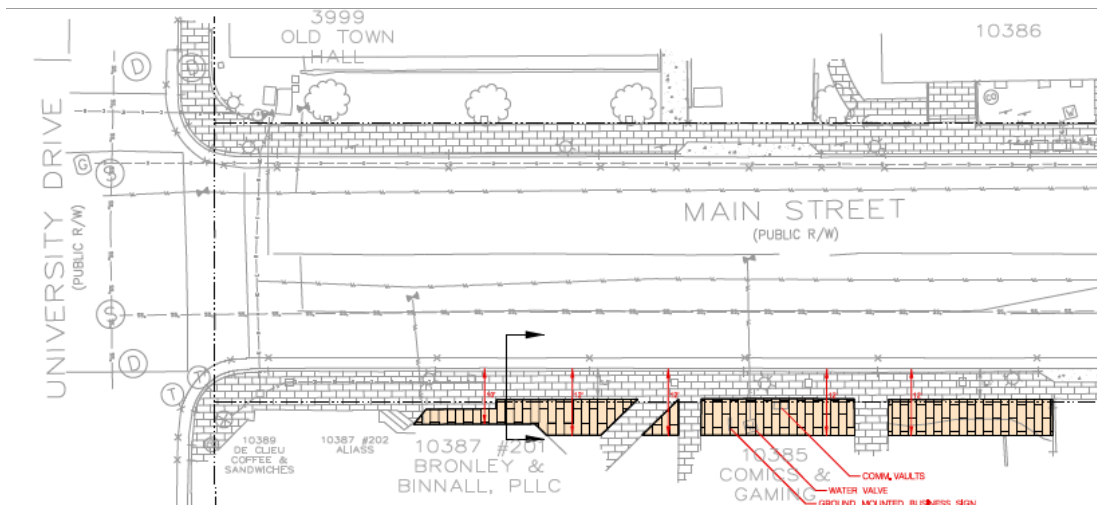

Right of Way

4

Summary of Segments

	Location	Segment #	Linear Feet	Original Width/ New Width (feet)	ROW needed	Estimated Cost
1	Sager Ave, north side east of University Drive	1	145	0 / 6	no	\$ 80,000
2	Old Lee Highway west side, north of Main Street	3	85	5.5 / 10	yes, 2 feet from 1 parcel	\$ 80,000
3	Chain Bridge Road, east side between North and Main	7	135	5 / 10	yes, 5 feet from 3 parcels	\$ 90,000
4	Main Street, north side btwn University Dr and Old Lee Hwy	6	340	6 / 8	yes, 2 feet from 5 parcels	\$ 110,000
5	University Drive, west side north of Sager Ave	8	155	6 / 12	yes, 4 feet from 1 parcel	\$ 130,000
6	Chain Bridge Road, west side between North and Main	5	235	6.5 / 9	yes, 5 feet from 3 parcels	\$ 100,000
7	Main Street, south side btwn University Dr and Old Lee Hwy	4	245	5.5 / 12	yes, 6 feet from 4 parcels	\$ 160,000

Summary of Benefits & Impacts

- 1,330 Linear Feet / 6,550 SF of New Sidewalk
- Total Estimated Construction Cost: \$850,000
 - Includes contingency and inspection
- Total Estimated Right of Way Cost: \$160,000
- Total Estimated Project Cost: \$1,200,000
 - Includes additional engineering costs
- Other issues: Utility coordination, ADA compliance

Recommended Scenario

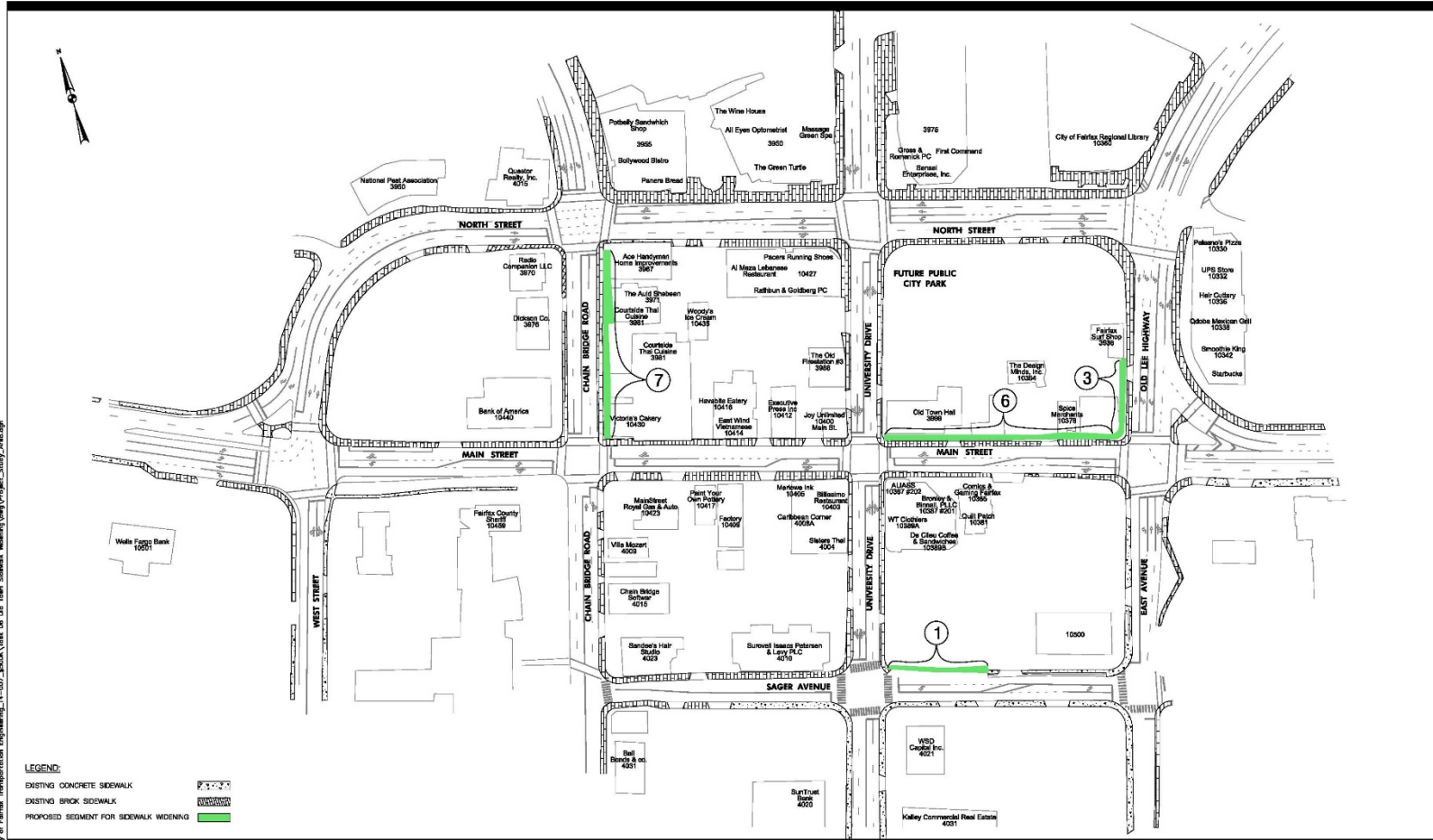

DRAWN BY: ... PLOTTED: Tuesday, February 14, 2017 AT 10:00 AM
 FILE NAME: V:\017-147-City of Fairfax Transportation Engineering_14-007_86202\Task 06 Old Town Sidewalk Widening\Map\Project_Sidewalk_Improvements.dwg

LEGEND:
 EXISTING CONCRETE SIDEWALK
 EXISTING BRICK SIDEWALK
 PROPOSED SEGMENT FOR SIDEWALK WIDENING

Recommended Scenario

	Location	Segment #	Linear Feet	Original Width/ New Width (feet)	ROW needed	Estimated Project Cost (CN + RW)
1	Sager Ave, north side east of University Drive	1	145	0/6	no	\$ 80,000
2	Old Lee Highway west side, north of Main Street	3	85	5.5/10	yes, 2 feet from 1 parcel	\$ 80,000
3	Chain Bridge Road, east side between North and Main	7	135	5/10	yes, 5 feet from 3 parcels	\$ 90,000
4	Main Street, north side btwn University Dr and Old Lee Hwy	6	340	6/8	yes, 2 feet from 5 parcels	\$ 110,000

Recommended Scenario

- Widen sidewalk in four locations
- 705 Linear Feet / 2600 Square Feet of New Sidewalk
- Total Estimated Construction Cost: \$360,000
- Total Estimated Right of Way Cost: \$ 52,000
- Total Estimated Project Cost: \$500,000 (includes CN, RW and additional engineering costs)
- Funding Available: \$500,000

Next Steps

- City Council concurrence on segments to advance
- City Council authorization to proceed with project
- City plans to use an on-call consultant for design and right of way acquisition



Questions?