



Old Lee Highway Multimodal Improvements

Stakeholder Advisory Committee Meeting #4

February 17, 2021

Tonight's Agenda

- Welcome and Review of Agenda
- Project Update
- Project Aesthetics
- Crosswalk Locations and Information
- Next Steps / Project Schedule

Old Lee Highway – Project Update

- Traffic Analysis is Ongoing
- Existing Conditions Model is Complete
 - Old Lee Highway congestion largely the result of interruptions at St. Leo's and Daniels Run.
 - Layton Hall/Farrcroft intersection is affected by interruptions at school entrances
- Alternatives Analysis Ongoing



Old Lee Highway – Recent Inquiries

- Update on coordination with Virginia Department of Historic Resources (VDHR)
 - Cultural Resources coordination is ongoing with VDHR, and additional field work is being planned in the upcoming months
- Concerns over traffic congestion at Farrcroft/Layton Hall intersection
 - The project does not propose any changes to the OLH/Farrcroft/Layton Hall intersection. This intersection is included in the ongoing traffic analysis, and preliminary traffic findings indicate that congestion at Farrcroft/Layton Hall are affected by congestion created at the school entrances to the north. The project team is evaluating alternatives to alleviate this congestion.

Old Lee Highway – Recent Inquiries

- Concerns Over the Consideration of Roundabouts for the Project
 - The ongoing traffic analysis is being performed to fully understand traffic along the Old Lee Highway corridor under the existing and proposed conditions. Part of the analysis includes evaluating the potential roundabouts and the effect they will have at the proposed location and on the corridor as a whole.
 - Testing the corridor with and without roundabouts, stoppages at the schools, etc.

Old Lee Highway – Recent Inquiries

- Roundabouts at Country Hill Drive and Ridge Avenue being considered with 90-100' radii.
- City staff, along with City Emergency Responders, visited other roundabouts in the region in December to evaluate the City's fire truck navigation.
 - Braddock Road/Pleasant Valley Drive (100' diameter) and Hunter Mill Road/Mystic Meadow Way (115' diameter)
 - Easier for the truck to navigate the 100' roundabout on Braddock Road
 - The lanes are wider even though the overall width is smaller.
 - Hunter Mill roundabout has narrower lanes with a larger concrete mountable apron in the center
 - Key takeaways:
 - Lane width and signage placement are key factors in navigability
 - Overall circumference less important

-
- Hunter Mill Video

Old Lee Highway – Project Aesthetics

- Street Trees & Landscaping
- Water Quality Facilities
- Retaining Wall Treatments
- Informational & Wayfinding Signage
- Lighting
- Historical Interpretation and Public Art
- Potential Project Features (Mobility, Safety, Furnishings)

Landscape Character



Proposed streetscape, initial conceptual rendering

Landscape Character

- Streetscape gateway

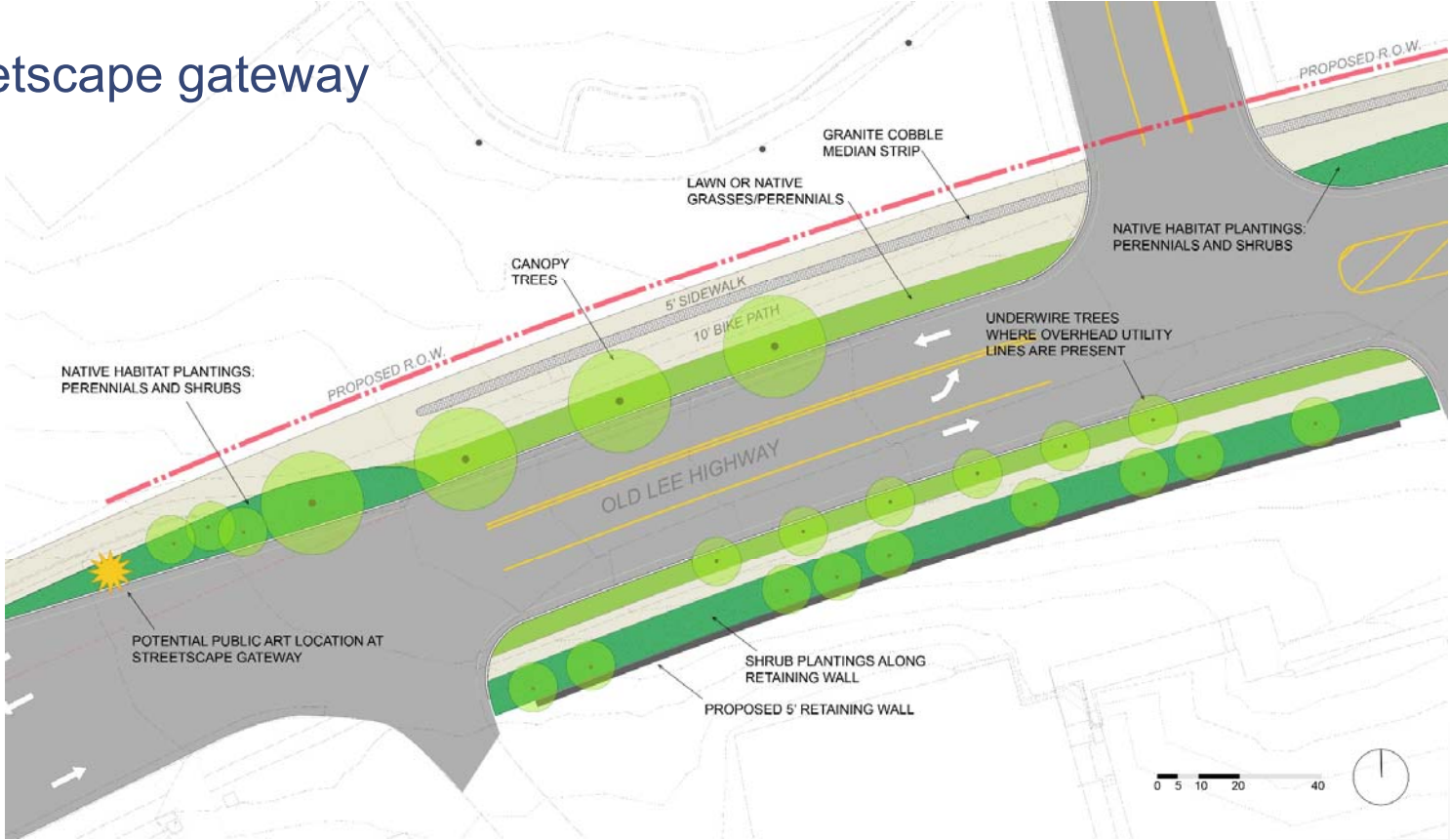

Corridor and shared use path gateway, just west of Layton Hall Drive

Landscape Character

- Bus stop and amenities hub

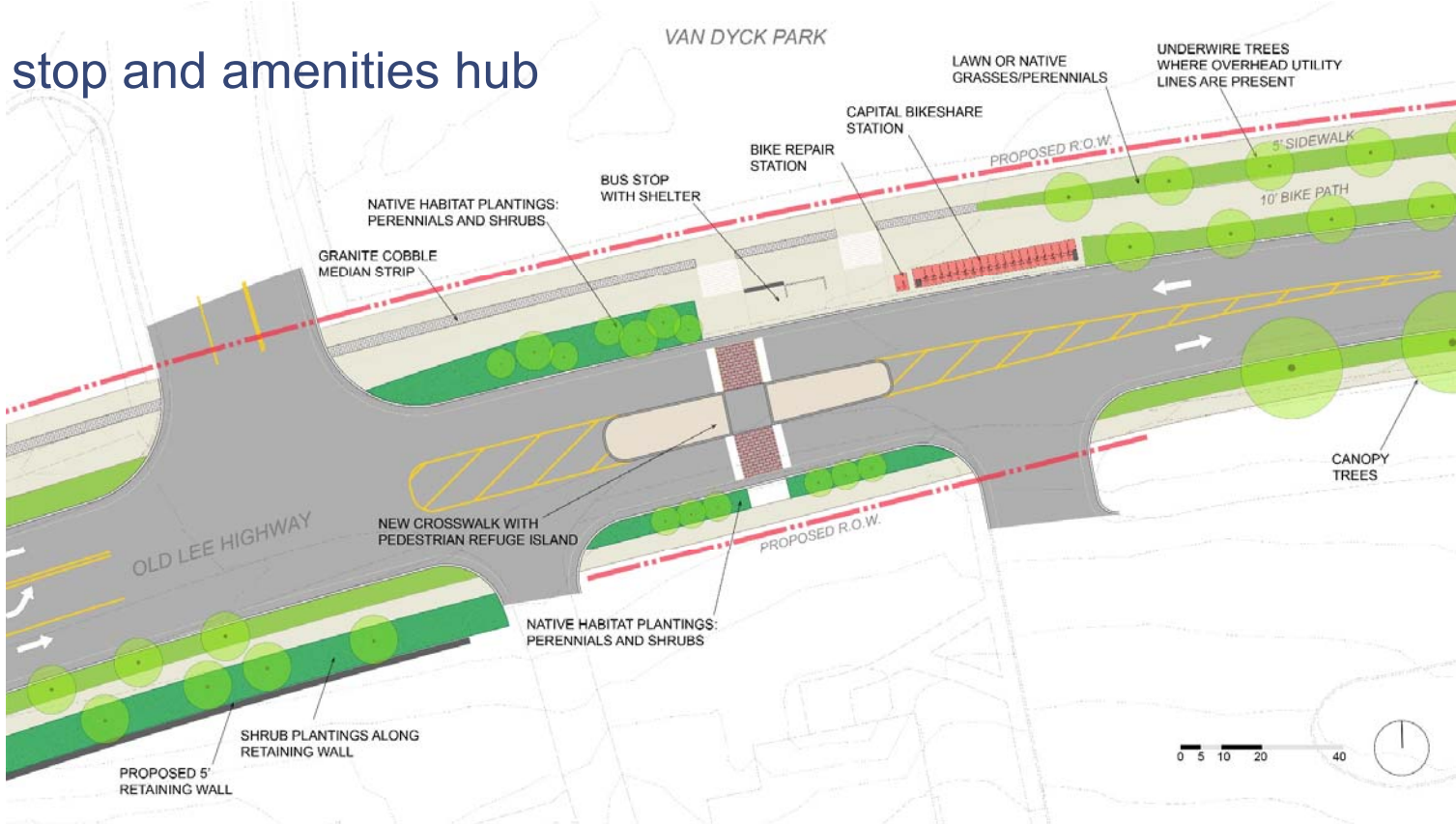

Old Lee Highway at Van Dyck Park

Landscape Character

- Areas of enhanced planting and green infrastructure

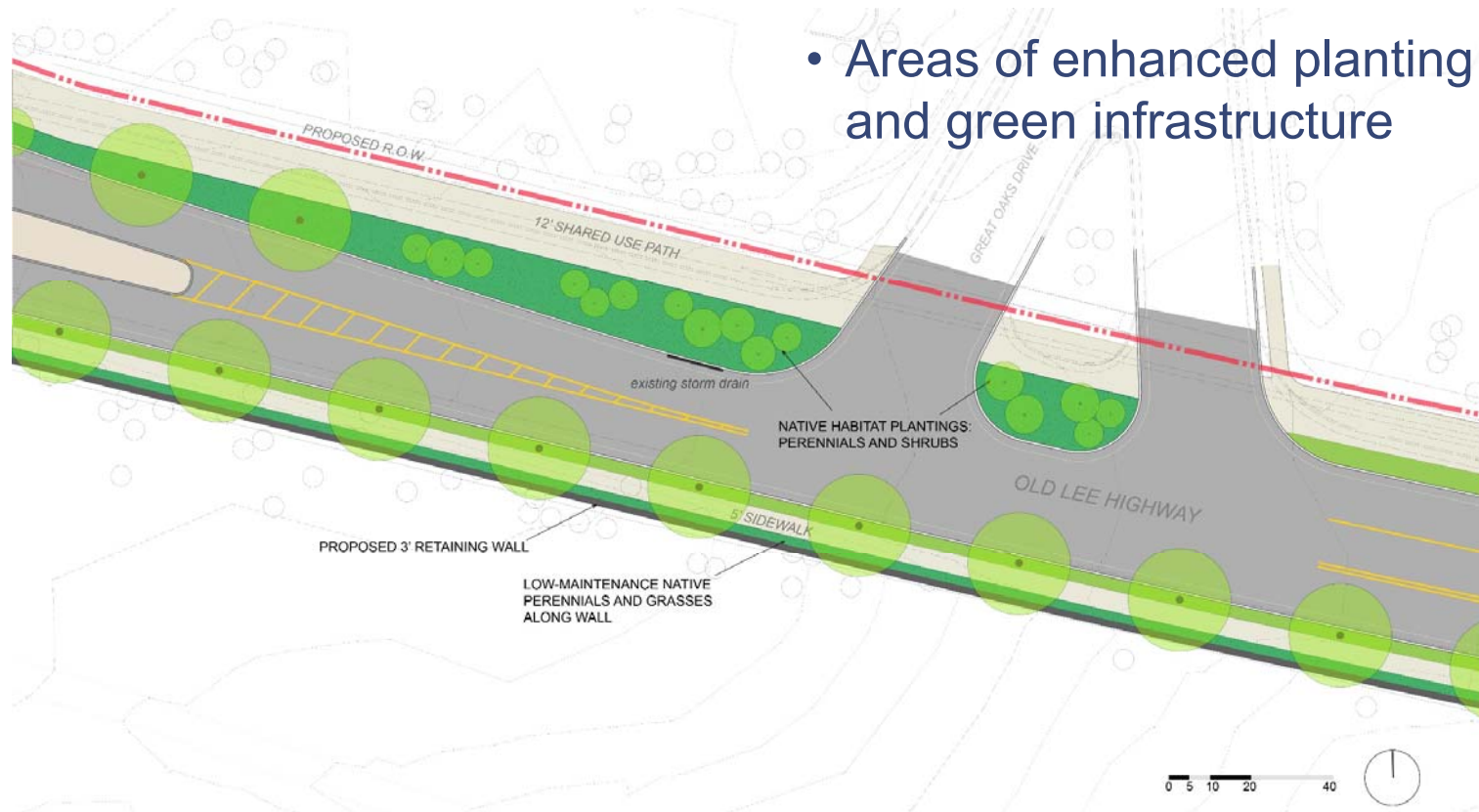

Old Lee Highway at Great Oaks Drive

Landscape: Canopy Trees



Pin Oak



Sweetgum



Tupelo



Willow Oak



Red Maple

Landscape: Underwire Trees



Eastern Redbud



Serviceberry



Hawthorn



**American
Hornbeam**



**Sweetbay
Magnolia**

Landscape: Native Shrubs



A range of native species for low maintenance plantings and green infrastructure

Landscape: Groundcover Plantings



Native perennials and grasses for habitat, green infrastructure, and seasonal interest

Landscape: Trail/Sidewalk Median



Strategies for dividing pedestrian and bike facilities

Water Quality Facilities



Street Tree Inlet Filters (Filterra's shown above)

Water Quality Facilities



Linear Bioretention Facilities

Retaining Wall Treatments



Existing retaining walls along Old Lee Highway may inspire look of new walls

Informational & Wayfinding Signage



Arlington, VA



Washington, DC



General Example

Lighting



Old Town Fairfax pedestrian lighting



Acorn light

Historical Interpretation and Public Art

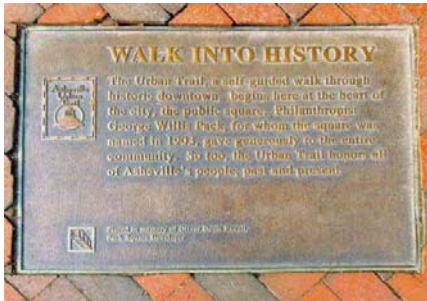

Informational plaques and sculptures tell the stories of downtown Asheville along the Asheville Urban Trail



A mix of signage and public art provides visitor information on Boston's Harborwalk



Signature gateway, Riverfront Heritage Trail, Kansas City MO



Temporary public art on the Anacostia Riverwalk

Potential Project Features: Mobility and Safety

- Bikeshare stations
- Blue light emergency phone
- Bicycle repair stations



Capital Bikeshare station in Arlington, VA



Blue light emergency phone on SIUE college campus



Bicycle repair station example

Potential Project Features: Furnishings

- Benches
- Planters



Historic overlay district benches approved for Old Town Fairfax



Self-watering Planter

Old Lee Highway Crosswalk Locations

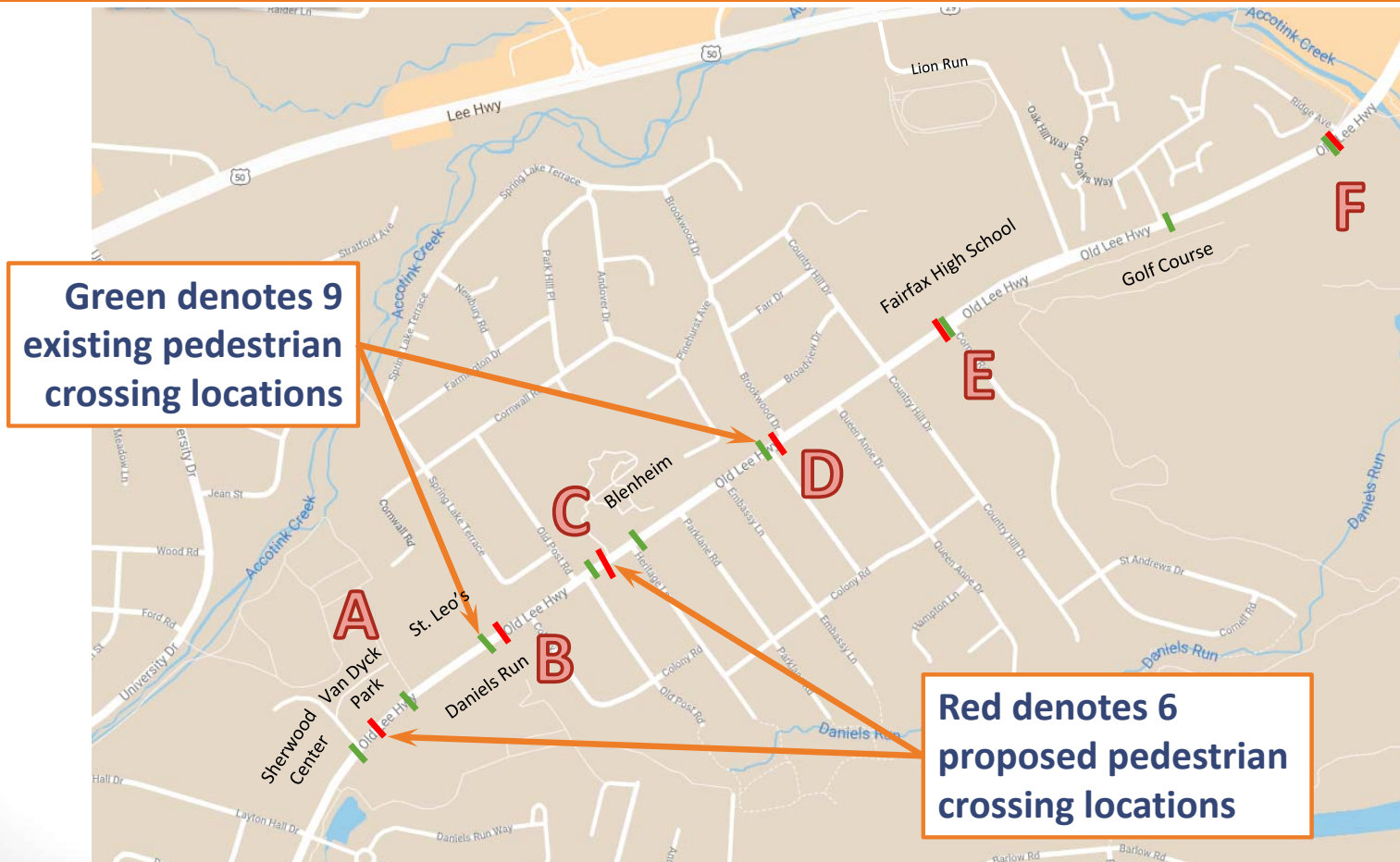

Old Lee Highway Crosswalk Information

- 9 existing pedestrian crossings
- 6 proposed pedestrian crossings
 - A - Van Dyck Park
 - B - St. Leo's/Daniels Run
 - C - Blenheim
 - D - Brookwood
 - E - Fairfax High School
 - F - Ridge Avenue
- Proposed crosswalk spacing
 - (A-B) 900' - Van Dyck to St. Leo's
 - (B-C) 1,000' - St. Leo's to Blenheim
 - (C-D) 1,000' - Blenheim to FHS
 - (D-E) 1,000' - Brookwood to FHS
 - (E-F) 2,500' - FHS to Ridge Avenue
- Enhanced crosswalk treatments to be provided

Next Steps & Project Schedule

- Complete Traffic Analysis – March 2021
- Update Plan Based on Traffic Analysis – April 2021
- City Council Work Session – Spring 2021
- Community-Wide Meeting – Summer 2021
- Public Hearing – Fall 2021
- Acquire Right of Way – January 2022-September 2022
- Relocate Utilities – Fall 2022 to Fall 2023
- Construct Project – Fall 2023 to Spring 2025