

FIRE LANE DESIGNATIONS

Under Section 509 of the City of Fairfax Fire Prevention Code, the Office of the Fire Marshal is authorized to designate fire lanes on public streets and on private property where necessary. This is to prevent parking in front of, or adjacent to, fire hydrants and to provide access for fire fighting equipment. Markings and signs are to be provided by the owner or agent of the property involved. Parking or otherwise obstructing such areas is prohibited.

I. HYDRANTS

- A. Parking is prohibited within 15' of a fire hydrant located along the curb line or edge of any public or private roadway. No special curb marking is required for enforcement.
- B. Fire hydrants installed in parking lots are to be located within a fire lane. Curb and/or roadway marking is required in accordance with Sections III and IV below.

SIGN TYPE "A"
NO PARKING OR STANDING FIRE LANE

Standard wording with an arrow at bottom pointing to the right. One sign mounted parallel to the line of curbing or pavement edge at end of painted area.

II. FIRE LANES

- A. Fire lanes must be installed where required by the office of the Fire Marshal. Fire lanes must be marked with both sign and curb delineation per Section III and IV below. Parking and fire lane markings are required as follows.

Street Width Curb to Curb or Paved Surface	Parking	Fire Lane Markings
Up to 28 feet	No parking allowed on either side	Both sides marked as fire lanes
28 feet up to 36 feet	Parallel parking allowed on one side as determined by the fire code official	One side marked as a fire lane
36 feet and over	Parallel parking allowed on both sides	No fire lane markings required Exception: Required access to pools, fire department apparatus access roads and similar areas must be marked as fire lanes

SIGN TYPE "C"
NO PARKING OR STANDING FIRE LANE

Standard wording with an arrow at bottom pointing to the left. One sign mounted parallel to the line of curbing or pavement edge at end of painted area.

SIGN TYPE "D"
NO PARKING OR STANDING FIRE LANE

Standard wording with no arrow. Two signs, back to back, mounted perpendicular to line or curbing or pavement edge.

III. SIGN SPECIFICATIONS

- A. Metal construction, 12" X 18".
- B. Red letters on reflective white background with 3/8" red trim strip around entire outer edge of sign.
- C. Lettering on sign to be: "NO PARKING OR STANDING FIRE LANE".
- D. Lettering size to be as follows: "NO PARKING" and "STANDING" is 2", "OR" is 1", "FIRE LANE" is 2 1/2" and the arrow with the solid shaft is 1" x 6" with the solid head 1 1/2" wide and 2" deep.
- E. Signs are to be mounted 7' from the ground to the bottom of the sign unless otherwise directed by the Office of the Fire Marshal.
- F. Post for signs, when required, must be metal and securely mounted, unless written permission for alternative is obtained prior to installation from the Office of the Fire Marshal. Signs should be spaced as shown on approved plans. In long stretches, the maximum distance between signs is 100'.
- G. Other special signs may be approved by the Office of the Fire Marshal.

IV. CURB DESIGNATION

- A. All curbs or paved spaces designated as fire lanes must be indicated by red paint as approved by the Office of the Fire Marshal. In areas without curbing, a 6" wide yellow stripe must be applied to the edge of the pavement. Paint must be highway traffic grade.
- Note: Fire lane markings, types of signs, locations, etc. are subject to approval by the Fire Marshal.

CPJ
Charles P. Johnson & Associates, Inc.
Civil and Environmental Engineers • Planners • Landscape Architects • Surveyors
9909 Pender Dr., Ste. 210 Fairfax, VA 22030 703-385-7555 Fax: 703-273-8995
www.cpjassoc.com • Charlottesville, VA • Charlottesville, VA • Greenbelt, MD • Frederick, MD • Fairfax, VA

FIRE PROTECTION PLAN
FAIRFAX
PRESBYTERIAN
CHURCH
CITY OF FAIRFAX, VIRGINIA

COMMONWEALTH OF VIRGINIA
BRIAN R. THOMAS
Lic. No. 038937
07/21/2022
PROFESSIONAL ENGINEER

DESIGN	DATE	SCALE	NO.
DRAWN	DATE	SCALE	NO.
CHECKED	DATE	SCALE	NO.
APPROVED	DATE	SCALE	NO.
SHEET 18 OF 51		PRJ NO: 2017-2570	
TYPE: MDP			

LEGEND

- PROPOSED RED PAINTED CURB/ EDGE OF PAVEMENT
- WATERMAIN
- ◆ FIRE HYDRANT
- ▼ FIRE DEPARTMENT CONNECTION
- ▲ PRIMARY BUILDING ACCESS POINT
- △ SECONDARY BLDG. ACCESS POINT

FIRE LANE SIGNS :

- ⊠ TYPE "A"
- ⊠ TYPE "C"
- ⊠ TYPE "D"

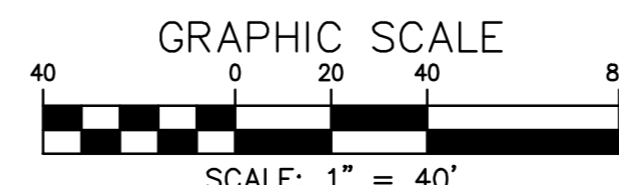

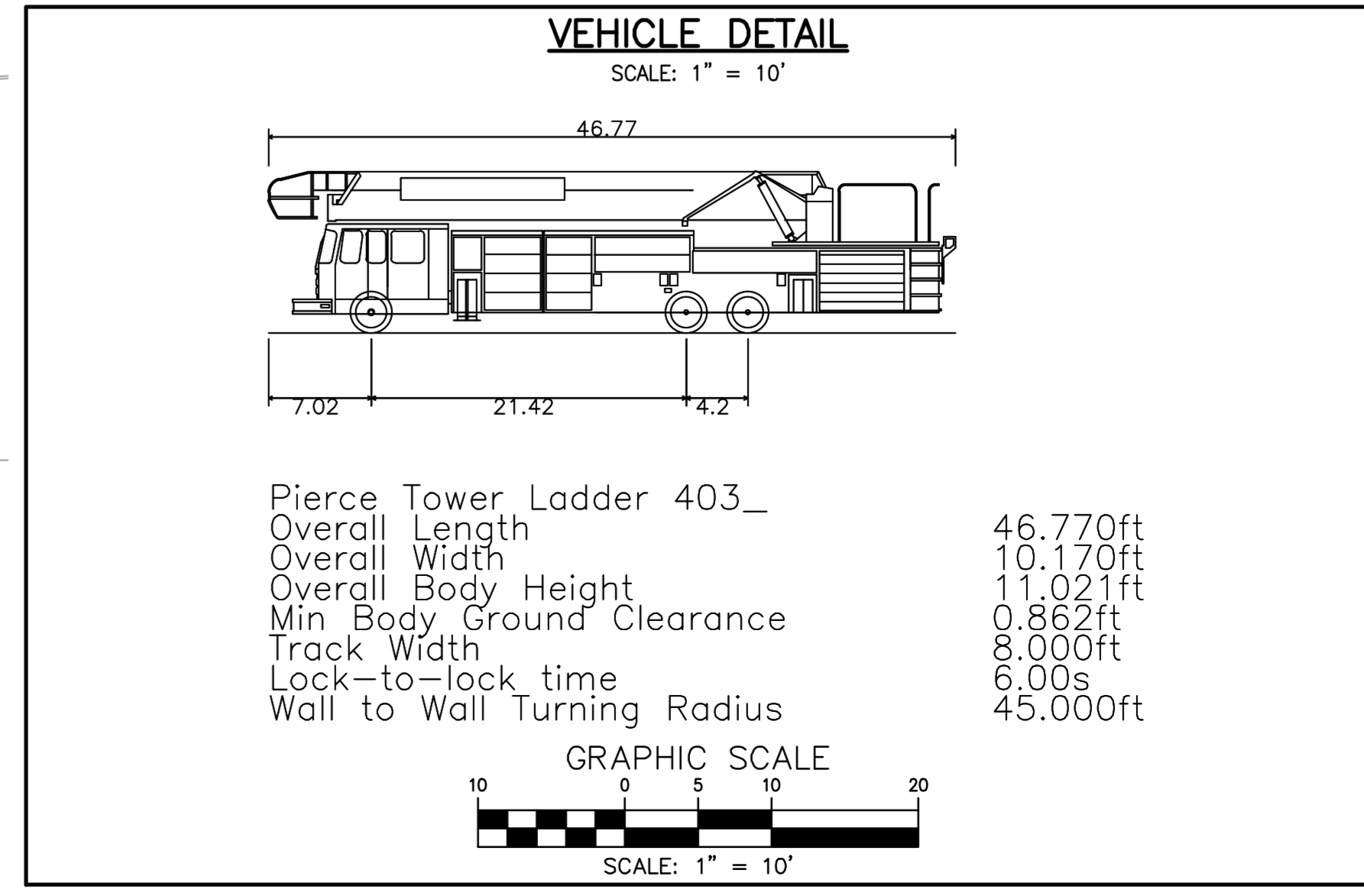
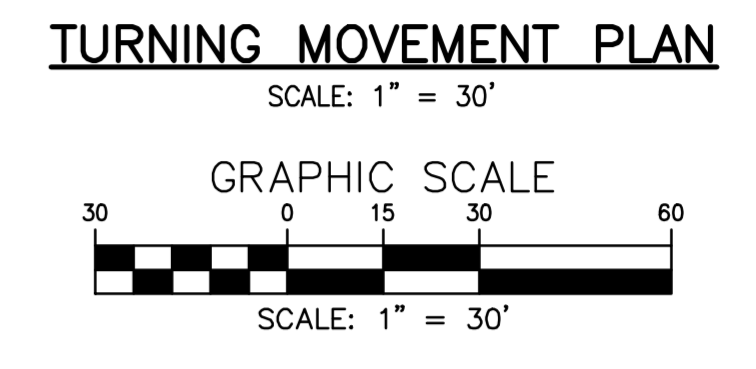
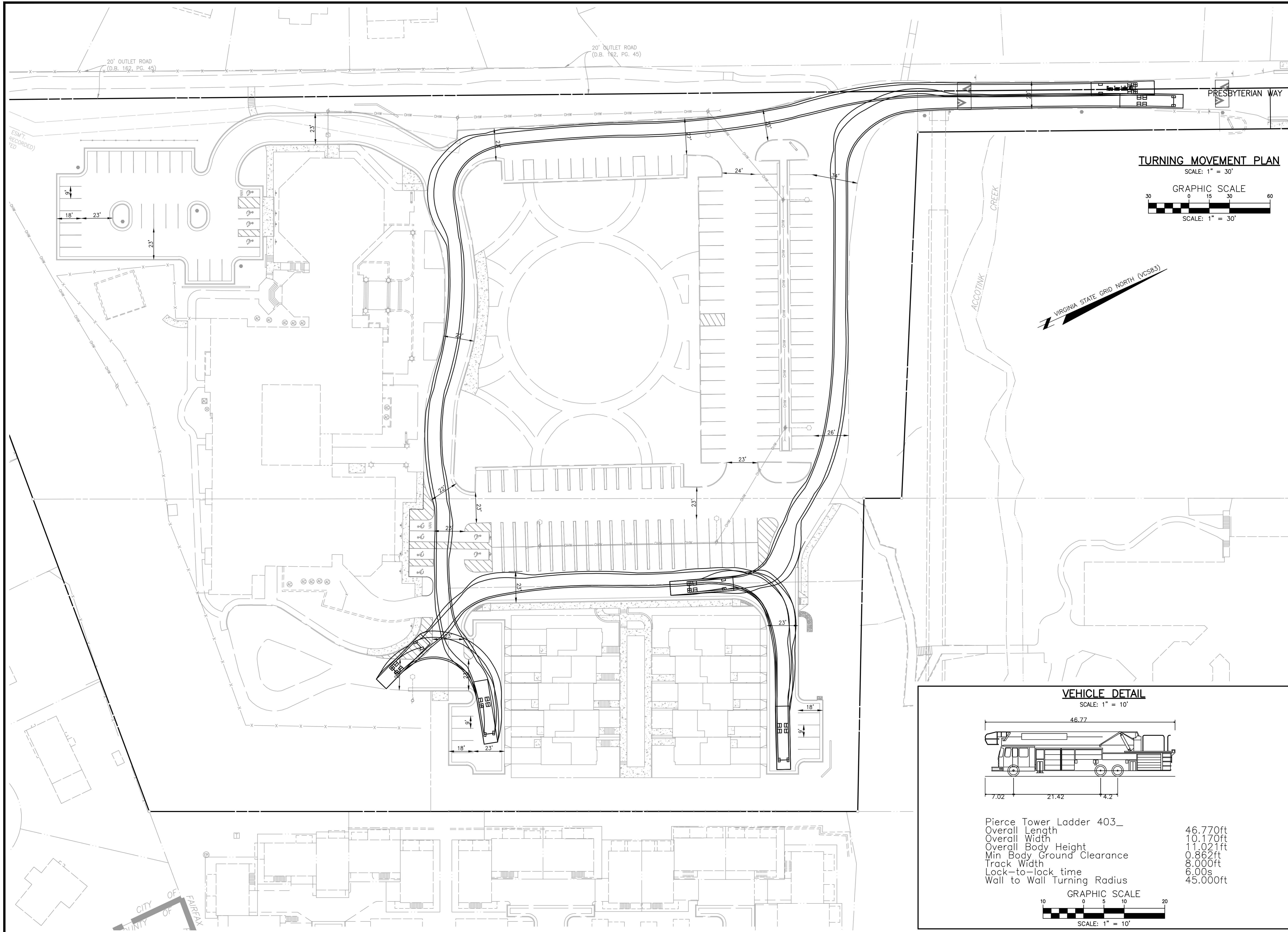

NO. DATE REVISION PRIOR TO APPROVAL

CPJ Charles P. Johnson & Associates, Inc.
Civil and Environmental Engineers • Planners • Landscape Architects • Surveyors
9999 Pender Dr., Ste. 210 Fairfax, VA 22030 703-385-7555 FAX: 703-273-8995
www.cpj.com • Chantilly, VA • Alexandria, VA • Greenbelt, MD • Frederick, MD • Fairfax, VA

TURNING MOVEMENTS: FIRE TRUCK

**FAIRFAX
PRESBYTERIAN
CHURCH**

CITY OF FAIRFAX, VIRGINIA

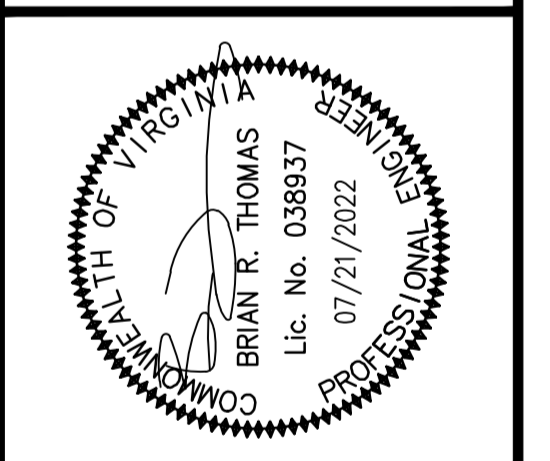

DESIGN	DRAFT	JURS	APPROVED	HMF	DATE	SCALE	AS	SHOWN	REVISIONS	REVISIONS	DATE	BY
					JUNE 2021							

SHEET 19 OF 51

PRJ NO: 2017-2570

TYPE: MDP

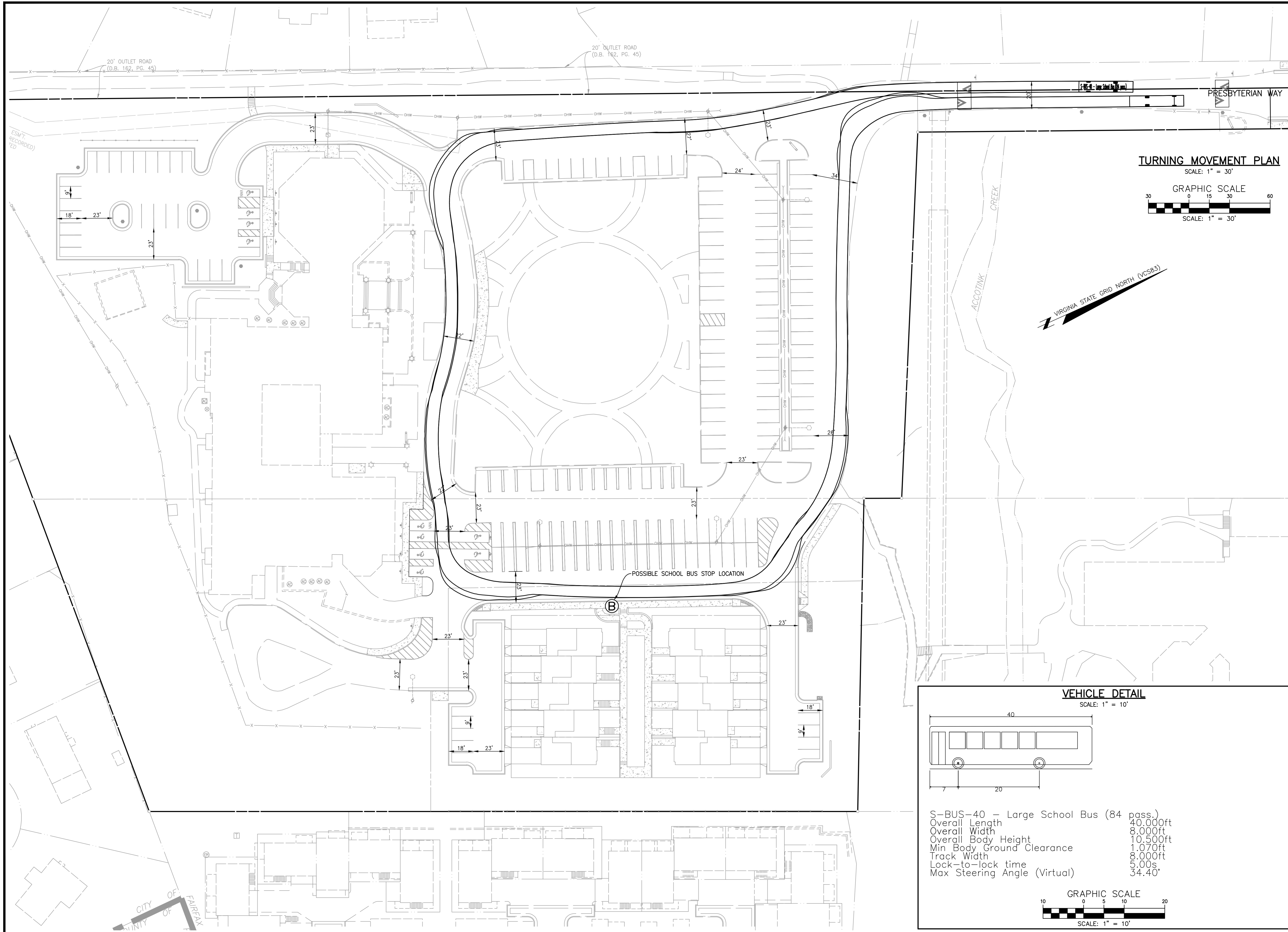

TURNING MOVEMENT PLAN
 SCALE: 1" = 30'
 GRAPHIC SCALE
 SCALE: 1" = 30'

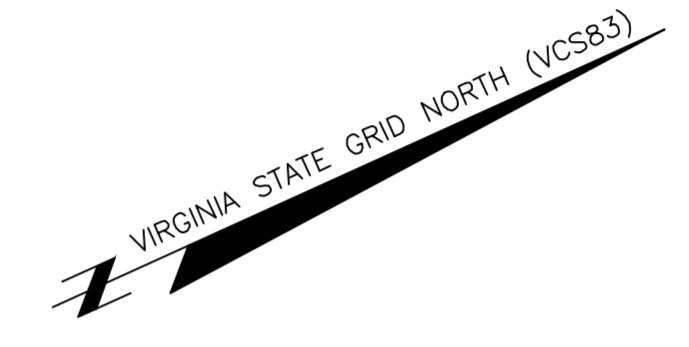

VEHICLE DETAIL
 SCALE: 1" = 10'

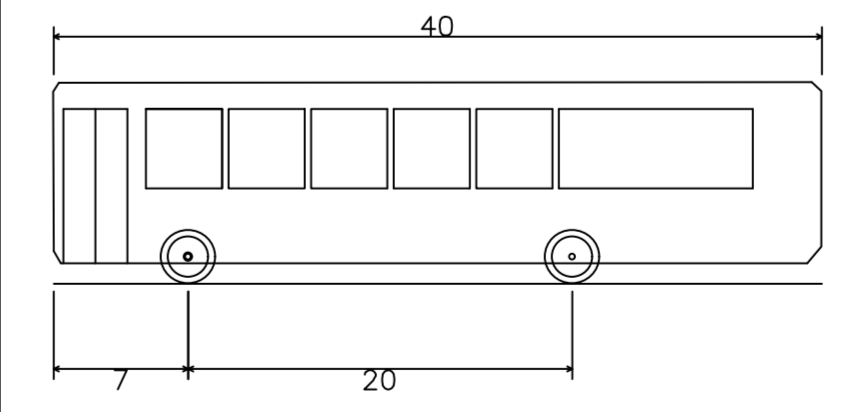

S-BUS-40 - Large School Bus (84 pass.)
 Overall Length 40.000ft
 Overall Width 8.000ft
 Overall Body Height 10.500ft
 Min Body Ground Clearance 1.070ft
 Track Width 8.000ft
 Lock-to-lock time 5.00s
 Max Steering Angle (Virtual) 34.40°

GRAPHIC SCALE
 SCALE: 1" = 10'

TURNING MOVEMENTS: SCHOOL BUS
FAIRFAX PRESBYTERIAN CHURCH
 CITY OF FAIRFAX, VIRGINIA

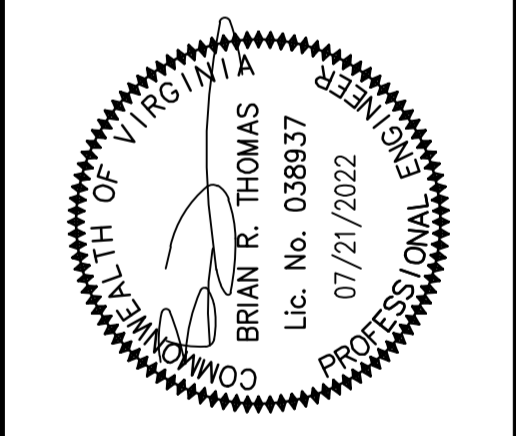

NO.	DATE	REVISION	APPROVED	DATE	BY

DESIGN	DRAFT	JURS	DATE	SCALE
APPROVED	HMF	DATE	JUNE 2021	AS SHOWN
SHEET 20 OF 51		PRJ NO: 2017-2570		
TYPE: MDP				

CPJ Charles P. Johnson & Associates, Inc.
 Civil and Environmental Engineers • Planners • Landscape Architects • Surveyors
 9909 Pender Dr., Ste. 210 Fairfax, VA 22030 703-385-7555 FAX: 703-273-8995
 www.cpj.com • Charlottesville, VA • Alexandria, VA • Annapolis, MD • Greenbelt, MD • Frederick, MD • Fairfax, VA

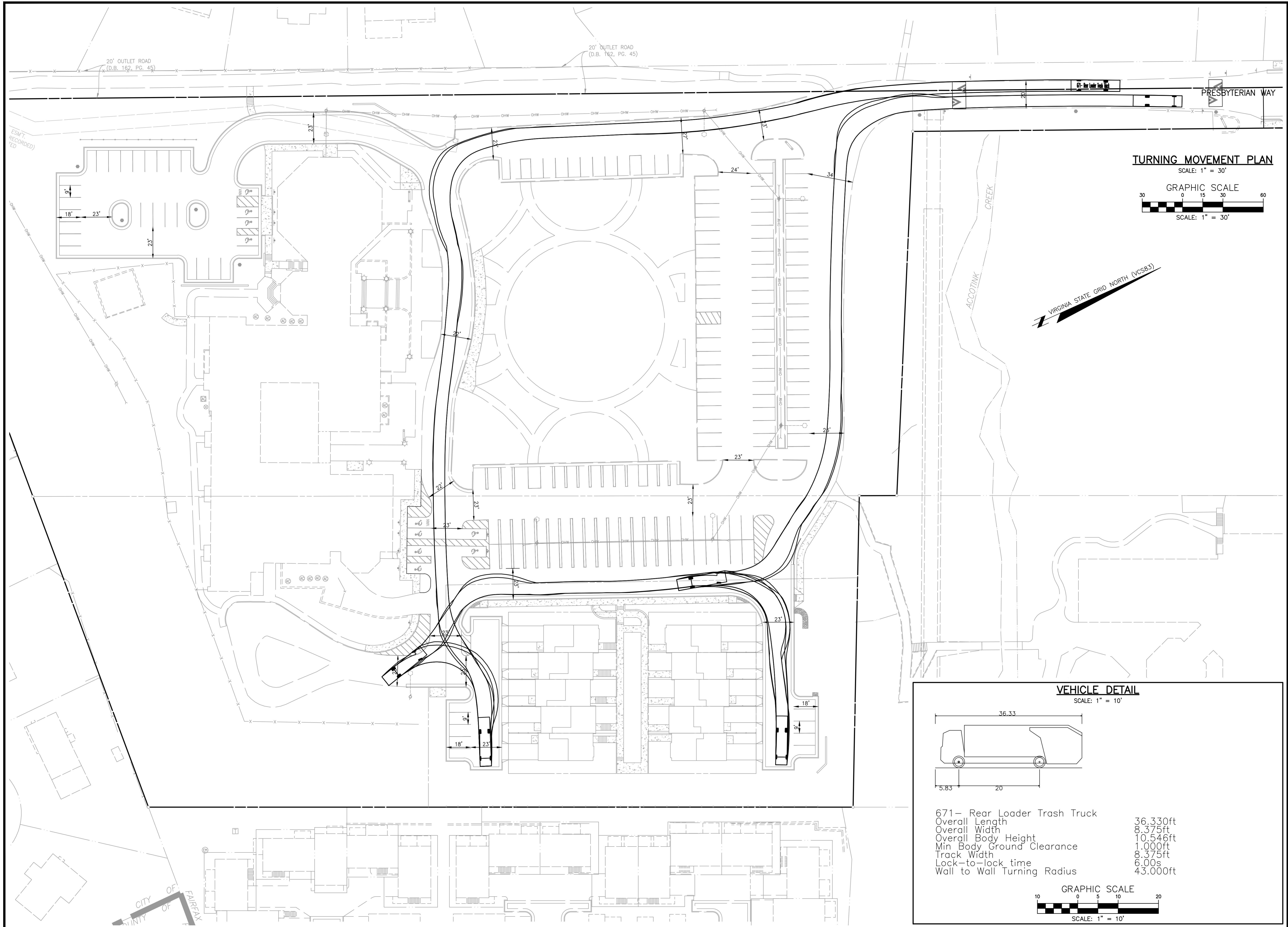

TURNING MOVEMENT PLAN
 SCALE: 1" = 30'
 GRAPHIC SCALE
 SCALE: 1" = 30'

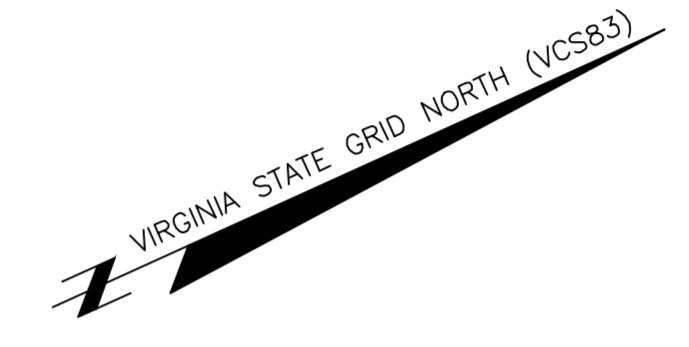

VEHICLE DETAIL
 SCALE: 1" = 10'

671- Rear Loader Trash Truck
 Overall Length 36.330ft
 Overall Width 8.375ft
 Overall Body Height 10.546ft
 Min Body Ground Clearance 1.000ft
 Track Width 8.375ft
 Lock-to-lock time 6.00s
 Wall to Wall Turning Radius 43.000ft

GRAPHIC SCALE
 SCALE: 1" = 10'

NO. DATE REVISION PRIOR TO APPROVAL

CPJ Charles P. Johnson & Associates, Inc.
 Civil and Environmental Engineers • Planners • Landscape Architects • Surveyors
 9909 Pender Dr., Ste. 210 Fairfax, VA 22030 703-585-7555 FAX: 703-273-8995
 www.cpjassoc.com • Charlottesville, VA • Alexandria, VA • Annapolis, MD • Greenbelt, MD • Frederick, MD • Fairfax, VA

TURNING MOVEMENTS: TRASH TRUCK

FAIRFAX PRESBYTERIAN CHURCH

CITY OF FAIRFAX, VIRGINIA

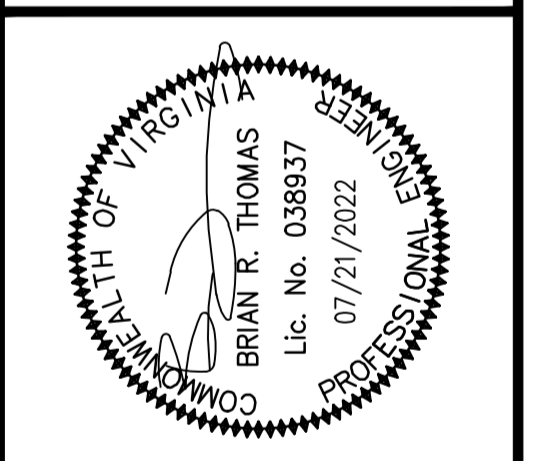

DESIGN	DRAFT	JURS	APPROVED	DATE	SCALE	DESCRIPTION	REVISIONS	NO.	DATE	REVIEW	APPROV	DATE	BY
				JUNE 2021	AS								

SHEET 21 OF 51
 PRJ NO: 2017-2570
 TYPE: MDP

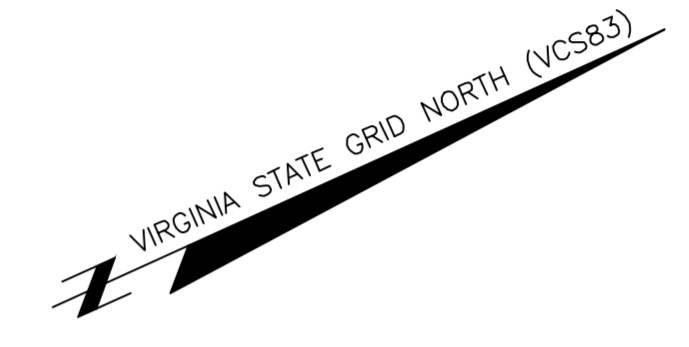
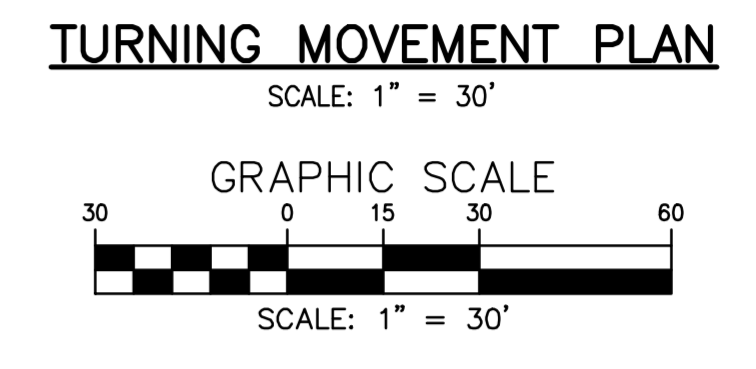
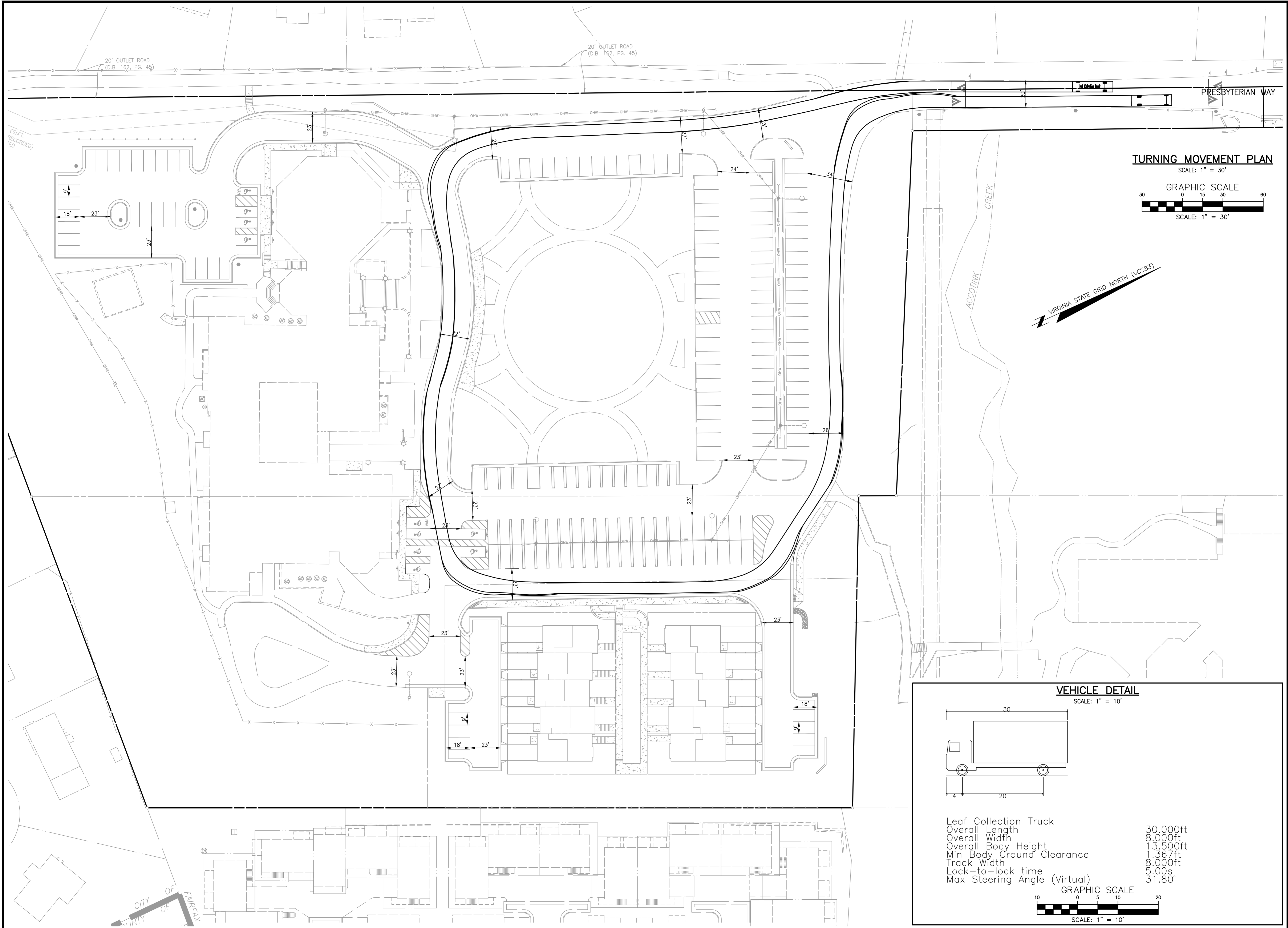

VEHICLE DETAIL
SCALE: 1" = 10'

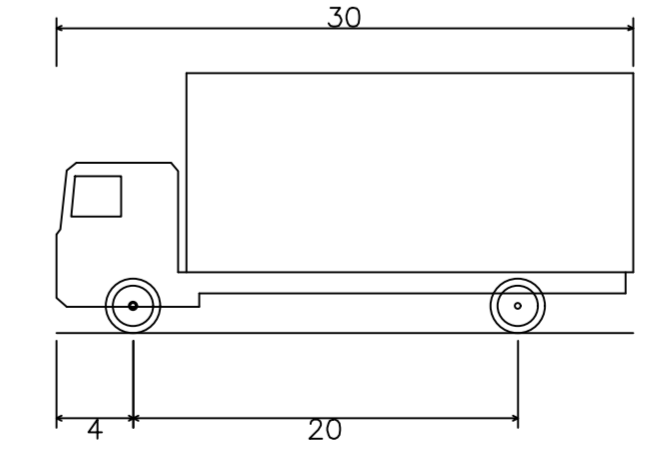

Leaf Collection Truck
 Overall Length 30.000ft
 Overall Width 8.000ft
 Overall Body Height 13.500ft
 Min Body Ground Clearance 1.367ft
 Track Width 8.000ft
 Lock-to-lock time 5:00s
 Max Steering Angle (Virtual) 51.80°

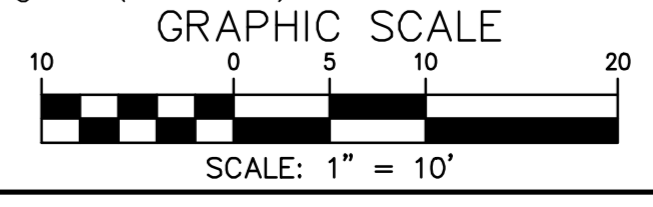

TURNING MOVEMENTS: LEAF TRUCK

**FAIRFAX
PRESBYTERIAN
CHURCH**

CITY OF FAIRFAX, VIRGINIA

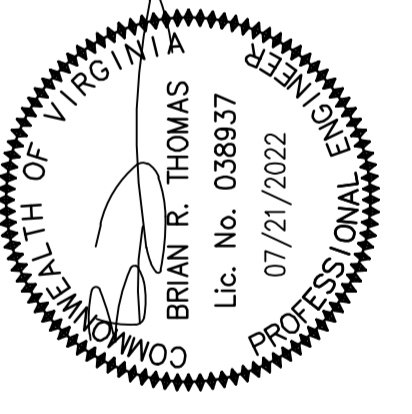

CPJ Charles P. Johnson & Associates, Inc.
 Civil and Environmental Engineers • Planners • Landscape Architects • Surveyors
 Associates
 9959 Pender Dr., Ste. 210 Fairfax, VA 22030 703-385-7555 Fax: 703-273-8995
 www.cpj.com • Charlottesville, VA • Glen Allen, VA • Greenbelt, MD • Frederick, MD • Fairfax, VA

NO.	DATE	REVISION	APPROVED	DATE

DESIGN	DRAFT	JURS	APPROVED	HMF	DATE	SCALE	DESCRIPTION	REVISIONS

SHEET	OF
22	51

PRJ NO: 2017-2570
TYPE: MDP

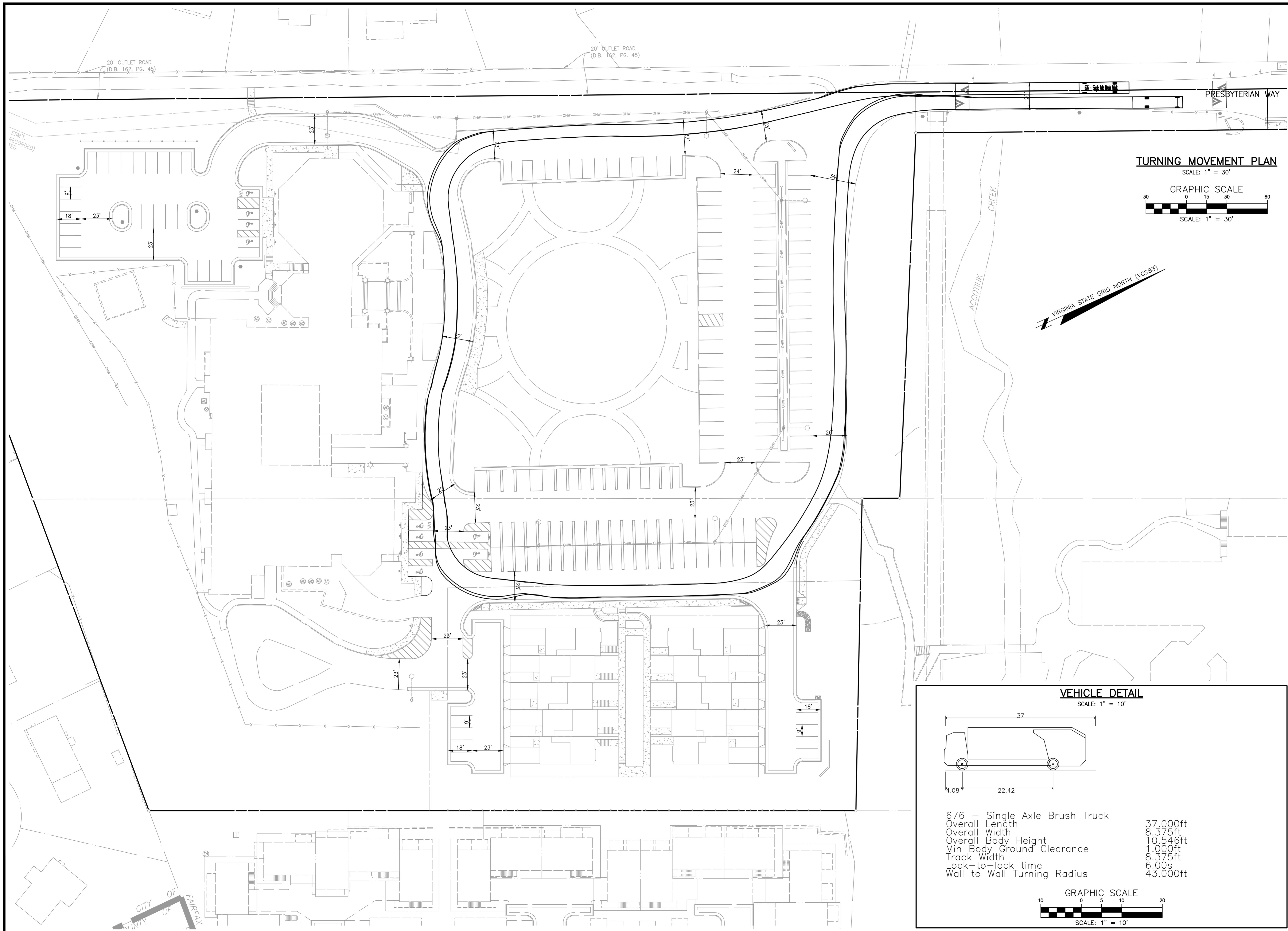

TURNING MOVEMENT PLAN
 SCALE: 1" = 30'
 GRAPHIC SCALE
 SCALE: 1" = 30'

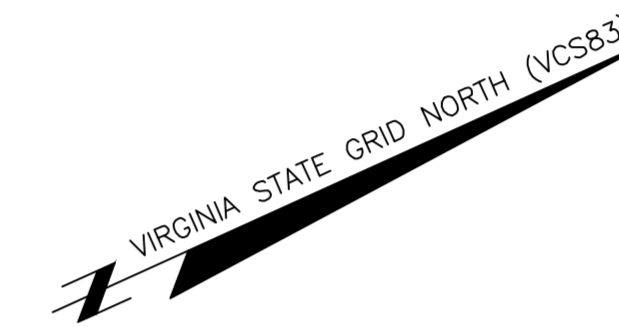

VEHICLE DETAIL
 SCALE: 1" = 10'

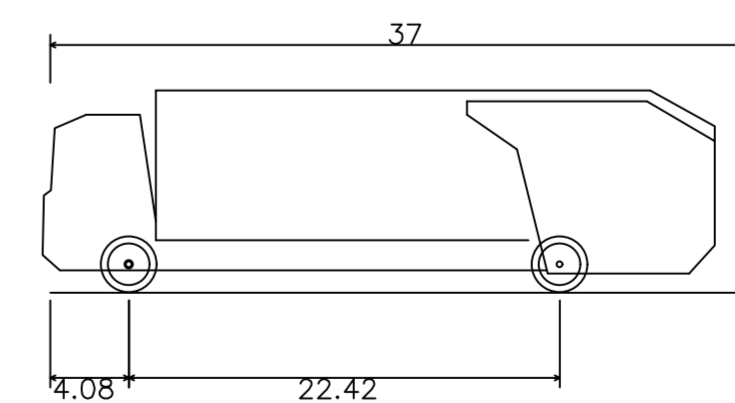

676 - Single Axle Brush Truck
 Overall Length 37.000ft
 Overall Width 8.375ft
 Overall Body Height 10.546ft
 Min Body Ground Clearance 1.000ft
 Track Width 8.375ft
 Lock-to-lock time 6.00s
 Wall to Wall Turning Radius 43.000ft

GRAPHIC SCALE
 SCALE: 1" = 10'

NO. DATE REVISION PRIOR TO APPROVAL

CPJ Charles P. Johnson & Associates, Inc.
 Civil and Environmental Engineers • Planners • Landscape Architects • Surveyors
 9999 Pender Dr., Ste. 210 Fairfax, VA 22030 703-385-7555 FAX: 703-273-8895
 www.cpj.com • Chantilly, VA • Alexandria, VA • Greenbelt, MD • Frederick, MD • Fairfax, VA

TURNING MOVEMENTS: BRUSH TRUCK

FAIRFAX PRESBYTERIAN CHURCH

CITY OF FAIRFAX, VIRGINIA

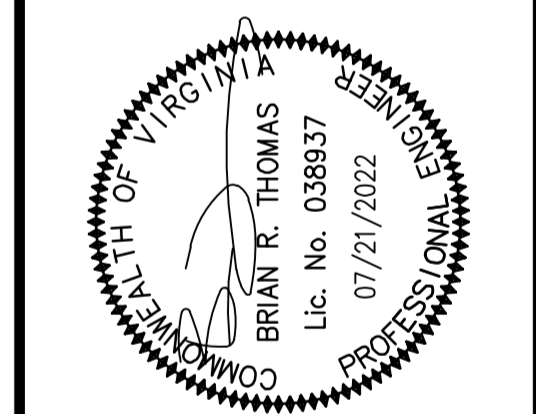

DESIGN	DRAFT	DATE	SCALE	DESCRIPTION	REVISIONS
JURS	AS	JUNE 2021	AS		
APPROVED	HMF				
REVIEW	AS				
APPROVAL	AS				
DATE					

SHEET	OF
23	51
PRJ NO: 2017-2570	
TYPE: MDP	

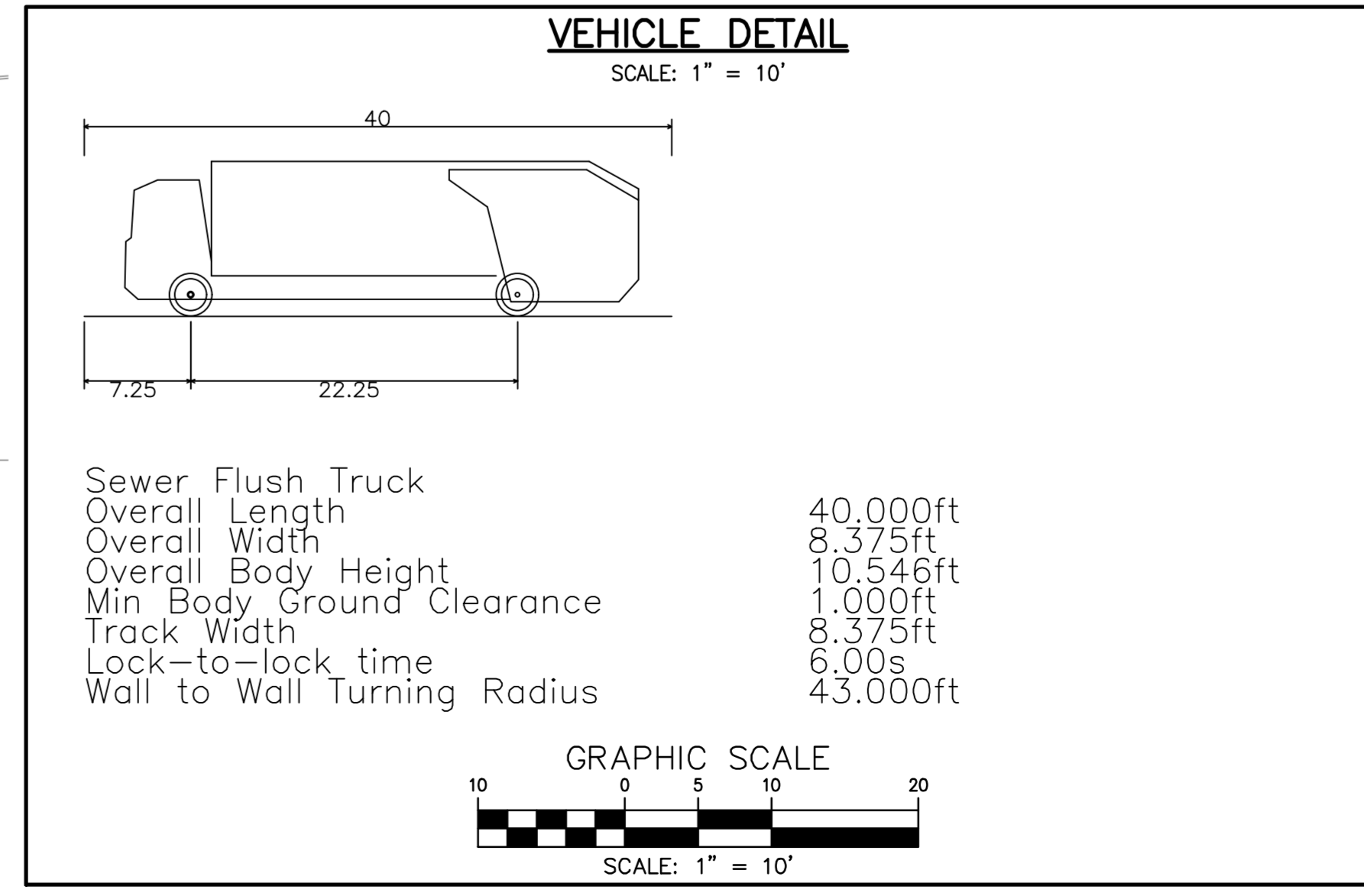
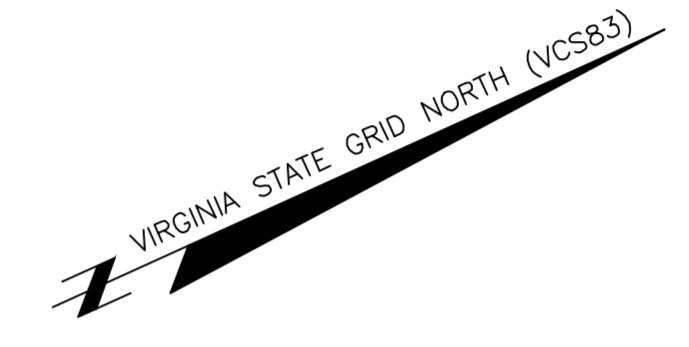
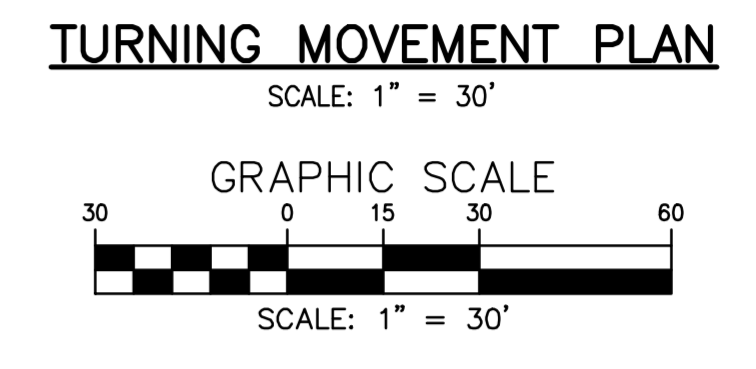
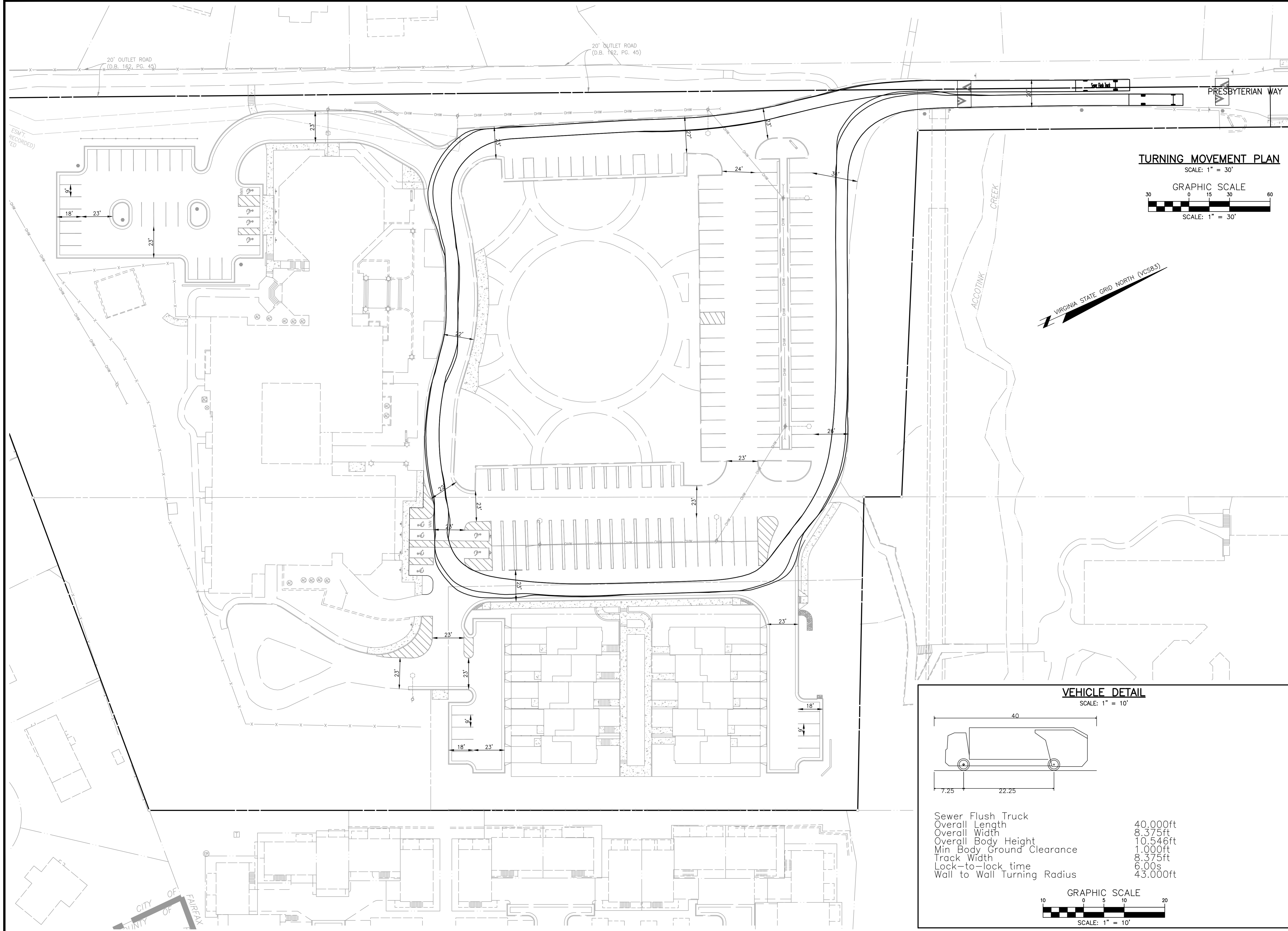

TURNING MOVEMENTS: SEWER FLUSH TRUCK

**FAIRFAX
PRESBYTERIAN
CHURCH**

CITY OF FAIRFAX, VIRGINIA

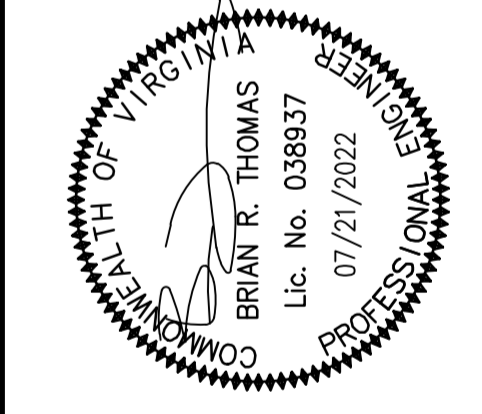

DESIGN	DRAFT	JURS	DATE	SCALE	REVISIONS
APPROVED	HMF	DATE	JUNE 2021	AS	SHOWN
SHEET		OF			
24		51			
PRJ NO: 2017-2570					
TYPE: MDP					

CPJ Charles P. Johnson & Associates, Inc.
Civil and Environmental Engineers • Planners • Landscape Architects • Surveyors
9909 Pender Dr., Ste. 210 Fairfax, VA 22030 703-585-7555 FAX: 703-273-8995
www.cpjassoc.com • Charlottesville, VA • Annapolis, MD • Greenbelt, MD • Frederick, MD • Fairfax, VA

NO.	DATE	REVISION	APPROVAL

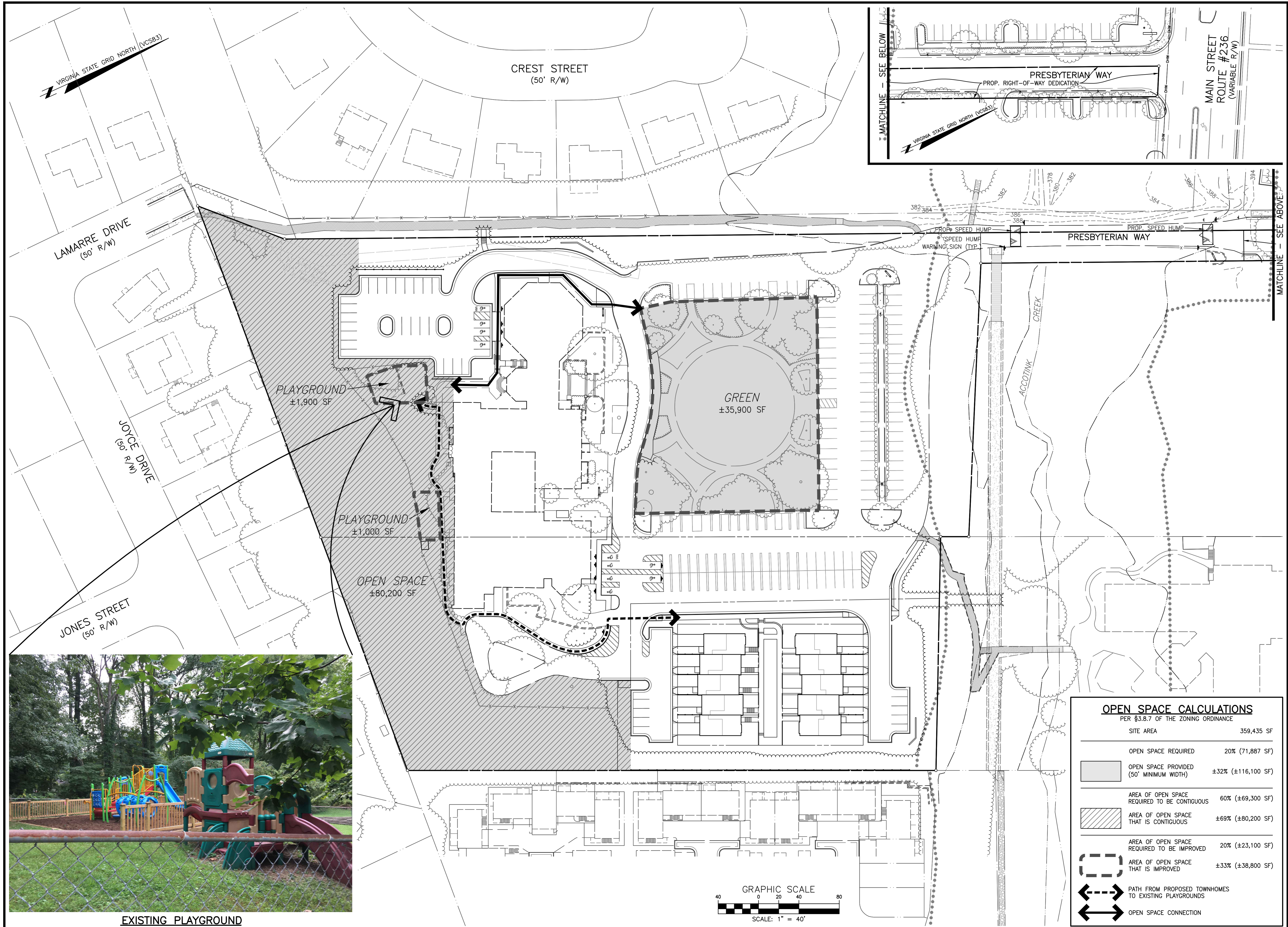

EXISTING PLAYGROUND

OPEN SPACE CALCULATIONS	
PER §3.8.7 OF THE ZONING ORDINANCE	
SITE AREA	359,435 SF
OPEN SPACE REQUIRED	20% (71,887 SF)
OPEN SPACE PROVIDED (50' MINIMUM WIDTH)	±32% (±116,100 SF)
AREA OF OPEN SPACE REQUIRED TO BE CONTIGUOUS	60% (±69,300 SF)
AREA OF OPEN SPACE THAT IS CONTIGUOUS	±69% (±80,200 SF)
AREA OF OPEN SPACE REQUIRED TO BE IMPROVED	20% (±23,100 SF)
AREA OF OPEN SPACE THAT IS IMPROVED	±33% (±38,800 SF)

	AREA OF OPEN SPACE THAT IS IMPROVED
	PATH FROM PROPOSED TOWNHOMES TO EXISTING PLAYGROUNDS
	OPEN SPACE CONNECTION

REVISION PRIOR TO APPROVAL

NO.	DATE	DESCRIPTION	REVISIONS

CPJ Charles P. Johnson & Associates, Inc.
 Civil and Environmental Engineers • Planners • Landscape Architects • Surveyors
 9909 Pender Dr., Ste. 210 Fairfax, VA 22030 703-585-7555 FAX: 703-273-8995
 www.cpjassoc.com • Charlottesville, VA • Charlottesville, VA • Greenbelt, MD • Frederick, MD • Fairfax, VA

RECREATION & OPEN SPACE PLAN

FAIRFAX PRESBYTERIAN CHURCH

CITY OF FAIRFAX, VIRGINIA

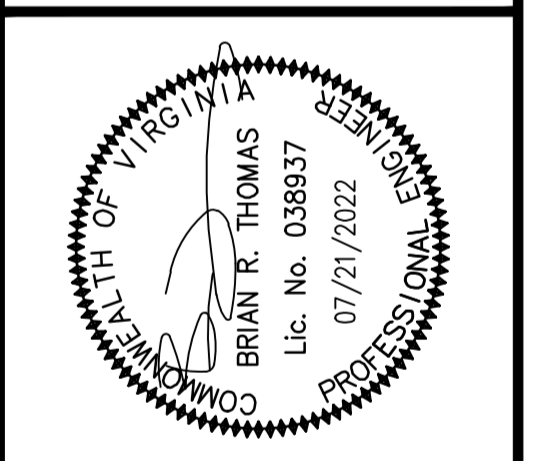

DESIGN	DRAWN	DATE	SCALE	HORIZ.	VERT.	NO.	DATE	BY
KJV	KJV	JAN. 2021	1" = 40'					
HMF	HMF							

SHEET 25 OF 51
 PRJ NO: 2017-2570
 TYPE: MDP

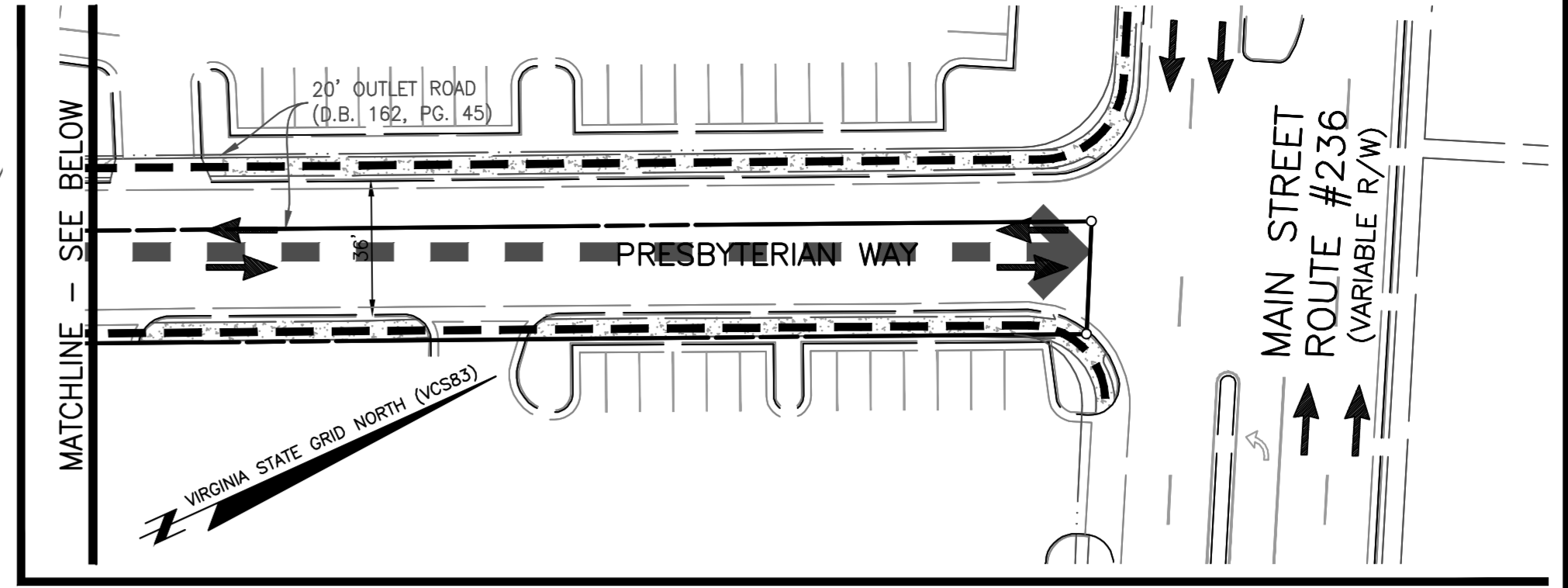
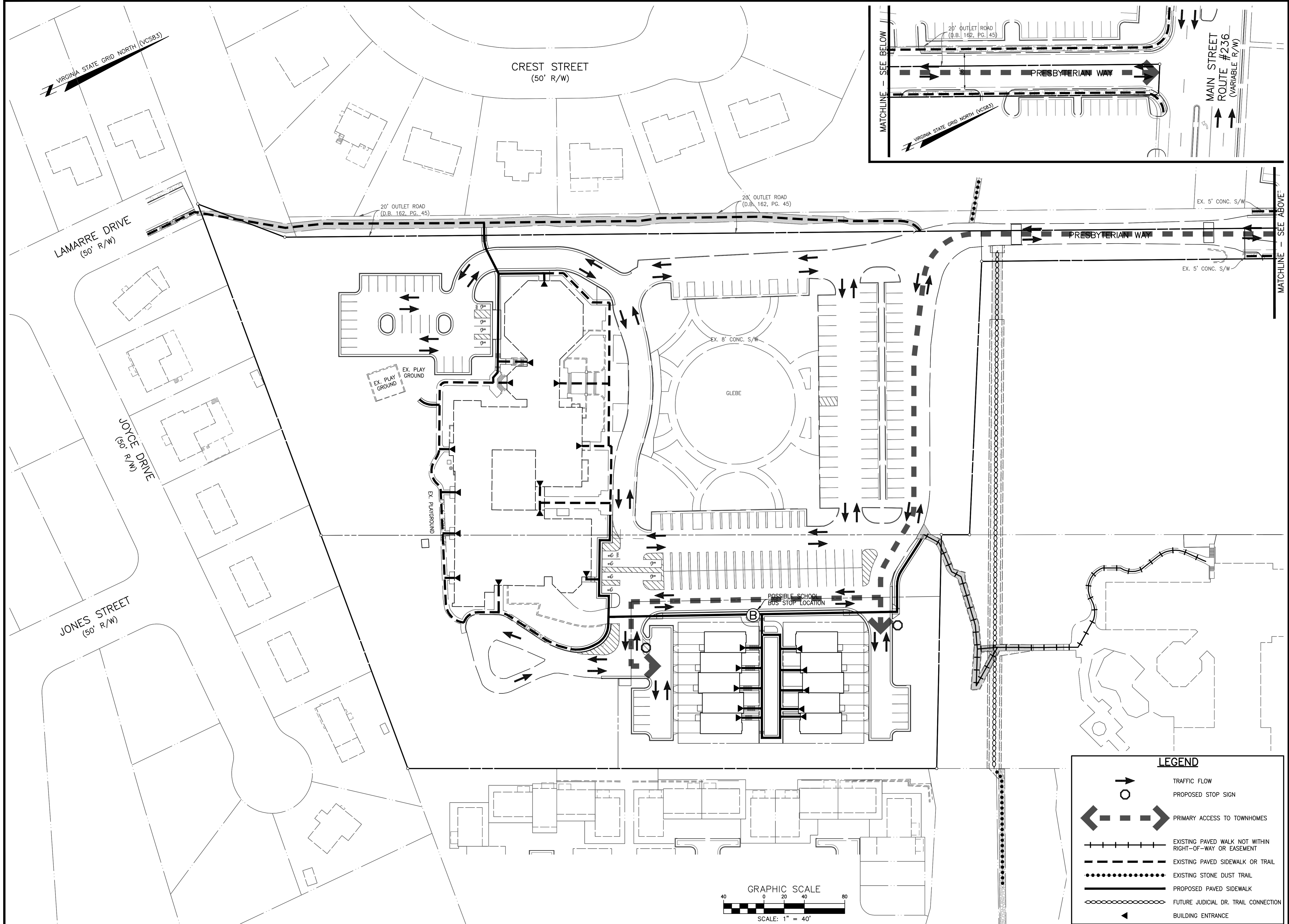

VEHICULAR & PEDESTRIAN CIRCULATION PLAN

FAIRFAX PRESBYTERIAN CHURCH

CITY OF FAIRFAX, VIRGINIA

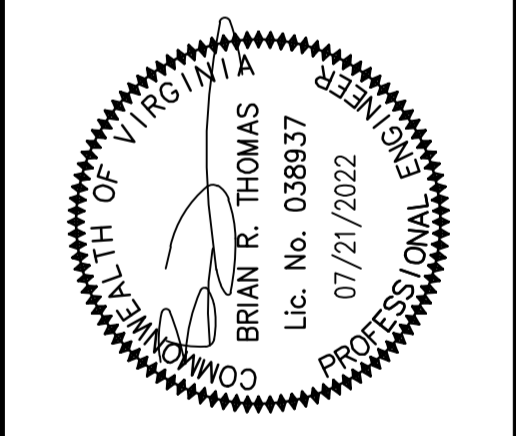

NO.	DATE	REVISION	APPROVED BY

DESIGN	DATE	SCALE	HORIZONTAL	VERTICAL
KJV	JAN. 2021	1" = 40'		
APPROVED				
HMF				
SHEET 26 OF 51		PRJ NO: 2017-2570		
TYPE: MDP				

LEGEND

- TRAFFIC FLOW
- PROPOSED STOP SIGN
- PRIMARY ACCESS TO TOWNHOMES
- EXISTING PAVED WALK NOT WITHIN RIGHT-OF-WAY OR EASEMENT
- EXISTING PAVED SIDEWALK OR TRAIL
- EXISTING STONE DUST TRAIL
- PROPOSED PAVED SIDEWALK
- FUTURE JUDICIAL DR. TRAIL CONNECTION
- BUILDING ENTRANCE

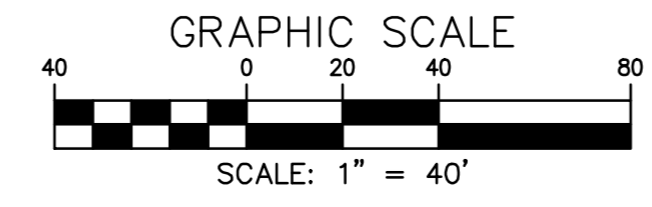

NO. DATE REVISION APPROVED BY

CPJ Charles P. Johnson & Associates, Inc.
Civil and Environmental Engineers • Planners • Landscape Architects • Surveyors
9909 Pender Dr., Ste. 210 Fairfax, VA 22030 703-585-7555 Fax: 703-273-8995
www.cpjassoc.com • Charlottesville, VA • Alexandria, VA • Annapolis, MD • Frederick, MD • Fairfax, VA

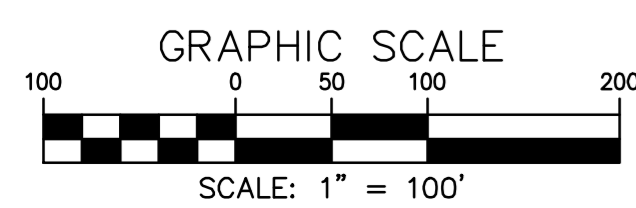

LEGEND

—+—+—+—+—	EXISTING PAVED WALK NOT WITHIN RIGHT-OF-WAY OR EASEMENT
-----	EXISTING PAVED SIDEWALK OR TRAIL
.....	EXISTING STONE DUST TRAIL
.....	EXISTING CROSSWALK
-----	PROPOSED PAVED SIDEWALK
.....	FUTURE JUDICIAL DR. TRAIL CONNECTION
->->->->->	PREFERRED PATH TO MAIN STREET FROM PROPOSED TOWNHOUSES
(B)	EXISTING CUE BUS STOP
⏏	EXISTING TRAFFIC SIGNAL

NEIGHBORHOOD PEDESTRIAN CONNECTION PLAN

**FAIRFAX
PRESBYTERIAN
CHURCH**

CITY OF FAIRFAX, VIRGINIA



NO.	DATE	REVISION	APPROVAL	DATE	BY

DESIGN: KJV	APPROVED: KJV	DATE: JAN. 2021	SCALE: HORIZONTAL = 1" = 100'
DRAWN: HMF	DATE: JAN. 2021	SCALE: VERTICAL = 1" = 100'	TYPE: MDP
SHEET: 27	OF: 51	PRJ NO: 2017-2570	

CPJ Charles P. Johnson & Associates, Inc.
 Associates
 9959 Pender Dr., Ste. 210 Fairfax, VA 22030 703-585-7555 FAX: 703-273-8995
 www.cpj.com
 www.cpj.com • Chantilly, VA • Gaithersburg, MD • Greenbelt, MD • Frederick, MD • Fairfax, VA