

MATCHLINE - SEE SHEET 12

MATCHLINE - SEE BELOW

MATCHLINE - SEE SHEET 10

MATCHLINE - SEE ABOVE

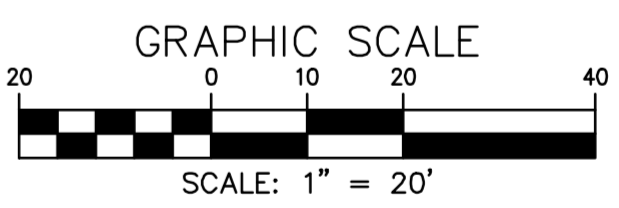
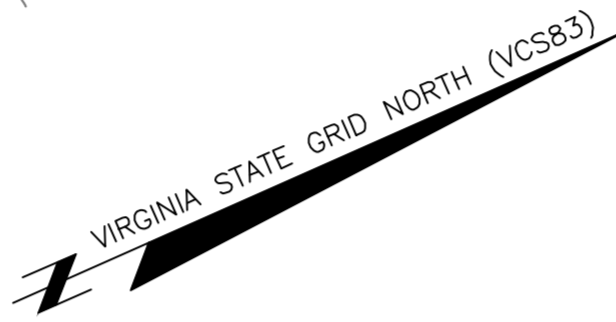
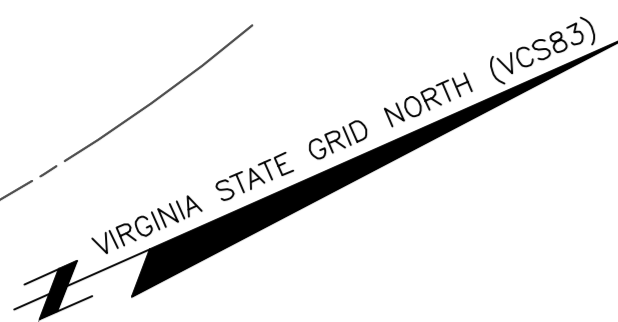

LEGEND	
	EXISTING CONTOUR
	EXISTING INDEX CONTOUR
	PROPOSED CONTOUR
	PROPOSED INDEX CONTOUR
	RESOURCE PROTECTION AREA
	100-YEAR FLOODPLAIN
	LIMITS OF CLEARING & GRADING
	EXISTING TREELINE
	PROPOSED TREELINE
	EXISTING STORM DRAIN
	PROPOSED STORM DRAIN
	EX. SANITARY SEWER & EASEMENT
	PROPOSED SANITARY SEWER
	EX. WATERMAIN & EASEMENT
	PROPOSED WATERMAIN
	EXISTING UTILITY LINE & POLE
	EXISTING STREET LIGHT
	PROPOSED STREET LIGHT (SEE SHEET 52 FOR DETAIL)

REVISION PRIOR TO APPROVAL

NO.	DATE	DESCRIPTION	BY

**CPJ** Charles P. Johnson & Associates, Inc.  
 Civil and Environmental Engineers • Planners • Landscape Architects • Surveyors  
 ASSOCIATES  
 9959 Pender Dr., Ste. 210 Fairfax, VA 22030 703-585-7555 FAX: 703-273-8995  
 www.cpj.com • Chantilly, VA • Greenbelt, MD • Frederick, MD • Fairfax, VA

PRELIMINARY GRADING PLAN

# FAIRFAX PRESBYTERIAN CHURCH

CITY OF FAIRFAX, VIRGINIA

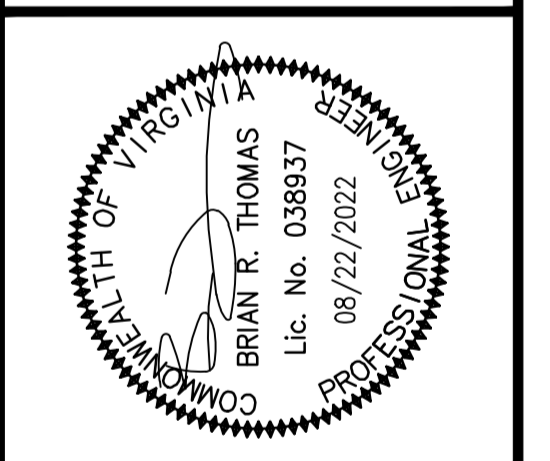

DESIGN	DRAWN	DATE	SCALE	HORIZONTAL	VERTICAL
KJV	KJV	JAN. 2021	1" = 20'	---	---

SHEET 9 OF 52  
 PRJ NO: 2017-2570  
 TYPE: MDP















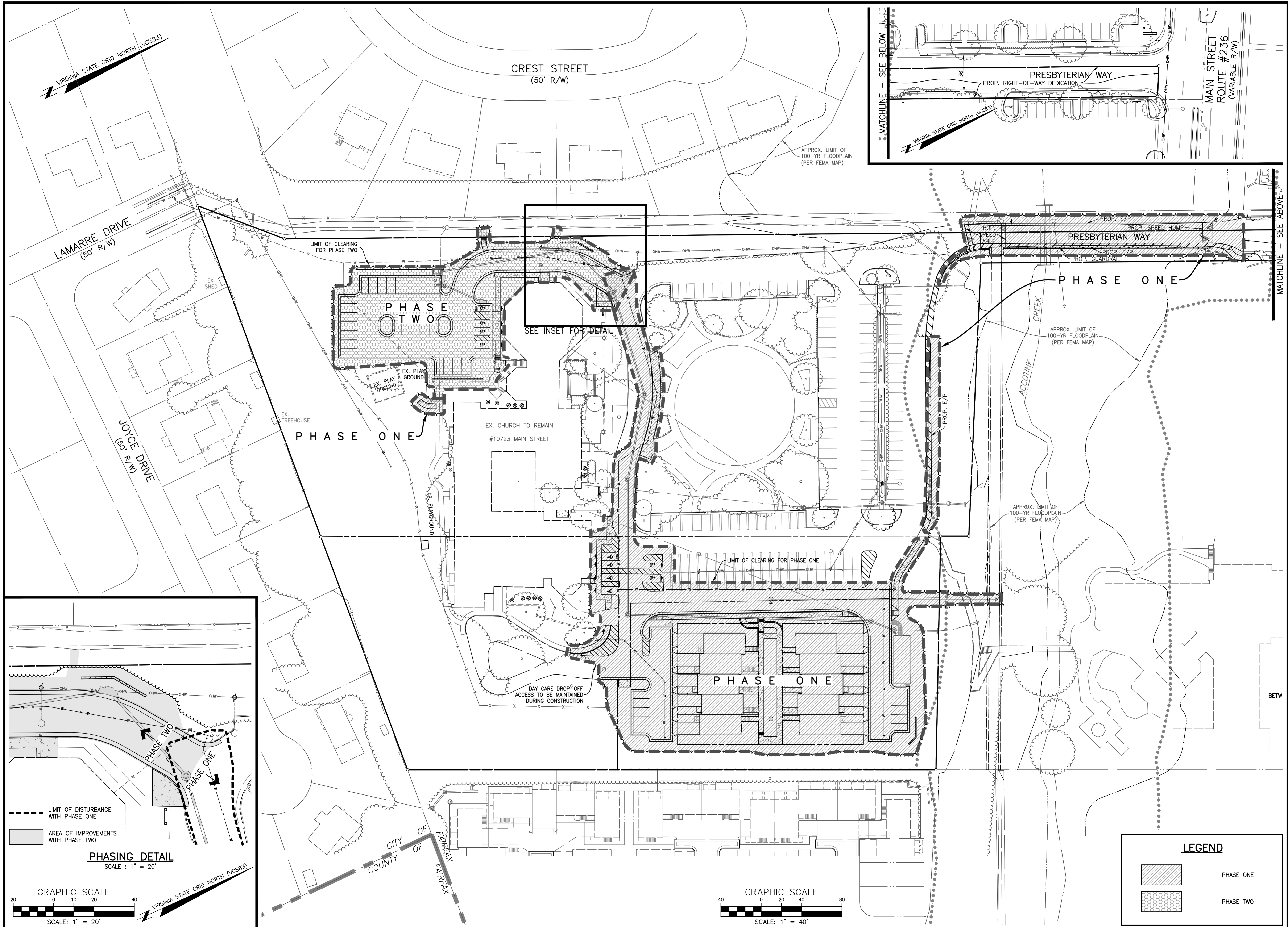

NO. DATE REVISION PRIOR TO APPROVAL

**CPJ** Charles P. Johnson & Associates, Inc.  
 Civil and Environmental Engineers • Planners • Landscape Architects • Surveyors  
 9909 Pender Dr., Ste. 210 Fairfax, VA 22030 703-385-7555 FAX: 703-273-8095  
 www.cpjassoc.com • Charlottesville, VA • Alexandria, VA • Annapolis, MD • Frederick, MD • Fairfax, VA

PHASING PLAN

**FAIRFAX PRESBYTERIAN CHURCH**

CITY OF FAIRFAX, VIRGINIA

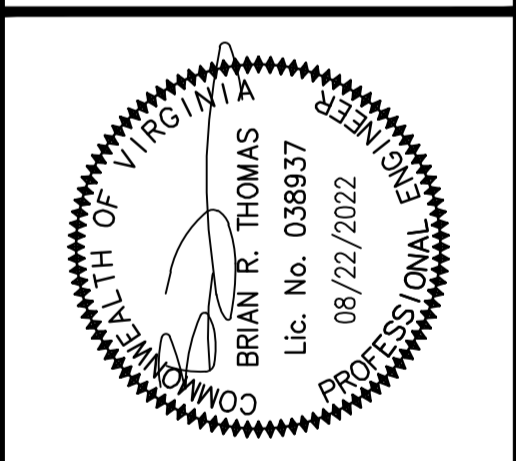

DESIGN	DRAWN	DATE	SCALE	NO.
KJV	KJV	JAN. 2021	SCALE	40
HMF	HMF		HORIZ. 1" = 40'	
			VERT. 1" = 40'	

REVISIONS	DESCRIPTION	DATE	BY

SHEET	OF
13	52
PRJ NO: 2017-2570	
TYPE: MDP	



VIRGINIA STATE GRID NORTH (VCS83)

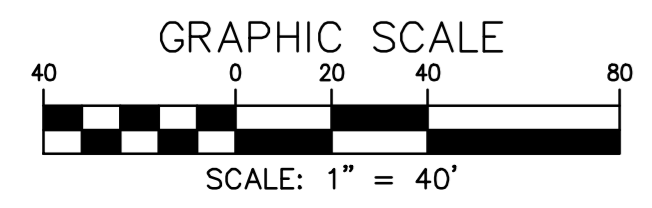
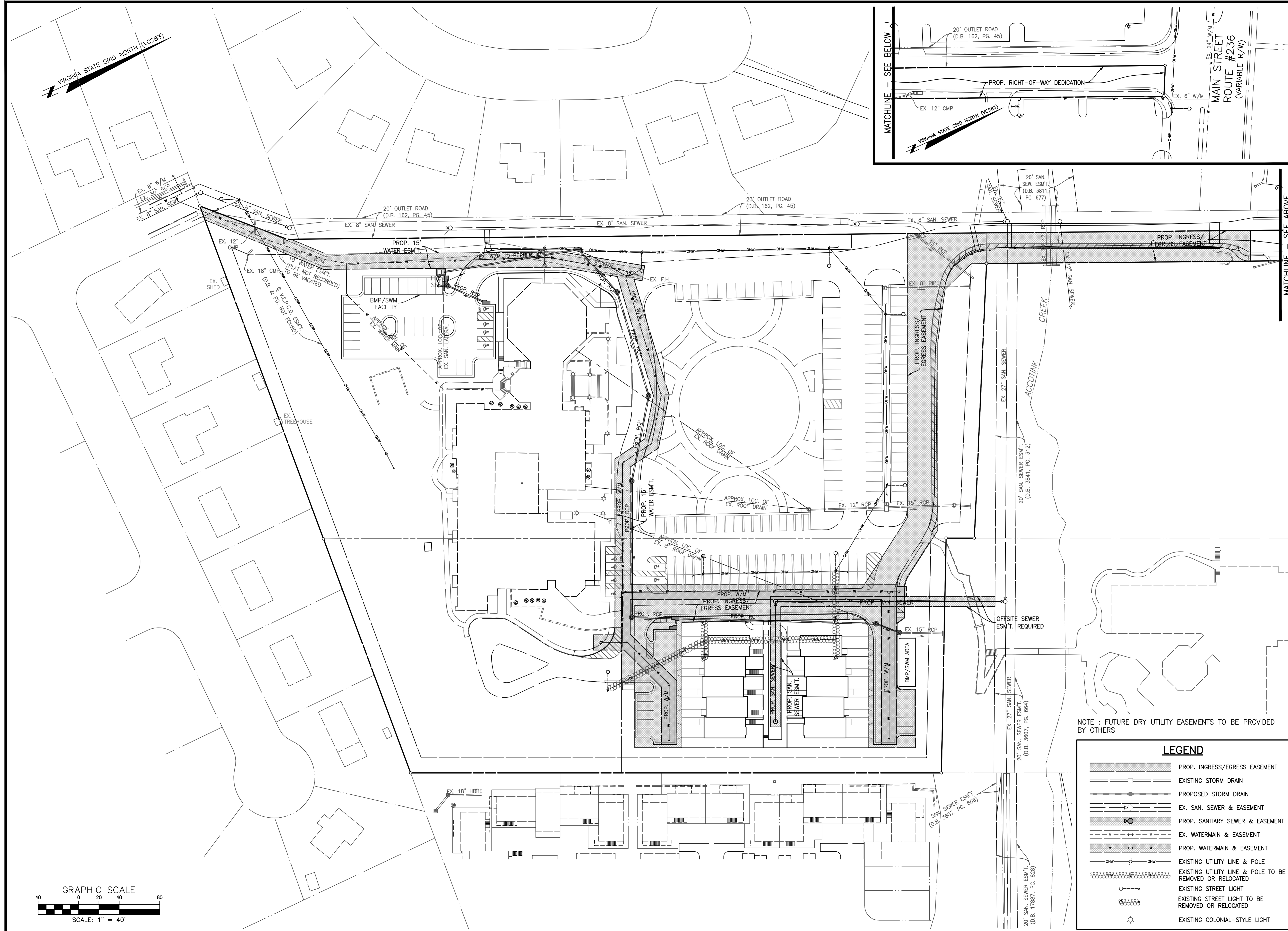
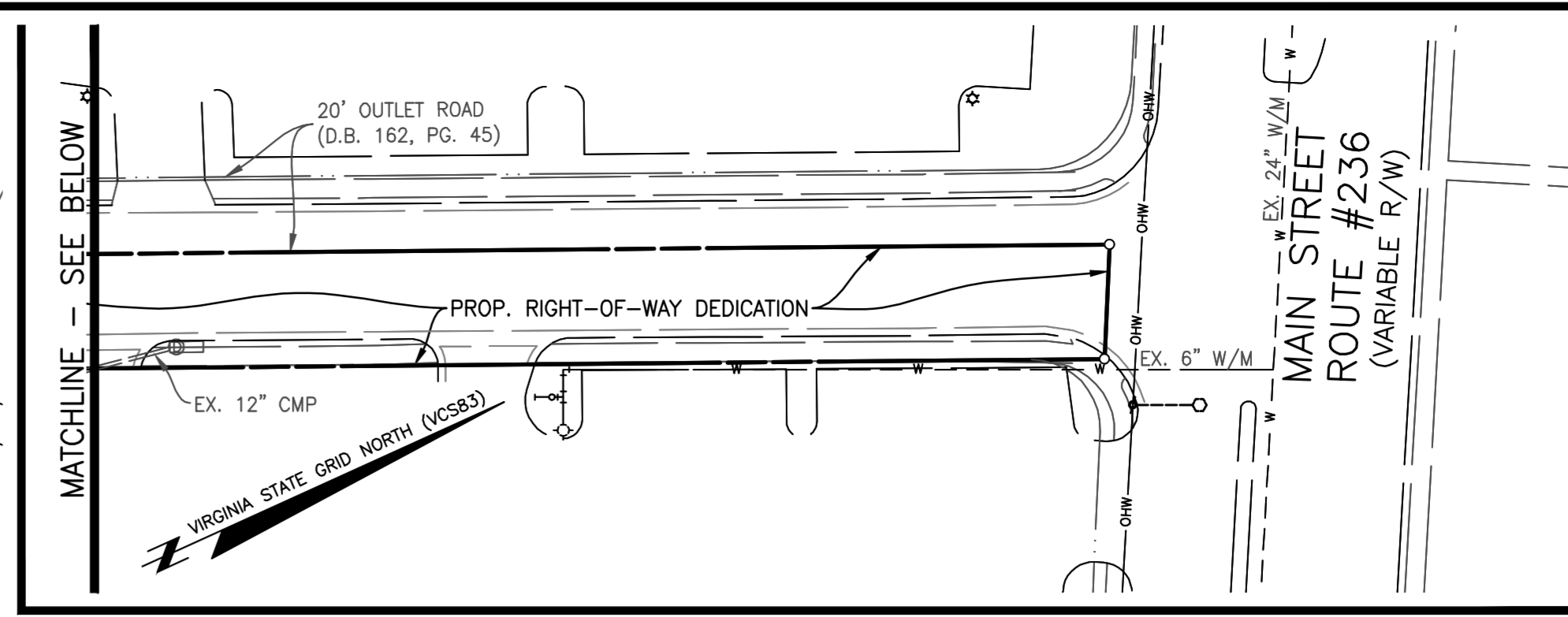

NOTE : FUTURE DRY UTILITY EASEMENTS TO BE PROVIDED BY OTHERS

LEGEND	
	PROP. INGRESS/EGRESS EASEMENT
	EXISTING STORM DRAIN
	PROPOSED STORM DRAIN
	EX. SAN. SEWER & EASEMENT
	PROP. SANITARY SEWER & EASEMENT
	EX. WATERMAIN & EASEMENT
	PROP. WATERMAIN & EASEMENT
	EXISTING UTILITY LINE & POLE
	EXISTING UTILITY LINE & POLE TO BE REMOVED OR RELOCATED
	EXISTING STREET LIGHT
	EXISTING STREET LIGHT TO BE REMOVED OR RELOCATED
	EXISTING COLONIAL-STYLE LIGHT

EASEMENT & UTILITY LAYOUT  
**FAIRFAX  
 PRESBYTERIAN  
 CHURCH**  
 CITY OF FAIRFAX, VIRGINIA

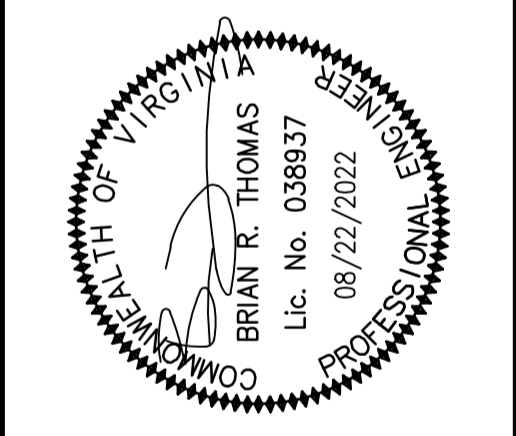

NO.	DATE	REVISION

DESIGN	DRAWN	DATE	SCALE
KJV	KJV	JAN. 2021	SCALE

SHEET	OF
14	52
PRJ NO: 2017-2570	
TYPE: MDP	

**CPJ** Charles P. Johnson & Associates, Inc.  
 Civil and Environmental Engineers • Planners • Landscape Architects • Surveyors  
 9909 Pender Dr., Ste. 210 Fairfax, VA 22030 703-585-7545 FAX: 703-273-8095  
 www.cpjassoc.com • Charlottesville, VA • Annapolis, MD • Greenbelt, MD • Frederick, MD • Fairfax, VA



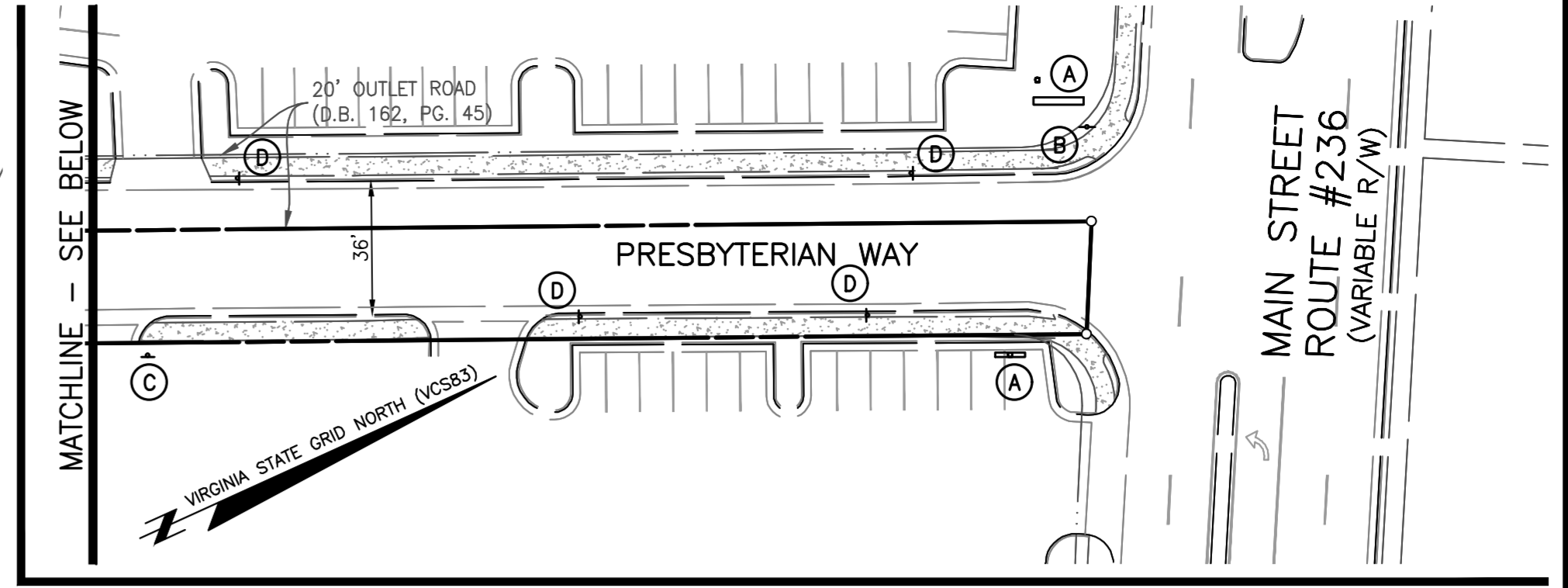
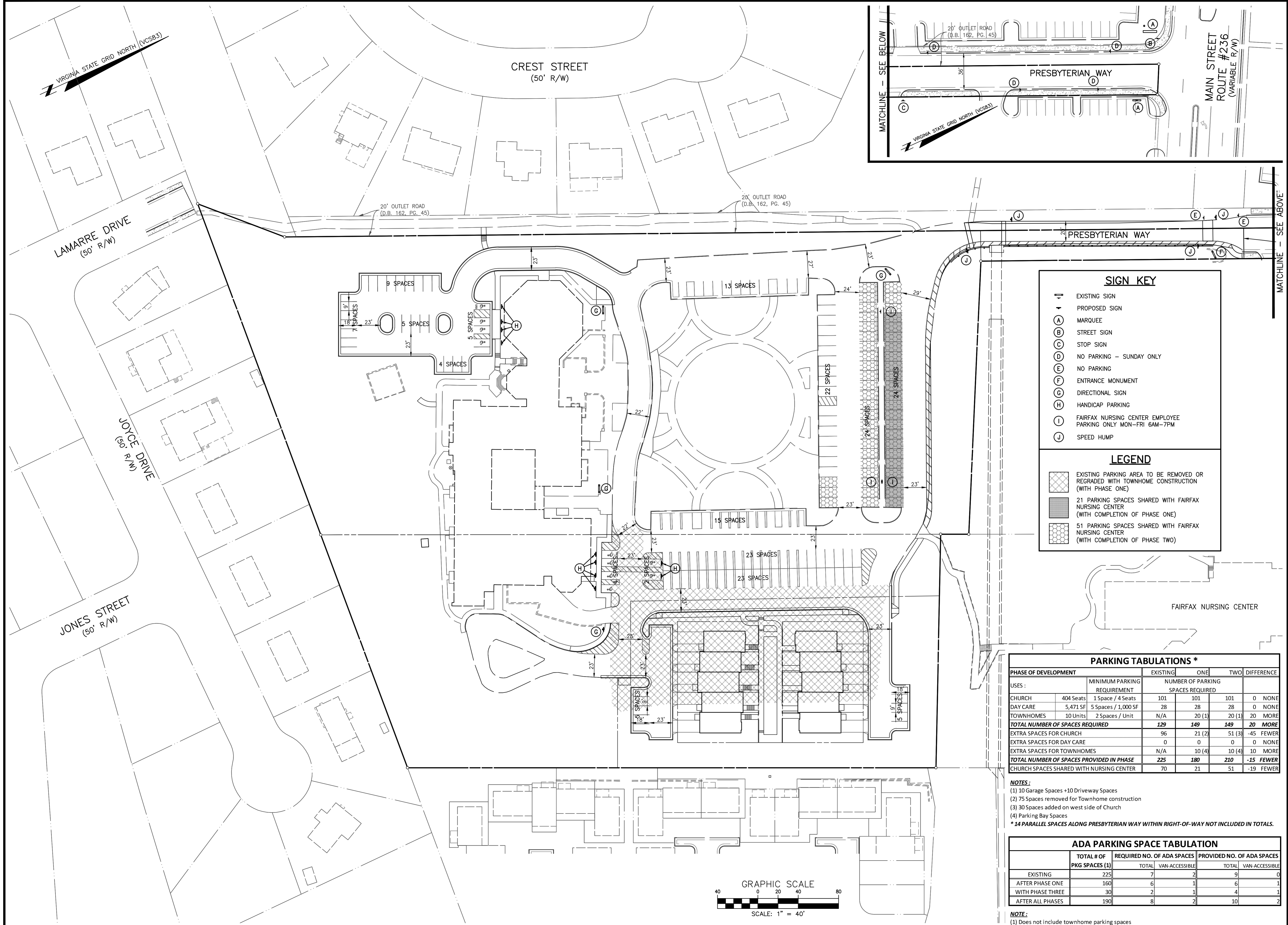

### SIGN KEY

- EXISTING SIGN
- PROPOSED SIGN
- (A) MARQUEE
- (B) STREET SIGN
- (C) STOP SIGN
- (D) NO PARKING - SUNDAY ONLY
- (E) NO PARKING
- (F) ENTRANCE MONUMENT
- (G) DIRECTIONAL SIGN
- (H) HANDICAP PARKING
- (I) FAIRFAX NURSING CENTER EMPLOYEE PARKING ONLY MON-FRI 6AM-7PM
- (J) SPEED HUMP

### LEGEND

- EXISTING PARKING AREA TO BE REMOVED OR REGRADED WITH TOWNHOME CONSTRUCTION (WITH PHASE ONE)
- 21 PARKING SPACES SHARED WITH FAIRFAX NURSING CENTER (WITH COMPLETION OF PHASE ONE)
- 51 PARKING SPACES SHARED WITH FAIRFAX NURSING CENTER (WITH COMPLETION OF PHASE TWO)

### PARKING TABULATIONS \*

PHASE OF DEVELOPMENT	MINIMUM PARKING REQUIREMENT	EXISTING			ONE			TWO			DIFFERENCE
		TOTAL	VAN-ACCESSIBLE	ADDITIONAL	TOTAL	VAN-ACCESSIBLE	ADDITIONAL	TOTAL	VAN-ACCESSIBLE	ADDITIONAL	
CHURCH	404 Seats / 1 Space / 4 Seats	101	101	101	101	101	101	101	101	0 NONE	
DAY CARE	5,471 SF / 5 Spaces / 1,000 SF	28	28	28	28	28	28	28	28	0 NONE	
TOWNHOMES	10 Units / 2 Spaces / Unit	N/A	20 (1)	20 (1)	20 (1)	20 (1)	20 (1)	20 (1)	20 (1)	20 MORE	
<b>TOTAL NUMBER OF SPACES REQUIRED</b>		<b>129</b>	<b>149</b>	<b>149</b>	<b>149</b>	<b>149</b>	<b>149</b>	<b>149</b>	<b>20 MORE</b>		
EXTRA SPACES FOR CHURCH		96	21 (2)	51 (3)	0	0	0	0	0	-45 FEWER	
EXTRA SPACES FOR DAY CARE		0	0	0	0	0	0	0	0	0 NONE	
EXTRA SPACES FOR TOWNHOMES		N/A	10 (4)	10 (4)	10 (4)	10 (4)	10 (4)	10 (4)	10 (4)	10 MORE	
<b>TOTAL NUMBER OF SPACES PROVIDED IN PHASE</b>		<b>225</b>	<b>180</b>	<b>210</b>	<b>210</b>	<b>210</b>	<b>210</b>	<b>210</b>	<b>-15 FEWER</b>		
CHURCH SPACES SHARED WITH NURSING CENTER		70	21	51	70	21	51	70	21	-19 FEWER	

**NOTES:**  
 (1) 10 Garage Spaces +10 Driveway Spaces  
 (2) 75 Spaces removed for Townhome construction  
 (3) 30 Spaces added on west side of Church  
 (4) Parking Bay Spaces  
 \* 14 PARALLEL SPACES ALONG PRESBYTERIAN WAY WITHIN RIGHT-OF-WAY NOT INCLUDED IN TOTALS.

### ADA PARKING SPACE TABULATION

	TOTAL # OF PKG SPACES (1)	REQUIRED NO. OF ADA SPACES		PROVIDED NO. OF ADA SPACES	
		TOTAL	VAN-ACCESSIBLE	TOTAL	VAN-ACCESSIBLE
EXISTING	225	7	2	9	0
AFTER PHASE ONE	160	6	1	6	1
WITH PHASE THREE	30	2	1	4	1
AFTER ALL PHASES	190	8	2	10	2

**NOTE:**  
 (1) Does not include townhome parking spaces

PARKING LAYOUT, TABULATIONS & SIGN LOCATIONS

# FAIRFAX PRESBYTERIAN CHURCH

CITY OF FAIRFAX, VIRGINIA

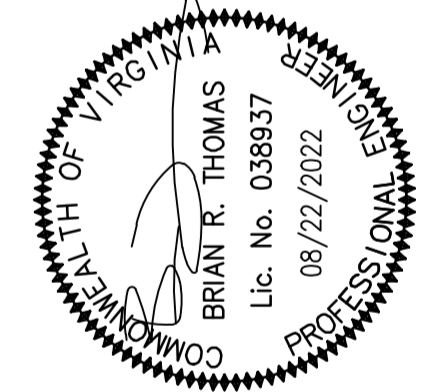

NO.	DATE	REVISIONS	REVIEW	APPROV	DATE	BY

DESIGN: KJV  
 CHECK: KJV  
 APPROVED: HMF  
 DATE: JAN. 2021  
 SCALE: HORIZ: 1" = 40'  
 VERT: ---  
 SHEET 15 OF 52  
 PRJ NO: 2017-2570  
 TYPE: MDP

**CPJ** Charles P. Johnson & Associates, Inc.  
 Civil and Environmental Engineers • Planners • Landscape Architects • Surveyors  
 9909 Pender Dr., Ste. 210 Fairfax, VA 22030 703-585-7555 FAX: 703-273-8995  
 www.cpj.com • Chantilly, VA • Annapolis, MD • Greenbelt, MD • Frederick, MD • Fairfax, VA







