

FIRE LANE DESIGNATIONS

Under Section 509 of the City of Fairfax Fire Prevention Code, the Office of the Fire Marshal is authorized to designate fire lanes on public streets and on private property where necessary. This is to prevent parking in front of, or adjacent to, fire hydrants and to provide access for fire fighting equipment. Markings and signs are to be provided by the owner or agent of the property involved. Parking or otherwise obstructing such areas is prohibited.

I. HYDRANTS

A. Parking is prohibited within 15' of a fire hydrant located along the curb line or edge of any public or private roadway. No special curb marking is required for enforcement.

B. Fire hydrants installed in parking lots are to be located within a fire lane. Curb and/or roadway marking is required in accordance with Sections III and IV below.

II. FIRE LANES

A. Fire lanes must be installed where required by the office of the Fire Marshal. Fire lanes must be marked with both sign and curb delineation per Section III and IV below. Parking and fire lane markings are required as follows.

Street Width Curb to Curb or Paved Surface	Parking	Fire Lane Markings
Up to 28 feet	No parking allowed on either side	Both sides marked as fire lanes
28 feet up to 36 feet	Parallel parking allowed on one side as determined by the fire code official	One side marked as a fire lane
36 feet and over	Parallel parking allowed on both sides	No fire lane markings required Exception: Required access to pools, fire department apparatus access roads and similar areas must be marked as fire lanes

SIGN TYPE "A"



Standard wording with an arrow at bottom pointing to the right. One sign mounted parallel to the line of curbing or pavement edge at end of painted area.

SIGN TYPE "C"



Standard wording with an arrow at bottom pointing to the left. One sign mounted parallel to the line of curbing or pavement edge at end of painted area.

SIGN TYPE "D"



Standard wording with no arrow. Two signs, back to back, mounted perpendicular to line or curbing or pavement edge.

III. SIGN SPECIFICATIONS

A. Metal construction, 12" X 18".

B. Red letters on reflective white background with 3/8" red trim strip around entire outer edge of sign.

C. Lettering on sign to be: "NO PARKING OR STANDING FIRE LANE".

D. Lettering size to be as follows: "NO PARKING" and "STANDING" is 2", "OR" is 1", "FIRE LANE" is 2 1/2" and the arrow with the solid shaft is 1" x 6" with the solid head 1 1/2" wide and 2" deep.

E. Signs are to be mounted 7' from the ground to the bottom of the sign unless otherwise directed by the Office of the Fire Marshal.

F. Post for signs, when required, must be metal and securely mounted, unless written permission for alternative is obtained prior to installation from the Office of the Fire Marshal. Signs should be spaced as shown on approved plans. In long stretches, the maximum distance between signs is 100'.

G. Other special signs may be approved by the Office of the Fire Marshal.

IV. CURB DESIGNATION

A. All curbs or paved spaces designated as fire lanes must be indicated by red paint as approved by the Office of the Fire Marshal. In areas without curbing, a 6" wide yellow stripe must be applied to the edge of the pavement. Paint must be highway traffic grade.

Note: Fire lane markings, types of signs, locations, etc. are subject to approval by the Fire Marshal.

FIRE PROTECTION PLAN

**FAIRFAX
PRESBYTERIAN
CHURCH**

CITY OF FAIRFAX, VIRGINIA

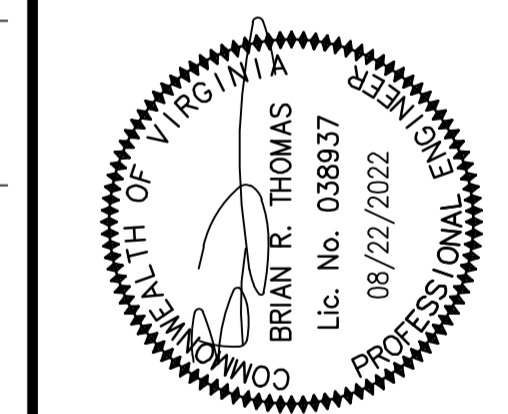

NO.	DATE	REVISION	PROJ TO APPROVAL

DESIGN	DRAWN	CHECKED	DATE	SCALE	HORIZ.	VERT.

SHEET	OF
18	52
PRJ NO: 2017-2570	
TYPE: MDP	

CPJ Charles P. Johnson & Associates, Inc.
Civil and Environmental Engineers • Planners • Landscape Architects • Surveyors
9909 Pender Dr., Ste. 210 Fairfax, VA 22030 703-385-7555 FAX: 703-273-8095
www.cpjassoc.com • Charlottesville, VA • Annapolis, MD • Greenbelt, MD • Frederick, MD • Fairfax, VA

LEGEND

- PROPOSED RED PAINTED CURB/ EDGE OF PAVEMENT
 - WATERMAIN
 - ◆ FIRE HYDRANT
 - ▼ FIRE DEPARTMENT CONNECTION
 - ▲ PRIMARY BUILDING ACCESS POINT
 - △ SECONDARY BLDG. ACCESS POINT
- FIRE LANE SIGNS :**
- ⊠ TYPE "A"
 - ⊠ TYPE "C"
 - ⊠ TYPE "D"

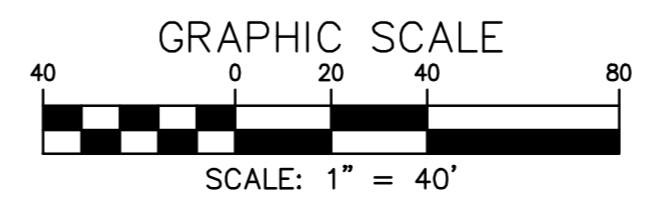

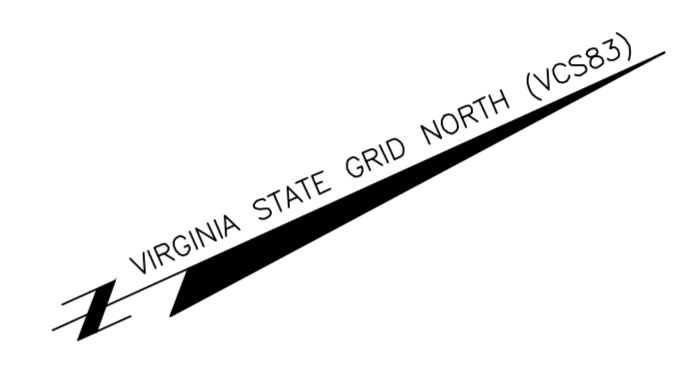
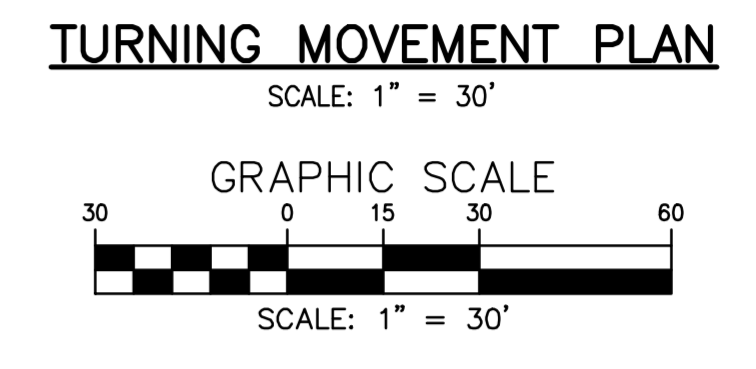
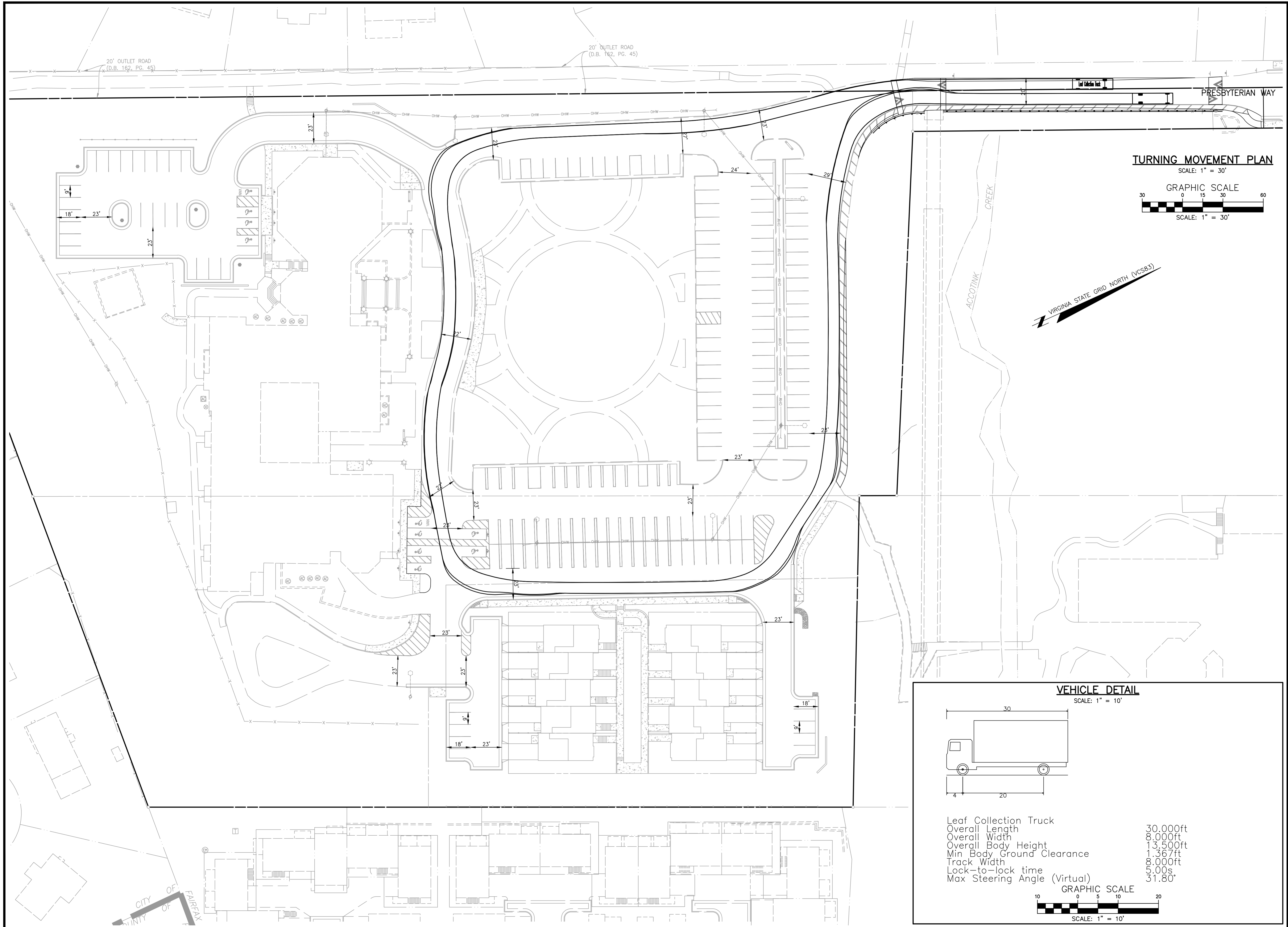

VEHICLE DETAIL
SCALE: 1" = 10'

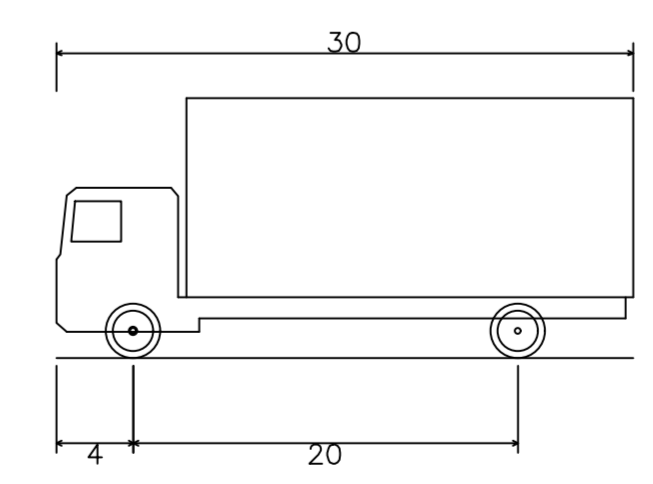

Leaf Collection Truck
 Overall Length 30.000ft
 Overall Width 8.000ft
 Overall Body Height 13.500ft
 Min Body Ground Clearance 1.367ft
 Track Width 8.000ft
 Lock-to-lock time 5.00s
 Max Steering Angle (Virtual) 51.80°

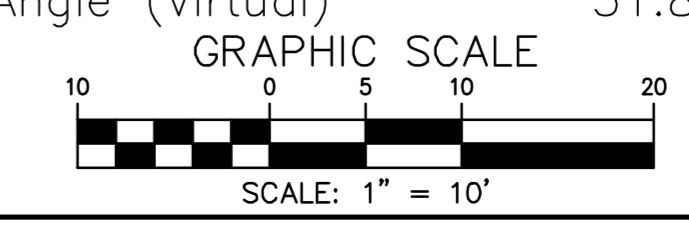

NO. DATE REVISION PRIOR TO APPROVAL

CPJ Charles P. Johnson & Associates, Inc.
 Associates
 Civil and Environmental Engineers • Planners • Landscape Architects • Surveyors
 9959 Pender Dr., Ste. 210 Fairfax, VA 22030 703-385-7555 FAX: 703-273-8995
 www.cpj.com • Chantilly, VA • Annapolis, MD • Greenbelt, MD • Frederick, MD • Fairfax, VA

TURNING MOVEMENTS: LEAF TRUCK

**FAIRFAX
 PRESBYTERIAN
 CHURCH**

CITY OF FAIRFAX, VIRGINIA

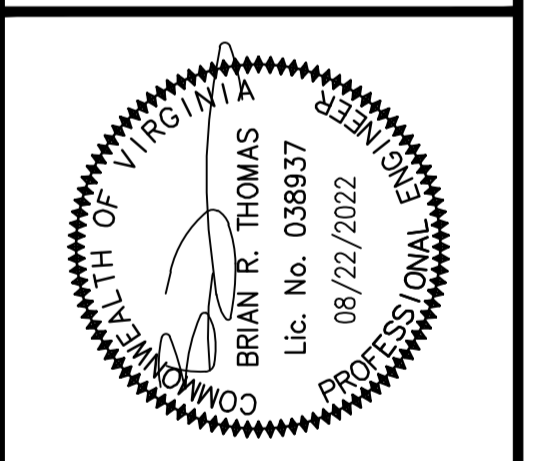

DESIGN	DRAFT	JURS	APPROVED	HMF	DATE	SCALE	HORIZ.	VERT.	SHOWN	REVISIONS	REVIEW	APPROV.	DATE	BY
					JUNE 2021	AS			SHOWN					
SHEET 22 OF 52														
PRJ NO: 2017-2570														
TYPE: MDP														

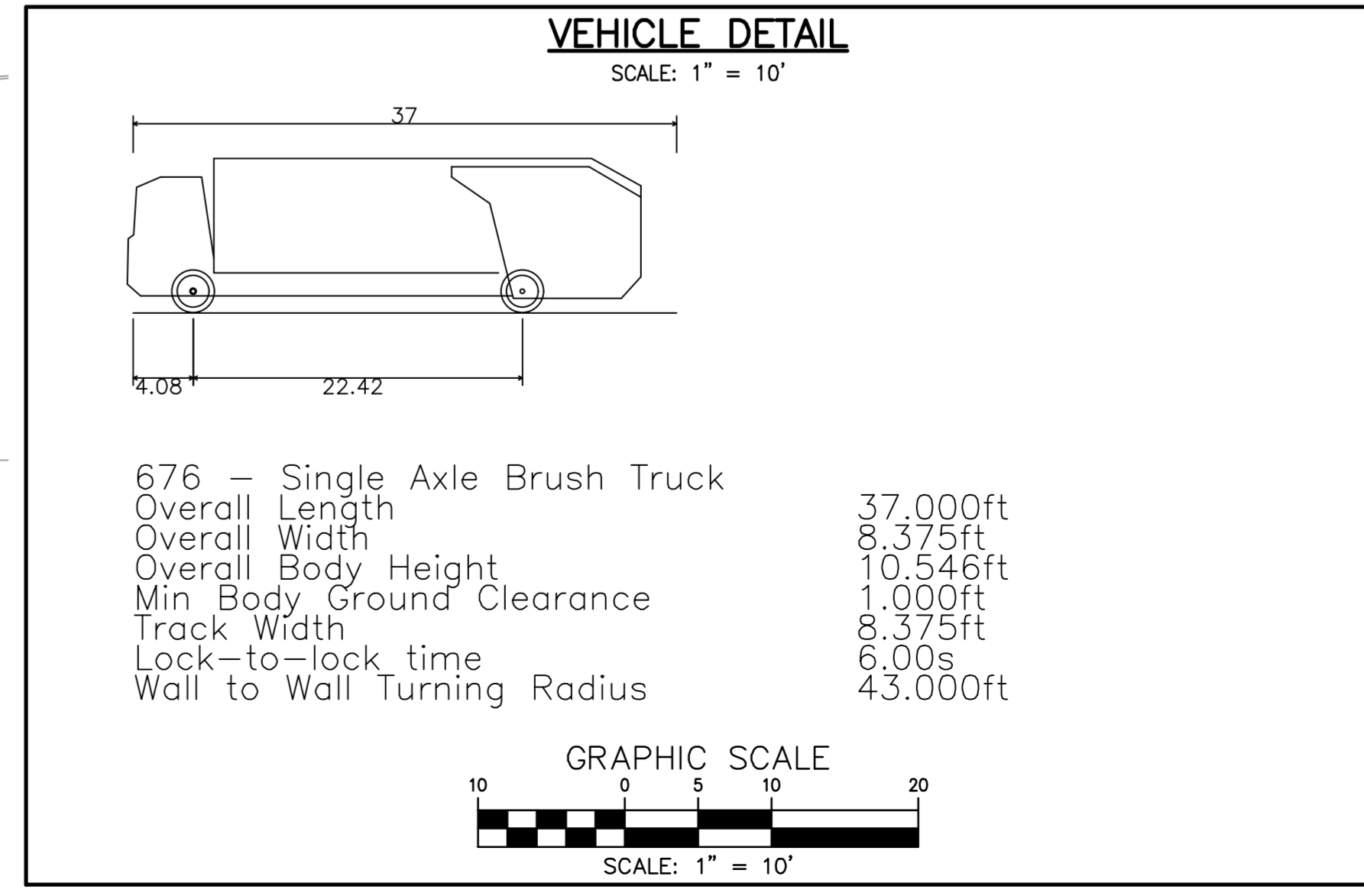
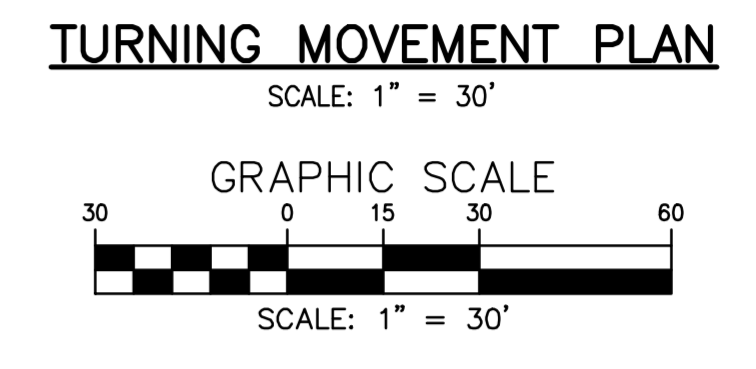
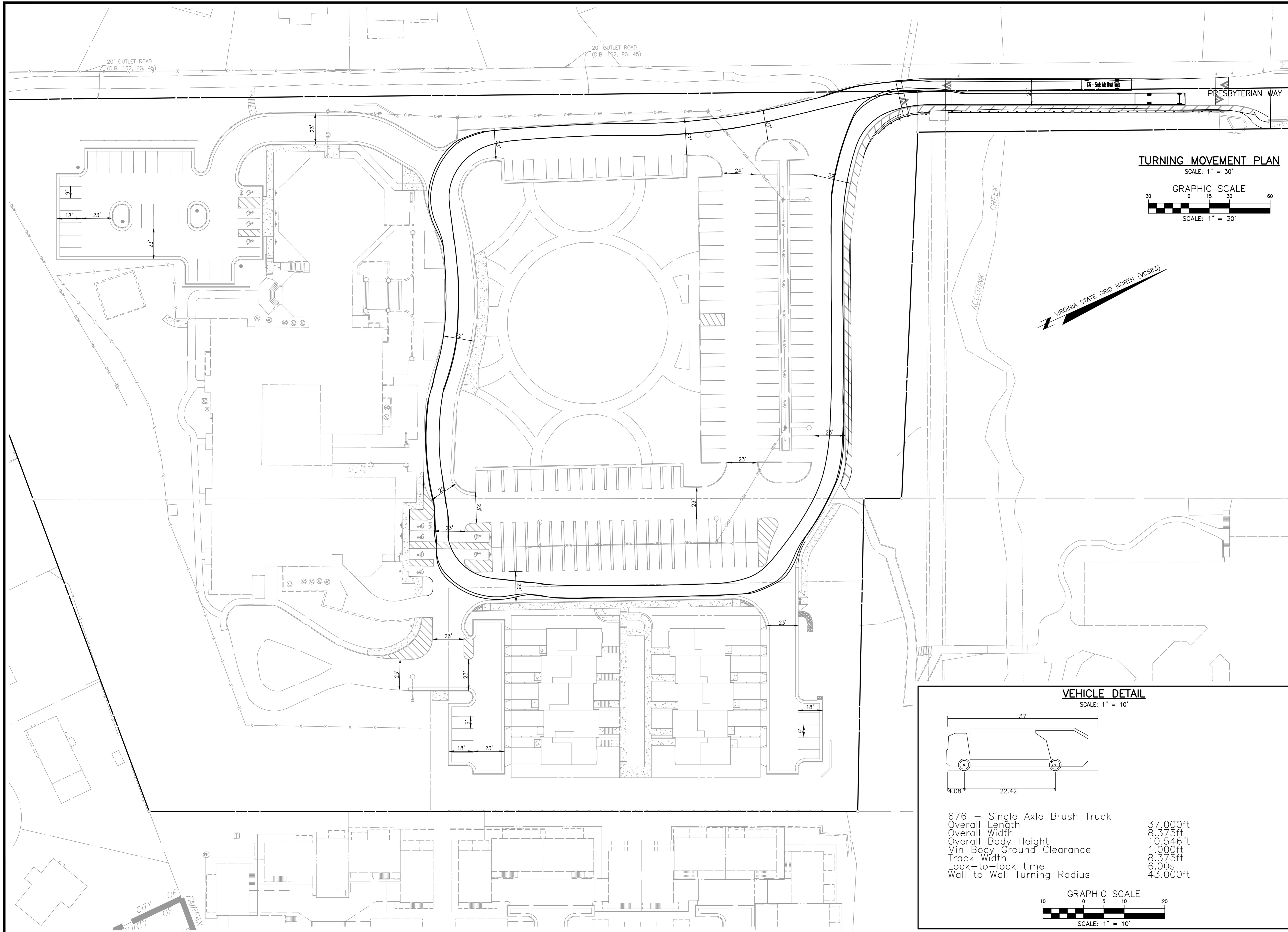

NO. DATE REVISION PRIOR TO APPROVAL

CPJ Charles P. Johnson & Associates, Inc.
Civil and Environmental Engineers • Planners • Landscape Architects • Surveyors
9959 Pender Dr., Ste. 210 Fairfax, VA 22030 703-585-7555 FAX: 703-273-8995
www.cpjassoc.com • Chantilly, VA • Annapolis, MD • Greenbelt, MD • Frederick, MD • Fairfax, VA

TURNING MOVEMENTS: BRUSH TRUCK

**FAIRFAX
PRESBYTERIAN
CHURCH**

CITY OF FAIRFAX, VIRGINIA

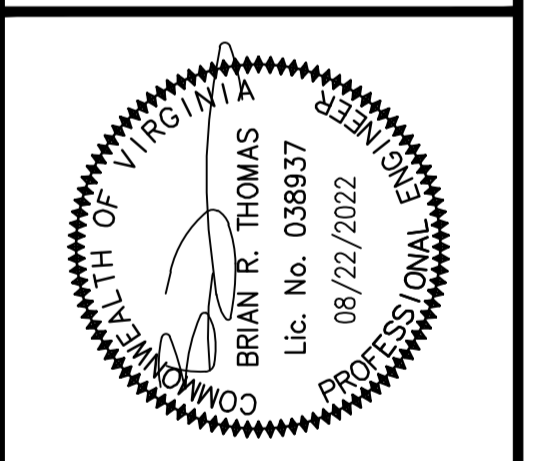

DESIGN	DRAFT	JURS	DATE	SCALE	DESCRIPTION	REVISIONS
			JUNE 2021	AS		
				AS		
				SHOWN		

REVIEW APPROV. DATE BY

SHEET 23 OF 52

PRJ NO: 2017-2570

TYPE: MDP

Attached Xrefs: 00-60700/00-60600/XREF-R0301/XREF-R0401/XREF-R0301/SEA/SEA/SIGNATURE/SIGNATURE DATE

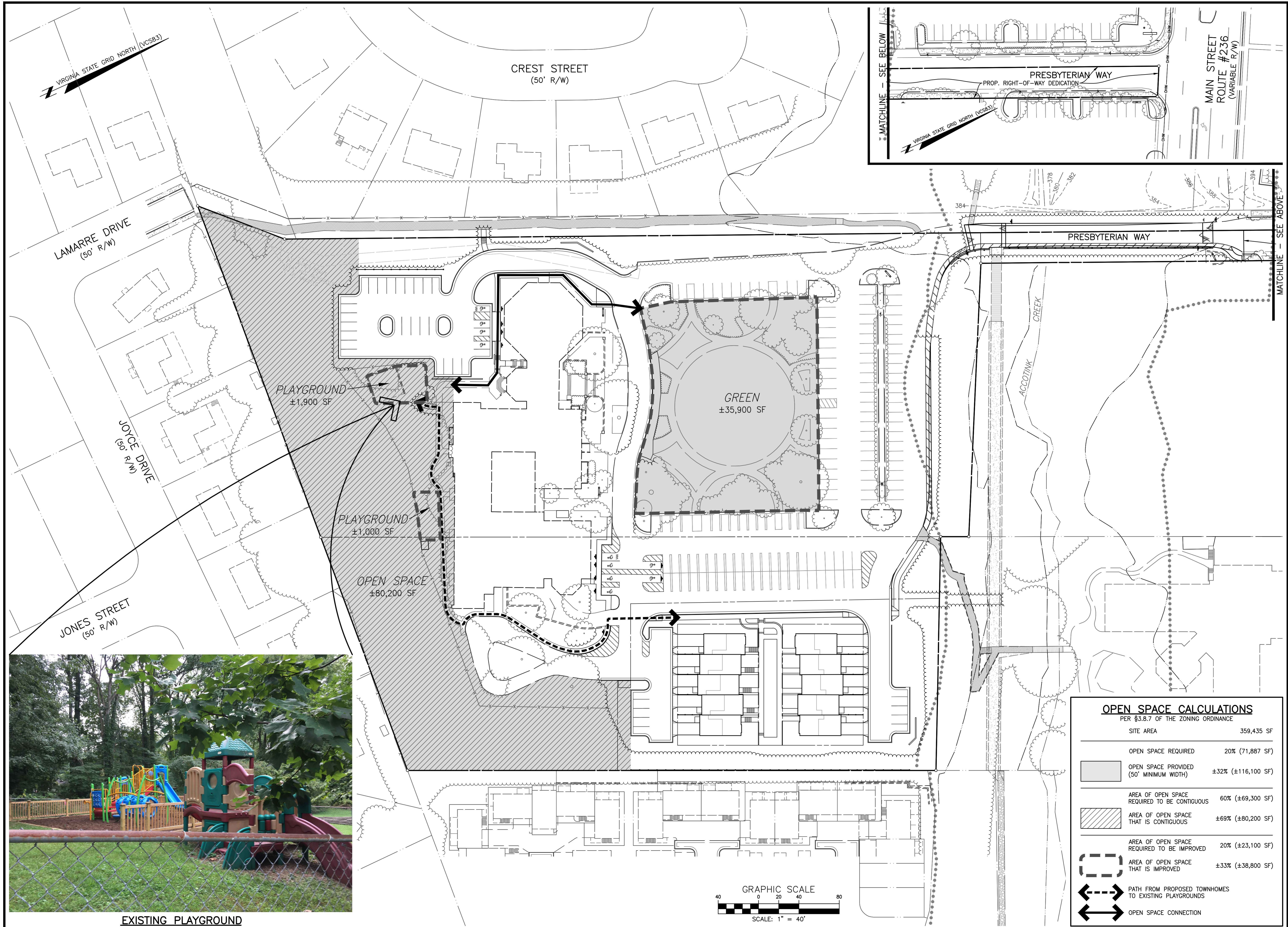

EXISTING PLAYGROUND

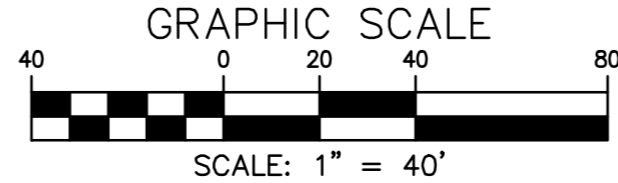

OPEN SPACE CALCULATIONS	
PER §3.8.7 OF THE ZONING ORDINANCE	
SITE AREA	359,435 SF
OPEN SPACE REQUIRED	20% (71,887 SF)
OPEN SPACE PROVIDED (50' MINIMUM WIDTH)	±32% (±116,100 SF)
AREA OF OPEN SPACE REQUIRED TO BE CONTIGUOUS	60% (±69,300 SF)
AREA OF OPEN SPACE THAT IS CONTIGUOUS	±69% (±80,200 SF)
AREA OF OPEN SPACE REQUIRED TO BE IMPROVED	20% (±23,100 SF)
AREA OF OPEN SPACE THAT IS IMPROVED	±33% (±38,800 SF)
 PATH FROM PROPOSED TOWNHOMES TO EXISTING PLAYGROUNDS	
 OPEN SPACE CONNECTION	

REVISION PRIOR TO APPROVAL

NO.	DATE	DESCRIPTION

CPJ Charles P. Johnson & Associates, Inc.
 Civil and Environmental Engineers • Planners • Landscape Architects • Surveyors
 ASSOCIATES
 9909 Pender Dr., Ste. 210 Fairfax, VA 22030 703-585-7555 FAX: 703-273-8995
 www.cpjassoc.com • Charlottesville, VA • Alexandria, VA • Annapolis, MD • Frederick, MD • Fairfax, VA

RECREATION & OPEN SPACE PLAN

FAIRFAX PRESBYTERIAN CHURCH

CITY OF FAIRFAX, VIRGINIA

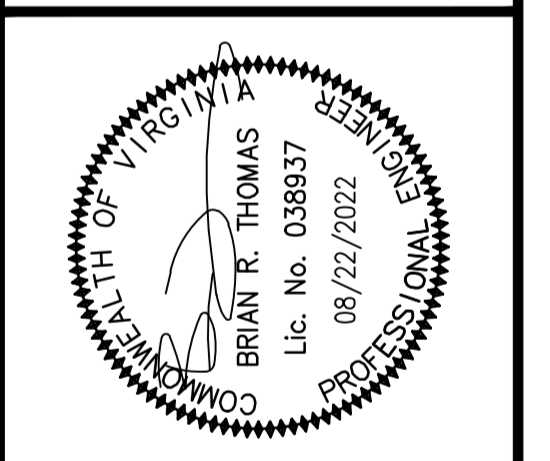

DESIGN	DRAWN	DATE	SCALE	NO.
KJV	HMF	JAN. 2021	1" = 40'	40
APPROVED	DATE <td>SCALE <td>HORIZ. 1" = 40'</td> <td>40</td> </td>	SCALE <td>HORIZ. 1" = 40'</td> <td>40</td>	HORIZ. 1" = 40'	40

SHEET 25 OF 52
 PRJ NO: 2017-2570
 TYPE: MDP

