

LEGEND	
	EXISTING PAVED WALK NOT WITHIN RIGHT-OF-WAY OR EASEMENT
	EXISTING PAVED SIDEWALK OR TRAIL
	EXISTING STONE DUST TRAIL
	EXISTING CROSSWALK
	PROPOSED PAVED SIDEWALK
	FUTURE JUDICIAL DR. TRAIL CONNECTION
	EXISTING CUE BUS STOP
	EXISTING TRAFFIC SIGNAL

NEIGHBORHOOD PEDESTRIAN CONNECTION PLAN

FAIRFAX PRESBYTERIAN CHURCH

CITY OF FAIRFAX, VIRGINIA

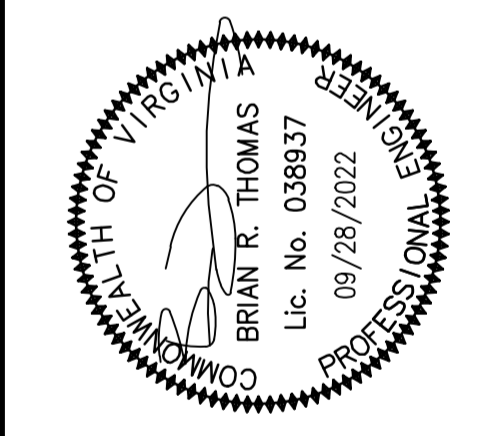

DESIGN	KJV	DATE	JAN. 2021
DRAWN	KJV	DATE	JAN. 2021
APPROVED	HMF	DATE	JAN. 2021
SHEET		OF	
28		53	
PRJ NO: 2017-2570			
TYPE: MDP			

NO. DATE REVISION PRIOR TO APPROVAL

CPJ Charles P. Johnson & Associates, Inc.
 Associates
 Civil and Environmental Engineers • Planners • Landscape Architects • Surveyors
 9959 Pender Dr., Ste. 210 Fairfax, VA 22030 703-585-7555 FAX: 703-273-8995
 www.cpj.com • Chantilly, VA • Gaithersburg, MD • Greenbelt, MD • Frederick, MD • Fairfax, VA

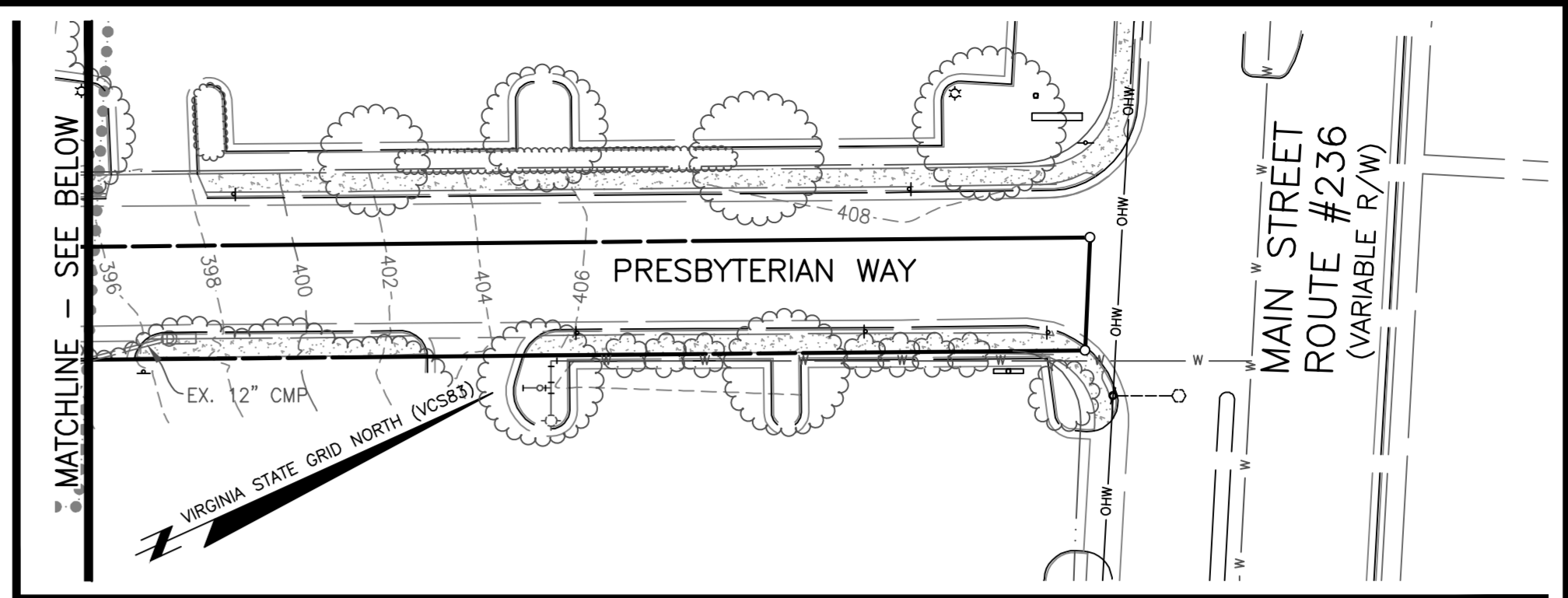

VIRGINIA STATE GRID NORTH (VCS83)

CREST STREET
(50' R/W)

LAMARRE DRIVE
(50' R/W)

JOYCE DRIVE
(50' R/W)

JONES STREET
(50' R/W)

MATCHLINE - SEE ABOVE

MATCHLINE - SEE BELOW

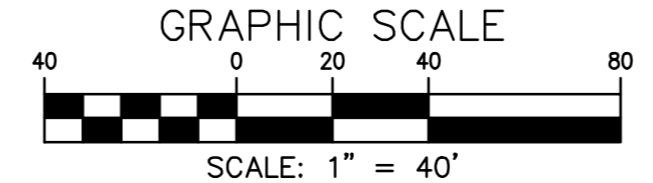

DESIGN		APPROVED		DATE	
DESIGN	KJV	APPROVED	HMF	DATE	JAN. 2021
LEGEND		LIMITS OF CLEARING & GRADING			
---		EXISTING TREELINE			
●		EXISTING TREE			

REVISION PRIOR TO APPROVAL

NO.	DATE	DESCRIPTION

CPJ Charles P. Johnson & Associates, Inc.
 Civil and Environmental Engineers • Planners • Landscape Architects • Surveyors
 ASSOCIATES
 999 Pender Dr., Ste. 210 Fairfax, VA 22039 703-585-7555 FAX: 703-273-8995
 www.cpj.com • Charlottesville, VA • Charlottesville, VA • Annapolis, MD • Greenbelt, MD • Frederick, MD • Fairfax, VA

TREE SURVEY

FAIRFAX PRESBYTERIAN CHURCH

CITY OF FAIRFAX, VIRGINIA

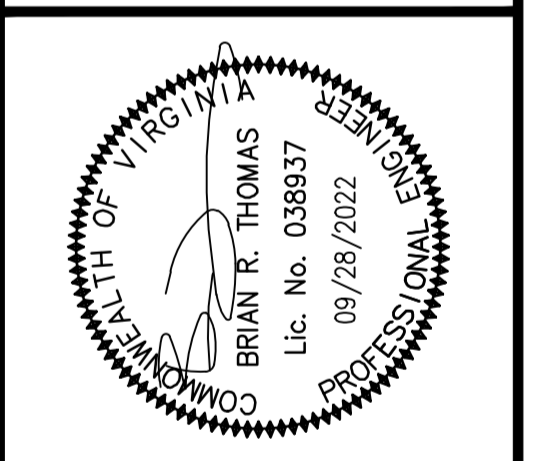

REVISIONS	NO.	DESCRIPTION	DATE	BY

DESIGN	KJV	APPROVED	HMF	DATE	JAN. 2021
SHEET		OF		40	
29		53			
PRJ NO: 2017-2570					
TYPE: MDP					

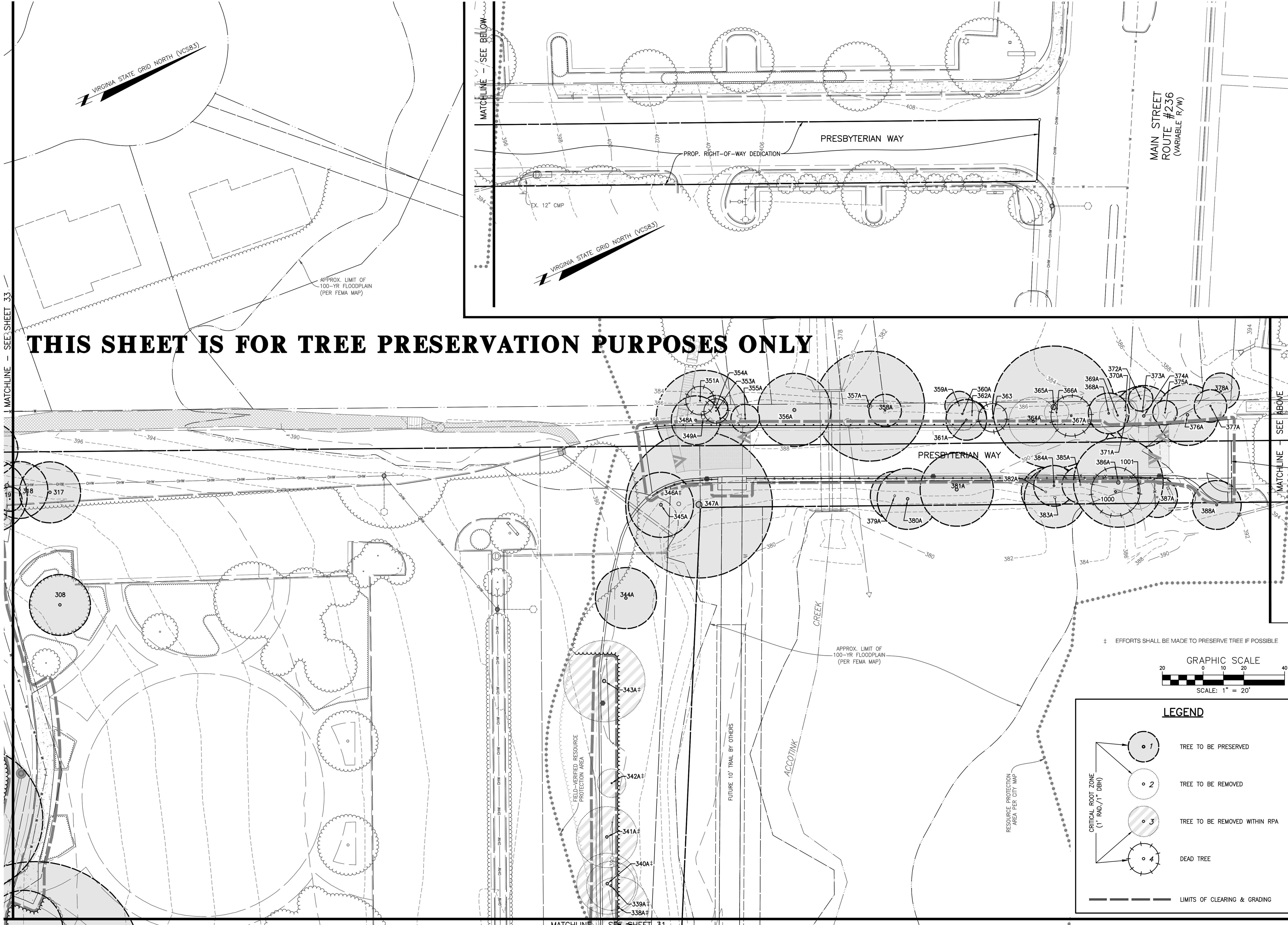

THIS SHEET IS FOR TREE PRESERVATION PURPOSES ONLY

MATCHLINE - SEE SHEET 33

MATCHLINE - SEE BELOW

MATCHLINE - SEE ABOVE

MATCHLINE - SEE SHEET 31

VIRGINIA STATE GRID NORTH (VCS83)

VIRGINIA STATE GRID NORTH (VCS83)

APPROX. LIMIT OF 100-YR FLOODPLAIN (PER FEMA MAP)

APPROX. LIMIT OF 100-YR FLOODPLAIN (PER FEMA MAP)

MAIN STREET ROUTE #236 (VARIABLE R/W)

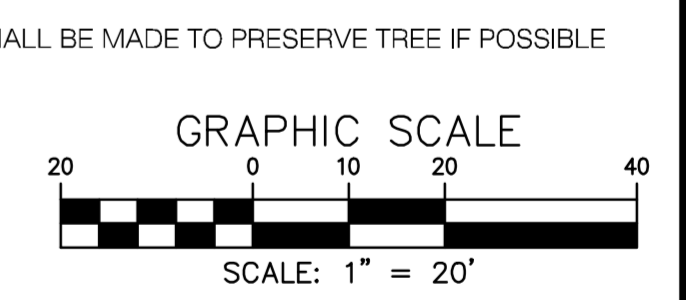

LEGEND

- TREE TO BE PRESERVED
- TREE TO BE REMOVED
- TREE TO BE REMOVED WITHIN RPA
- DEAD TREE
- LIMITS OF CLEARING & GRADING

CRITICAL ROOT ZONE (1' RAD./1" DBH)

RESOURCE PROTECTION AREA PER CITY MAP

FIELD-VERIFIED RESOURCE PROTECTION AREA

FUTURE 10' TRAIL BY OTHERS

ACCOTINK CREEK

NO. DATE REVISION PRIOR TO APPROVAL

CPJ Charles P. Johnson & Associates, Inc.
 Civil and Environmental Engineers • Planners • Landscape Architects • Surveyors
 999 Pender Dr., Ste. 210 Fairfax, VA 22039 703-585-7555 FAX: 703-273-8995
 www.cpjassoc.com • Charlottesville, VA • Alexandria, VA • Annapolis, MD • Frederick, MD • Fairfax, VA

TREE MANAGEMENT PLAN

FAIRFAX PRESBYTERIAN CHURCH

CITY OF FAIRFAX, VIRGINIA

COMMONWEALTH OF VIRGINIA

BRIAN R. THOMAS
 Lic. No. 038937
 09/28/2022

PROFESSIONAL ENGINEER

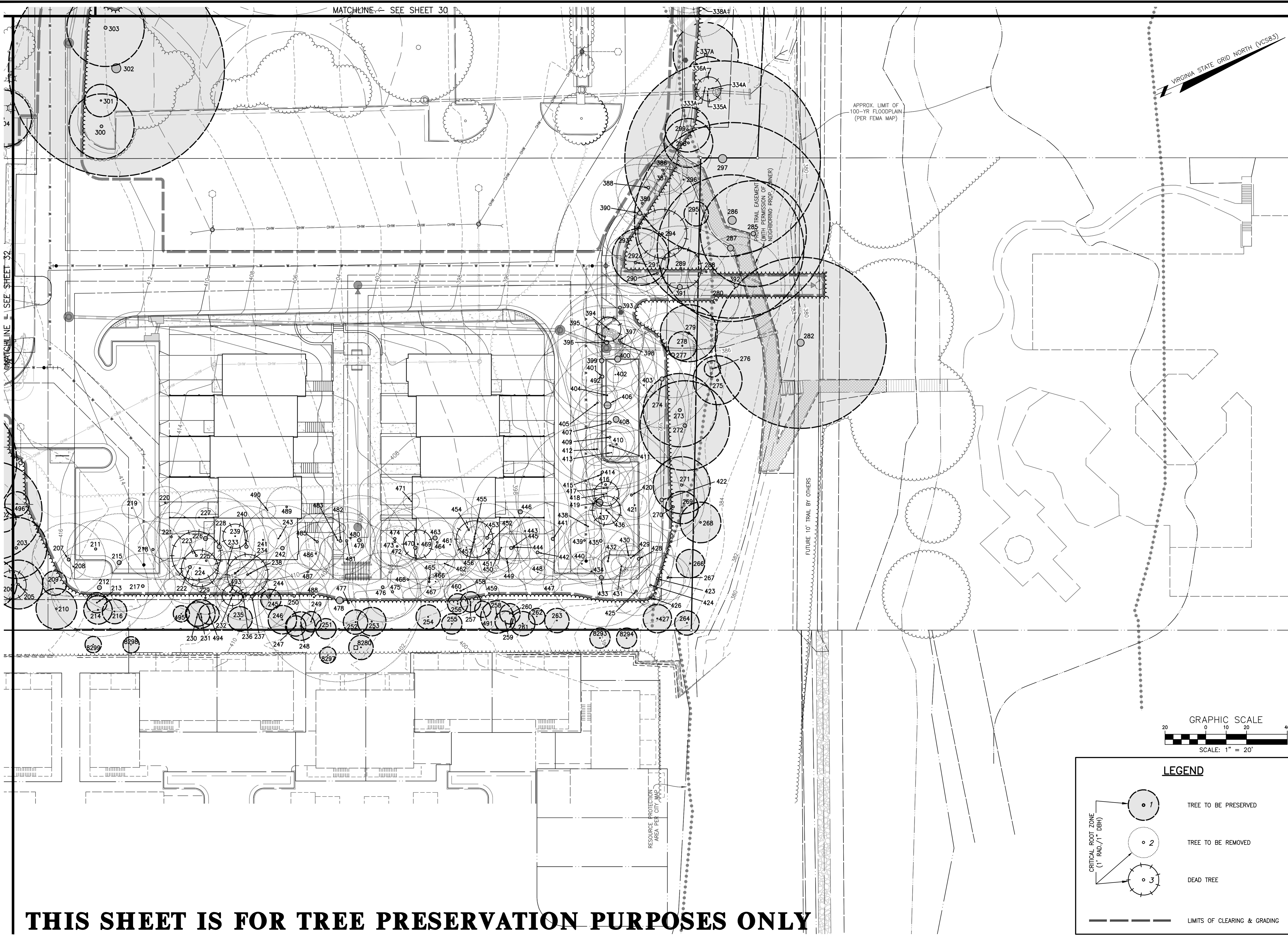

DESIGN	DRAWN	DATE	SCALE	HORIZ. 1" = 20'	VERT. 1" = 20'	REVISIONS	NO.	DATE	BY
KJV	KJV	JAN. 2021	AS SHOWN						
APPROVED	HMF								
SHEET 30 OF 53									
PRJ NO: 2017-2570									
TYPE: MDP									

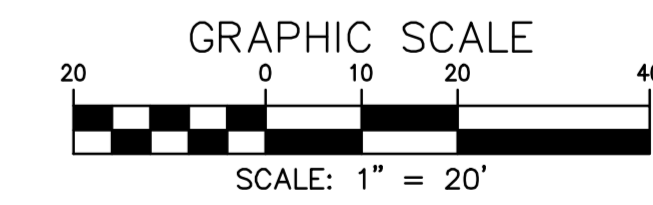

THIS SHEET IS FOR TREE PRESERVATION PURPOSES ONLY

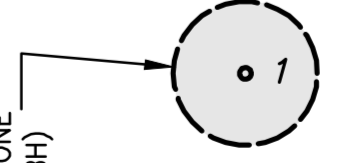
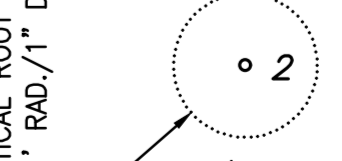
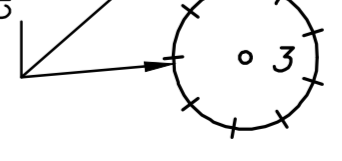

LEGEND

-  TREE TO BE PRESERVED
-  TREE TO BE REMOVED
-  DEAD TREE
-  LIMITS OF CLEARING & GRADING

NO. DATE REVISION PRIOR TO APPROVAL

CPJ Charles P. Johnson & Associates, Inc.
 Civil and Environmental Engineers • Planners • Landscape Architects • Surveyors
 Associates
 9909 Pender Dr., Ste. 210 Fairfax, VA 22030 703-585-7555 Fax: 703-273-8995
 www.cpj.com • Charlottesville, VA • Charlottesville, VA • Annapolis, MD • Frederick, MD • Fairfax, VA

TREE MANAGEMENT PLAN

FAIRFAX PRESBYTERIAN CHURCH

CITY OF FAIRFAX, VIRGINIA

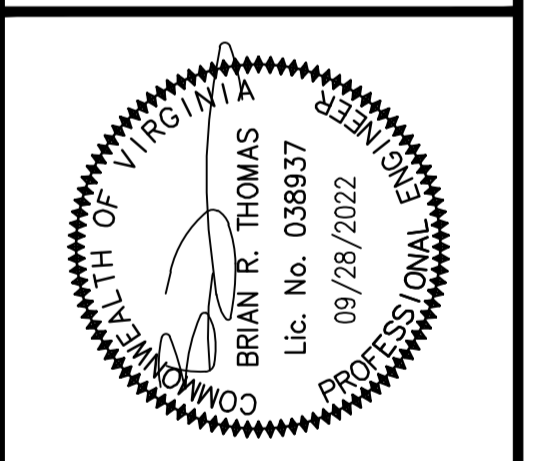

DESIGN	DATE	SCALE	HORIZ. 1" = 20'	VERT. 1" = 20'
DESIGN: KJV	JAN. 2021			
APPROVED: HMF				
SHEET 31 OF 53				
PRJ NO: 2017-2570				
TYPE: MDP				



MATCHLINE - SEE SHEET 33

VIRGINIA STATE GRID NORTH (VCS83)

JONES STREET
(50' R/W)

MATCHLINE - SEE SHEET 31

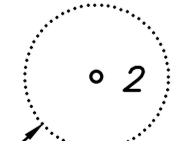
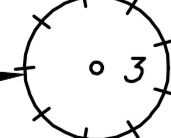
LEGEND

-  TREE TO BE PRESERVED
-  TREE TO BE REMOVED
-  DEAD TREE
-  LIMITS OF CLEARING & GRADING

CRITICAL ROOT ZONE
(1" RAD./1" DBH)

THIS SHEET IS FOR TREE PRESERVATION PURPOSES ONLY

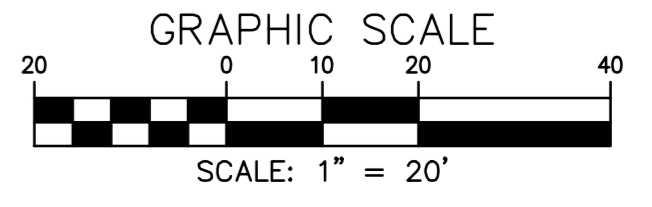

NO. DATE REVISION PRIOR TO APPROVAL

CPJ Charles P. Johnson & Associates, Inc.
civil and environmental Engineers • Planners • Landscape Architects • Surveyors
9959 Pender Dr., Ste. 210 Fairfax, VA 22030 703-585-7555 FAX: 703-273-8995
www.cpjassoc.com • Charlottesville, VA • Charlottesville, VA • Greenbelt, MD • Frederick, MD • Fairfax, VA

TREE MANAGEMENT PLAN

**FAIRFAX
PRESBYTERIAN
CHURCH**

CITY OF FAIRFAX, VIRGINIA

COMMONWEALTH OF VIRGINIA
BRIAN R. THOMAS
Lic. No. 038937
09/28/2022
PROFESSIONAL ENGINEER

DESIGN	DRAFT	APPROVED	DATE	SCALE	HORIZ.	VERT.	DESCRIPTION	REVISIONS	REVIEW	APPROV.	DATE
KJV	KJV	HMF	JAN. 2021	1" = 20'							
<p>00-60700/00-60500/XREF-R0401/XREF-R0301/RZ SEAL/RZ SIGNATURE/RZ SIGNATURE DATE</p> <p>Attached Xrefs: 00-60700/00-60500/XREF-R0401/XREF-R0301/RZ SEAL/RZ SIGNATURE/RZ SIGNATURE DATE</p>											
<p>SHEET 32 OF 53</p> <p>PRJ NO: 2017-2570</p> <p>TYPE: MDP</p>											

THIS SHEET IS FOR TREE PRESERVATION PURPOSES ONLY

VIRGINIA STATE GRID NORTH (VCS83)

LEGEND

- 1 TREE TO BE PRESERVED
- 2 TREE TO BE REMOVED
- 3 DEAD TREE
- LIMITS OF CLEARING & GRADING

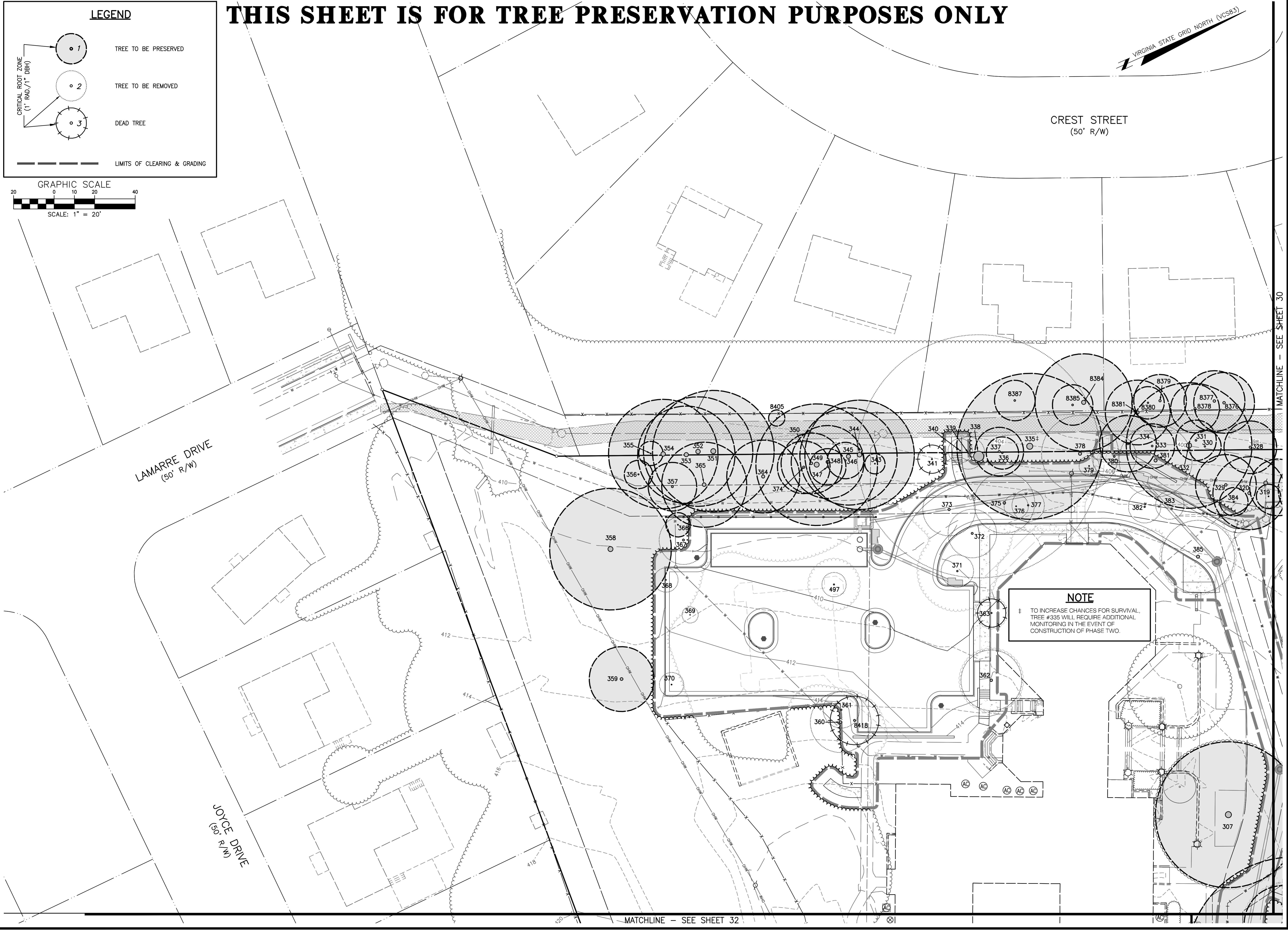
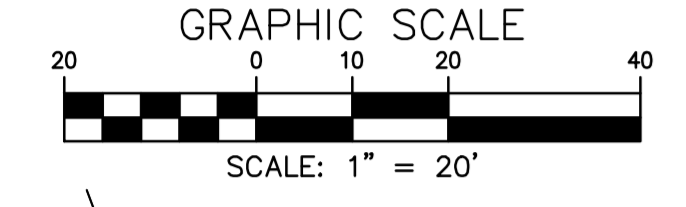

NOTE
 † TO INCREASE CHANCES FOR SURVIVAL, TREE #335 WILL REQUIRE ADDITIONAL MONITORING IN THE EVENT OF CONSTRUCTION OF PHASE TWO.

TREE MANAGEMENT PLAN
FAIRFAX PRESBYTERIAN CHURCH
 CITY OF FAIRFAX, VIRGINIA

CPJ Charles P. Johnson & Associates, Inc.
 Civil and Environmental Engineers • Planners • Landscape Architects • Surveyors
 9959 Pender Dr., Ste. 210 Fairfax, VA 22030 703-385-7555 Fax: 703-273-8995
 www.cpjinc.com • Charlottesville, VA • Charlottesville, VA • Charlottesville, VA • Charlottesville, VA • Charlottesville, VA

TREE MANAGEMENT PLAN
FAIRFAX PRESBYTERIAN CHURCH
 CITY OF FAIRFAX, VIRGINIA

COMMONWEALTH OF VIRGINIA
 BRYAN R. THOMAS
 Lic. No. 038937
 09/28/2022
 PROFESSIONAL ENGINEER

DESIGN	DRAWN	DATE	SCALE	REVISIONS
KJV	KJV	JAN. 2021	HORIZ: 1" = 20'	
APPROVED	HMF		VERT: ---	
SHEET 33 OF 53 PRJ NO: 2017-2570 TYPE: MDP				

TREE INVENTORY

FAIRFAX PRESBYTERIAN CHURCH

CITY OF FAIRFAX, VIRGINIA

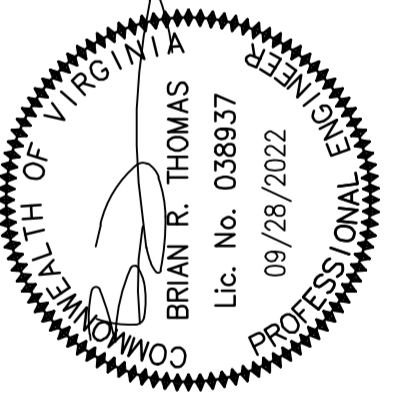

TREE INVENTORY - Townhouses at Fairfax Presbyterian Church

Tree #	Species	Size dbh	Condition %	Crown Radius (ft)	Avg. Radius (ft)	Dead Tree	Poor Condition	Off Site/Co-Owned	Status
333A	Black Cherry	7	63	8			X		Preserve
334A	Unknown	6	0	0		X			Preserve
335A	Red Maple	5	68	8					Preserve
336A	Red Maple	10	75	10					Preserve
337A	Red Maple	16	72	10					Preserve
338A	Honeylocust	15	68	10					Remove
339A	American Elm	12	68	10					Remove
340A	Honeylocust	15	68	10					Remove
341A	Honeylocust	15	75	15					Remove
342A	White Mulberry	7	75	15					Remove
343A	Tulip Poplar	20	68	15					Remove
344A	Tulip Poplar	15	68	10					Preserve
345A	Red Maple	10.6	72	15					Preserve
346A	Red Maple	24	78	20					Preserve
347A	Honeylocust	12,12,12	59	5		X			Preserve
348A	Red Maple	12	68	10					Preserve
349A	Red Maple	13,10	68	10					Preserve
351A	Unknown	7	0	0		X			Preserve
353A	Unknown	6	0	0		X			Preserve
354A	Honeylocust	18	59	5		X			Preserve
355A	White Ash	27	63	10		X			Preserve
356A	Red Maple	18	68	20					Preserve
357A	American Elm	9,9,9	65	20					Preserve
358A	Red Maple	8	56	5		X			Preserve
359A	Red Maple	7	56	5					Preserve
360A	Red Maple	8	63	5					Preserve
361A	Red Maple	10	63	5					Preserve
362A	Red Maple	7	63	5					Preserve
363A	Unknown	7	0	0		X			Preserve
364A	Red Maple	12	72	10					Preserve
365A	American Elm	30	72	10					Preserve
366A	Red Maple	6	72	10					Preserve
367A	Unknown	10	0	0		X			Preserve
368A	Red Maple	10	72	5					Preserve
369A	American Elm	9	75	8					Preserve
370A	American Elm	6	75	8					Preserve
371A	Red Maple	6.6	75	10					Preserve
372A	American Elm	6	75	10					Preserve
373A	Red Maple	8	75	10					Preserve
374A	American Elm	15	72	9					Preserve
375A	Red Maple	6	75	10					Preserve
376A	American Elm	15	69	20					Preserve
377A	Red Maple	8	78	15					Preserve
378A	American Elm	9	75	10					Preserve
379A	Red Maple	12	72	10					Preserve
380A	Red Maple	15	72	10					Preserve
381A	Tulip Poplar	18	72	15					Preserve
382A	American Elm	12	75	20					Preserve
383A	American Elm	15	75	10					Preserve
384A	Honeylocust	10	72	10					Preserve
385A	American Elm	9	69	5		X			Preserve
386A	Red Maple	22	63	20		X			Preserve
387A	Littleleaf Linden	10	72	10					Preserve
388A	Littleleaf Linden	12	81	15					Preserve
1000	Unknown	12	0	0		X			Preserve
1001	American Elm	8	72	10					Preserve

NOTE :

TOTAL NO. OF TREES INVENTORIED = 351
 TREES TO BE PRESERVED = 165
 TREES TO BE REMOVED = 186

± EFFORTS SHALL BE MADE TO PRESERVE TREE IF POSSIBLE

dbh = Diameter at Breast Height (measured 4.5 feet above ground).
 * CONDITION RATING - provided as percentages based on methods outlined in the 9th edition of the Guide for Plant Appraisal, published by the International Society of Arboriculture.
 * DEAD TREE - tree is dead or near dead and will likely not survive long term. No tree canopy credit taken.
 * POOR CONDITION TREE - Tree has been assessed with condition of < 40 or Arborist has determined that tree will likely not survive long term due to poor health, structure or other contributing factors.

* OFF SITE/CO-OWNED TREE - Tree is either off site or co-owned or definitive ownership could not be determined during initial tree inventory. Ownership shall be determined during pre-construction phase of development. Removal or arboricultural treatment of off site trees is prohibited without written permission from landowner. Location and diameter measurements are "estimated" and the trees condition "assessed visually" from proposed development site.

Tree Survey Information Completed by Charles P. Johnson & Associates, Inc. - Arborist Rebecca Mitchell - ISA #MA-4668A

DESIGN	DRAFT	DATE	SCALE	HORI.:	VERT.:
KJV	KJV	JAN. 2021	---	---	---
APPROVED	HMF				
SHEET 35 OF 53					
PRJ NO: 2017-2570					
TYPE: MDP					

THIS SHEET IS FOR LANDSCAPE PURPOSES ONLY

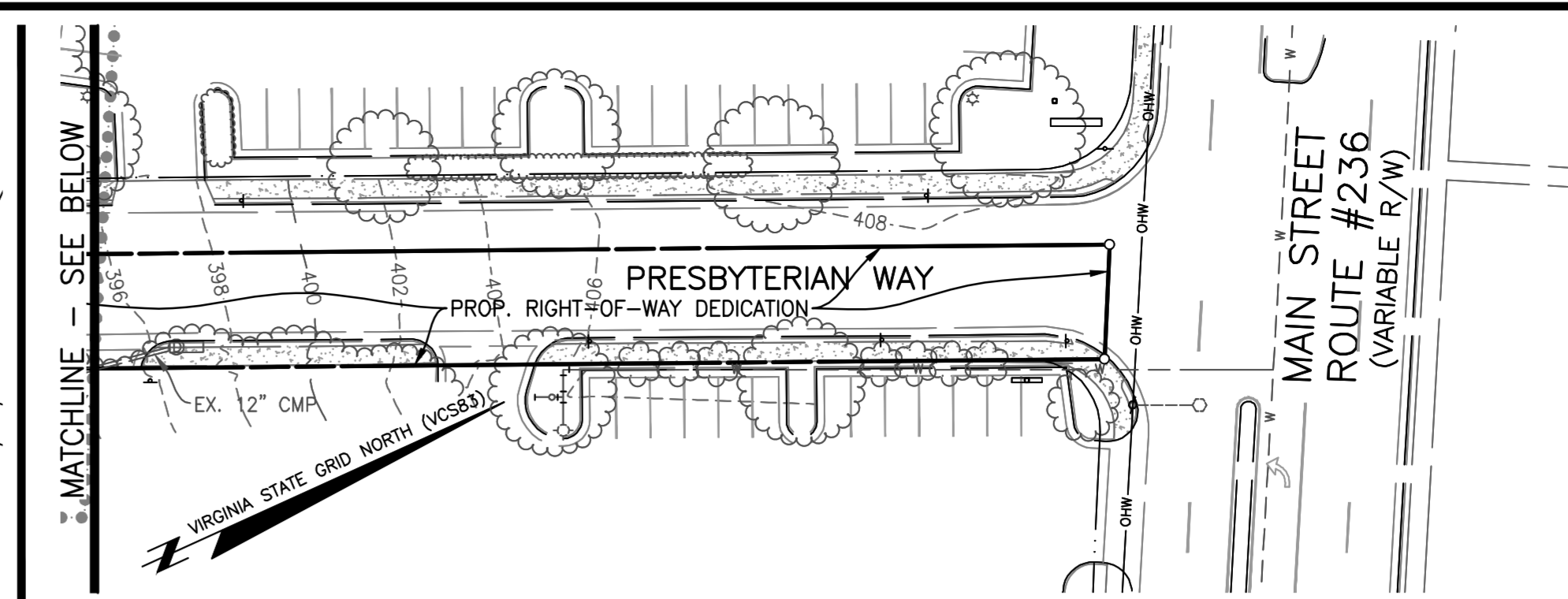
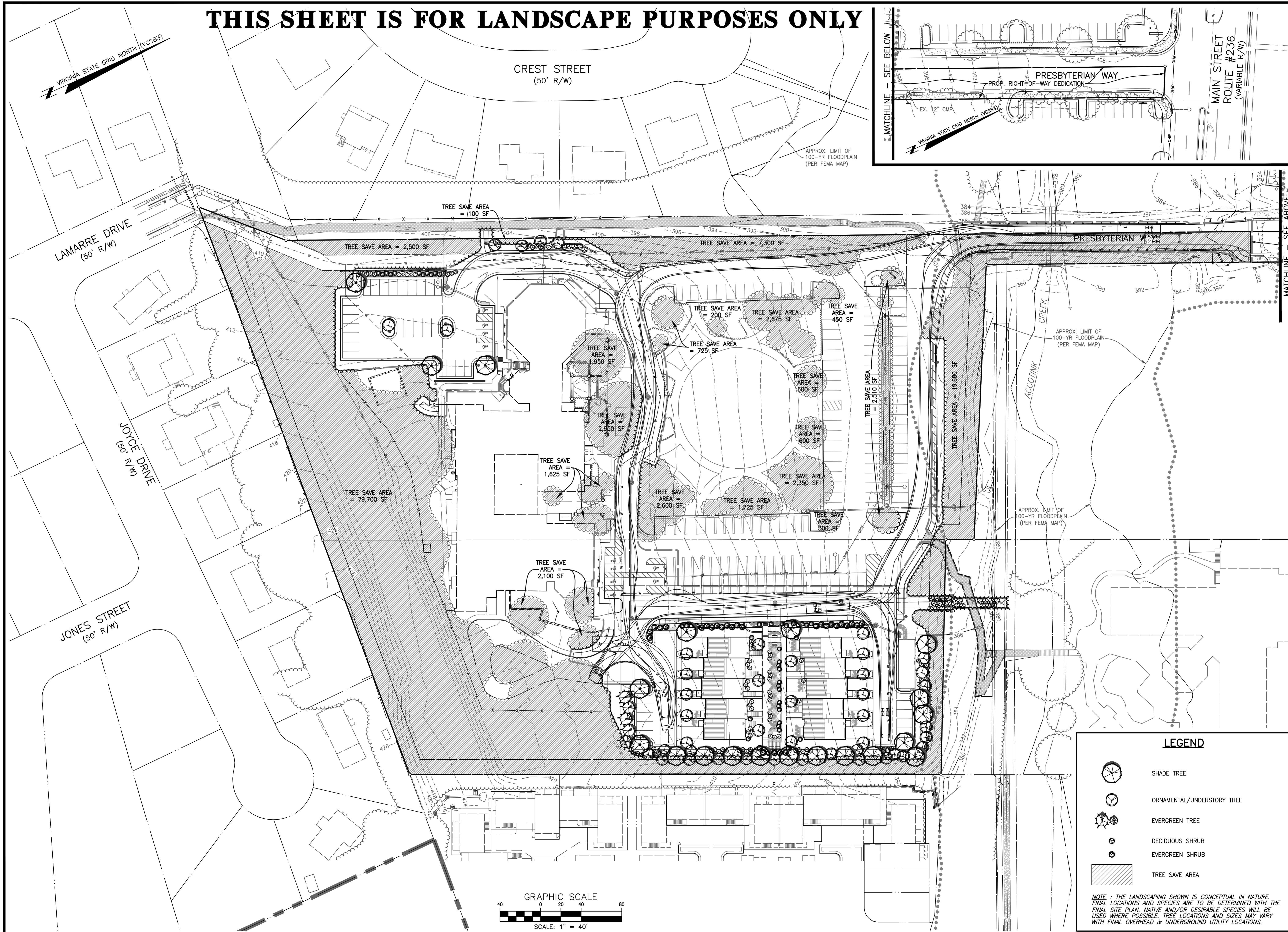

NO. DATE REVISION PRIOR TO APPROVAL

CPJ Charles P. Johnson & Associates, Inc.
 civil and environmental Engineers • Planners • Landscape Architects • Surveyors
 9999 Pender Dr., Ste. 210 Fairfax, VA 22030 703-585-7555 FAX: 703-273-8995
ASSOCIATES
 www.cpj.com • Charlottesville, VA • Charlottesville, VA • Annapolis, MD • Fredericksburg, MD • Fairfax, VA

OVERALL LANDSCAPE PLAN

FAIRFAX PRESBYTERIAN CHURCH

CITY OF FAIRFAX, VIRGINIA

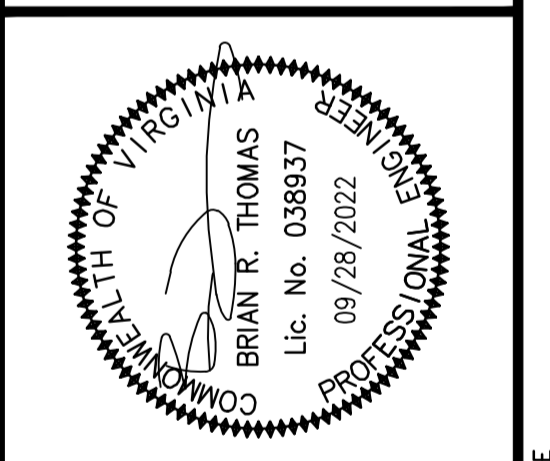

DESIGN	DRAWN	DATE	SCALE	HORIZ.	VERT.	NO.	DESCRIPTION	REVISIONS	BY	DATE
KJV	KJV	JAN. 2021	SCALE			40'				
	HMF									

SHEET 36 OF 53

PRJ NO: 2017-2570

TYPE: MDP

LEGEND

- SHADE TREE
- ORNAMENTAL/UNDERSTORY TREE
- EVERGREEN TREE
- DECIDUOUS SHRUB
- EVERGREEN SHRUB
- TREE SAVE AREA

NOTE: THE LANDSCAPING SHOWN IS CONCEPTUAL IN NATURE. FINAL LOCATIONS AND SPECIES ARE TO BE DETERMINED WITH THE FINAL SITE PLAN. NATIVE AND/OR DESIRABLE SPECIES WILL BE USED WHERE POSSIBLE. TREE LOCATIONS AND SIZES MAY VARY WITH FINAL OVERHEAD & UNDERGROUND UTILITY LOCATIONS.

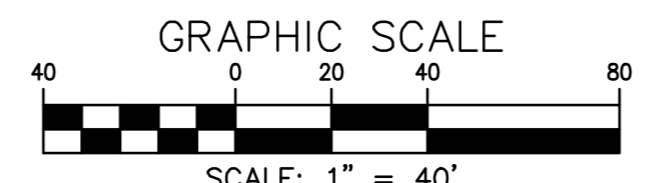

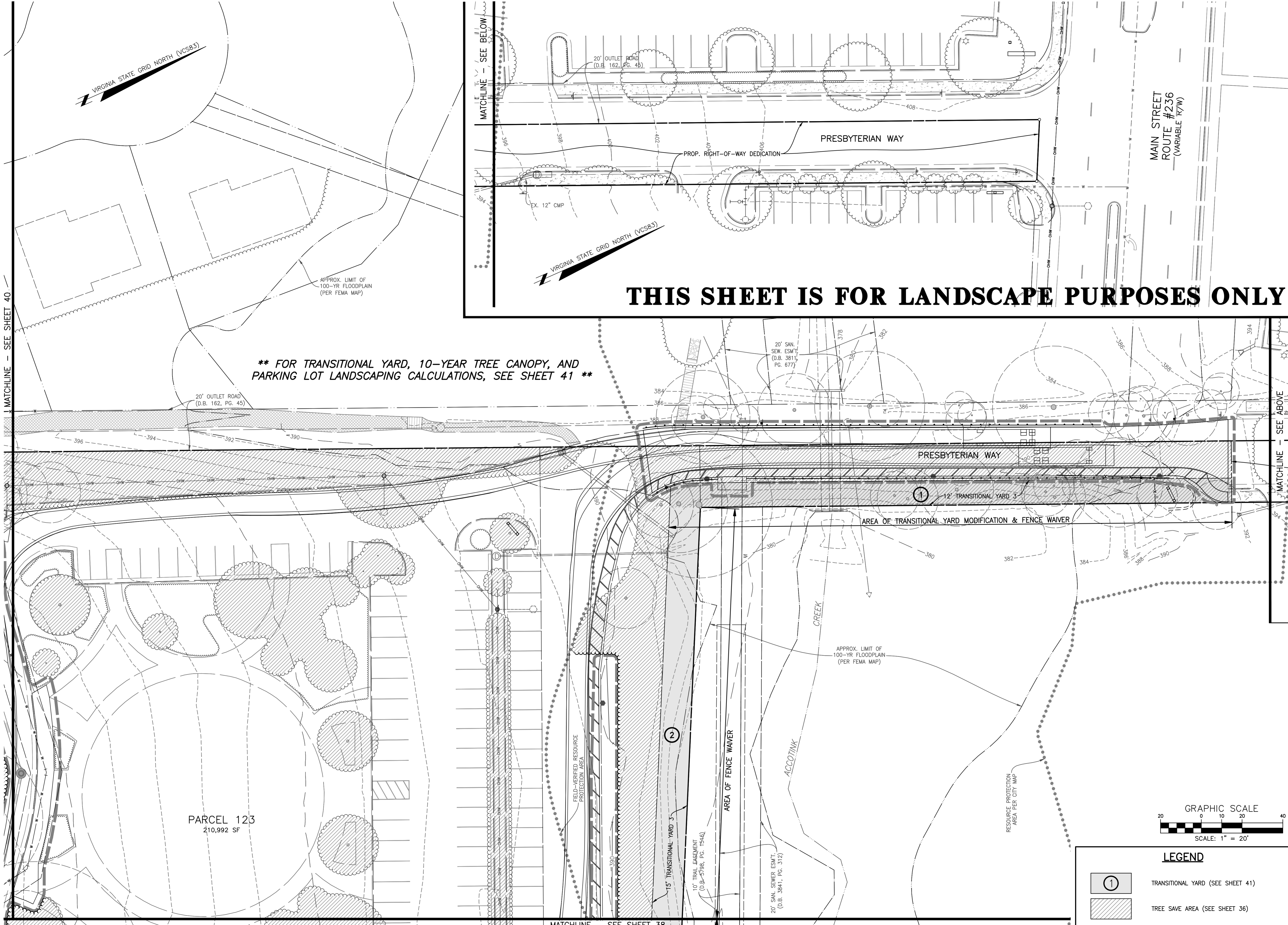

THIS SHEET IS FOR LANDSCAPE PURPOSES ONLY

**** FOR TRANSITIONAL YARD, 10-YEAR TREE CANOPY, AND PARKING LOT LANDSCAPING CALCULATIONS, SEE SHEET 41 ****

PARCEL 123
210,992 SF

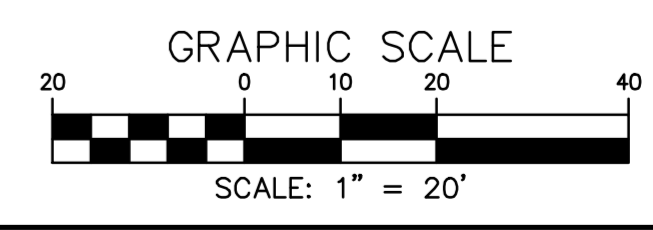

LEGEND	
	TRANSITIONAL YARD (SEE SHEET 41)
	TREE SAVE AREA (SEE SHEET 36)

NO. DATE REVISION PRIOR TO APPROVAL

CPJ Charles P. Johnson & Associates, Inc.
 Associates
 9959 Pender Dr., Ste. 210 Fairfax, VA 22030 703-585-7555 FAX: 703-273-8995
 www.cpjva.com • Charlottesville, VA • Charlottesville, VA • Greenbelt, MD • Frederick, MD • Fairfax, VA

CONCEPTUAL LANDSCAPE PLAN

FAIRFAX PRESBYTERIAN CHURCH

CITY OF FAIRFAX, VIRGINIA

COMMONWEALTH OF VIRGINIA
 BRYAN R. THOMAS
 Lic. No. 038937
 09/28/2022
 PROFESSIONAL ENGINEER

DESIGN	DRAWN	DATE	SCALE	REVISIONS	REVIEW	APPROVED	DATE
KJV	KJV	JAN. 2021	1" = 20'				
HMF	HMF						

SHEET 37 OF 53
 PRJ NO: 2017-2570
 TYPE: MDP

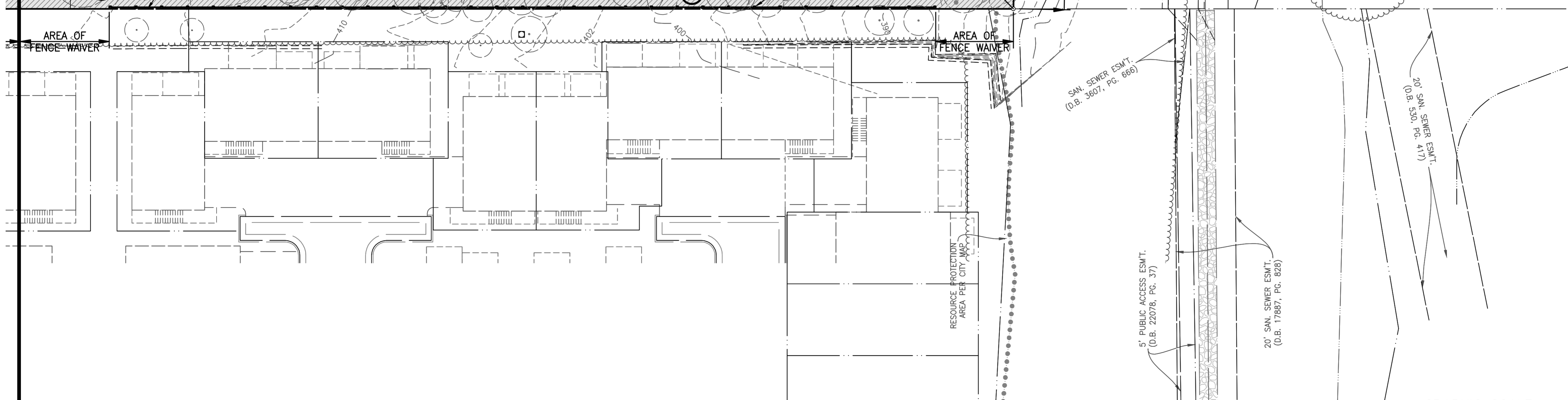
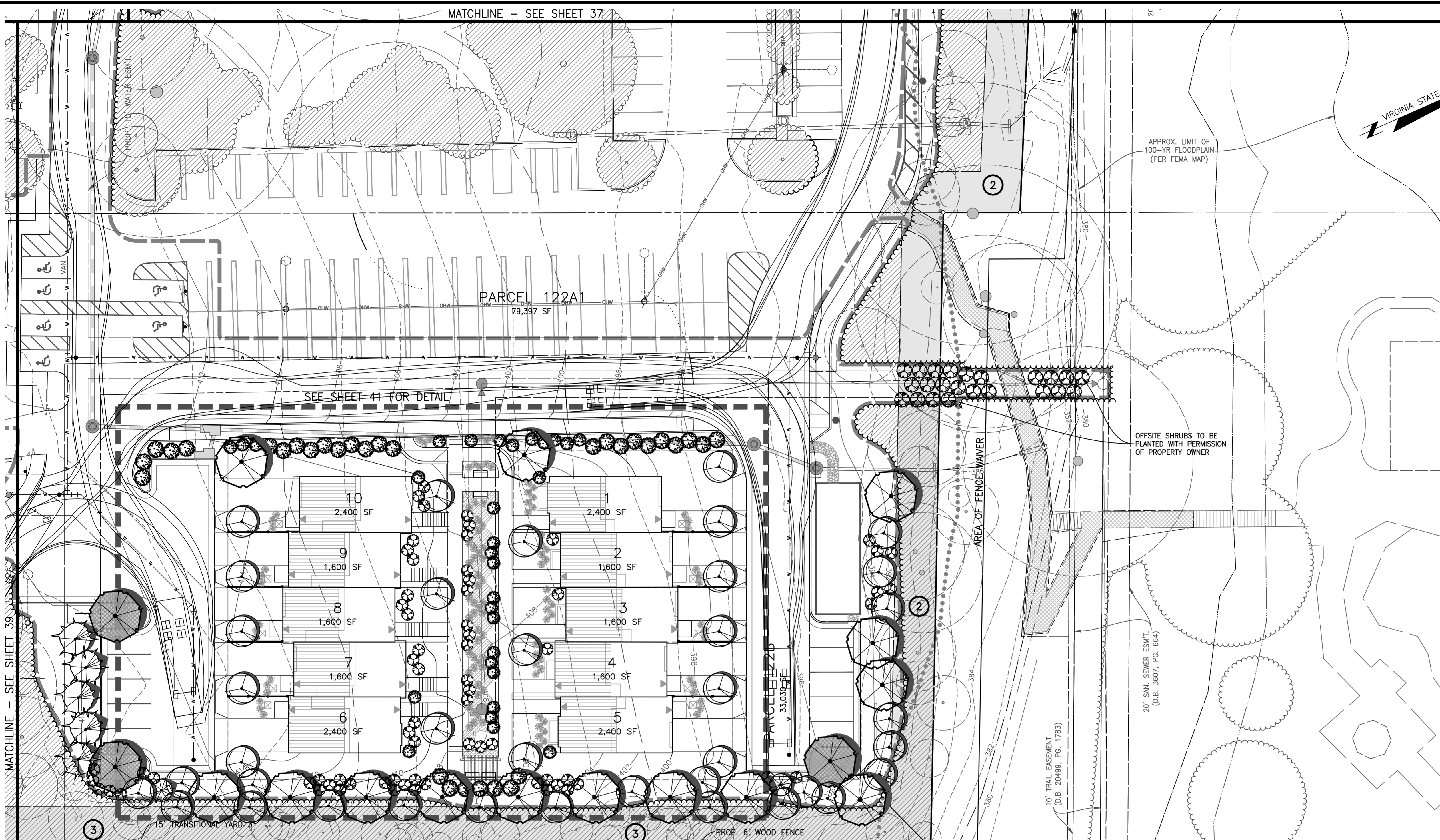

LEGEND

- TREE TO BE PRESERVED (SEE SHEET 30)
- SHADE TREE
- TREE COUNTED TOWARD PARKING LOT LANDSCAPING (SEE SHEET 41)
- ORNAMENTAL/UNDERSTORY TREE
- EVERGREEN TREE
- DECIDUOUS SHRUB
- EVERGREEN SHRUB
- TRANSITIONAL YARD (SEE SHEET 41)
- TREE SAVE AREA (SEE SHEET 36)

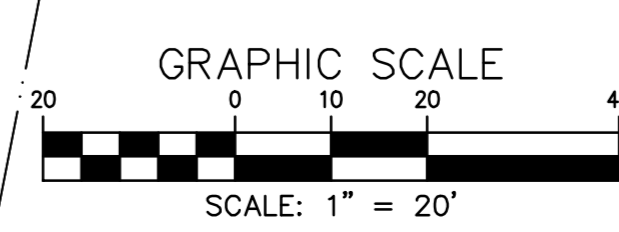

NOTE: THE LANDSCAPING SHOWN IS CONCEPTUAL IN NATURE. FINAL LOCATIONS AND SPECIES ARE TO BE DETERMINED WITH THE FINAL SITE PLAN. NATIVE AND/OR DESIRABLE SPECIES WILL BE USED WHERE POSSIBLE. TREE LOCATIONS AND SIZES MAY VARY WITH FINAL OVERHEAD & UNDERGROUND UTILITY LOCATIONS.

THIS SHEET IS FOR LANDSCAPE PURPOSES ONLY

MATCHLINE - SEE SHEET 39

MATCHLINE - SEE SHEET 37

PARCEL 122A1
79,397 SF

SEE SHEET 41 FOR DETAIL

VIRGINIA STATE GRID NORTH (VCS83)

APPROX. LIMIT OF 100-YR FLOODPLAIN (PER FEMA MAP)

OFFSITE SHRUBS TO BE PLANTED WITH PERMISSION OF PROPERTY OWNER

AREA OF FENCE WAIVER

20' SAN. SEWER ESMT. (O.B. 3607, PG. 664)

10' TRAIL EASEMENT (D.B. 20499, PG. 1783)

SAN. SEWER ESMT. (O.B. 3607, PG. 656)

20' SAN. SEWER ESMT. (O.B. 530, PG. 417)

5' PUBLIC ACCESS ESMT. (D.B. 22078, PG. 37)

20' SAN. SEWER ESMT. (O.B. 17887, PG. 828)

RESOURCE PROTECTION AREA PER CITY MAP

CONCEPTUAL LANDSCAPE PLAN

FAIRFAX PRESBYTERIAN CHURCH

CITY OF FAIRFAX, VIRGINIA

Charles P. Johnson & Associates, Inc.
Civil and Environmental Engineers • Planners • Landscape Architects • Surveyors
9959 Pender Dr., Ste. 210 Fairfax, VA 22030 703-385-7555 Fax: 703-273-8995
www.cpaia.com • Charlottesville, VA • Charlottesville, VA • Greenbelt, MD • Frederick, MD • Fairfax, VA

REVISIONS

NO.	DATE	REVISION

PROFESSIONAL ENGINEER

BRIAN R. THOMAS
Lic. No. 038937
09/28/2022

DESIGN: KJV
DRAFT: KJV
APPROVED: HMF
DATE: JAN. 2021
SCALE: HORIZ: 1" = 20'
VERT: ---

SHEET 38 OF 53

PRJ NO: 2017-2570

TYPE: MDP

MATCHLINE - SEE SHEET 40

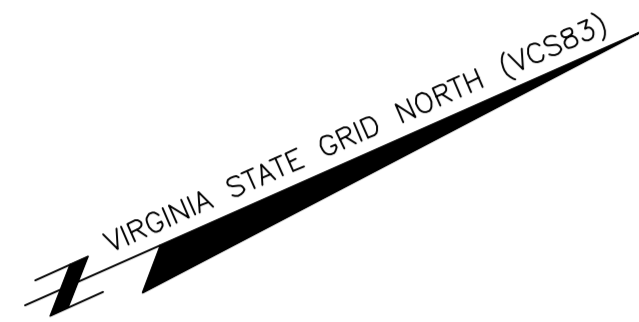

JONES STREET
(50' R/W)

15' TRANSITIONAL YARD 3

AREA OF FENCE WAIVER

MATCHLINE - SEE SHEET 38

AREA OF FENCE WAIVER

LEGEND

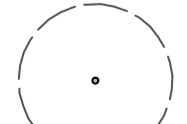
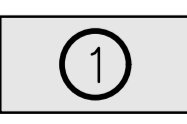
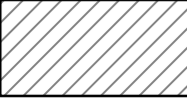
-  TREE TO BE PRESERVED (SEE SHEET 32)
-  TRANSITIONAL YARD (SEE SHEET 41)
-  TREE SAVE AREA (SEE SHEET 36)

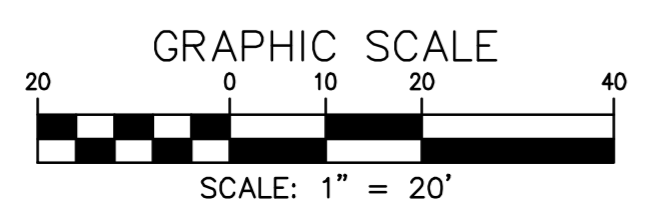

THIS SHEET IS FOR LANDSCAPE PURPOSES ONLY

CONCEPTUAL LANDSCAPE PLAN

**FAIRFAX
PRESBYTERIAN
CHURCH**

CITY OF FAIRFAX, VIRGINIA

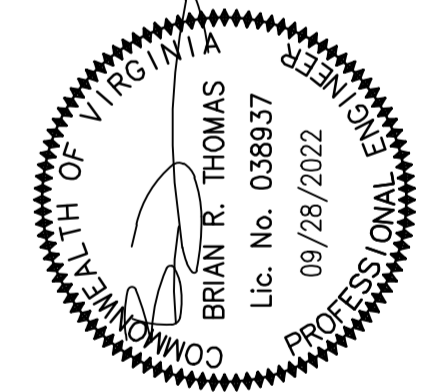





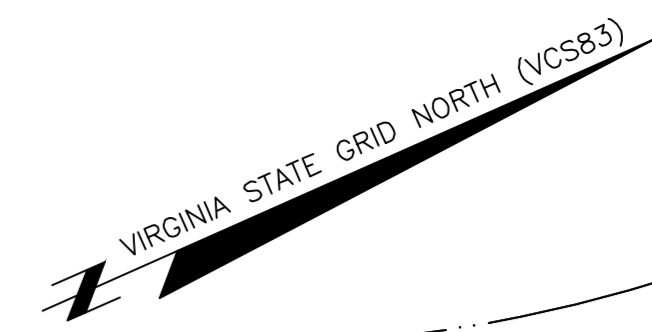

CPJ Charles P. Johnson & Associates, Inc.
 Associates
 Civil and Environmental Engineers • Planners • Landscape Architects • Surveyors
 9959 Pender Dr., Ste. 210 Fairfax, VA 22030 703-585-7555 FAX: 703-273-8995
 www.cpj.com • Chantilly, VA • Alexandria, VA • Greenbelt, MD • Frederick, MD • Fairfax, VA

DESIGN	DATE	SCALE	REVISIONS
DESIGN	JAN. 2021	HORIZ: 1" = 20'	
APPROVED		VERT: ---	
KJV			
HMF			
DATE			
JAN. 2021			
SCALE			
HORIZ: 1" = 20'			
VERT: ---			
SHEET	OF		
39	53		
PRJ NO: 2017-2570			
TYPE: MDP			

THIS SHEET IS FOR LANDSCAPE PURPOSES ONLY



LEGEND

-  TREE TO BE PRESERVED (SEE SHEET 30)
-  SHADE TREE
-  TREE COUNTED TOWARD PARKING LOT LANDSCAPING (SEE SHEET 41)
-  ORNAMENTAL/UNDERSTORY TREE
-  DECIDUOUS SHRUB
-  TRANSITIONAL YARD (SEE SHEET 41)
-  TREE SAVE AREA (SEE SHEET 36)

NOTE: THE LANDSCAPING SHOWN IS CONCEPTUAL IN NATURE. FINAL LOCATIONS AND SPECIES ARE TO BE DETERMINED WITH THE FINAL SITE PLAN. NATIVE AND/OR DESIRABLE SPECIES WILL BE USED WHERE POSSIBLE. TREE LOCATIONS AND SIZES MAY VARY WITH FINAL OVERHEAD & UNDERGROUND UTILITY LOCATIONS.

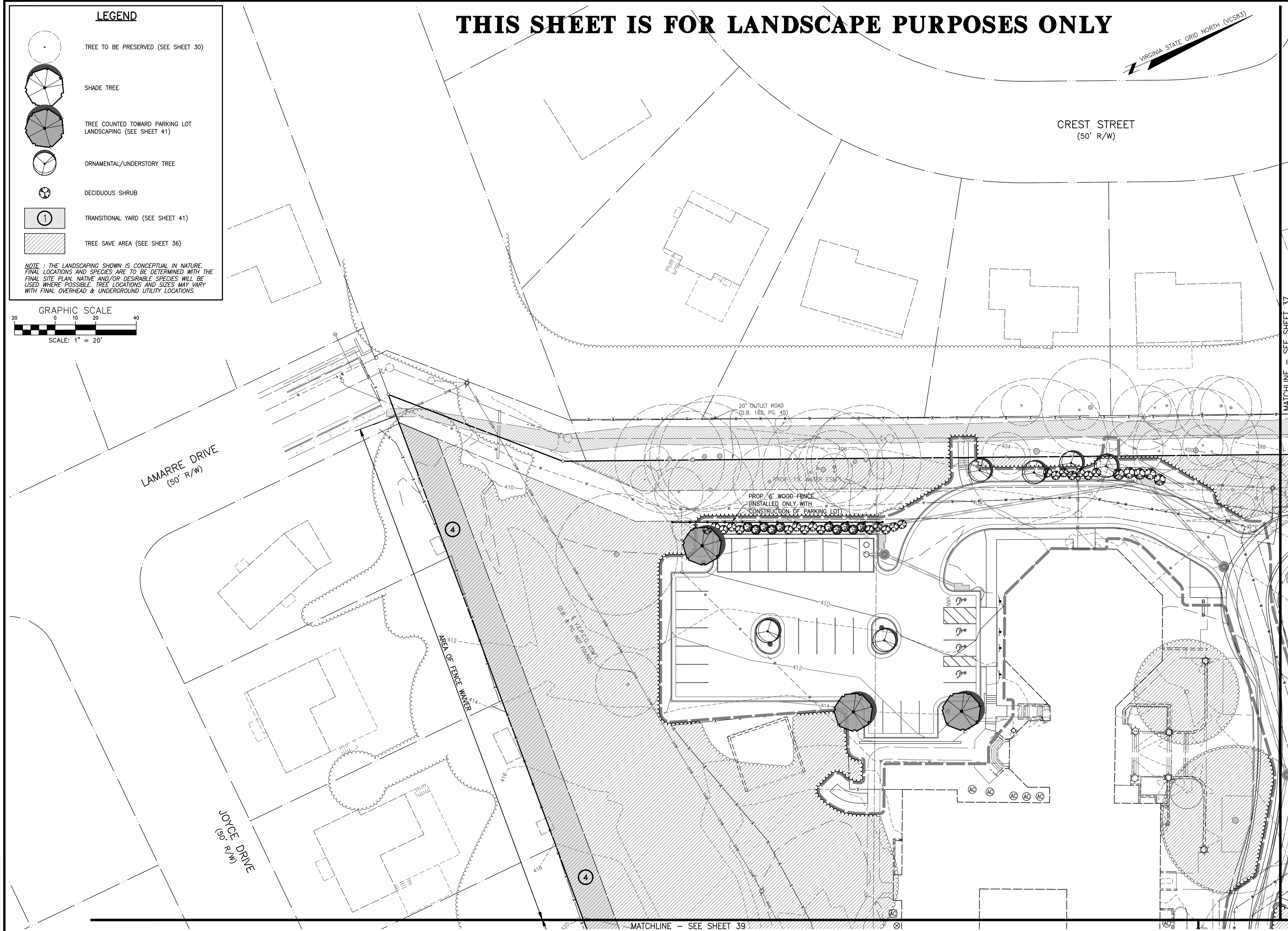
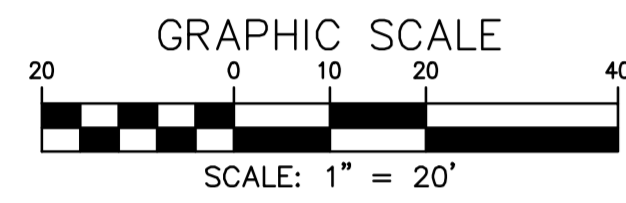

NO. DATE REVISION PRIOR TO APPROVAL

CPJ Charles P. Johnson & Associates, Inc.
 civil and environmental Engineers • Planners • Landscape Architects • Surveyors
 9909 Pender Dr., Ste. 210 Fairfax, VA 22030 703-385-7555 FAX: 703-273-8995
 www.cpjassoc.com • Charlottesville, VA • Charlottesville, VA • Greenbelt, MD • Frederick, MD • Fairfax, VA

CONCEPTUAL LANDSCAPE PLAN

FAIRFAX PRESBYTERIAN CHURCH

CITY OF FAIRFAX, VIRGINIA

MATCHLINE - SEE SHEET 37

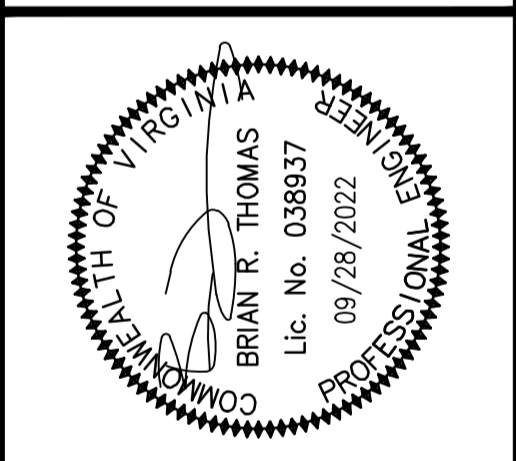

DESIGN	DATE	BY	REVISIONS	DATE
DESIGN				
DRAWN				
CHECKED				
APPROVED				
DATE	JAN. 2021			
SCALE				
HORIZ. 1" = 20'				
VERT. 1" = 20'				

PROJECT NO: 2017-2570
 TYPE: MDP

Attached Xrefs: 00-60700/00-60500/XREF-R0301/00-66801/RZ SEA/RZ SIGNATURE/RZ SIGNATURE DATE

THIS SHEET IS FOR LANDSCAPE PURPOSES ONLY

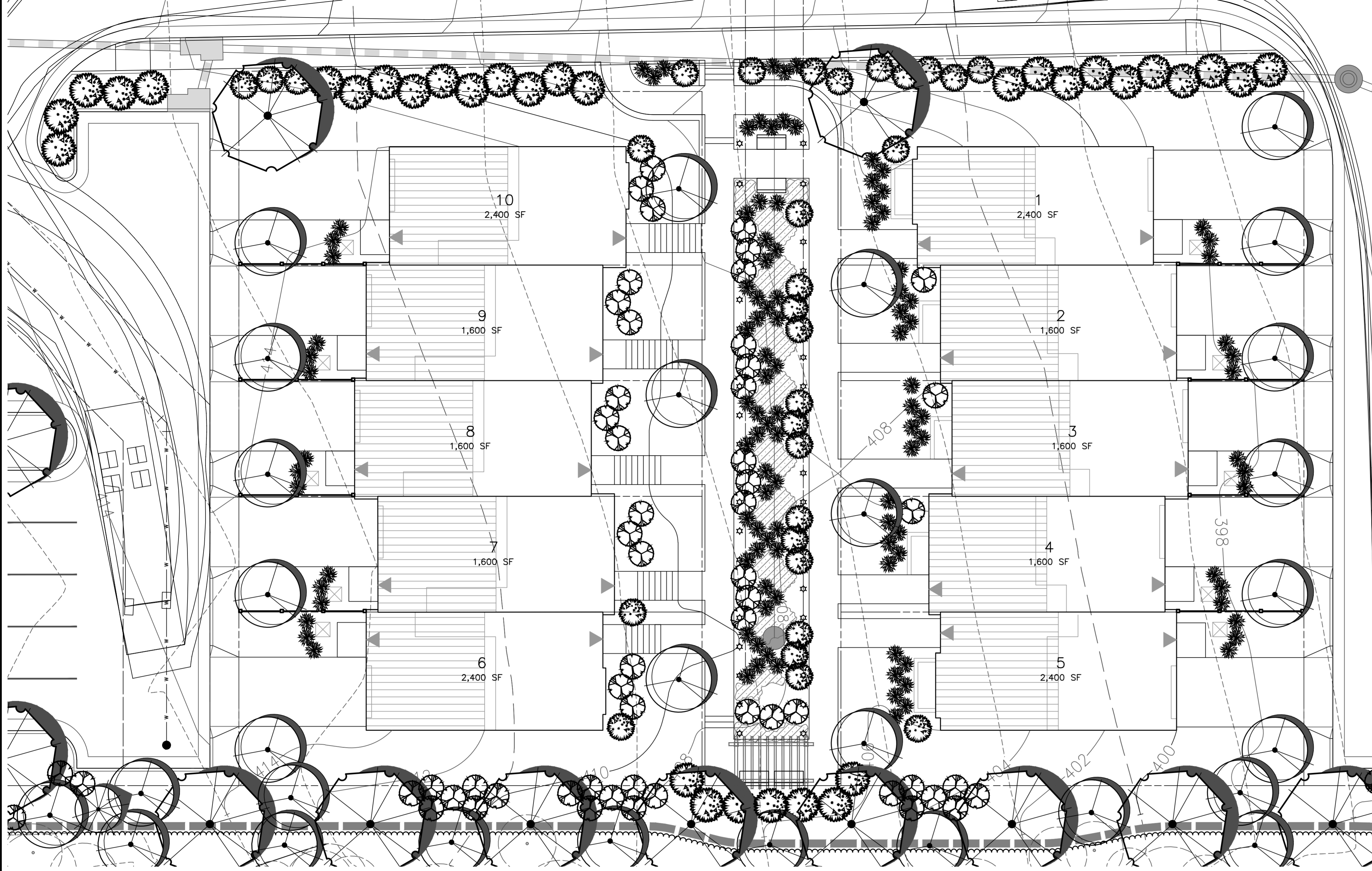

LEGEND

- SHADE TREE
- ORNAMENTAL/UNDERSTORY TREE
- EVERGREEN TREE
- DECIDUOUS SHRUB
- EVERGREEN SHRUB
- ORNAMENTAL GRASS
- GROUNDCOVER
- SOLAR PATHWAY LIGHT (SEE SHEET 53 FOR DETAIL)

NOTE: THE LANDSCAPING SHOWN IS CONCEPTUAL IN NATURE. FINAL LOCATIONS AND SPECIES ARE TO BE DETERMINED WITH THE FINAL SITE PLAN. NATIVE AND/OR DESIRABLE SPECIES WILL BE USED WHERE POSSIBLE. TREE LOCATIONS AND SIZES MAY VARY WITH FINAL OVERHEAD & UNDERGROUND UTILITY LOCATIONS.

TOWNHOME LANDSCAPING DETAIL
SCALE: 1" = 10'

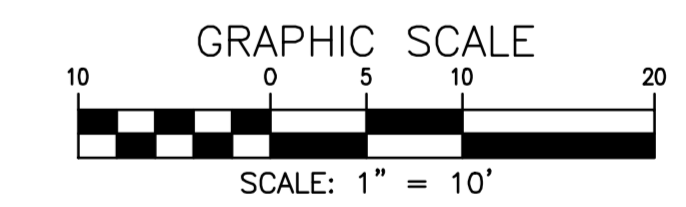

NO. DATE REVISION PRIOR TO APPROVAL

CPJ Charles P. Johnson & Associates, Inc.
Civil and Environmental Engineers • Planners • Landscape Architects • Surveyors
9959 Pender Dr., Ste. 210 Fairfax, VA 22030 703-585-7555 FAX: 703-273-8995
www.cpjassoc.com • Charlottesville, VA • Annapolis, MD • Greenbelt, MD • Frederick, MD • Fairfax, VA

TOWNHOME LANDSCAPING & LANDSCAPE CALCULATIONS

FAIRFAX PRESBYTERIAN CHURCH

CITY OF FAIRFAX, VIRGINIA

BRIAN R. THOMAS
Lic. No. 038937
09/28/2022
PROFESSIONAL ENGINEER
COMMONWEALTH OF VIRGINIA

1 TRANSITIONAL YARD 3
275 FT LENGTH *

REQUIRED	PROVIDED
15' MINIMUM WIDTH	12' WIDTH
6' MINIMUM FENCE OR WALL HEIGHT	N/A FENCE (WAIVED)
11 CANOPY TREES (4 PER 100 FT)	* CANOPY TREES
11 UNDERSTORY TREES (4 PER 100 FT)	* UNDERSTORY TREES
11 SHRUBS (4 PER 100 FT)	* SHRUBS

* 100% OF THE BUFFER IS WITHIN THE TREE SAVE AREA, AND CONTAINS AT LEAST 11 CANOPY TREES

3 TRANSITIONAL YARD 3
512 FT LENGTH *

REQUIRED	PROVIDED
15' MINIMUM WIDTH	15' WIDTH
6' MINIMUM FENCE OR WALL HEIGHT	6' FENCE (PARTIAL)
20 CANOPY TREES (4 PER 100 FT)	* CANOPY TREES
20 UNDERSTORY TREES (4 PER 100 FT)	* UNDERSTORY TREES
20 SHRUBS (4 PER 100 FT)	* SHRUBS

* THE ENTIRE BUFFER IS WITHIN THE TREE SAVE AREA

2 TRANSITIONAL YARD 3
520 FT LENGTH *

REQUIRED	PROVIDED
15' MINIMUM WIDTH	15' WIDTH
6' MINIMUM FENCE OR WALL HEIGHT	N/A FENCE (WAIVED)
21 CANOPY TREES (4 PER 100 FT)	* CANOPY TREES
21 UNDERSTORY TREES (4 PER 100 FT)	2 UNDERSTORY TREES
21 SHRUBS (4 PER 100 FT)	8 SHRUBS

* 91% OF THE BUFFER IS WITHIN THE TREE SAVE AREA, AND CONTAINS AT LEAST 21 CANOPY TREES

4 TRANSITIONAL YARD 3
570 FT LENGTH *

REQUIRED	PROVIDED
15' MINIMUM WIDTH	15' WIDTH
6' MINIMUM FENCE OR WALL HEIGHT	N/A FENCE (WAIVED)
23 CANOPY TREES (4 PER 100 FT)	* CANOPY TREES
23 UNDERSTORY TREES (4 PER 100 FT)	* UNDERSTORY TREES
23 SHRUBS (4 PER 100 FT)	* SHRUBS

* THE ENTIRE BUFFER IS WITHIN THE TREE SAVE AREA

INTERIOR PARKING LOT LANDSCAPING CALCULATIONS

PHASE OF DEVELOPMENT	ONE	TWO	TOTAL
NUMBER OF PARKING SPACES PROVIDED IN EACH PHASE	10	30	40
CANOPY TREES REQUIRED (1 tree/10 spaces)	1	3	4
CANOPY TREES PROVIDED IN EACH PHASE	3	3	6

NOTE: For expansion of existing parking lot only, per Zoning Ordinance § 4.5.7.A.1(b)

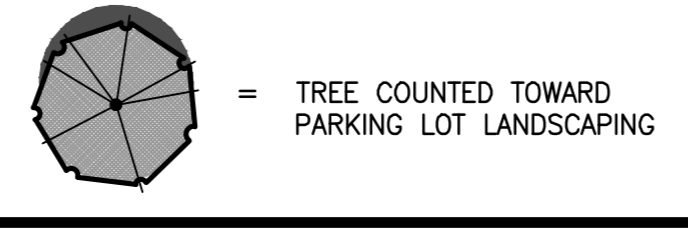

PLANT SCHEDULE

	QUANTITY	X CANOPY	= TOTAL
SHADE TREES (3.5" CAL.) (E.G. RED MAPLE, SCARLET OAK, GINKGO)	20	250	5,000
UNDERSTORY TREES (2" CAL.) (E.G. SERVICEBERRY, FRINGETREE, REDBUD)	44	100	4,400
EVERGREEN TREES (8' HGT.) (E.G. AMERICAN HOLLY, EASTERN REDCEDAR)	5	100	500
EVERGREEN TREES (6' HGT.) (E.G. EASTERN ARBORVITAE)	2	50	100
MEDIUM DECIDUOUS SHRUBS (E.G. BEAUTYBERRY, VIBURNUM, WINTERBERRY)	119	0	0
MEDIUM EVERGREEN SHRUBS (E.G. WHITE CEDAR, YALPON HOLLY, RHODODENDRON)	72	0	0
ORNAMENTAL GRASSES (E.G. LITTLE BLUESTEM, SWITCH GRASS, BOTTLEBRUSH)	115	0	0
			7,600

IMPERVIOUS SURFACE CALCULATIONS

	AREA
SITE AREA	359,435 SF
EXISTING CHURCH	27,250 SF
PROPOSED TOWNHOUSES	8,000 SF
SIDEWALKS	23,200 SF
STREETS & PARKING	115,340 SF
TOTAL IMPERVIOUS AREA	173,790 SF
IMPERVIOUS SURFACE RATIO	173,790/359,435 = 48.3%

10-YEAR TREE COVER CALCULATIONS

TREE COVER REQUIRED	
TOTAL SITE AREA	359,435 S.F.
PERCENTAGE OF TREE COVER REQUIRED	10%
TOTAL TREE COVER REQUIRED	35,944 S.F.
TREE COVER PROVIDED	
AREA OF EXISTING TREES TO BE PRESERVED	132,460 S.F.±
AREA OF TREES TO BE PLANTED	10,000 S.F.±
TOTAL TREE COVER PROVIDED (39.6% OF SITE AREA)	142,460 S.F.±

DESIGN	DATE	REVISIONS	DESCRIPTION	BY	DATE

SCALE: 1" = 10'

HORIZONTAL: 1" = 10'

VERTICAL: 1" = 10'

SHEET 41 OF 53

PRJ NO: 2017-2570

TYPE: MDP

Attached Xrefs: 00-60700/00-60600/XREF-R0401/XREF-R0301/00-66801/RZ SEA/RZ SIGNATURE/RZ SIGNATURE DATE