

STREET WIDTH (X)	25'	27'	37'
DISTANCE (Y)	98'	98'	103'
DISTANCE (Z) (MIN.)	18'	18'	21'

ALL DIMENSIONS SHOWN ARE TO BACK OF CURB UNLESS OTHERWISE SHOWN

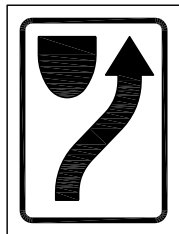
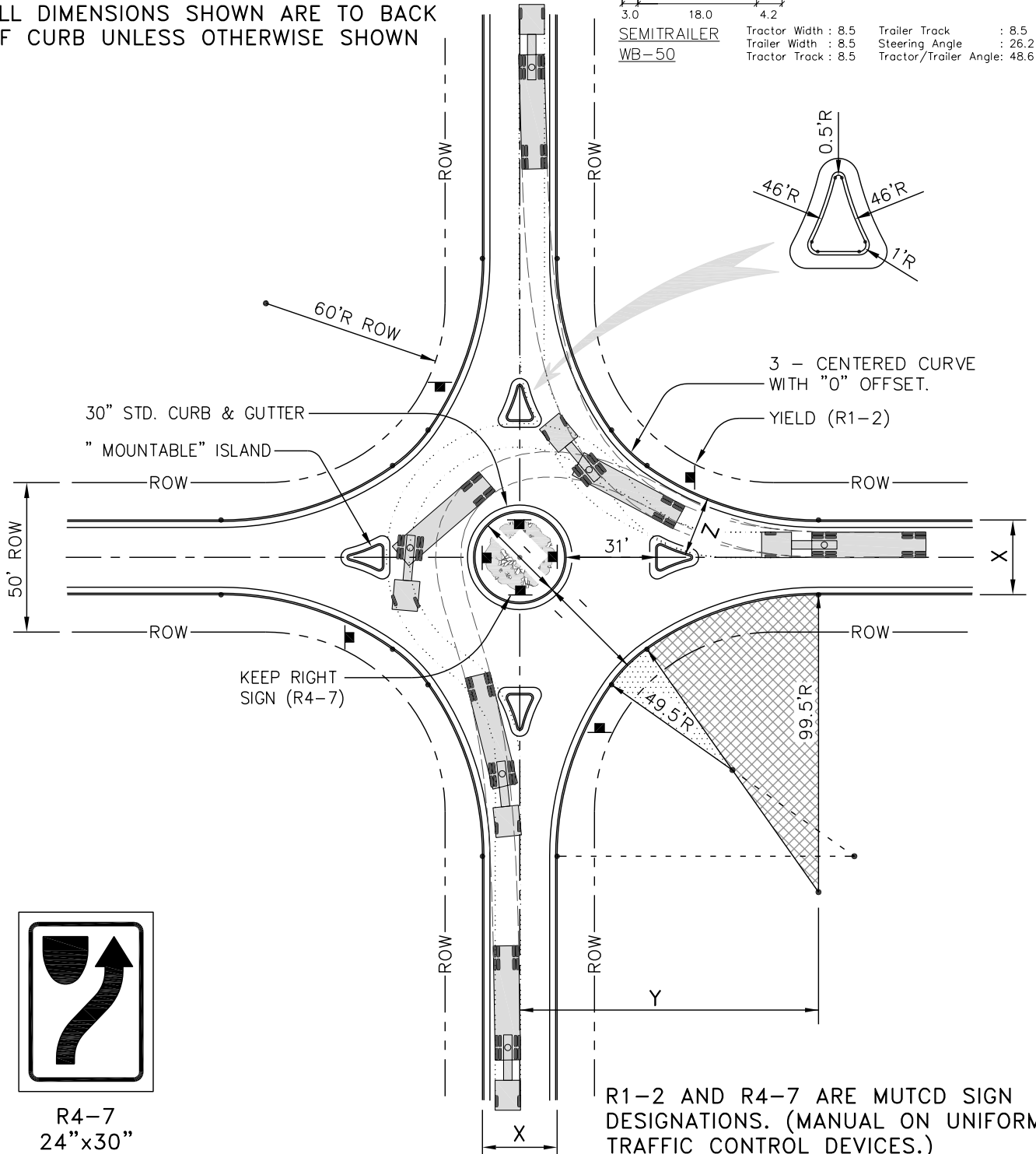
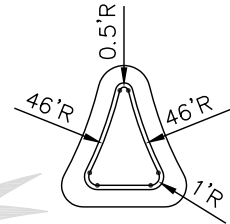
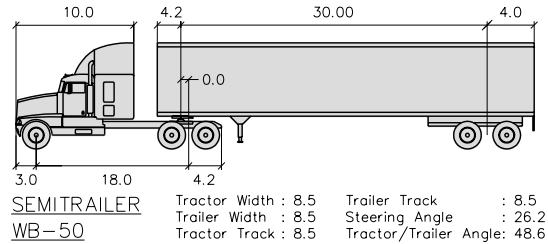

R4-7  
24" x 30"

R1-2 AND R4-7 ARE MUTCD SIGN DESIGNATIONS. (MANUAL ON UNIFORM TRAFFIC CONTROL DEVICES.)



Department of Public Works  
10455 Armstrong Street  
Fairfax, VA 22030-3630

**CITY of FAIRFAX**  
USE WITH THE FAIRFAX STANDARD SPECIFICATIONS ONLY

Voice (703) 246-6330  
FAX (703) 591-5727  
www.fairfaxva.gov

**ROUND ABOUT STD.  
TRAFFIC CIRCLE DETAIL**

SCALE: Not To Scale	DETAIL # 2403.02
REVISION DATE: July, 2005	SHEET #: 1 of 1