

PROJECT MANAGER Wendy Block Sanford, (703) 385-7889  
SURVEYED BY, DATE Nick Kougalis, L.S., (703) 368-7373 (2020)  
DESIGN BY Mark A. Gunn, P.E., (703) 368-7373  
SUBSURFACE UTILITY BY, DATE AccuMark, (800) 542-2990 (2015)

# Roadway Lighting Index of Sheets

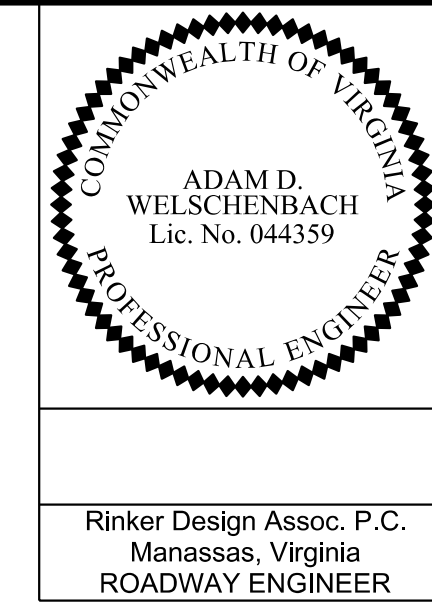

REVISED	STATE	ROUTE	STATE PROJECT	SHEET NO.
	VA.	6228	U000-154-R94	18

DESIGN FEATURES RELATING TO CONSTRUCTION OR TO REGULATION AND CONTROL OF TRAFFIC MAY BE SUBJECT TO CHANGE AS DEEMED NECESSARY BY THE DEPARTMENT

Rinker Design Assoc. P.C.  
Manassas, Virginia  
ROADWAY ENGINEER

### PROJECT LOCATION

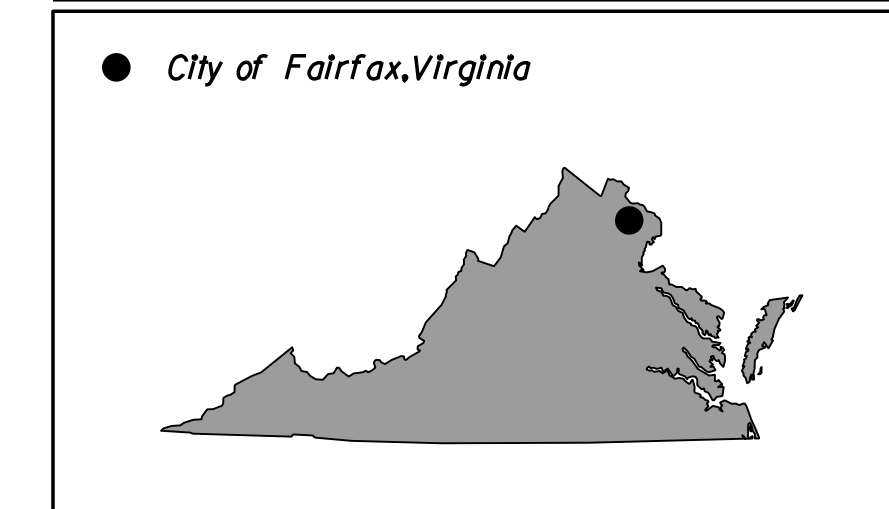

### PROJECT LOCATION:

From: 0.00 MI. North of Blenheim Blvd. (Rte. 6628) and Layton Hall Rd. (Rte. 3) Intersection  
To: 0.20 MI. South of Blenheim Blvd. (Rte. 6628) and Fairfax Blvd. (Rte. 50) Intersection

### PROJECT LIGHTING AREA

The Blenheim Boulevard Project has been designed in accordance with RP-8-18 to include all Shared Use Path Improvements and Sidewalk Improvements on the south side of Blenheim Blvd.

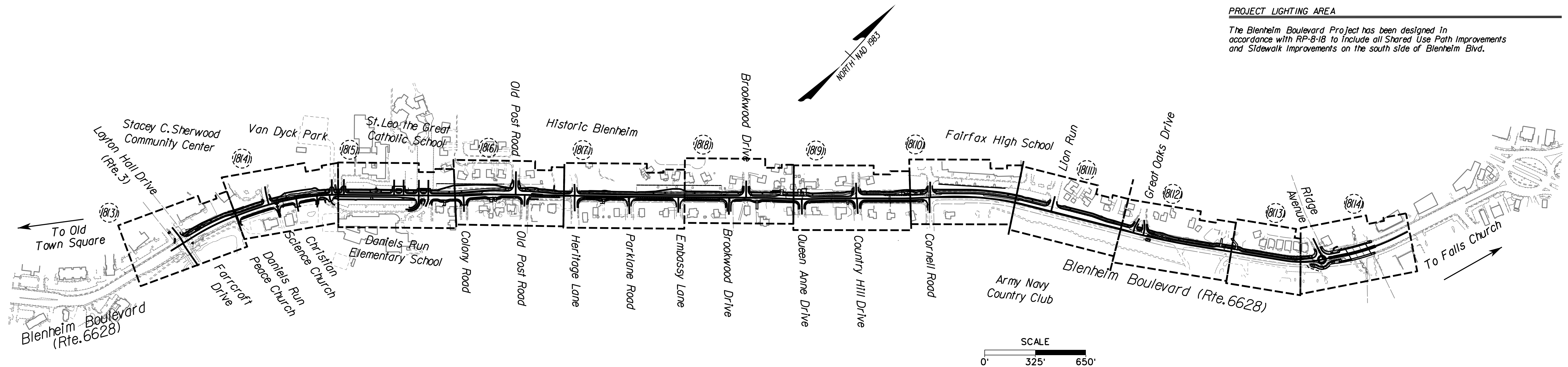
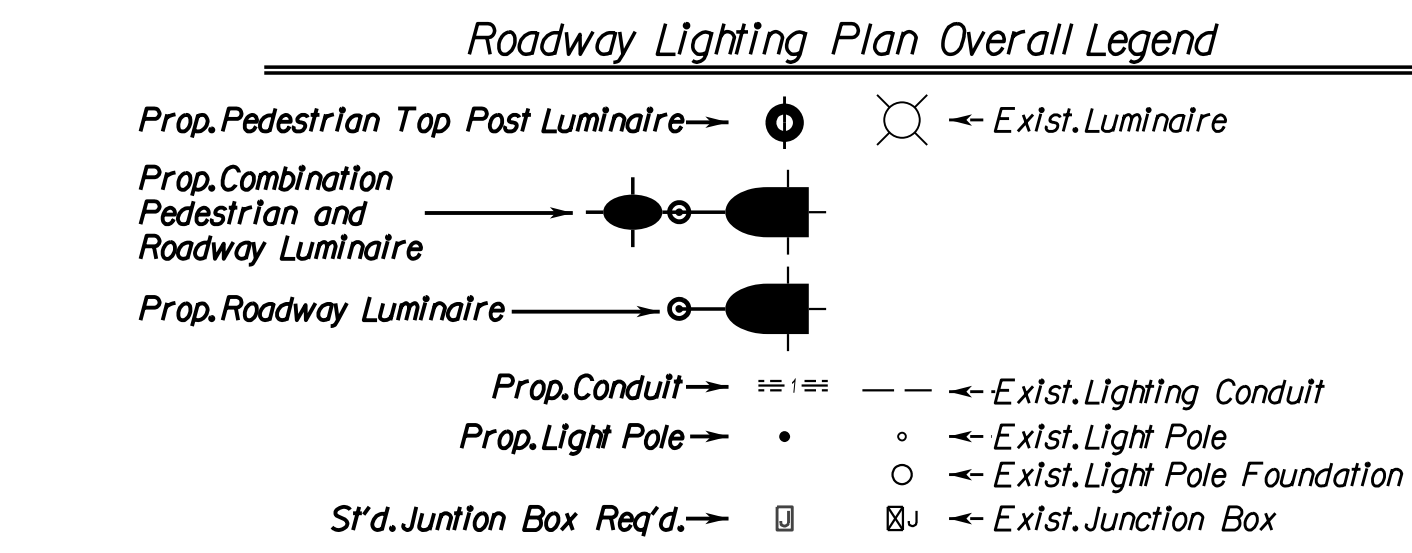

### Pole Callout Information

Pole XX, St'd. LP-1 Req'd. ← Pole Number & Foundation Type  
 Sta. 123+15.00, 100.00' RT ← Station Number of the Pole Location, & Offset Distance RT. (Right) or LT. (Left) of Referred Base Line  
 Blenheim Blvd. Bl. ← Roadway Baseline

### PROJECT SHEET INDEX

Sheet No. 18	.....	Roadway Lighting Index of Sheets and Project Location Map
Sheet No. 18(1A)	.....	Roadway Lighting Plan General Notes
Sheet No. 18(1B)	.....	Roadway Lighting Design Criteria & Statistical Calculations
Sheet No. 18(1C)	.....	Roadway Lighting Pole Specifications
Sheet No. 18(1D)	.....	Roadway Lighting Pole Specifications
Sheet No. 18(2)	.....	Not Used
Sheet No. 18(3)	.....	Roadway Lighting Plan
Sheet No. 18(4)	.....	Roadway Lighting Plan
Sheet No. 18(5)	.....	Roadway Lighting Plan
Sheet No. 18(6)	.....	Roadway Lighting Plan
Sheet No. 18(7)	.....	Roadway Lighting Plan
Sheet No. 18(8)	.....	Roadway Lighting Plan
Sheet No. 18(9)	.....	Roadway Lighting Plan
Sheet No. 18(10)	.....	Roadway Lighting Plan
Sheet No. 18(11)	.....	Roadway Lighting Plan
Sheet No. 18(12)	.....	Roadway Lighting Plan
Sheet No. 18(13)	.....	Roadway Lighting Plan
Sheet No. 18(14)	.....	Roadway Lighting Plan

SCALE	PROJECT	SHEET NO.
0 325 650'	U000-154-R94	18

PH PLANS THESE PLANS ARE UNFINISHED AND UNAPPROVED AND ARE NOT TO BE USED FOR CONSTRUCTION. ADDITIONAL EASEMENTS FOR UTILITY RELOCATIONS MAY BE REQUIRED BEYOND THE PROPOSED RIGHT-OF-WAY SHOWN ON THESE PLANS.

PROJECT MANAGER *Wendy Block Sanford, (703) 385-7889*  
SURVEYED BY, DATE *Nick Kougalis, L.S., (703) 368-7373 (2020)*  
DESIGN BY *Mark A. Gunn, P.E., (703) 368-7373*  
SUBSURFACE UTILITY BY, DATE *Accumark, (800) 542-2990 (2015)*

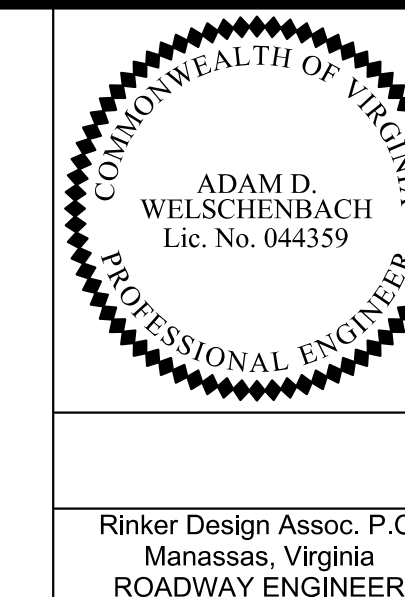

REVISED	STATE	STATE		SHEET NO.
	ROUTE	PROJECT		
	VA.	6228	U000-154-R94	18(1)

DESIGN FEATURES RELATING TO CONSTRUCTION OR TO REGULATION AND CONTROL OF TRAFFIC MAY BE SUBJECT TO CHANGE AS DEEMED NECESSARY BY THE DEPARTMENT

# Roadway Lighting Plan General Notes

### LIGHTING GENERAL NOTES:

#### CONDUIT INSTALLATION NOTES

1. Conduit shall be schedule 40 PVC in appropriate areas and Rigid Galvanized Steel if there are loading issues, or otherwise specified by the Public Works Director. The size of the conduit shall be specified on the Plan.
2. The sum of the bend angles in a single run of conduit shall not exceed 360 degrees.
3. The ends of all conduits, whether shop or field cut, shall be reamed to remove burrs and rough edges. Cuts shall be made square and true so that the ends will butt or come together for the full circumference thereof.
4. Conduit Risers shall be installed on wood utility poles. Conduit shall be attached to the pole with conduit clamps. The Public Works Director shall determine the length of riser. A rain tight entrance cap with plastic wire entry knockouts shall be installed at the top of each riser.
5. Conduit locations are diagrammatic. Field adjustments shall be made as required to stay within the limits of construction, out of ditch lines, away from guardrail, away from fence posts, and to clear obstructions.
6. All proposed conduit bypassing light pole foundations shall have a 3 ft. preferred clearance and a 1 ft. minimum clearance from edge of foundation.
7. Conduits shall be installed with radius offsets (5' minimum radius) to bypass drainage inlets, manholes, and other obstructions.
8. At locations where proposed conduit shall cross existing conduit, the Contractor shall hand-dig the trench and shall take adequate care not to damage the existing conduit or the contents thereof. These conditions shall apply at all such conduit crossings except those locations where proposed conduit will cross conduit designated to be abandoned.

#### JUNCTION BOXES NOTES

1. Shall be made of a Quartzite Composite material with locking cover.
2. Conduit shall enter the side(s) of the structure at the depth of the conduit run and shall extend a minimum of 2" and a maximum of 4" into the structure.
3. All junction boxes shall be set on a 12" minimum depth bedding of washed gravel (VDOT #57 stone or approved equal).
4. The top of all junction boxes shall be installed flush with the surrounding grade or pavement unless otherwise specified by the Public Works Director.
5. The conduit entrance holes shall be patched such that debris and water cannot enter the structure.
6. Station and offset references in junction box labels are based on the construction baseline as light pole label of the nearest proposed light pole.

#### MISCELLANEOUS NOTES:

1. The grounding rod shall be driven into undisturbed earth. The ground wire shall be attached to the ground rod with a ground clamp.
2. The ground wire shall be continuous and unspliced from the ground rod to the lighting pole if applicable.
3. Ground wire shall be #8 AWG solid bare copper wire.
4. The Contractor shall restore all areas disturbed by his operation to conditions equal to or better than existing conditions.
5. The Contractor shall remove surplus materials, unsuitable soil, trash, and debris and legally dispose of off-site.

	PROJECT U000-154-R94	SHEET NO. 18(1)
--	-------------------------	--------------------

PROJECT MANAGER *Wendy Block Sanford, (703) 385-7889*  
 SURVEYED BY, DATE *Nick Kougalis, L.S., (703) 368-7373 (2020)*  
 DESIGN BY *Mark A. Gunn, P.E., (703) 368-7373*  
 SUBSURFACE UTILITY BY, DATE *Accumark, (800) 542-2990 (2015)*

# Roadway Lighting Design Criteria and Statistical Calculations

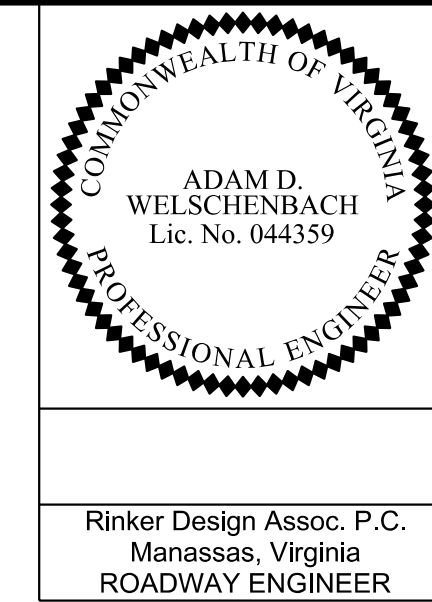

REVISED	STATE	ROUTE	STATE PROJECT	SHEET NO.
	VA.	6228	U000-154-R94	18(1A)

DESIGN FEATURES RELATING TO CONSTRUCTION OR TO REGULATION AND CONTROL OF TRAFFIC MAY BE SUBJECT TO CHANGE AS DEEMED NECESSARY BY THE DEPARTMENT

Roadway Lighting RP-8-18: Table II-1  
Lighting Design Criteria for Streets

Street Classification	Pedestrian Area Classification	Average Luminance Avg (cd/m <sup>2</sup> )	Average Uniformity Ratio Avg/Lmin	Maximum Uniformity Ratio Lmax/Lmin	Max. Velling Luminance Ratio Lymax/Lavg
Major	High	1.2	3.0	5.0	0.3
	Medium	0.9	3.0	5.0	0.3
	Low	0.6	3.5	6.0	0.3
Collector	High	0.8	3.0	5.0	0.4
	Medium	0.6	3.5	6.0	0.4
	Low	0.4	4.0	8.0	0.4
Local	High	0.6	6.0	10.0	0.4
	Medium	0.5	6.0	10.0	0.4
	Low	0.3	6.0	10.0	0.4

Roadway Lighting RP-8-18: Table I2-4  
Illuminance for Roundabouts (lux/fc)

Street Classification	Pedestrian Activity Classification			Eavg/Emin
	High	Medium	Low	
Major / Major	34/3.2	26/2.4	18/1.7	3:1
Major / Collector	29/2.7	22/2.0	15/1.4	3:1
Major / Local	26/2.4	20/1.9	13/1.2	3:1
Collector / Collector	24/2.2	18/1.7	12/1.1	4:1
Collector / Local	21/2.0	16/1.5	10/0.9	4:1
Local / Local	18/1.7	14/1.3	8/0.7	6:1

Statistical Area Map

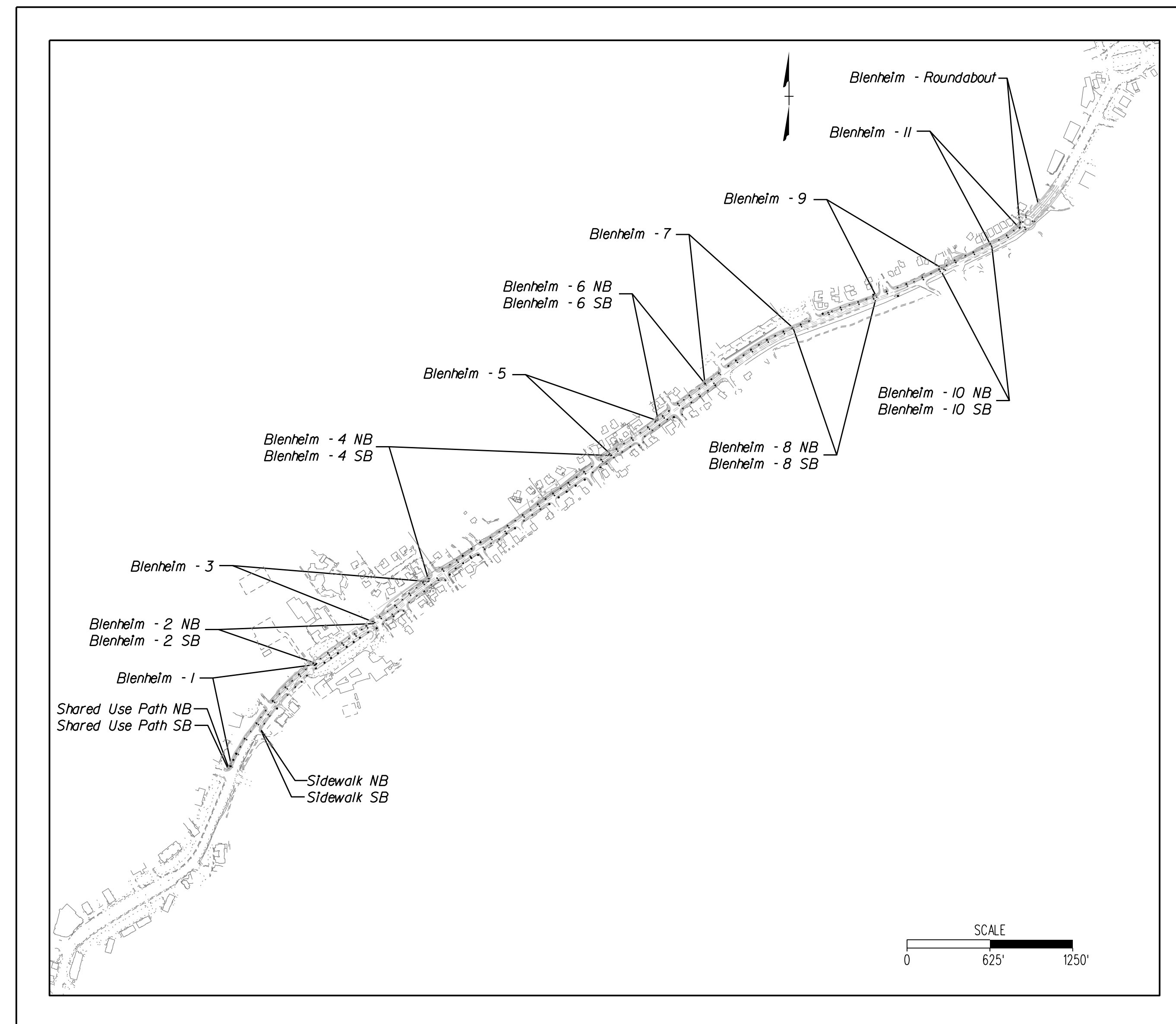



PROJECT MANAGER *Wendy Block Sanford, (703) 385-7889*  
 SURVEYED BY, DATE *Nick Kougalis, L.S., (703) 368-7373 (2020)*  
 DESIGN BY *Mark A. Gunn, P.E., (703) 368-7373*  
 SUBSURFACE UTILITY BY, DATE *Accumark, (800) 542-2990 (2015)*

# Roadway Lighting Luminaire Specifications

## Std. Decorative Pole

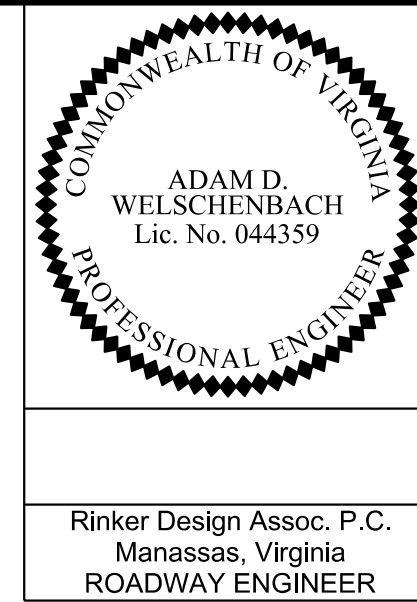

REVISED	STATE	STATE		SHEET NO.
	ROUTE	PROJECT		
	VA.	6228	U000-154-R94	18(1B)

DESIGN FEATURES RELATING TO CONSTRUCTION OR TO REGULATION AND CONTROL OF TRAFFIC MAY BE SUBJECT TO CHANGE AS DEEMED NECESSARY BY THE DEPARTMENT

Rinker Design Assoc. P.C.  
Manassas, Virginia  
ROADWAY ENGINEER

## Std. Roadway Pole

Section 10460 - Street Lighting

Page 10460-



**Shoebox**  
(150W-250W EQ)

The Shoebox luminaire provides a full cut-off distribution for lighting roadways and parking areas.

Comparable HID Wattage	Finish Color	Initial Lamp Lumens	Lighting Pattern	Correlated Color Temperature (CCT)	Input Wattage	Billing Tier	B-U-G Rating	Recommended Mounting Height (ft.)	Luminaire Stock #	WMIS CU Code
150	Black	8080	Type II	3000K	71	3	2-0-2	25 - 30	42341567	LEDSBBA0823BXXX
150	Gray	8080	Type II	3000K	71	3	2-0-2	25 - 30	42341566	LEDSBBA0823GXXX
150	Black	8506	Type II	4000K	71	3	2-0-2	25 - 30	42341568	LEDSBBA0824BXXX
150	Gray	8506	Type II	4000K	71	3	2-0-2	25 - 30	42339747	LEDSBBA0824GXXX
150	Black	8080	Type III	3000K	71	3	2-0-2	25 - 30	42323697	LEDSBBA0833BXXX
150	Gray	8080	Type III	3000K	71	3	2-0-2	25 - 30	42323695	LEDSBBA0833GXXX
150	Black	8101	Type IV	3000K	71	3	2-0-2	25 - 30	42323698	LEDSBBA0843BXXX
150	Gray	8101	Type IV	3000K	71	3	2-0-2	25 - 30	42323696	LEDSBBA0843GXXX
150	Black	8606	Type III	4000K	71	3	2-0-2	25 - 30	42315811	LEDSBBA0834BXXX
150	Gray	8606	Type III	4000K	71	3	2-0-2	25 - 30	42315783	LEDSBBA0834GXXX
150	Black	8569	Type IV	4000K	71	3	2-0-2	25 - 30	42315632	LEDSBBA0844BXXX
150	Gray	8569	Type IV	4000K	71	3	2-0-2	25 - 30	42315784	LEDSBBA0844GXXX
200	Gray	11936	Type III	3000K	105	4	3-0-3	30 - 35	42332134	LEDSBBA1233GXXX
250	Black	15381	Type III	3000K	145	5	3-0-3	30 - 35	42337108	LEDSBBA1533BXXX
250	Gray	15381	Type III	3000K	145	5	3-0-3	30 - 35	42329991	LEDSBBA1533GXXX
250	Black	14952	Type IV	3000K	145	5	3-0-3	30 - 35	42337109	LEDSBBA1543BXXX
250	Gray	14952	Type IV	3000K	145	5	3-0-3	30 - 35	42329992	LEDSBBA1543GXXX
250	Black	16193	Type III	4000K	145	5	3-0-3	30 - 35	42342703	LEDSBBA1534BXXX
250	Gray	16463	Type III	4000K	145	5	3-0-3	30 - 35	42315785	LEDSBBA1534GXXX
250	Black	16193	Type IV	4000K	145	5	3-0-3	30 - 35	42342704	LEDSBBA1544BXXX
250	Gray	16463	Type IV	4000K	145	5	3-0-3	30 - 35	42315786	LEDSBBA1544GXXX

Section 10460 - Street Lighting

Page 10460-



**Cutoff Acorn**

These Cutoff luminaire options are a dark-skies friendly alternative to various fixture styles.

Comparable HID Wattage	Finish Color	Initial Lamp Lumens	Lighting Pattern	Correlated Color Temperature (CCT)	Input Wattage	Billing Tier	Basic / Premium	Recommended Mounting Height (ft.)	BUG Rating	Luminaire Stock #	WMIS CU Code
70	Black	3551	Type III	3000K	47	2	Premium	10 - 12	1-0-1	42315978	LEDACCO0333BXXX
100	Black	5063	Type III	3000K	70	3	Premium	12 - 16	1-0-1	42315866	LEDACCO0533BXXX
150	Black	6513	Type III	3000K	95	4	Premium	12 - 16	2-0-2	42315977	LEDACCO0733BXXX

## Std. Combination Pole



**Teardrop**

Classic, elegant appearance for Historic Districts, Residential Areas, Parks, Walkways, Campuses, Boulevards, and Roadways. Styled to replicate the teardrop luminaires that illuminated boulevards during the first half of the century.

Comparable HID Wattage	Finish Color	Initial Lamp Lumens	Lighting Pattern	Correlated Color Temperature (CCT)	Input Wattage	Input Amps	Billing Tier	EPA	B-U-G Rating	Recommended Mounting Height (ft.)	Luminaire Stock #	WMIS CU Code	Optional Accessories
100	Black	4517	Type III	3000K	38	0.37	2	1.43	1-3-2	14 - 16	42337235	LEDTDSM0333BXXX	-
100	Black	4739	Type III	4000K	38	0.37	2	1.43	1-3-2	14 - 16	42337236	LEDTDSM0334BXXX	-
100	Black	3661	Type III	3000K	38	0.37	2	1.43	1-1-1	14 - 16	42337259	LEDTDSM0333BXXX	Deep Skirt
100	Black	3841	Type III	4000K	38	0.37	2	1.43	1-1-1	14 - 16	42337260	LEDTDSM0334BXXX	Deep Skirt
150	Black	8690	Type III	3000K	77	0.75	3	1.43	2-3-3	16 - 18	42337257	LEDTDSM0833BXXX	-
150	Black	9118	Type III	4000K	77	0.75	3	1.43	2-3-3	16 - 18	42337258	LEDTDSM0834BXXX	-
150	Black	7043	Type III	3000K	77	0.75	3	1.43	1-2-1	16 - 18	42337261	LEDTDSM0833BXXX	Deep Skirt
150	Black	7390	Type III	4000K	77	0.75	3	1.43	1-2-1	16 - 18	42337262	LEDTDSM0834BXXX	Deep Skirt
250	Black	12914	Type III	3000K	118	1.15	4	2.37	2-3-3	20 - 30	42337263	LEDTDLG1233BXXX	-
250	Black	13551	Type III	4000K	118	1.15	4	2.37	2-3-3	20 - 30	42337264	LEDTDLG1234BXXX	-
250	Black	9939	Type III	3000K	118	1.15	4	2.37	2-2-2	20 - 30	42337267	LEDTDLG1233BXXX	Deep Skirt
250	Black	10430	Type III	4000K	118	1.15	4	2.37	2-2-2	20 - 30	42337268	LEDTDLG1234BXXX	Deep Skirt
400	Black	23508	Type III	3000K	242	2.36	9	2.37	3-3-5	20 - 30	42337265	LEDTDLG2233BXXX	-
400	Black	24667	Type III	4000K	242	2.36	9	2.37	3-3-5	20 - 30	42337266	LEDTDLG2234BXXX	-
400	Black	18255	Type III	3000K	242	2.36	9	2.37	3-3-3	20 - 30	42337269	LEDTDLG2233BXXX	Deep Skirt
400	Black	19156	Type III	4000K	242	2.36	9	2.37	3-3-3	20 - 30	42337270	LEDTDLG2234BXXX	Deep Skirt



PROJECT MANAGER *Wendy Block Sanford, (703) 385-7889*  
 SURVEYED BY, DATE *Nick Kougalis, L.S., (703) 368-7373 (2020)*  
 DESIGN BY *Mark A. Gunn, P.E., (703) 368-7373*  
 SUBSURFACE UTILITY BY, DATE *Accumark, (800) 542-2990 (2015)*

# Roadway Lighting Pole Specifications

## Std. Decorative Pole

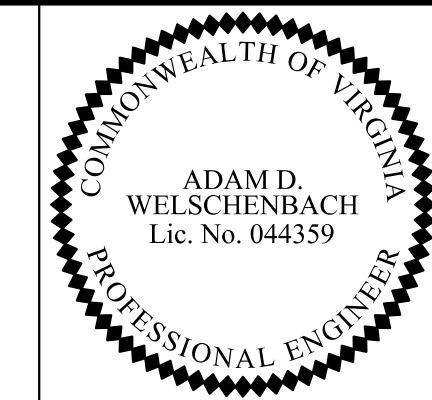

REVISED	STATE	ROUTE	PROJECT	SHEET NO.
	VA.	6228	U000-154-R94	18(1C)

DESIGN FEATURES RELATING TO CONSTRUCTION OR TO REGULATION AND CONTROL OF TRAFFIC MAY BE SUBJECT TO CHANGE AS DEEMED NECESSARY BY THE DEPARTMENT

Rinker Design Assoc. P.C.  
 Manassas, Virginia  
 ROADWAY ENGINEER

### Dominion Energy Outdoor Lighting Pole Specifications

#### Decorative Fluted Tapered Aluminum for Post Top Luminaires



Fluted tapered pole with structural Arlen style base constructed of aluminum alloy for single or twin post top luminaires. Poles are available directly embedded or base mounted for use with underground supplied conductors only. Anchor base poles require customer-installed and maintained concrete pole foundations and anchor-bolts.

Light fixtures that match well with this pole include:

- All LED Acorn styles
- All LED Colonial styles
- Premium LED Cutoff styles
- Premium LED Lantern styles

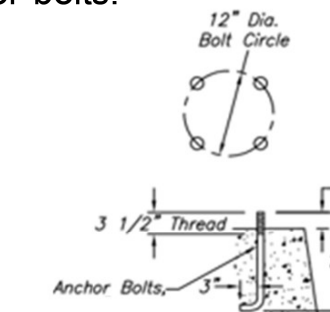

#### POLE SPECIFICATIONS

FIXTURE MOUNTING HEIGHT (ft)	TOTAL POLE LENGTH (ft)	BASE DIAMETER (in)	BASE HEIGHT (in)	EMBED or ANCHOR BASE	FINISH COLOR	WMIS CU	POLE ONLY STOCK #
12.0	16.0	17.0	17.0	Embed	Black RAL-9017	PA16ARB	42337639
12.0	16.0	17.0	17.0	Embed	Green RAL-6009	PA16ARM	42337642
14.0	18.0	17.0	17.0	Embed	Black RAL-9005	PA18ARB	42337640
14.0	18.0	17.0	17.0	Embed	Green RAL-6009	PA18ARM	42337643
16.0	20.0	17.0	17.0	Embed	Black RAL-9005	PA20ARB	42337641
16.0	20.0	17.0	17.0	Embed	Green RAL-6009	PA20ARM	42337644
12.0*	12.0	12 inch bolt circle		Anchor	Black RAL-9017	PA12ABAB	42337782
12.0*	12.0	12 inch bolt circle		Anchor	Green RAL-6009	PA12ABAM	42337785
14.0*	14.0	12 inch bolt circle		Anchor	Black RAL-9005	PA14ABAB	42337783
14.0*	14.0	12 inch bolt circle		Anchor	Green RAL-6009	PA14ABAM	42337786
16.0*	16.0	12 inch bolt circle		Anchor	Black RAL-9005	PA16ABAB	42337784
16.0*	16.0	12 inch bolt circle		Anchor	Green RAL-6009	PA16ABAM	42337887

\* Approximate based on height above grade to top of anchor base

Many localities have restrictions on light distribution and placement of outdoor lighting equipment. Consult with your local government before selecting outdoor lighting equipment.

## Std. Roadway Pole

Section 10460 - Street Lighting

Page 10460-

### Dominion Energy Outdoor Lighting Pole Specifications

#### Smooth Round Tapered Aluminum Direct Embed for Side Mounted Luminaires



Smooth round tapered poles constructed of aluminum alloy for side mounted luminaires. Single arm or two arms at 180 degrees. Poles are directly embedded for use with underground supplied conductors only.

Light fixtures that match well with this pole include:

- Basic LED Cobra style
- Basic LED Open Vertical (Area)
- Basic LED Shoebox style

#### POLE SPECIFICATIONS

ARM MOUNTING HEIGHT (ft)	TOTAL POLE LENGTH (ft)	BUTT DIAMETER* (in)	GROUNDLINE DIAMETER (in)	EMBED or ANCHOR BASE	FINISH COLOR	WMIS CU	POLE ONLY STOCK #
17.0	22.0	4.5	8.0	Embed	Natural Aluminum	PA22	42336282
17.0	22.0	4.5	8.0	Embed	Black RAL-9017	PA22B	42336283
22.0	27.0	4.5	8.0	Embed	Natural Aluminum	PA27	42336284
22.0	27.0	4.5	8.0	Embed	Black RAL-9017	PA27B	42336285
27.0	33.0	4.5	10.0	Embed	Natural Aluminum	PA33	42336286
27.0	33.0	4.5	10.0	Embed	Black RAL-9017	PA33B	42336297
32.0	38.0	4.5	10.0	Embed	Natural Aluminum	PA38	42336298
32.0	38.0	4.5	10.0	Embed	Black RAL-9017	PA38B	42336299
37.0	43.0	4.5	10.0	Embed	Natural Aluminum	PA43	42336300
37.0	43.0	4.5	10.0	Embed	Black RAL-9017	PA43B	42336301

Many localities have restrictions on light distribution and placement of outdoor lighting equipment. Consult with your local government before selecting outdoor lighting equipment.

## Std. Combination Pole

### Dominion Energy Outdoor Lighting Pole Specifications

#### Decorative Urbanscape Roadway and Pedestrian for Two Luminaires

Fluted tapered "Urbanscape" poles constructed of aluminum alloy for Teardrop or side mounted luminaires for roadway applications and side mounted or post top mounted luminaires for pedestrian applications. Poles are directly embedded for use with underground supplied conductors only.

Light fixtures that match well with this pole include:

- |  |  |
|--|--|
| <ul style="list-style-type: none"> <li>• Premium LED Teardrop style</li> <li>• Basic LED Shoebox style</li> <li>• Basic LED Cobra style</li> </ul> | <ul style="list-style-type: none"> <li>• Premium LED Acorn style</li> <li>• Premium LED Colonial style</li> <li>• Premium LED Cutoff style</li> <li>• Premium LED Lantern style</li> <li>• Premium LED Teardrop style</li> </ul> |
|--|--|

#### POLE SPECIFICATIONS

UPPER FIXTURE MOUNTING	LOWER FIXTURE MOUNTING	TOTAL POLE LENGTH (ft)	BUTT DIAMETER (in)	GROUNDLINE DIAMETER (in)	MINIMUM BOLT PROJECTION (in)	FINISH COLOR	WMIS CU	POLE ONLY STOCK #
30.0	16.0	35.0	4.0**	8.0	N/A	Black RAL-9017	PA35BUD	42346756
30.0*	16.0*	30.0	11-12 inch bolt circle		2.75	Black RAL-9017	PA30ABBUD	42346777

\* Approximate based on height above grade to top of anchor base

\*\* Butt of pole is flattened to serve as anti-rotational device

#### UPPER ARMS FOR ALUMINUM DECORATIVE URBANSCAPE POLES

ARM LENGTH (ft)	ARM RISE (in)	FINISH COLOR	DESCRIPTION	WEIGHT (lbs)	EPA	WMIS CU	DE STOCK #
4.0	N/A	Black RAL-9017	Single Member Decorative Pipe Arm	26.0	1.83	BKTPA4FT	42342998
6.0	N/A	Black RAL-9017	Single Member Decorative Pipe Arm	34.0	2.3	BKTPA6FT	42342999

#### LOWER ARMS FOR ALUMINUM DECORATIVE URBANSCAPE POLES

ARM LENGTH (ft)	ARM RISE (in)	FINISH COLOR	DESCRIPTION	WEIGHT (lbs)	EPA	WMIS CU	DE STOCK #
2.2	N/A	Black RAL-9017	Single Member Decorative Pipe Arm	N/A	N/A	BKTO2FTBUD	42346555
2.2	N/A	Black RAL-9017	Single Member Decorative Pipe Arm with Tenon	N/A	N/A	BKTO2FTBUD	42346556

#### BANNER ARMS FOR DECORATIVE URBANSCAPE POLES

ARM LENGTH (ft)	ARM RISE (in)	FINISH COLOR	DESCRIPTION	WEIGHT (lbs)	EPA	WMIS CU	DE STOCK #
2.0	N/A	Black RAL-9017	Two Banner Arms to Mount in Breakaway Coupling	N/A	N/A	BKTBUD	42346755

Many localities have restrictions on light distribution and placement of outdoor lighting equipment. Consult with your local government before selecting outdoor lighting equipment.

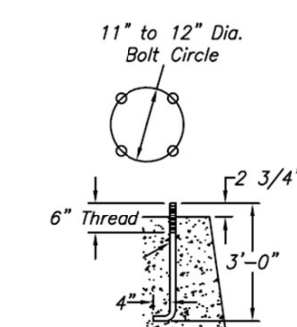



PROJECT MANAGER *Wendy Block Sanford, (703) 385-7889*  
SURVEYED BY, DATE *Nick Kougalis, L.S., (703) 368-7373 (2020)*  
DESIGN BY *Mark A. Gunn, P.E., (703) 368-7373*  
SUBSURFACE UTILITY BY, DATE *Accumark, (800) 542-2990 (2015)*

COMMONWEALTH OF VIRGINIA  
ADAM D. WELSCHENBACH  
Lic. No. 044359  
PROFESSIONAL ENGINEER

Rinker Design Assoc. P.C.  
Manassas, Virginia  
ROADWAY ENGINEER

REVISED	STATE	ROUTE	STATE PROJECT	SHEET NO.
	VA.	6228	U000-154-R94	18(3)

DESIGN FEATURES RELATING TO CONSTRUCTION OR TO REGULATION AND CONTROL OF TRAFFIC MAY BE SUBJECT TO CHANGE AS DEEMED NECESSARY BY THE DEPARTMENT

# Roadway Lighting Plan

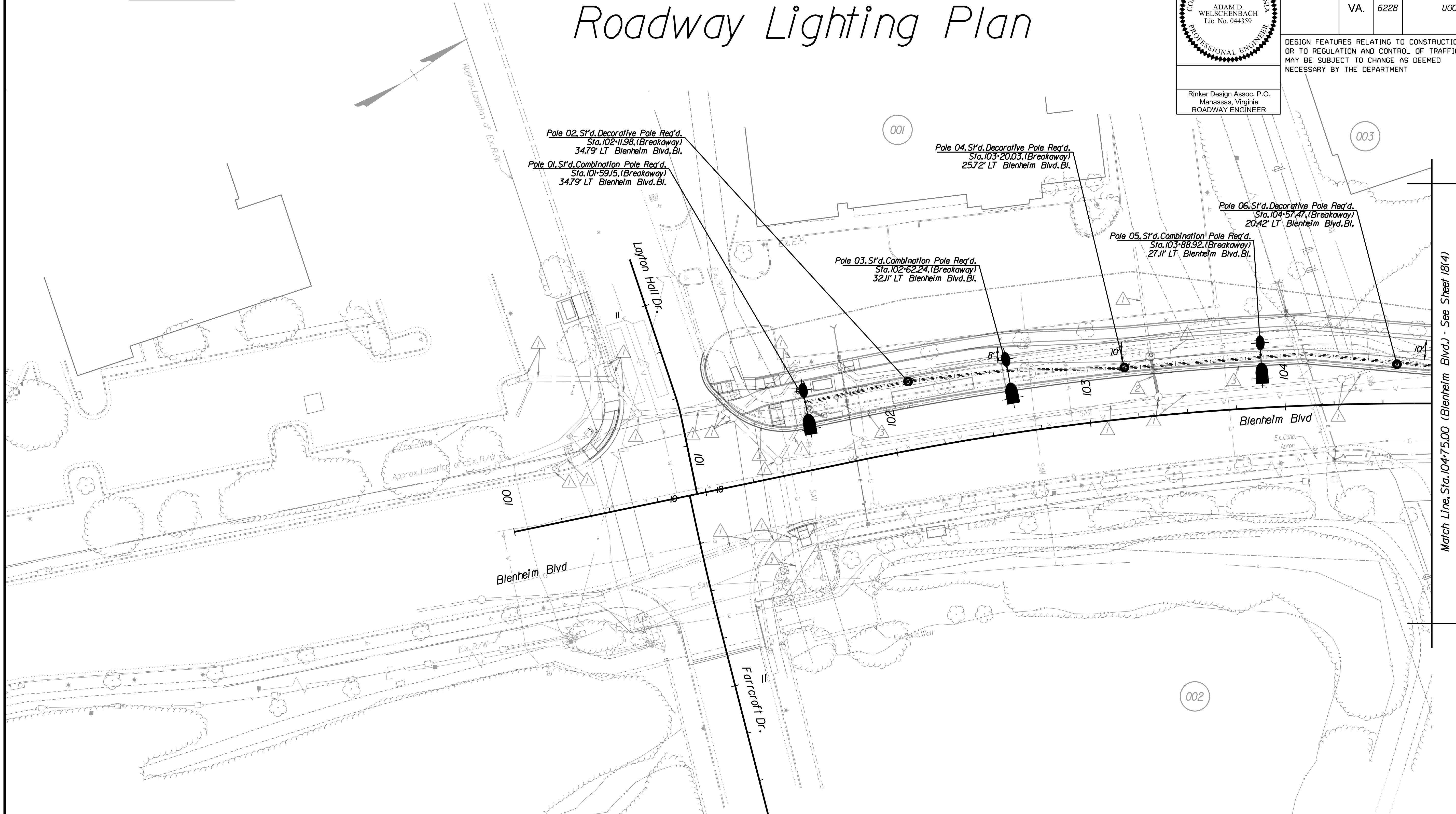

Match Line, Sta. 104+75.00 (Blenheim Blvd.) - See Sheet 18(4)

REFERENCES  
(PROFILES, DETAIL & DRAINAGE DESCRIPTION SHEETS, ETC.)

Survey Control Data Sheet	IF
Geometric Data Sheet	IG(3)
Horizontal Constr. Alignment Data	IG(1A) - IG(1F)
Erosion Controls Ph1 & Ph2	IO - IR(6)
Typical Sections	2A - 2A(7)
Drainage Descriptions	2G - 2G(3)
Profile Blenheim Blvd	3A
Pavement Marking & Signing Plan	I5 Series
Intersection/Bus Stop Detail Plan	IH Series

SCALE 0 25' 50'

PROJECT U000-154-R94 SHEET NO. 18(3)

PH PLANS THESE PLANS ARE UNFINISHED AND UNAPPROVED AND ARE NOT TO BE USED FOR CONSTRUCTION. ADDITIONAL EASEMENTS FOR UTILITY RELOCATIONS MAY BE REQUIRED BEYOND THE PROPOSED RIGHT-OF-WAY SHOWN ON THESE PLANS.

PROJECT MANAGER Wendy Block Sanford, (703) 385-7889  
SURVEYED BY, DATE Nick Kougalis, L.S., (703) 368-7373 (2020)  
DESIGN BY Mark A. Gunn, P.E., (703) 368-7373  
SUBSURFACE UTILITY BY, DATE AccuMark, (800) 542-2990 (2015)

COMMONWEALTH OF VIRGINIA  
ADAM D. WELSCHENBACH  
Lic. No. 044359  
PROFESSIONAL ENGINEER

Rinker Design Assoc. P.C.  
Manassas, Virginia  
ROADWAY ENGINEER

REVISED	STATE	ROUTE	STATE PROJECT	SHEET NO.
	VA.	6228	U000-154-R94	18(4)

DESIGN FEATURES RELATING TO CONSTRUCTION OR TO REGULATION AND CONTROL OF TRAFFIC MAY BE SUBJECT TO CHANGE AS DEEMED NECESSARY BY THE DEPARTMENT

# Roadway Lighting Plan

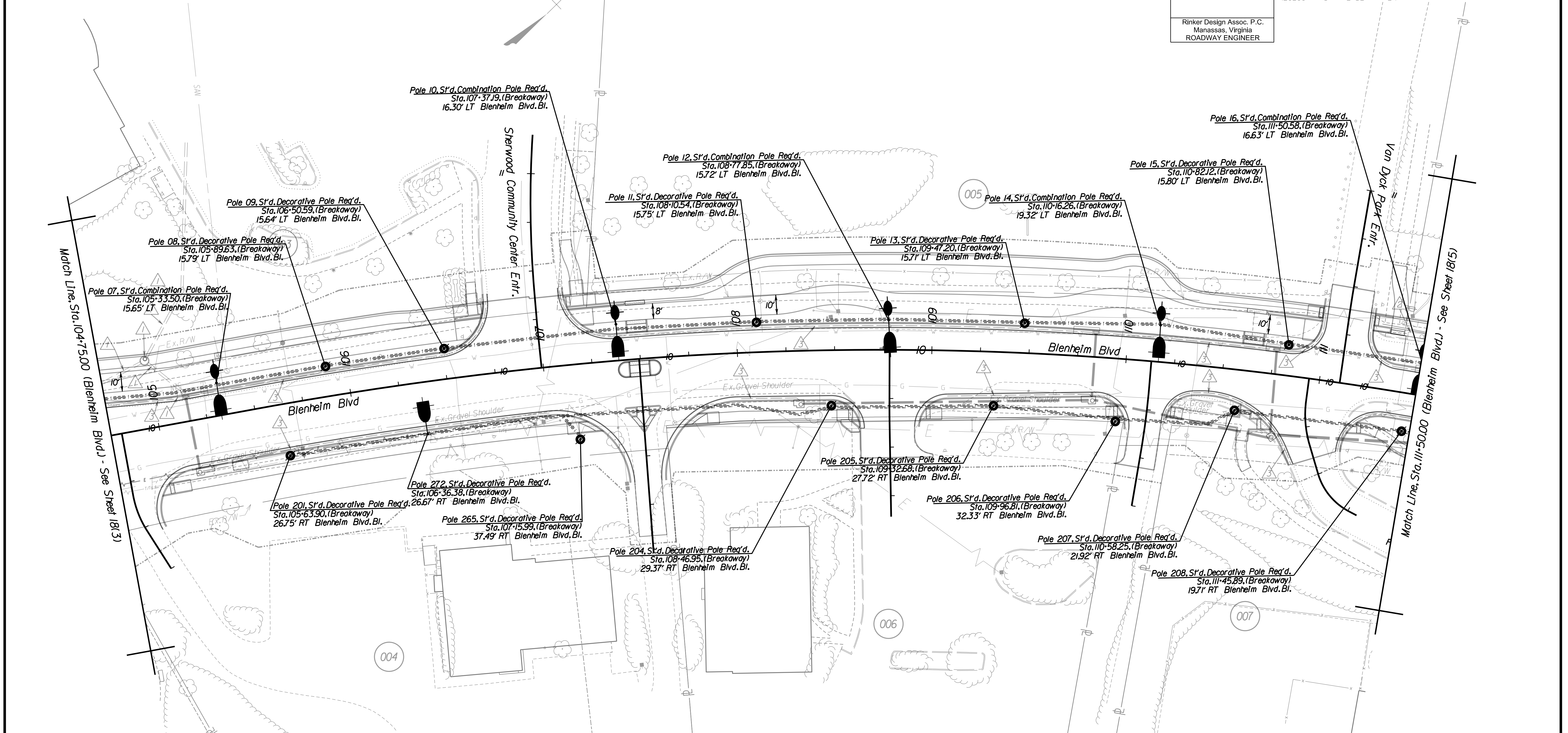

### REFERENCES (PROFILES, DETAIL & DRAINAGE DESCRIPTION SHEETS, ETC.)

Survey Control Data Sheet	IF
Geometric Data Sheet	1G(4)
Horizontal Constr. Alignment Data	1G(1A) - 1G(1F)
Erosion Controls Ph1 & Ph2	10 - 10(6)
Typical Sections	2A - 2A(7)
Drainage Descriptions	2G - 2G(3)
Profile Blenheim Blvd	4A
Profile Entrances	4B
Pavement Marking & Signing Plan	15 Series
Intersection/Bus Stop Detail Plan	1H Series

SCALE	PROJECT	SHEET NO.
0 25' 50'	U000-154-R94	18(4)

PH PLANS      THESE PLANS ARE UNFINISHED AND UNAPPROVED AND ARE NOT TO BE USED FOR CONSTRUCTION.      ADDITIONAL EASEMENTS FOR UTILITY RELOCATIONS MAY BE REQUIRED BEYOND THE PROPOSED RIGHT-OF-WAY SHOWN ON THESE PLANS.



PROJECT MANAGER Wendy Block Sanford, (703) 385-7889  
SURVEYED BY, DATE Nick Kougalis, L.S., (703) 368-7373 (2020)  
DESIGN BY Mark A. Gunn, P.E., (703) 368-7373  
SUBSURFACE UTILITY BY, DATE AccuMark, (800) 542-2990 (2015)

COMMONWEALTH OF VIRGINIA  
ADAM D. WELSCHENBACH  
Lic. No. 044359  
PROFESSIONAL ENGINEER

Rinker Design Assoc. P.C.  
Manassas, Virginia  
ROADWAY ENGINEER

REVISED	STATE	ROUTE	STATE	PROJECT	SHEET NO.
	VA.	6228		U000-154-R94	18(5)

DESIGN FEATURES RELATING TO CONSTRUCTION OR TO REGULATION AND CONTROL OF TRAFFIC MAY BE SUBJECT TO CHANGE AS DEEMED NECESSARY BY THE DEPARTMENT

# Roadway Lighting Plan

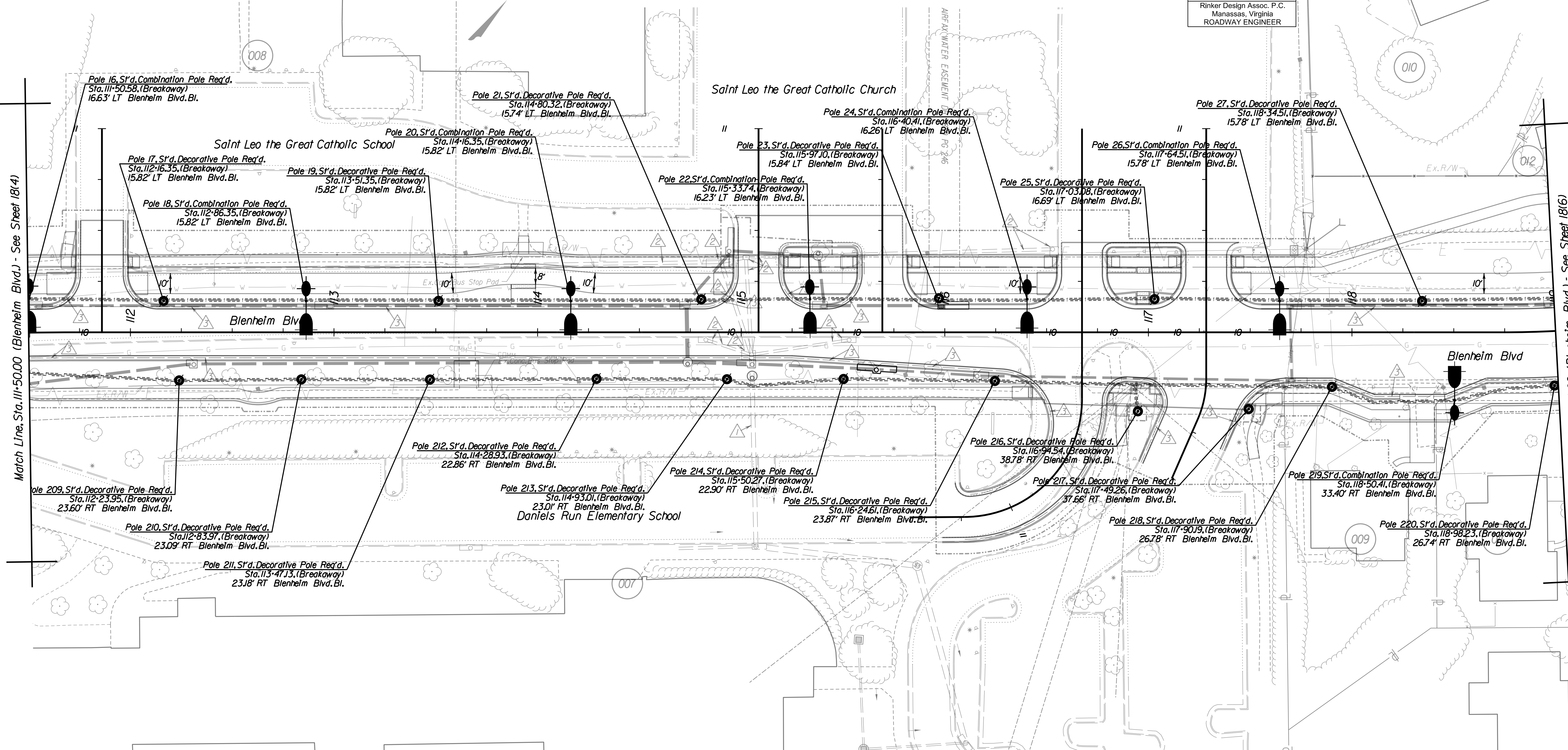

### REFERENCES (PROFILES, DETAIL & DRAINAGE DESCRIPTION SHEETS, ETC.)

Survey Control Data Sheet	IF
Geometric Data Sheet	IG(5)
Horizontal Constr. Alignment Data	IG(1A) - IG(1F)
Erosion Controls Ph1 & Ph2	IO - IO(6)
Typical Sections	2A - 2A(7)
Drainage Descriptions	2G - 2G(3)
Profile Blenheim Blvd	5A
Profile Entrances	5B
Pavement Marking & Signing Plan	15 Series
Intersection/Bus Stop Detail Plan	1H Series

SCALE: 0 25' 50'

PROJECT: U000-154-R94

SHEET NO.: 18(5)

PH PLANS

THESE PLANS ARE UNFINISHED AND UNAPPROVED AND ARE NOT TO BE USED FOR CONSTRUCTION.

ADDITIONAL EASEMENTS FOR UTILITY RELOCATIONS MAY BE REQUIRED BEYOND THE PROPOSED RIGHT-OF-WAY SHOWN ON THESE PLANS.

PROJECT MANAGER Wendy Block Sanford, (703) 385-7889  
SURVEYED BY, DATE Nick Kougalis, L.S., (703) 368-7373 (2020)  
DESIGN BY Mark A. Gunn, P.E., (703) 368-7373  
SUBSURFACE UTILITY BY, DATE AccuMark, (800) 542-2990 (2015)

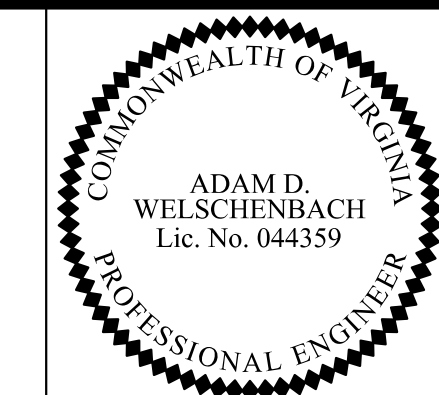

Rinker Design Assoc. P.C.  
Manassas, Virginia  
ROADWAY ENGINEER

REVISED	STATE	ROUTE	STATE PROJECT	SHEET NO.
	VA.	6228	U000-154-R94	18(6)

DESIGN FEATURES RELATING TO CONSTRUCTION OR TO REGULATION AND CONTROL OF TRAFFIC MAY BE SUBJECT TO CHANGE AS DEEMED NECESSARY BY THE DEPARTMENT

Spring Lake Ter.

# Roadway Lighting Plan

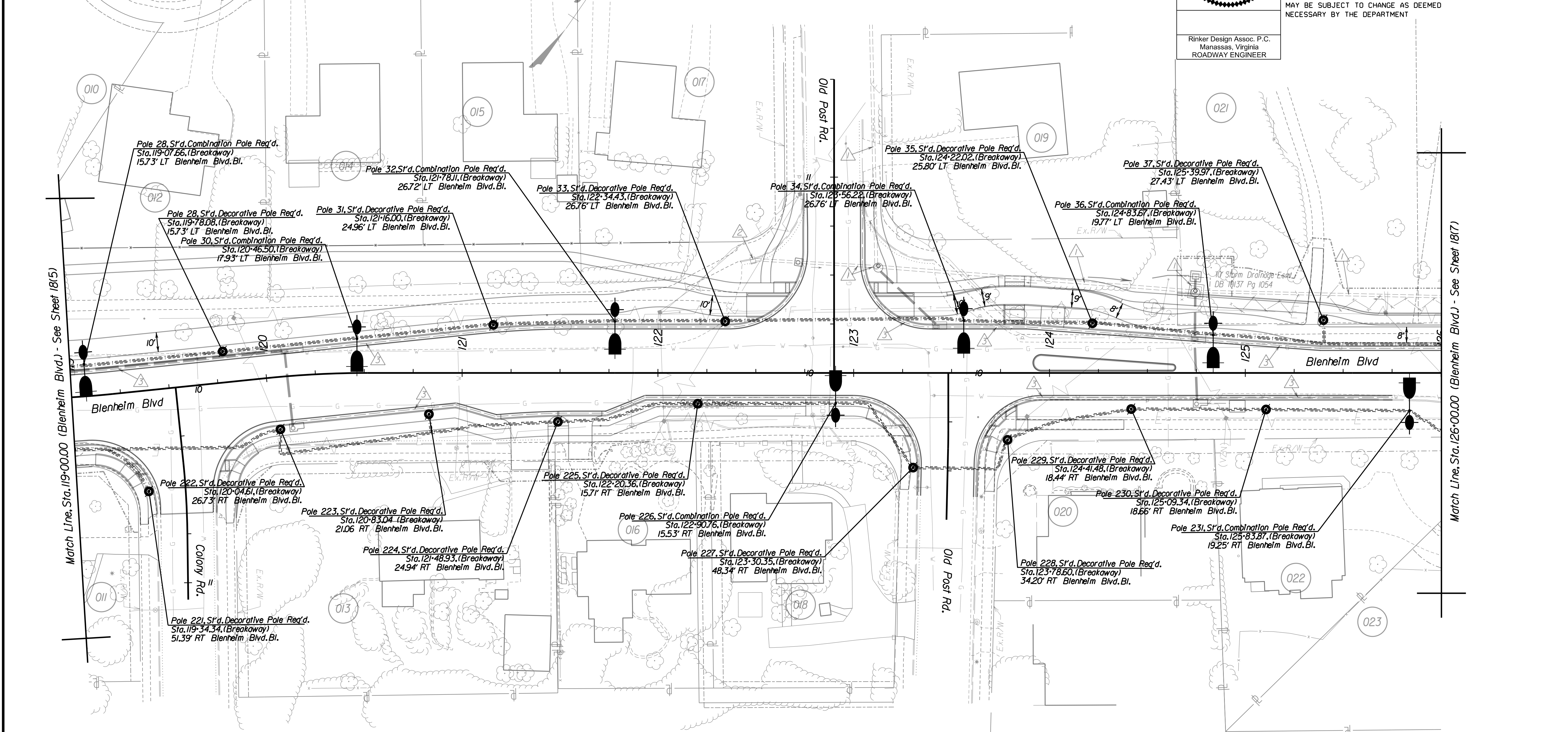

Match Line, Sta. 119+00.00 (Blenheim Blvd.) - See Sheet 18(5)

Match Line, Sta. 126+00.00 (Blenheim Blvd.) - See Sheet 18(7)

### REFERENCES (PROFILES, DETAIL & DRAINAGE DESCRIPTION SHEETS, ETC.)

Survey Control Data Sheet	IF
Geometric Data Sheet	IG(6)
Horizontal Constr. Alignment Data	IG(1A) - IG(1F)
Erosion Controls Plan & Ph2	IO - IR(6)
Typical Sections	2A - 2A(7)
Drainage Descriptions	2G - 2G(3)
Profile Blenheim Blvd	6A
Profile Entrances	6B
Pavement Marking & Signing Plan	15 Series
Inter section/Bus Stop Detail Plan	1H Series

SCALE	PROJECT	SHEET NO.
0 25' 50'	U000-154-R94	18(6)

PH PLANS THESE PLANS ARE UNFINISHED AND UNAPPROVED AND ARE NOT TO BE USED FOR CONSTRUCTION. ADDITIONAL EASEMENTS FOR UTILITY RELOCATIONS MAY BE REQUIRED BEYOND THE PROPOSED RIGHT-OF-WAY SHOWN ON THESE PLANS.



PROJECT MANAGER Wendy Block Sanford, (703) 385-7889  
SURVEYED BY, DATE Nick Kougalis, L.S., (703) 368-7373 (2020)  
DESIGN BY Mark A. Gunn, P.E., (703) 368-7373  
SUBSURFACE UTILITY BY, DATE AccuMark, (800) 542-2990 (2015)

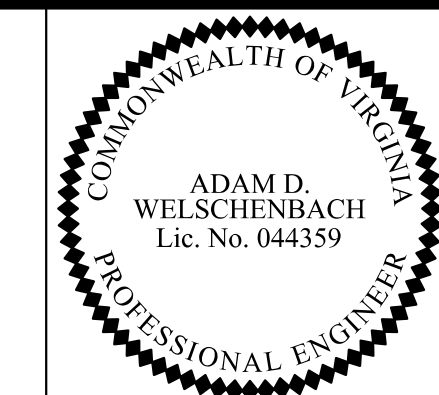

Rinker Design Assoc. P.C.  
Manassas, Virginia  
ROADWAY ENGINEER

REVISED	STATE	ROUTE	PROJECT	SHEET NO.
	VA.	6228	U000-154-R94	18(7)

DESIGN FEATURES RELATING TO CONSTRUCTION OR TO REGULATION AND CONTROL OF TRAFFIC MAY BE SUBJECT TO CHANGE AS DEEMED NECESSARY BY THE DEPARTMENT

# Roadway Lighting Plan

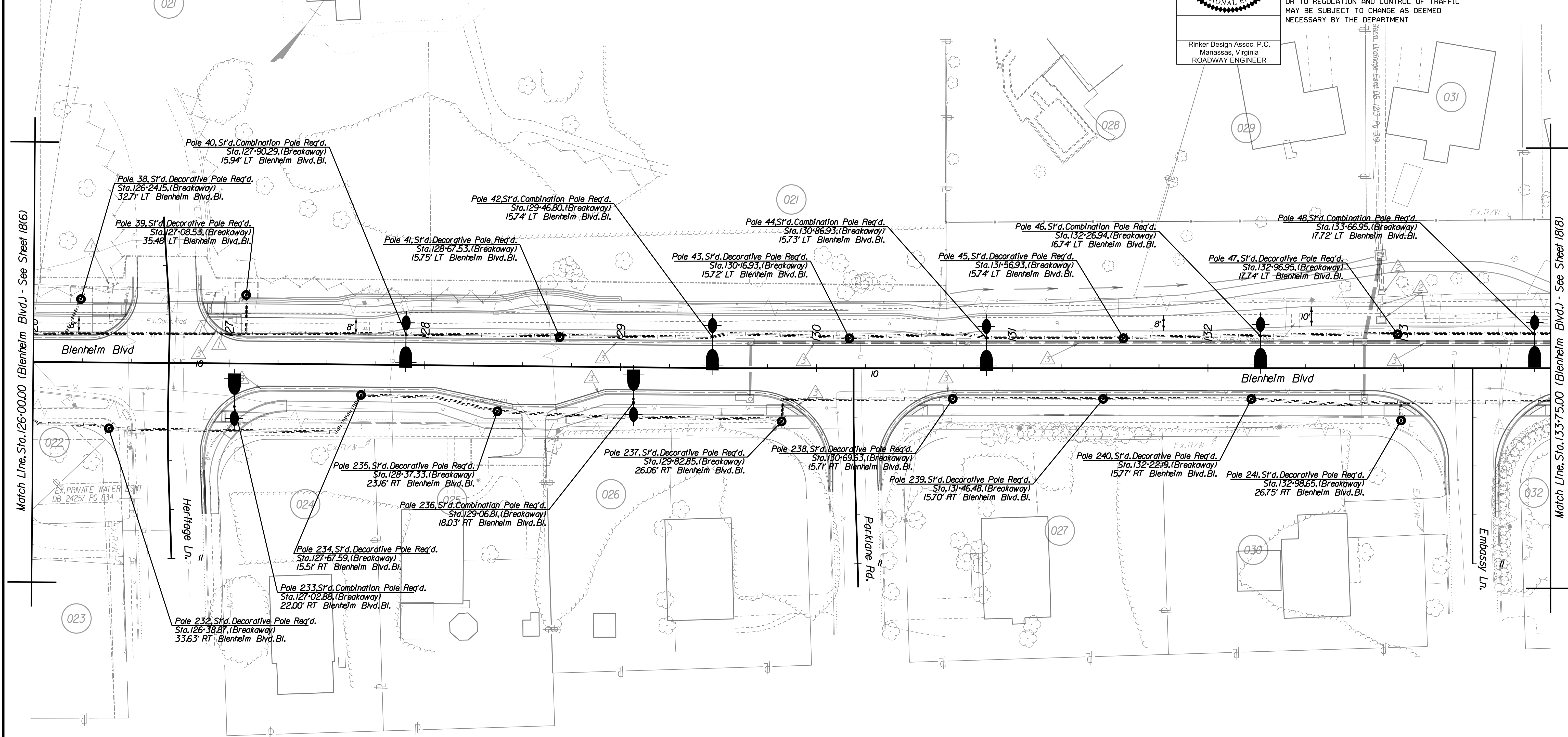

Match Line, Sta. 126+00.00 (Blenheim Blvd.) - See Sheet 18(6)

Match Line, Sta. 133+75.00 (Blenheim Blvd.) - See Sheet 18(8)

### REFERENCES (PROFILES, DETAIL & DRAINAGE DESCRIPTION SHEETS, ETC.)

Survey Control Data Sheet	IF
Geometric Data Sheet	IG(7)
Horizontal Constr. Alignment Data	IG(1A) - IG(1F)
Erosion Controls Ph1 & Ph2	IO - IO(6)
Typical Sections	2A - 2A(7)
Drainage Descriptions	2G - 2G(3)
Profile Blenheim Blvd	7A
Profile Side Roads	7B
Pavement Marking & Signing Plan	15 Series
Intersection/Bus Stop Detail Plan	1H Series

SCALE	PROJECT	SHEET NO.
0 25' 50'	U000-154-R94	18(7)

PH PLANS THESE PLANS ARE UNFINISHED AND UNAPPROVED AND ARE NOT TO BE USED FOR CONSTRUCTION. ADDITIONAL EASEMENTS FOR UTILITY RELOCATIONS MAY BE REQUIRED BEYOND THE PROPOSED RIGHT-OF-WAY SHOWN ON THESE PLANS.



PROJECT MANAGER Wendy Block Sanford, (703) 385-7889  
SURVEYED BY, DATE Nick Kougalis, L.S., (703) 368-7373 (2020)  
DESIGN BY Mark A. Gunn, P.E., (703) 368-7373  
SUBSURFACE UTILITY BY, DATE AccuMark, (800) 542-2990 (2015)

COMMONWEALTH OF VIRGINIA  
ADAM D. WELSCHENBACH  
Lic. No. 044359  
PROFESSIONAL ENGINEER

Rinker Design Assoc. P.C.  
Manassas, Virginia  
ROADWAY ENGINEER

REVISED	STATE	ROUTE	STATE PROJECT	SHEET NO.
	VA.	6228	U000-154-R94	18(8)

DESIGN FEATURES RELATING TO CONSTRUCTION OR TO REGULATION AND CONTROL OF TRAFFIC MAY BE SUBJECT TO CHANGE AS DEEMED NECESSARY BY THE DEPARTMENT

# Roadway Lighting Plan

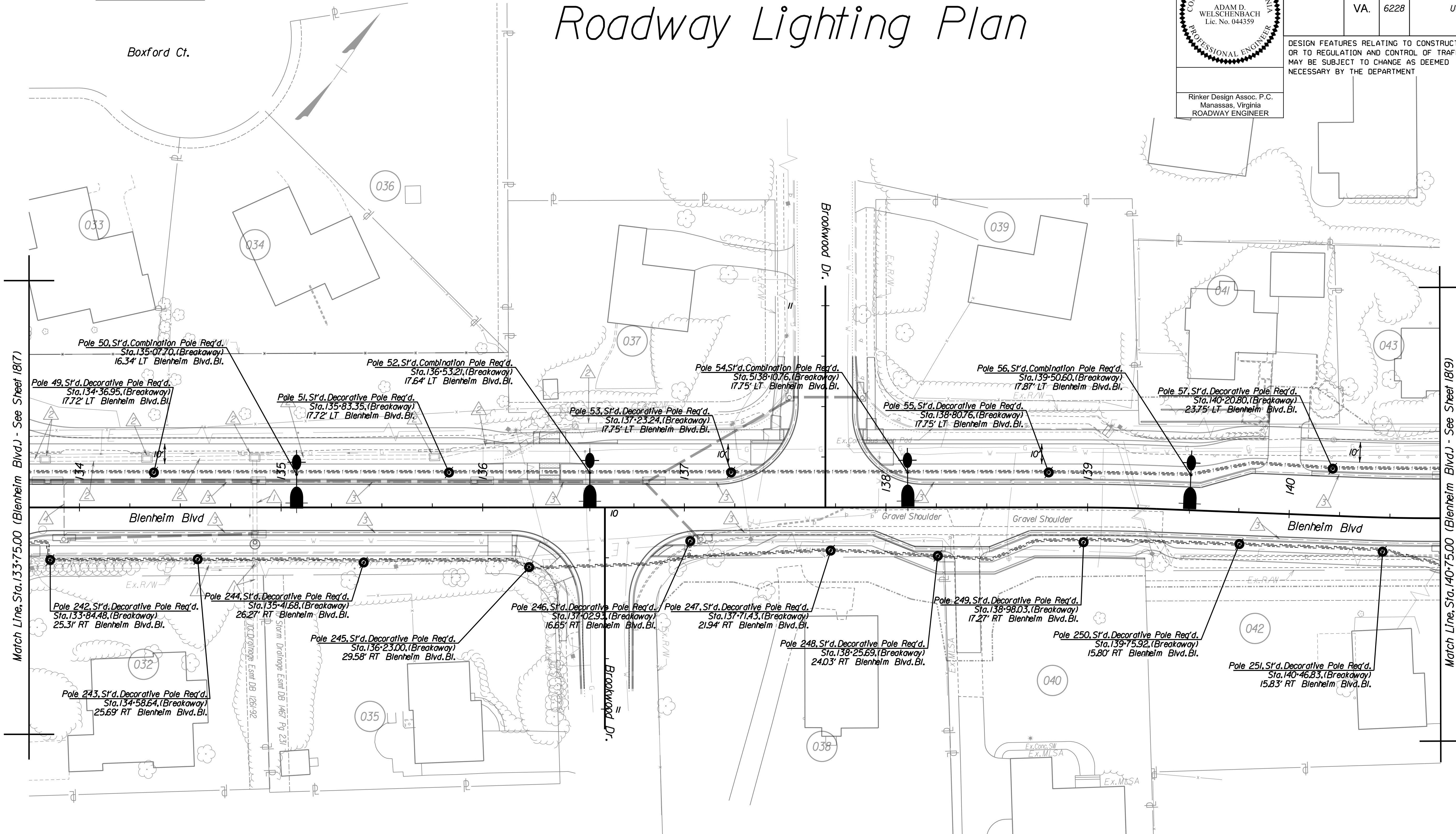

Match Line, Sta. 133+75.00 (Blenheim Blvd.) - See Sheet 18(7)

Match Line, Sta. 140+75.00 (Blenheim Blvd.) - See Sheet 18(9)

### REFERENCES (PROFILES, DETAIL & DRAINAGE DESCRIPTION SHEETS, ETC.)

Survey Control Data Sheet	IF
Geometric Data Sheet	IG(8)
Horizontal Constr. Alignment Data	IG(1A) - IG(1F)
Erosion Controls Ph1 & Ph2	IO - IR(6)
Typical Sections	2A - 2A(7)
Drainage Descriptions	2G - 2G(3)
Profile Blenheim Blvd	8A
Profile Brookwood Drive	8B
Pavement Marking & Signing Plan	15 Series
Intersection/Bus Stop Detail Plan	1H Series

SCALE	PROJECT	SHEET NO.
0 25' 50'	U000-154-R94	18(8)

PH PLANS THESE PLANS ARE UNFINISHED AND UNAPPROVED AND ARE NOT TO BE USED FOR CONSTRUCTION. ADDITIONAL EASEMENTS FOR UTILITY RELOCATIONS MAY BE REQUIRED BEYOND THE PROPOSED RIGHT-OF-WAY SHOWN ON THESE PLANS.

PROJECT MANAGER Wendy Block Sanford, (703) 385-7889  
SURVEYED BY, DATE Nick Kougalis, L.S., (703) 368-7373 (2020)  
DESIGN BY Mark A. Gunn, P.E., (703) 368-7373  
SUBSURFACE UTILITY BY, DATE AccuMark, (800) 542-2990 (2015)

COMMONWEALTH OF VIRGINIA  
ADAM D. WELSCHENBACH  
Lic. No. 044359  
PROFESSIONAL ENGINEER

Rinker Design Assoc. P.C.  
Manassas, Virginia  
ROADWAY ENGINEER

REVISED	STATE	ROUTE	STATE PROJECT	SHEET NO.
	VA.	6228	U000-154-R94	18(9)

DESIGN FEATURES RELATING TO CONSTRUCTION OR TO REGULATION AND CONTROL OF TRAFFIC MAY BE SUBJECT TO CHANGE AS DEEMED NECESSARY BY THE DEPARTMENT

# Roadway Lighting Plan

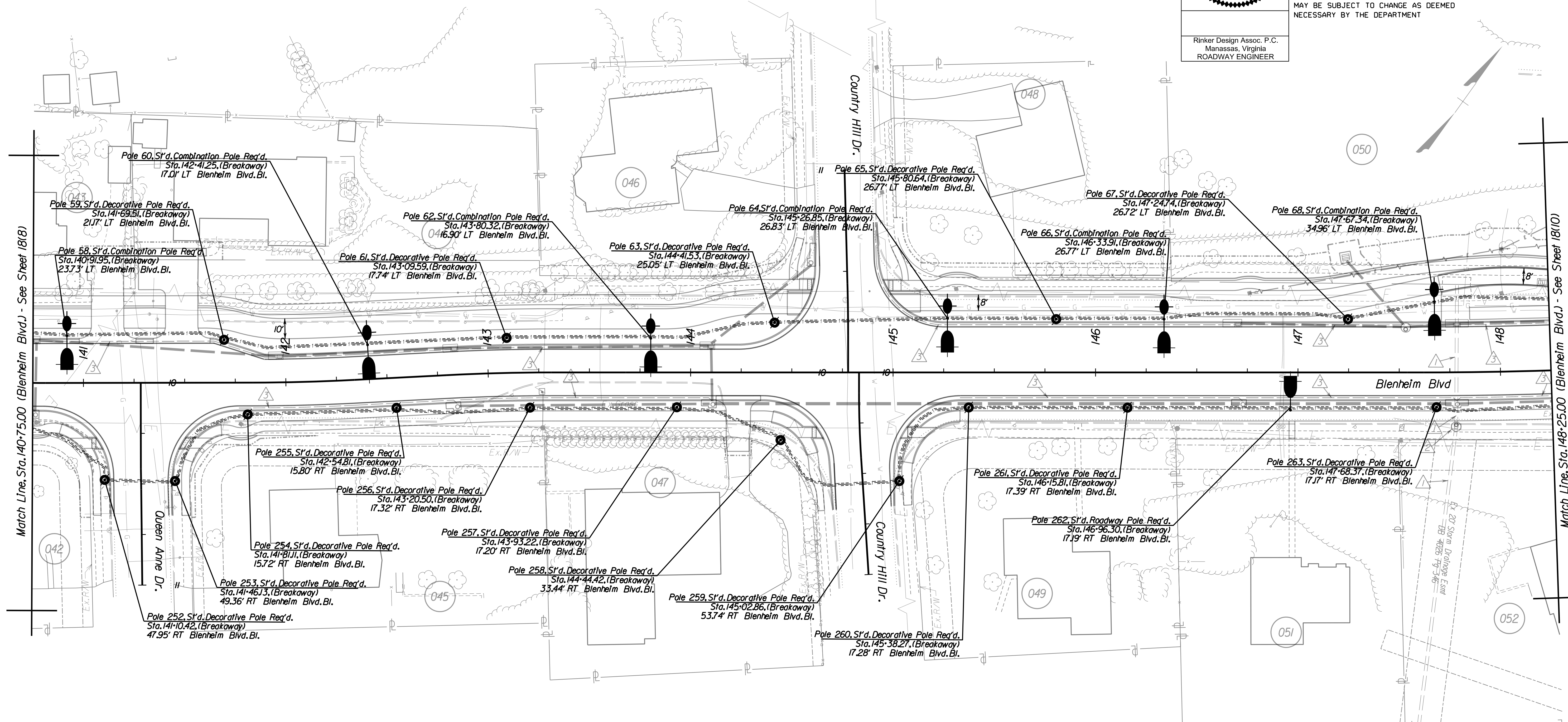

Match Line, Sta. 140+75.00 (Blenheim Blvd.) - See Sheet 18(B)

Match Line, Sta. 148+25.00 (Blenheim Blvd.) - See Sheet 18(C)

### REFERENCES (PROFILES, DETAIL & DRAINAGE DESCRIPTION SHEETS, ETC.)

Survey Control Data Sheet	IF
Geometric Data Sheet	IG(9)
Horizontal Constr. Alignment Data	IG(1A) - IG(1F)
Erosion Controls Ph1 & Ph2	IO - IR(6)
Typical Sections	2A - 2A(7)
Drainage Descriptions	2G - 2G(3)
Profile Blenheim Blvd	9A
Profile Side Roads	9B
Pavement Marking & Signing Plan	15 Series
Intersection/Bus Stop Detail Plan	1H Series

SCALE	PROJECT	SHEET NO.
0 25' 50'	U000-154-R94	18(9)

PH PLANS THESE PLANS ARE UNFINISHED AND UNAPPROVED AND ARE NOT TO BE USED FOR CONSTRUCTION. ADDITIONAL EASEMENTS FOR UTILITY RELOCATIONS MAY BE REQUIRED BEYOND THE PROPOSED RIGHT-OF-WAY SHOWN ON THESE PLANS.



PROJECT MANAGER Wendy Block Sanford, (703) 385-7889  
SURVEYED BY, DATE Nick Kougalis, L.S., (703) 368-7373 (2020)  
DESIGN BY Mark A. Gunn, P.E., (703) 368-7373  
SUBSURFACE UTILITY BY, DATE AccuMark, (800) 542-2990 (2015)

COMMONWEALTH OF VIRGINIA  
ADAM D. WELSCHENBACH  
Lic. No. 044359  
PROFESSIONAL ENGINEER

Rinker Design Assoc. P.C.  
Manassas, Virginia  
ROADWAY ENGINEER

REVISED	STATE	ROUTE	STATE PROJECT	SHEET NO.
	VA.	6228	U000-154-R94	18(10)

DESIGN FEATURES RELATING TO CONSTRUCTION OR TO REGULATION AND CONTROL OF TRAFFIC MAY BE SUBJECT TO CHANGE AS DEEMED NECESSARY BY THE DEPARTMENT

# Roadway Lighting Plan

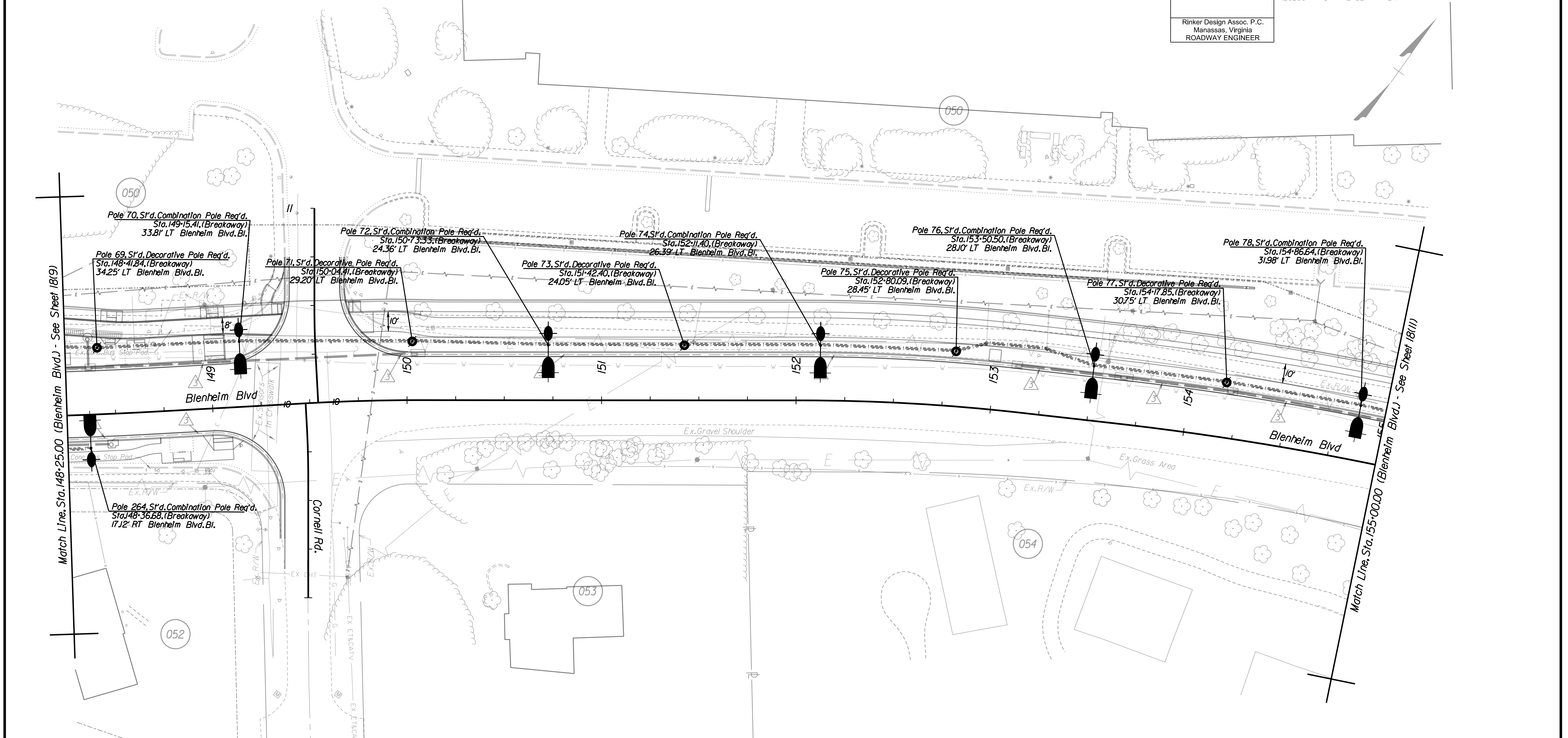

### REFERENCES (PROFILES, DETAIL & DRAINAGE DESCRIPTION SHEETS, ETC.)

Survey Control Data Sheet	IF
Geometric Data Sheet	IG(10)
Horizontal Constr. Alignment Data	IG(1A) - IG(1F)
Erosion Controls Ph1 & Ph2	10 - 1R(6)
Typical Sections	2A - 2A(7)
Drainage Descriptions	2G - 2G(3)
Profile Blenheim Blvd	10A
Profile Cornell Rd., Entrance	10B
Pavement Marking & Signing Plan	15 Series
Intersection/Bus Stop Detail Plan	1H Series

SCALE 0 25' 50'	PROJECT U000-154-R94	SHEET NO. 18(10)
--------------------	-------------------------	---------------------

PH PLANS      THESE PLANS ARE UNFINISHED AND UNAPPROVED AND ARE NOT TO BE USED FOR CONSTRUCTION.      ADDITIONAL EASEMENTS FOR UTILITY RELOCATIONS MAY BE REQUIRED BEYOND THE PROPOSED RIGHT-OF-WAY SHOWN ON THESE PLANS.



PROJECT MANAGER Wendy Block Sanford, (703) 385-7889  
SURVEYED BY, DATE Nick Kougalis, L.S., (703) 368-7373 (2020)  
DESIGN BY Mark A. Gunn, P.E., (703) 368-7373  
SUBSURFACE UTILITY BY, DATE AccuMark, (800) 542-2990 (2015)

COMMONWEALTH OF VIRGINIA  
ADAM D. WELSCHENBACH  
Lic. No. 044359  
PROFESSIONAL ENGINEER

Rinker Design Assoc. P.C.  
Manassas, Virginia  
ROADWAY ENGINEER

REVISED	STATE	ROUTE	STATE	PROJECT	SHEET NO.
	VA.	6228		U000-154-R94	18(11)

DESIGN FEATURES RELATING TO CONSTRUCTION OR TO REGULATION AND CONTROL OF TRAFFIC MAY BE SUBJECT TO CHANGE AS DEEMED NECESSARY BY THE DEPARTMENT

# Roadway Lighting Plan

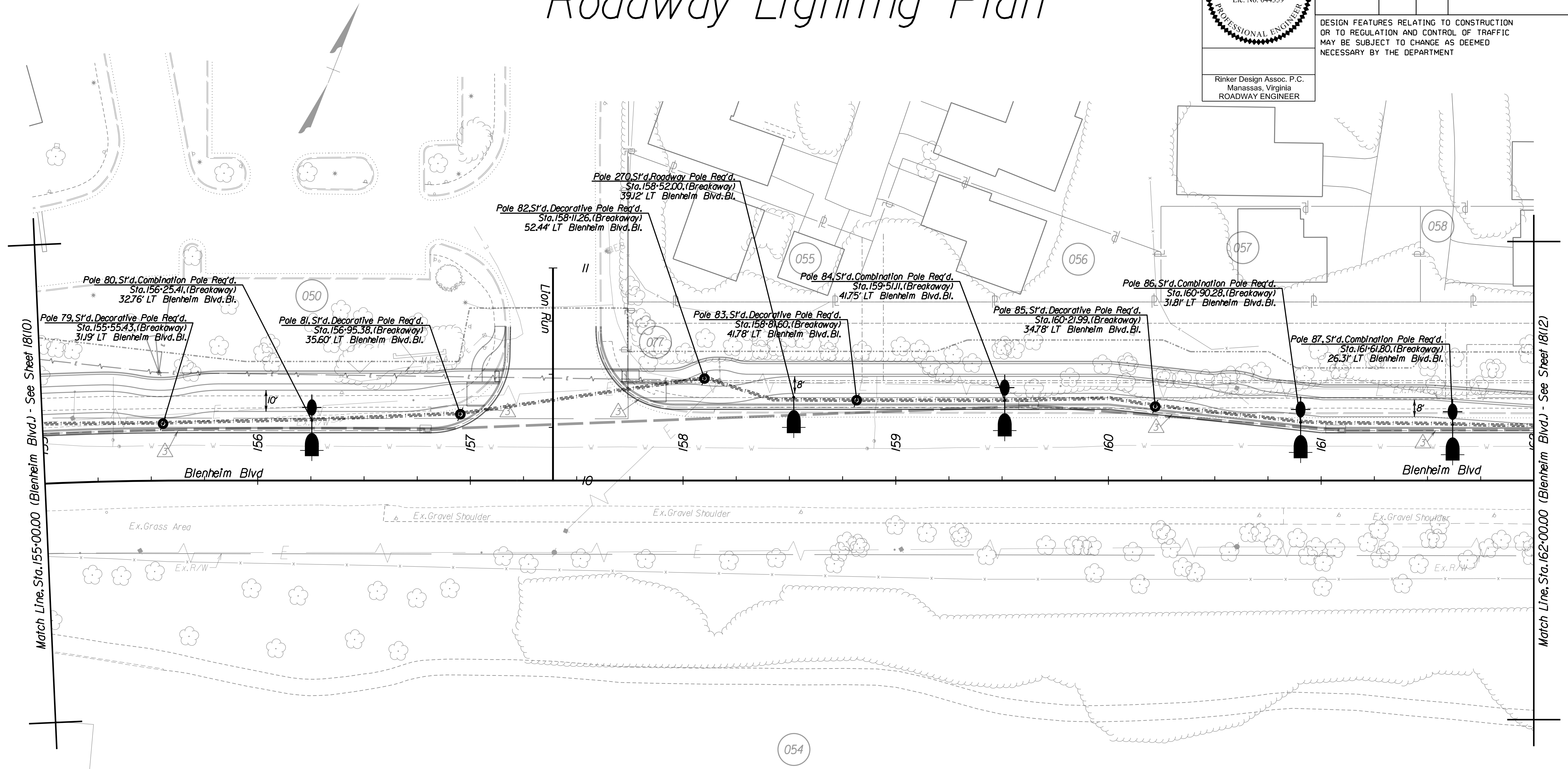

Match Line, Sta. 155+00.00 (Blenheim Blvd.) - See Sheet 18(10)

Match Line, Sta. 162+00.00 (Blenheim Blvd.) - See Sheet 18(12)

REFERENCES  
(PROFILES, DETAIL & DRAINAGE DESCRIPTION SHEETS, ETC.)

Survey Control Data Sheet	IF
Geometric Data Sheet	IG(11)
Horizontal Constr. Alignment Data	IG(1A) - IG(1F)
Erosion Controls PhJ & Ph2	IO - IR(6)
Typical Sections	2A - 2A(7)
Drainage Descriptions	2G - 2G(3)
Profile Blenheim Blvd	IIA
Profile Lion Run	IIB
Pavement Marking & Signing Plan	I5 Series
Intersection/Bus Stop Detail Plan	IH Series

SCALE 0 25' 50'

PROJECT U000-154-R94 SHEET NO. 18(11)

PH PLANS THESE PLANS ARE UNFINISHED AND UNAPPROVED AND ARE NOT TO BE USED FOR CONSTRUCTION.

ADDITIONAL EASEMENTS FOR UTILITY RELOCATIONS MAY BE REQUIRED BEYOND THE PROPOSED RIGHT-OF-WAY SHOWN ON THESE PLANS.

PROJECT MANAGER Wendy Block Sanford, (703) 385-7889  
SURVEYED BY, DATE Nick Kougalis, L.S., (703) 368-7373 (2020)  
DESIGN BY Mark A. Gunn, P.E., (703) 368-7373  
SUBSURFACE UTILITY BY, DATE AccuMark, (800) 542-2990 (2015)

COMMONWEALTH OF VIRGINIA  
ADAM D. WELSCHENBACH  
Lic. No. 044359  
PROFESSIONAL ENGINEER

Rinker Design Assoc. P.C.  
Manassas, Virginia  
ROADWAY ENGINEER

REVISED	STATE	ROUTE	STATE PROJECT	SHEET NO.
	VA.	6228	U000-154-R94	18(12)

DESIGN FEATURES RELATING TO CONSTRUCTION OR TO REGULATION AND CONTROL OF TRAFFIC MAY BE SUBJECT TO CHANGE AS DEEMED NECESSARY BY THE DEPARTMENT

# Roadway Lighting Plan

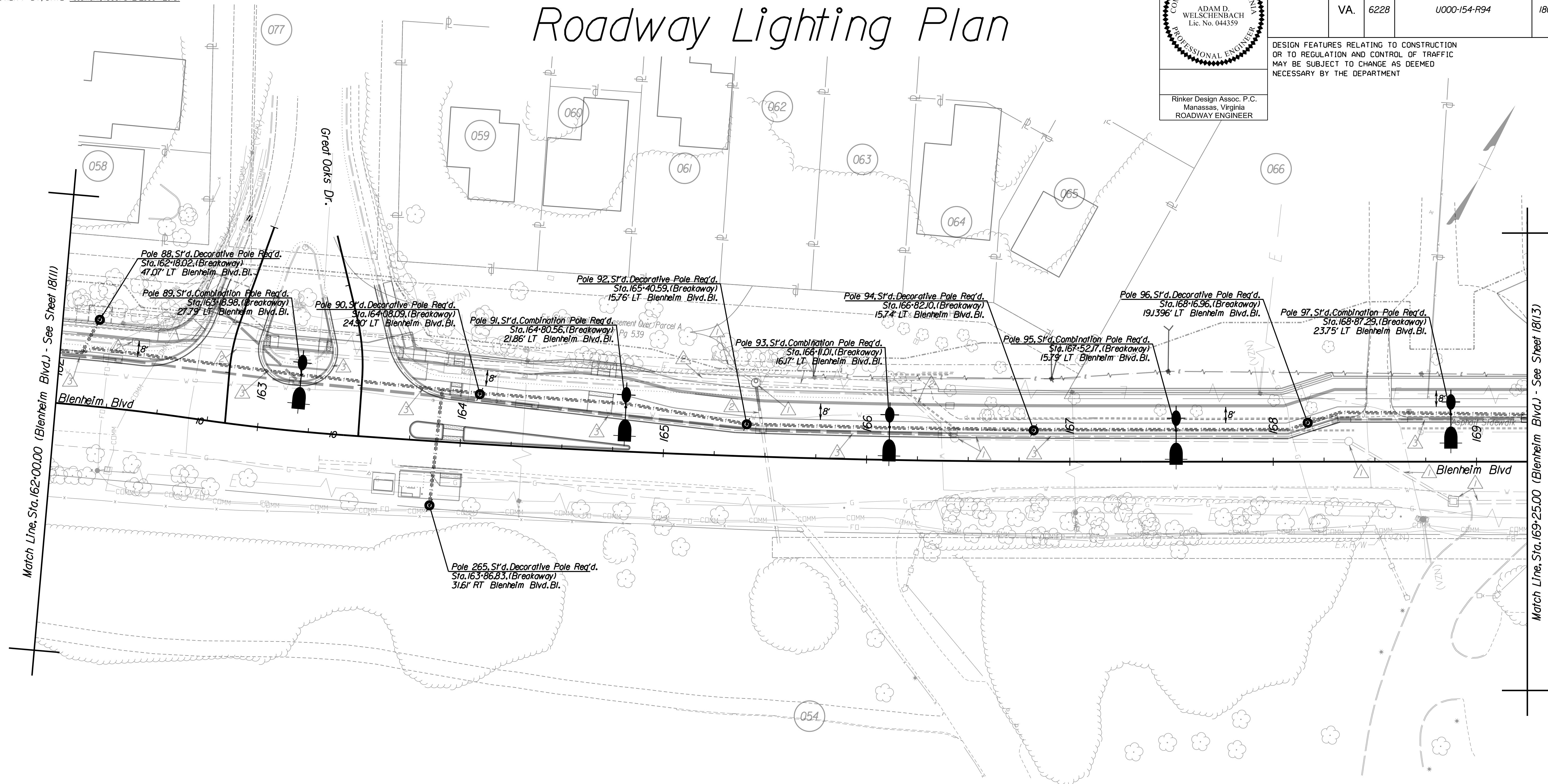

### REFERENCES (PROFILES, DETAIL & DRAINAGE DESCRIPTION SHEETS, ETC.)

- Survey Control Data Sheet IF
- Geometric Data Sheet 1G(12)
- Horizontal Constr. Alignment Data 1G(1A) - 1G(1F)
- Erosion Controls Ph1 & Ph2 1O - 1O(6)
- Typical Sections 2A - 2A(7)
- Drainage Descriptions 2G - 2G(3)
- Profile Blenheim Blvd 12A
- Profile Great Oaks Dr. Entrances 12B
- Pavement Marking & Signing Plan 15 Series
- Intersection/Bus Stop Detail Plan 1H Series

SCALE 0 25' 50'

PROJECT U000-154-R94 SHEET NO. 18(12)

PH PLANS THESE PLANS ARE UNFINISHED AND UNAPPROVED AND ARE NOT TO BE USED FOR CONSTRUCTION. ADDITIONAL EASEMENTS FOR UTILITY RELOCATIONS MAY BE REQUIRED BEYOND THE PROPOSED RIGHT-OF-WAY SHOWN ON THESE PLANS.

PROJECT MANAGER *Wendy Block Sanford, (703) 385-7889*  
SURVEYED BY, DATE *Nick Kougalis, L.S., (703) 368-7373 (2020)*  
DESIGN BY *Mark A. Gunn, P.E., (703) 368-7373*  
SUBSURFACE UTILITY BY, DATE *Accumark, (800) 542-2990 (2015)*

COMMONWEALTH OF VIRGINIA  
 ADAM D. WELSCHENBACH  
 Lic. No. 044359  
 PROFESSIONAL ENGINEER

Rinker Design Assoc. P.C.  
 Manassas, Virginia  
 ROADWAY ENGINEER

REVISED	STATE	STATE		SHEET NO.
	ROUTE	PROJECT		
	VA.	6228	U000-154-R94	18(13)

DESIGN FEATURES RELATING TO CONSTRUCTION OR TO REGULATION AND CONTROL OF TRAFFIC MAY BE SUBJECT TO CHANGE AS DEEMED NECESSARY BY THE DEPARTMENT

# Roadway Lighting Plan

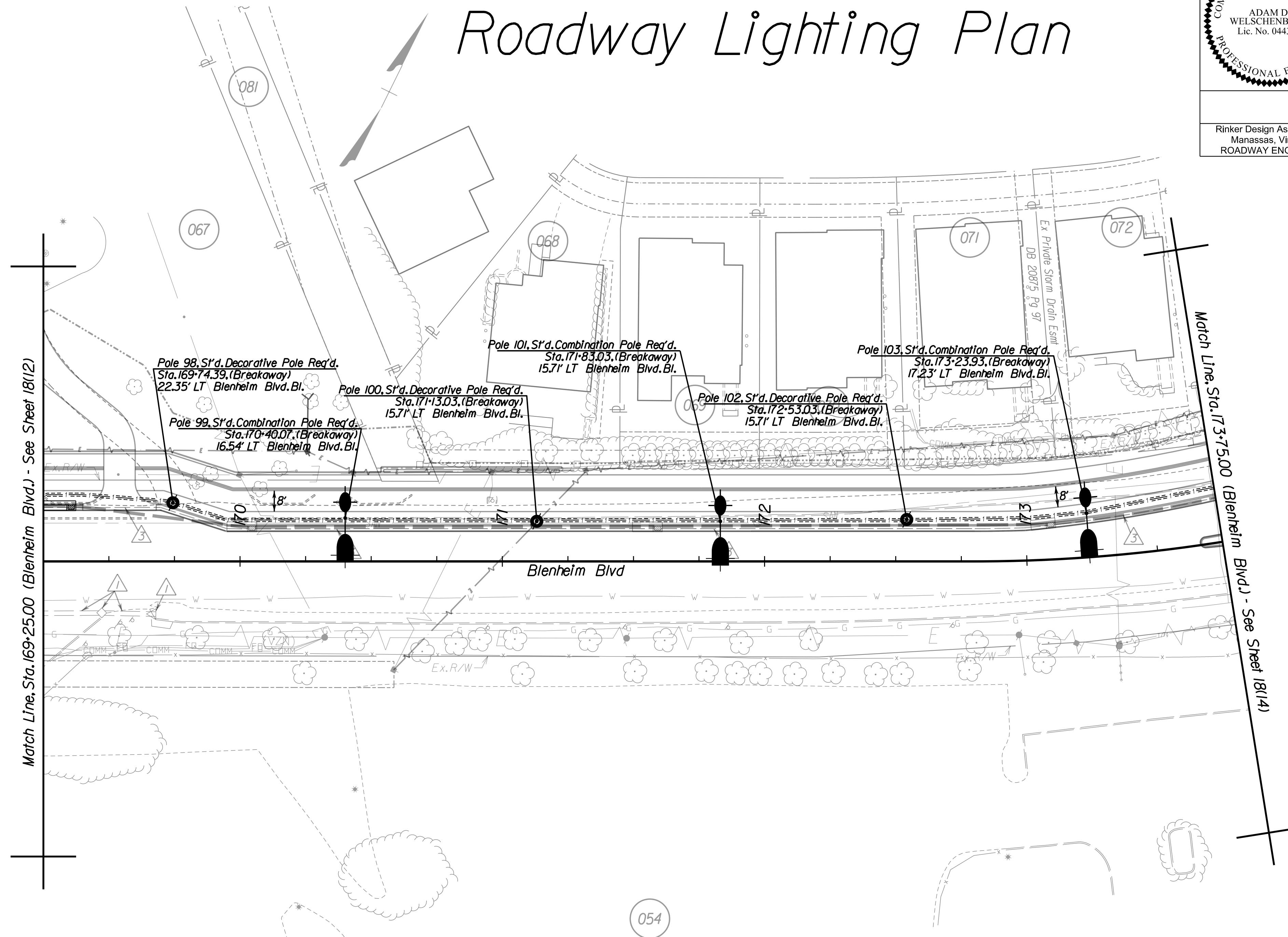

### REFERENCES (PROFILES, DETAIL & DRAINAGE DESCRIPTION SHEETS, ETC.)

Survey Control Data Sheet	IF
Geometric Data Sheet	1G(13)
Horizontal Constr. Alignment Data	1G(1A) - 1G(1F)
Erosion Controls Ph1 & Ph2	10 - 1R(6)
Typical Sections	2A - 2A(7)
Drainage Descriptions	2G - 2G(3)
Profile Blenheim Blvd	13A
Profile Entrances	13B
Pavement Marking & Signing Plan	15 Series
Intersection/Bus Stop Detail Plan	1H Series

SCALE 0 25' 50'	PROJECT U000-154-R94	SHEET NO. 18(13)
--------------------	-------------------------	---------------------

PH PLANS      THESE PLANS ARE UNFINISHED AND UNAPPROVED AND ARE NOT TO BE USED FOR CONSTRUCTION.      ADDITIONAL EASEMENTS FOR UTILITY RELOCATIONS MAY BE REQUIRED BEYOND THE PROPOSED RIGHT-OF-WAY SHOWN ON THESE PLANS.



PROJECT MANAGER Wendy Block Sanford, (703) 385-7889  
SURVEYED BY, DATE Nick Kougalis, L.S., (703) 368-7373 (2020)  
DESIGN BY Mark A. Gunn, P.E., (703) 368-7373  
SUBSURFACE UTILITY BY, DATE AccuMark, (800) 542-2990 (2015)

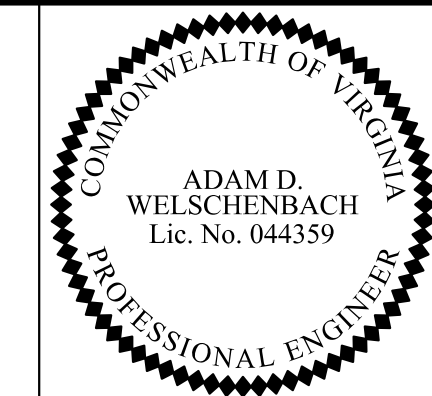

Rinker Design Assoc. P.C.  
Manassas, Virginia  
ROADWAY ENGINEER

REVISED	STATE	ROUTE	STATE PROJECT	SHEET NO.
	VA.	6228	U000-154-R94	18(14)

DESIGN FEATURES RELATING TO CONSTRUCTION OR TO REGULATION AND CONTROL OF TRAFFIC MAY BE SUBJECT TO CHANGE AS DEEMED NECESSARY BY THE DEPARTMENT

# Roadway Lighting Plan

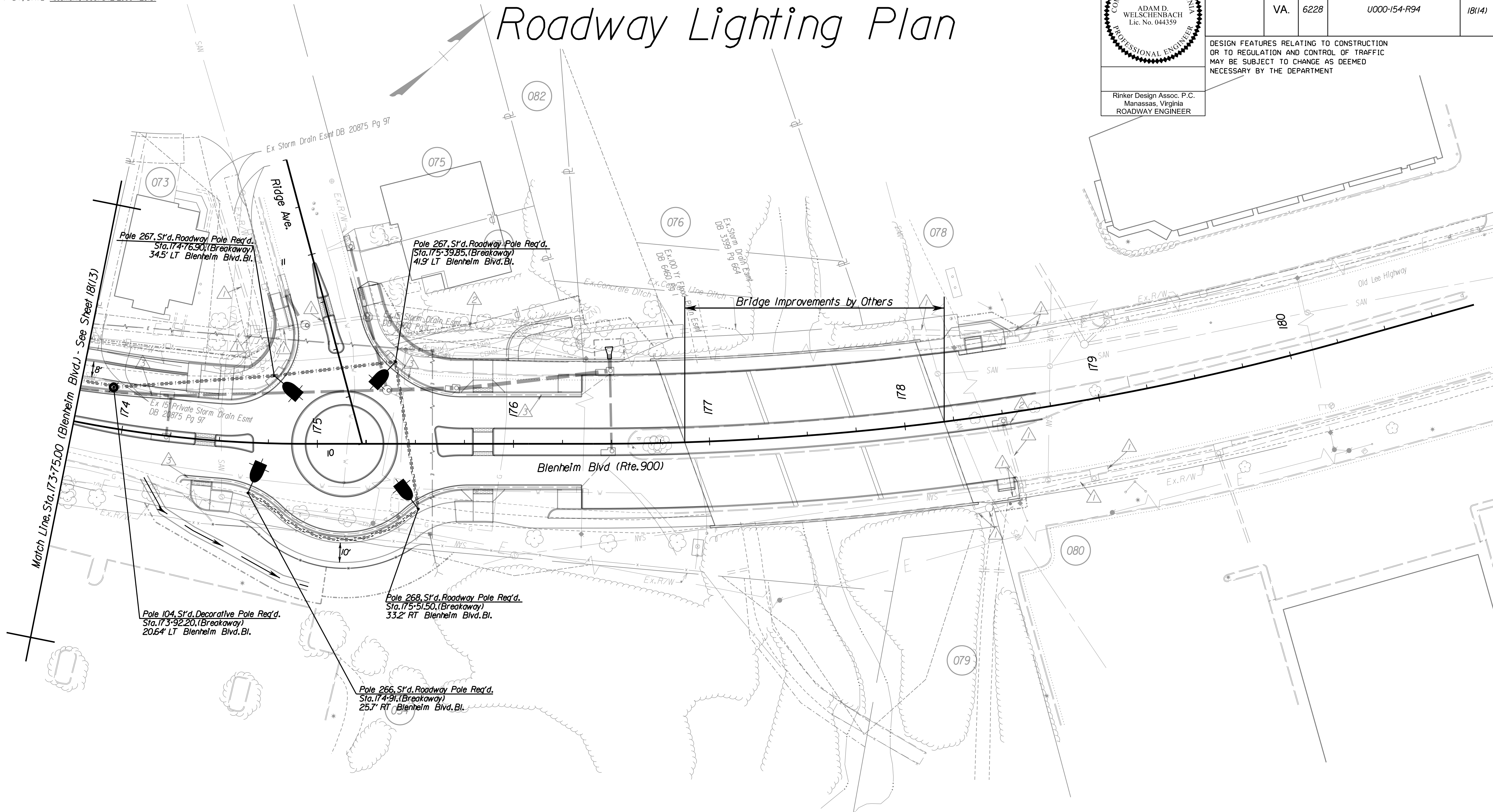

Match Line, Sta. 173+75.00 (Blenheim Blvd.) - See Sheet 18(13)

Pole 267, S't'd. Roadway Pole Req'd.  
Sta. 174+76.90 (Breakaway)  
34.5' LT Blenheim Blvd. Bl.

Pole 267, S't'd. Roadway Pole Req'd.  
Sta. 175+39.85 (Breakaway)  
41.9' LT Blenheim Blvd. Bl.

Pole 104, S't'd. Decorative Pole Req'd.  
Sta. 173+92.20 (Breakaway)  
20.64' LT Blenheim Blvd. Bl.

Pole 268, S't'd. Roadway Pole Req'd.  
Sta. 175+51.50 (Breakaway)  
33.2' RT Blenheim Blvd. Bl.

Pole 266, S't'd. Roadway Pole Req'd.  
Sta. 174+91 (Breakaway)  
25.7' RT Blenheim Blvd. Bl.

### REFERENCES (PROFILES, DETAIL & DRAINAGE DESCRIPTION SHEETS, ETC.)

Survey Control Data Sheet	IF
Geometric Data Sheet	IG(14)
Horizontal Constr. Alignment Data	IG(1A) - IG(1F)
Erosion Controls Ph1 & Ph2	IO - IO(6)
Typical Sections	2A - 2A(7)
Drainage Descriptions	2G - 2G(3)
Profile Blenheim Blvd	14A
Profile Ridge Avenue	14B
Pavement Marking & Signing Plan	15 Series
Intersection/Bus Stop Detail Plan	1H Series

SCALE 0 25' 50'	PROJECT U000-154-R94	SHEET NO. 18(14)
--------------------	-------------------------	---------------------

PH PLANS THESE PLANS ARE UNFINISHED AND UNAPPROVED AND ARE NOT TO BE USED FOR CONSTRUCTION. ADDITIONAL EASEMENTS FOR UTILITY RELOCATIONS MAY BE REQUIRED BEYOND THE PROPOSED RIGHT-OF-WAY SHOWN ON THESE PLANS.