

REV.	DATE	COMMENTS
2	08/19/24	GDP SET THIRD SUBMITTAL
1	07/22/24	GDP SET SECOND SUBMITTAL
0	01/18/24	GDP SET FIRST SUBMISSION

THIS PLAN SET IS FOR PERMITTING PURPOSES ONLY AND MAY NOT BE USED FOR CONSTRUCTION

PROJECT: **SOUTHPIK**
PROPOSED TACO BELL FAST FOOD RESTAURANT W/ DRIVE-THRU
 BOULEVARD MARKETPLACE, PARCEL D
 10120 FAIRFAX BOULEVARD
 CITY OF FAIRFAX, FAIRFAX COUNTY, VIRGINIA

811 PROTECT YOURSELF
 ALL STATES REQUIRE NOTIFICATION OF EXCAVATORS, DESIGNERS, OR ANY PERSON PREPARING TO BEGIN THE EXCAVATION SURFACE ANYWHERE IN ANY STATE
 FOR STATE SPECIFIC DIRECT PHONE NUMBERS VISIT: WWW.CALL811.COM

DYNAMIC ENGINEERING
 LAND DEVELOPMENT CONSULTING • PERMITTING
 GEOTECHNICAL • ENVIRONMENTAL
 TRAFFIC • SURVEY • PLANNING & ZONING
 125 West Street - Suite 201
 Annapolis, MD 21412
 410.567.5000
 Offices conveniently located at:
 Annapolis, MD • 410.567.5000
 Chesapeake Beach, MD • 410.567.5000
 Fairfax, VA • 703.761.2300
 Falls Church, VA • 703.761.2300
 Herndon, VA • 703.761.2300
 Loudoun County, VA • 703.761.2300
 Manassas, VA • 703.761.2300
 Northern Virginia • 703.761.2300
 Quantico, VA • 703.761.2300
 Reston, VA • 703.761.2300
 Silver Spring, MD • 301.787.4400
 Springfield, VA • 703.761.2300
 Washington, DC • 202.778.4400
 Annapolis, MD • 410.567.5000

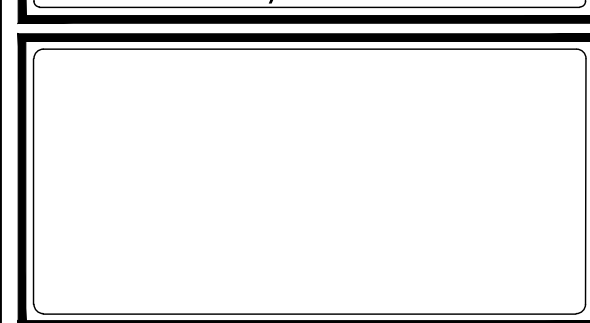

TITLE: **OVERALL GENERAL DEVELOPMENT PLAN & SPECIAL USE PERMIT PLAT**

SCALE: (H) AS NOTED (V) --- DATE: 01/18/2024

PROJECT NO: 3486-22-01538

SHEET NO: **4** OF 19

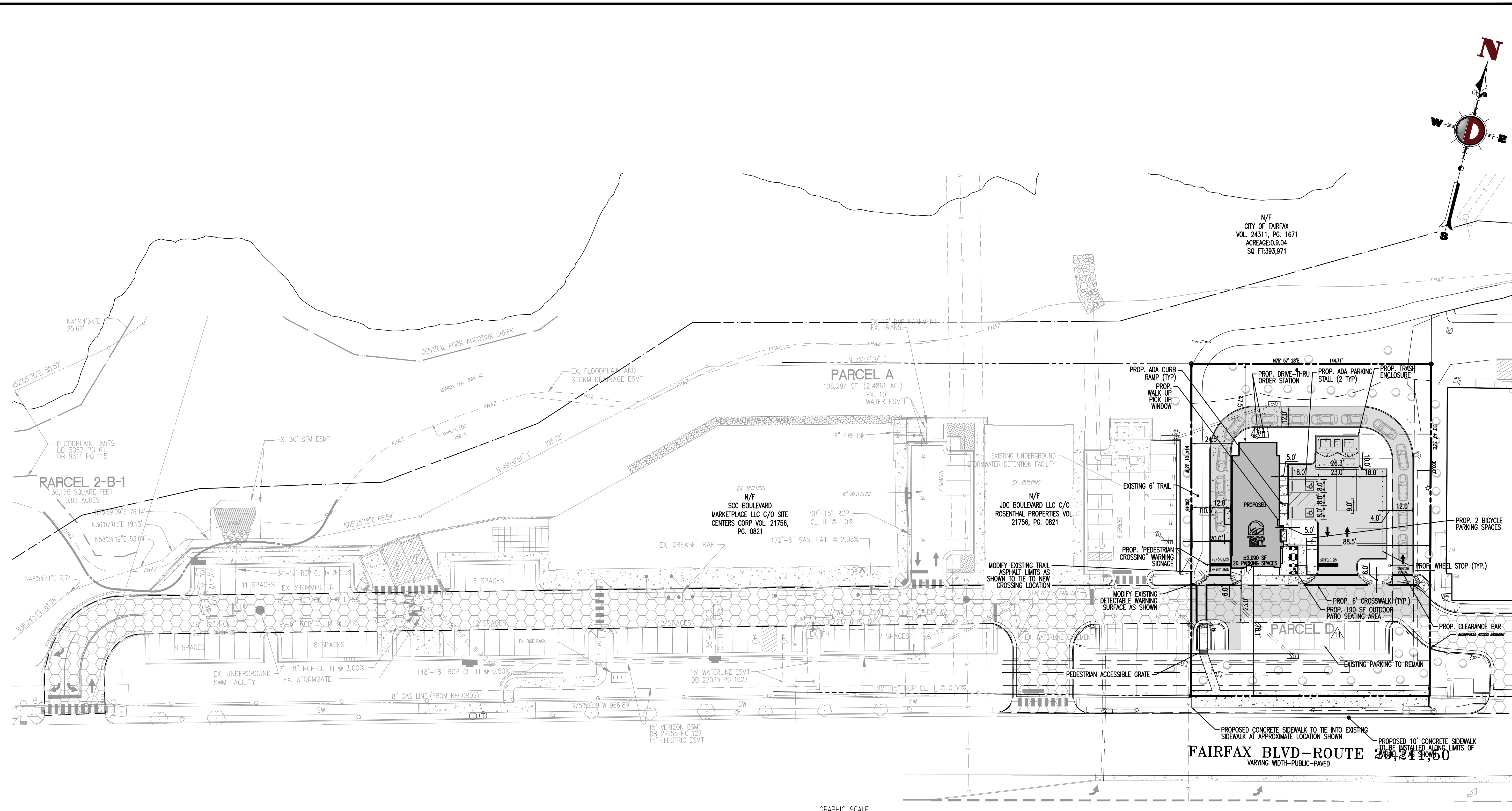

ZONING TABULATIONS

TAX MAP NUMBER	47-4-23-000-D, 47-4-23-000-A (NO MODIFICATIONS ARE PROPOSED TO PARCEL A AND ALL EXISTING IMPROVEMENTS ARE TO REMAIN)
PROPERTY AREA	0.66 AC (PARCEL D)
EXISTING ZONING	CR (COMMERCIAL RETAIL)
EXISTING USE	VACANT (PARCEL D)
PROPOSED USE	FAST FOOD RESTAURANT WITH DRIVE THROUGH (PARCEL D)
COMP PLAN LAND USE	CC (COMMERCIAL CORRIDOR)
BUILDING AREA	2,090 SF (PARCEL D)

ZONING COMPLIANCE (PARCEL A & D)

	ALLOWED/REQUIRED	PROVIDED	
		PARCEL D	PARCEL A
LOT AREA, MINIMUM	20,000 SF	28,921 SF	108,290
YARD REQUIREMENTS			
FRONT SETBACK, STREET (FAIRFAX BLVD)	93' MAXIMUM, 20' MINIMUM	78.1'	78.3'
SIDE SETBACK (EAST)	10'	88.5'	9'
SIDE SETBACK (WEST)	10'	24.5'	9'
REAR SETBACK (NORTH)	0'	47.5'	26'
BULK PLANE REQUIREMENTS	N/S	N/S	N/S
LOT WIDTH MINIMUM	N/S	N/S	N/S
BUILDING HEIGHT	5 STORIES, 60 FT	1 STORY, 25 FT	26 FT
BUILDING COVERAGE, MAXIMUM	60%	7.23%	18.11%
LOT COVERAGE, MAXIMUM	85%	39.51%	57.00%
FLOOR AREA MAXIMUM	N/S	N/S	N/S
PARKING AND LOADING REQUIREMENTS			
PARKING (1 SPACE / 200 SF OF FLOOR AREA)	11	20	100
INTERIOR PARKING LOT LANDSCAPING	1 ISLAND/10 SPACES	1 ISLAND/10 SPACES	1 ISLAND/12 SPACES
LOADING	NONE FOR BUILDINGS UNDER 10,000 SF	NONE	NONE
STACKING REQUIREMENT	10	13	10

STORMWATER MANAGEMENT NARRATIVE

THE EXISTING PARCEL IS THE EASTERN PORTION OF A LARGER OVERALL COMMERCIAL DEVELOPMENT "BOULEVARD MARKETPLACE" IN THE CURRENT CONDITION, A VACANT GRASS COVERED BUILDING PAD IS SURROUNDED BY EXISTING PAVING, PARKING AREAS AS WELL AS LANDSCAPING ON ALL SIDES OF THE DEVELOPMENT. THERE IS AN EXISTING RESOURCE PROTECTION AREA (RPA) BOUNDARY TO THE IMMEDIATE NORTH OF THE SITE THAT IS NOT CURRENTLY BEING IMPACTED, OR PROPOSED TO BE IMPACTED BY DEVELOPMENT.

AS A PART OF THE PREVIOUS SHOPPING CENTER CONSTRUCTION, AN EXISTING UNDERGROUND STORM FILTER AND DETENTION FACILITY WAS INSTALLED (2011 SITE PLAN AMENDMENT NO. 1190131) AND CURRENTLY TREATS THE PARCEL OF INTEREST, IN ADDITION TO THE NEIGHBORING PARCEL TO THE WEST, THE UNDERGROUND FILTER DEVICES IN PLACE MEET / EXCEED ALL UPDATED 2024 VIRGINIA DEPARTMENT OF ENVIRONMENTAL QUALITY STANDARDS, SPECIFICALLY THE VIRGINIA RUNOFF REDUCTION METHOD (VRRM VERSION 4-1).

CONFIRMED THROUGH SURVEY AND PER THE PREVIOUS SITE PLAN SP-17040063, BMP REQUIREMENTS ARE MET THROUGH THE INSTALLED CONTECH STORMFILTER STRUCTURE, AS WELL AS PROVIDING THE NECESSARY STORM DETENTION TO RESTORE RUNOFF VALUES TO PRE-DEVELOPMENT RATES. THE EXISTING SITE DRAINAGE OUTFALLS THROUGH STORM DRAIN TO ACCOTINK CREEK; MOST OF ALL SITE DRAINAGE IS CONTAINED TO ON-SITE STORM DRAIN WITH LITTLE SHEET FLOW OFF SITE. NO MODIFICATIONS TO THIS EXISTING STRUCTURE ARE PROPOSED, AND THE PROPOSED SITE CONSTRUCTION/GRADING FOR THE NEW DRIVE THROUGH RESTAURANT WILL UTILIZE THE EXISTING STORMWATER INFRASTRUCTURE WITH LITTLE MODIFICATION TO THE EXISTING GRADING AND DRAINAGE PATTERNS.

PER THE PREVIOUS DESIGN, THE CONTECH DEVICE ON SITE WAS INSTALLED IN ORDER TO TREAT IN EXCESS OF APPROXIMATELY 13,833 SQUARE FEET OF IMPERVIOUS AREA. THE NEW DESIGN, WITH A SMALLER PROPOSED BUILDING FOOTPRINT AND ADDITIONAL GREENSPACE, CREATES 11,370 SQUARE FEET OF IMPERVIOUS AREA, WITH A REDUCTION OF CLOSE TO 3,000 SF OF TOTAL IMPERVIOUS AREA BASED ON THE MOST RECENT APPROVED DESIGN. THE EXISTING CONTECH DEVICE ON SITE WILL STILL MEET AND EXCEED BMP AND STORMWATER STORAGE REQUIREMENTS PER THE PREVIOUS APPROVAL CRITERIA. IN ADDITION, THE SITE LIMITS DISTURBANCE TO THE ESTABLISHED VEGETATION OUTSIDE THE EXISTING CURB LINE AND CREATES NO ADDITIONAL GRADING OR MODIFICATION TO AREAS INFRRING ON THE EXISTING RPA.

WATER AND SEWER NARRATIVE

THE SITE PRESENTLY HAS AN EXISTING WATER SERVICE CONNECTION AND OUTSIDE WATER METER SERVICED VIA THE EXISTING 6" WATER LATERAL ON THE NEIGHBORING PROPERTY TO THE WEST. THE SITE SIMILARLY HAS AN EXISTING SANITARY SERVICE CONNECTION ALSO SERVICED VIA AN EXISTING 6" SANITARY LATERAL ON THE NEIGHBORING PROPERTY TO THE WEST. PROPOSED WATER AND SEWER SERVICE CONNECTIONS TO THE NEW RESTAURANT BUILDING WILL BE PROVIDED AS PART OF THIS DEVELOPMENT, UTILIZING THE EXISTING CONNECTION POINTS.

FINAL DESIGN COORDINATION WILL BE DONE WITH THE APPROPRIATE WATER AND SEWER AGENCIES AS PART OF THE SITE PLAN PROCESS.

Plotted: 08/19/24 - 5:51 PM, By: ezhang
 File: \\dpc\local_defenders\data\VEPC\PROJECTS\486 ABD Capital\22-01538 Fairfax VA\Imp\Special Exception Plans\04482201538SSD.dwg, ---> OVERALL GENERAL DEVELOPMENT PLAN & SPECIAL USE PERMIT PLAT

Plotted: 08/19/24 - 5:51 PM, By: ezhang
 File: \\deepa\local\defenders\Data\DEFCP\PROJECTS\4466\ABDD\Captial\22-01538\Fairfax_VA\Dwg\Special Exception Plans\044662201538SS0.dwg, ---> EROSION AND SEDIMENT CONTROL & CONSTRUCTION MANAGEMENT

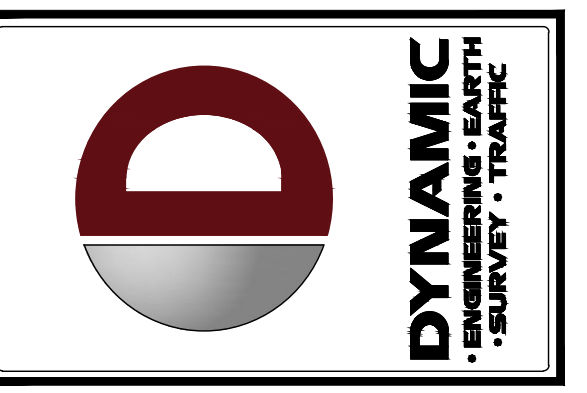
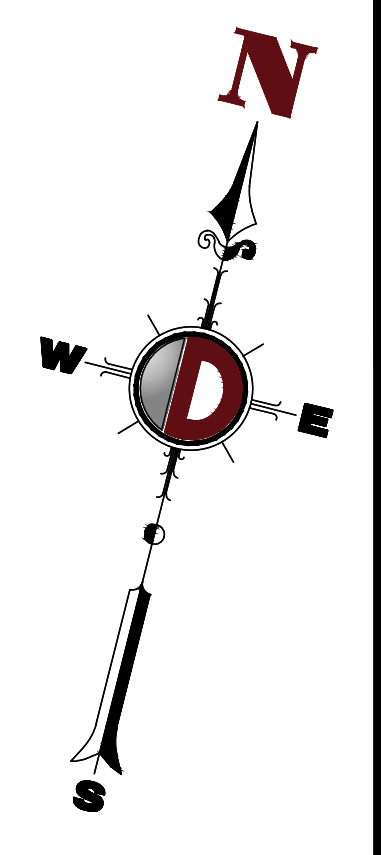
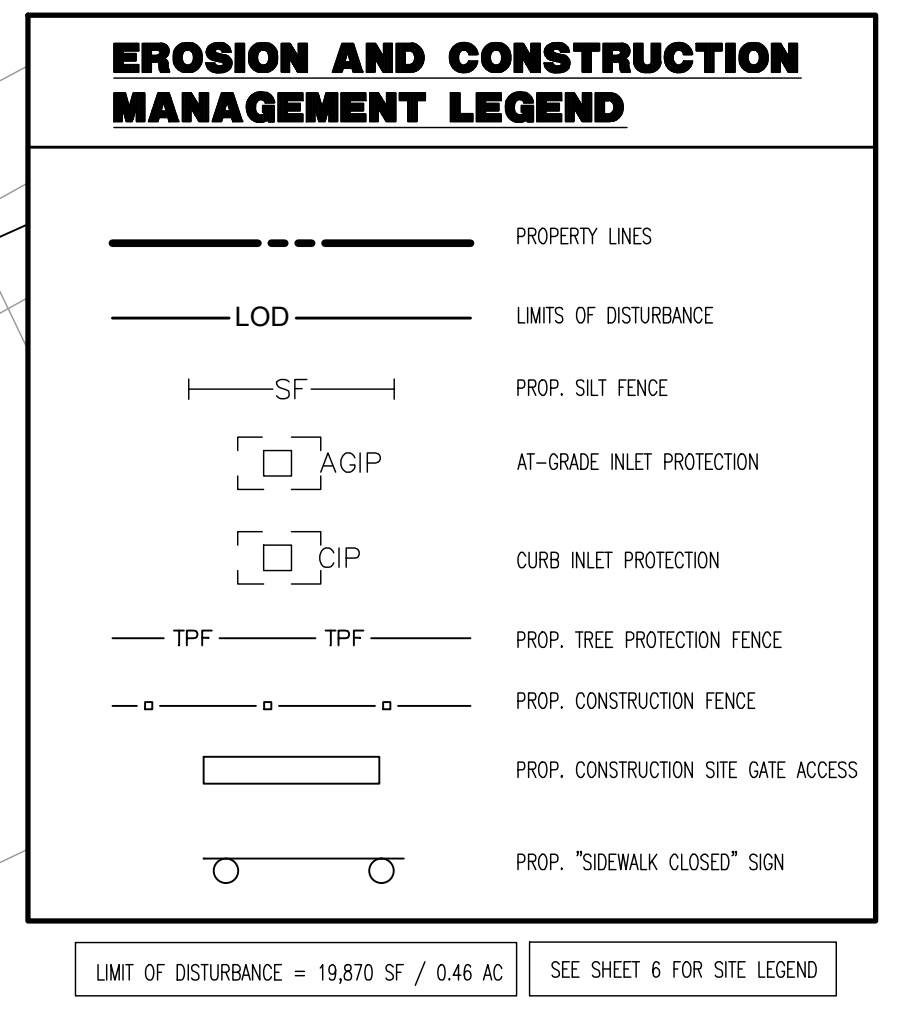
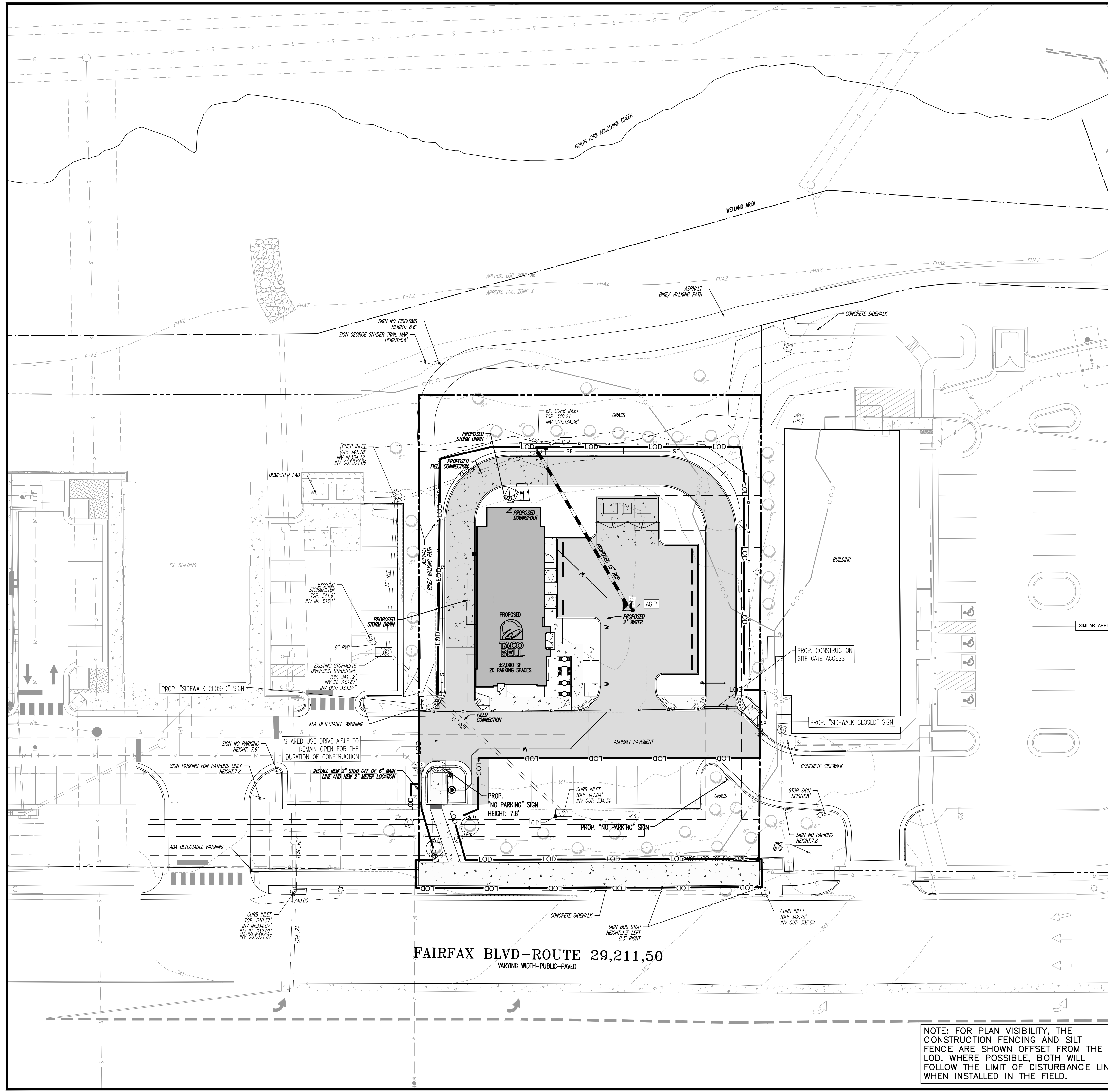

REV.	DATE	COMMENTS
2	08/19/24	GDP SET THIRD SUBMITTAL
1	07/22/24	GDP SET SECOND SUBMITTAL
0	07/18/24	GDP SET FIRST SUBMISSION

THIS PLAN SET IS FOR PERMITTING PURPOSES ONLY AND MAY NOT BE USED FOR CONSTRUCTION

DESIGNED BY: JAC
 CHECKED BY: JJC
 CM
 JAC

PROJECT: **SOUTHPIAP**
 PROPOSED TACO BELL FAST FOOD RESTAURANT W/ DRIVE-THRU
 BOULEVARD MARKETPLACE, PARCEL D
 10120 FAIRFAX BOULEVARD
 CITY OF FAIRFAX, FAIRFAX COUNTY, VIRGINIA

811 PROTECT YOURSELF
 ALL STATES REQUIRE NOTIFICATION OF EXCAVATORS, DESIGNERS, OR ANY PERSON PREPARING TO DIG INTO THE EARTH'S SURFACE ANYWHERE IN ANY STATE FOR STATE SPECIFIC DIRECT PHONE NUMBERS VISIT: WWW.CALL811.COM

DYNAMIC ENGINEERING
 LAND DEVELOPMENT CONSULTING • PERMITTING
 GEOTECHNICAL • ENVIRONMENTAL
 TRAFFIC • SURVEY • PLANNING & ZONING
 125 West Street - Suite 201
 Annapolis, MD 21412
 1-410-567-5000
 Offices conveniently located at:
 Annapolis, MD • 410-567-5000
 Chesapeake Beach, MD • 410-567-5000
 Fairfax, VA • 703-771-1111
 Falls Church, VA • 703-771-1111
 Herndon, VA • 703-771-1111
 Reston, VA • 703-771-1111
 Silver Spring, MD • 301-787-4400
 Washington, DC • 202-462-2000
 www.dynamiccec.com

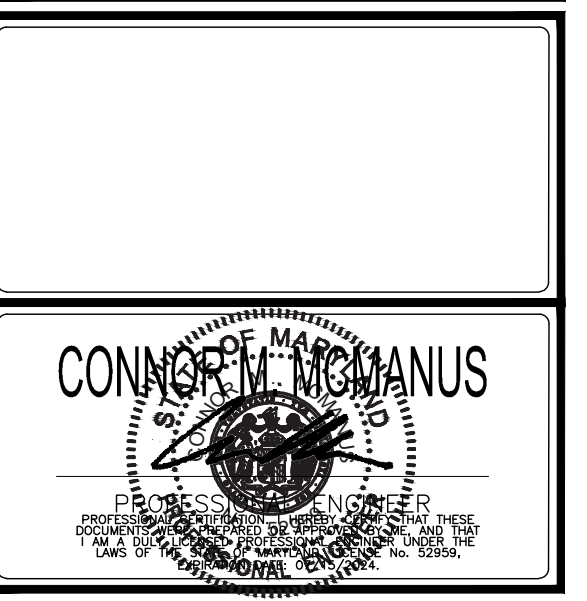

TITLE: EROSION AND SEDIMENT CONTROL & CONSTRUCTION MANAGEMENT

SCALE: (H) AS NOTED (V) --->
 DATE: 01/18/2024
 PROJECT No: 3486-22-01538
 SHEET No: **5** Rev. #: 19 2

Figure C-SCM-04-6 Curb Inlet Protection with 2-Inch x 4-Inch Wooden Weir

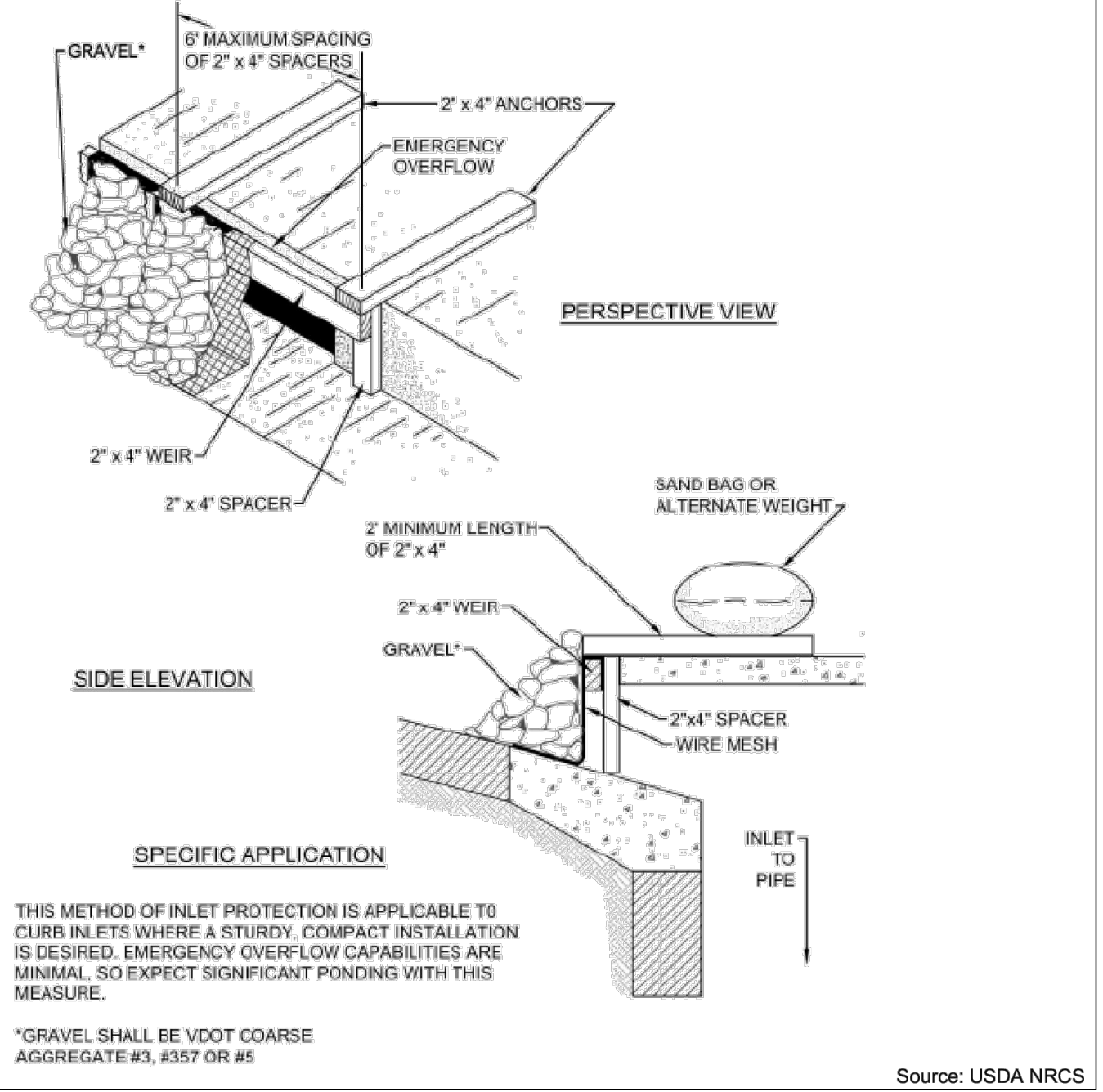
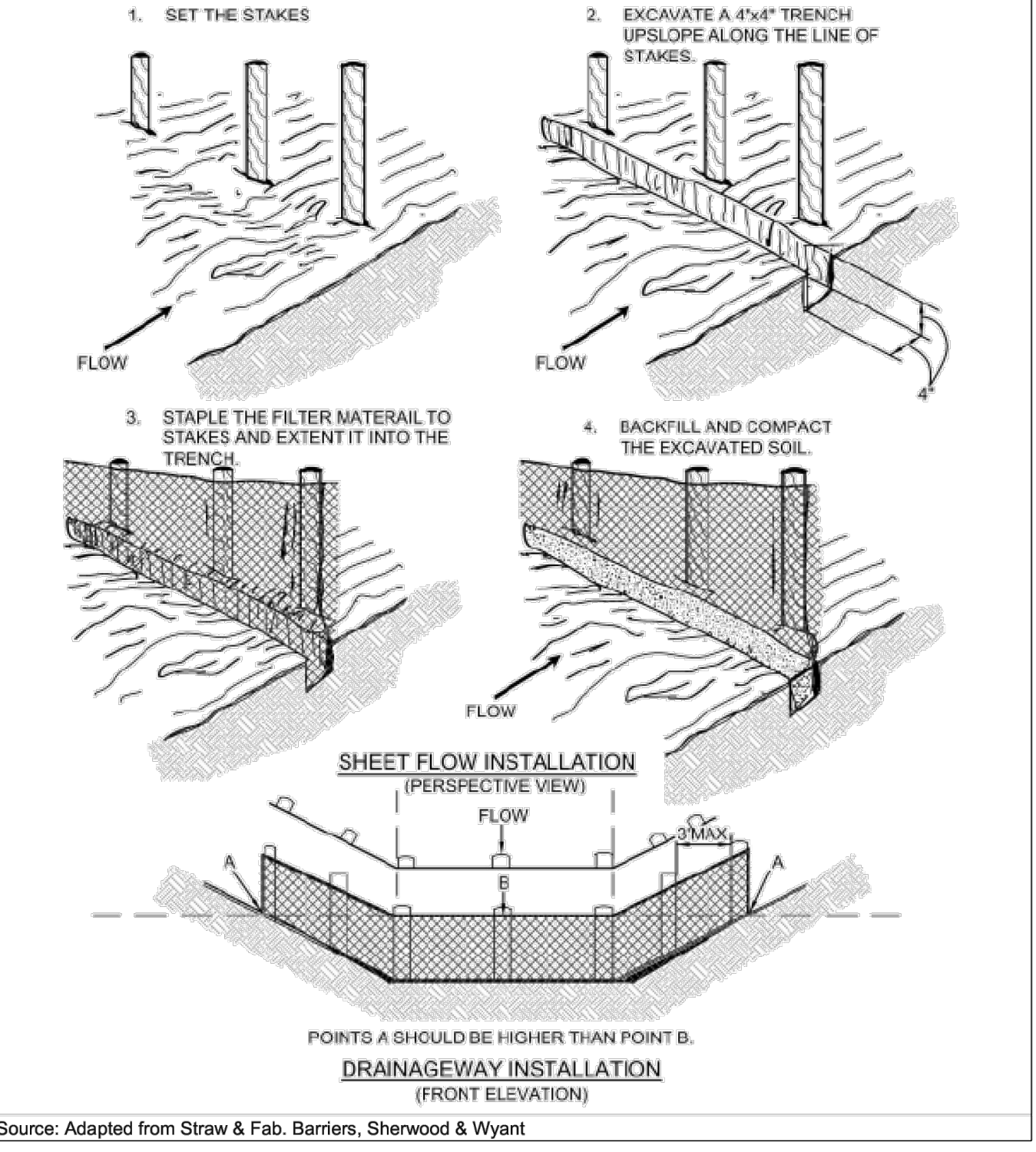
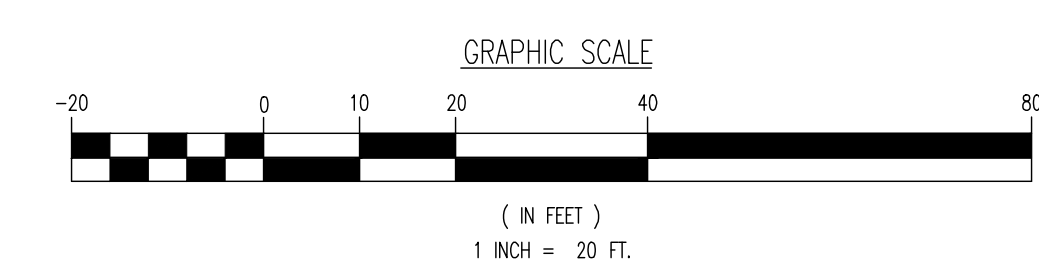

Figure C-PCM-04-4 Construction of Silt Fence without Wire Support Installation



NOTE: FOR PLAN VISIBILITY, THE CONSTRUCTION FENCING AND SILT FENCE ARE SHOWN OFFSET FROM THE LOD. WHERE POSSIBLE, BOTH WILL FOLLOW THE LIMIT OF DISTURBANCE LINE WHEN INSTALLED IN THE FIELD.



Plotted: 08/19/24 - 4:41 PM, by: cserido
 File: P:\VEPC PROJECTS\486 ABD Copital\22-01538 Fairfax VA\DWG\Special Exception Plans\04862201538SLD.DWG, ----> 05 CONCEPTUAL LANDSCAPE PLAN AND TABULATIONS

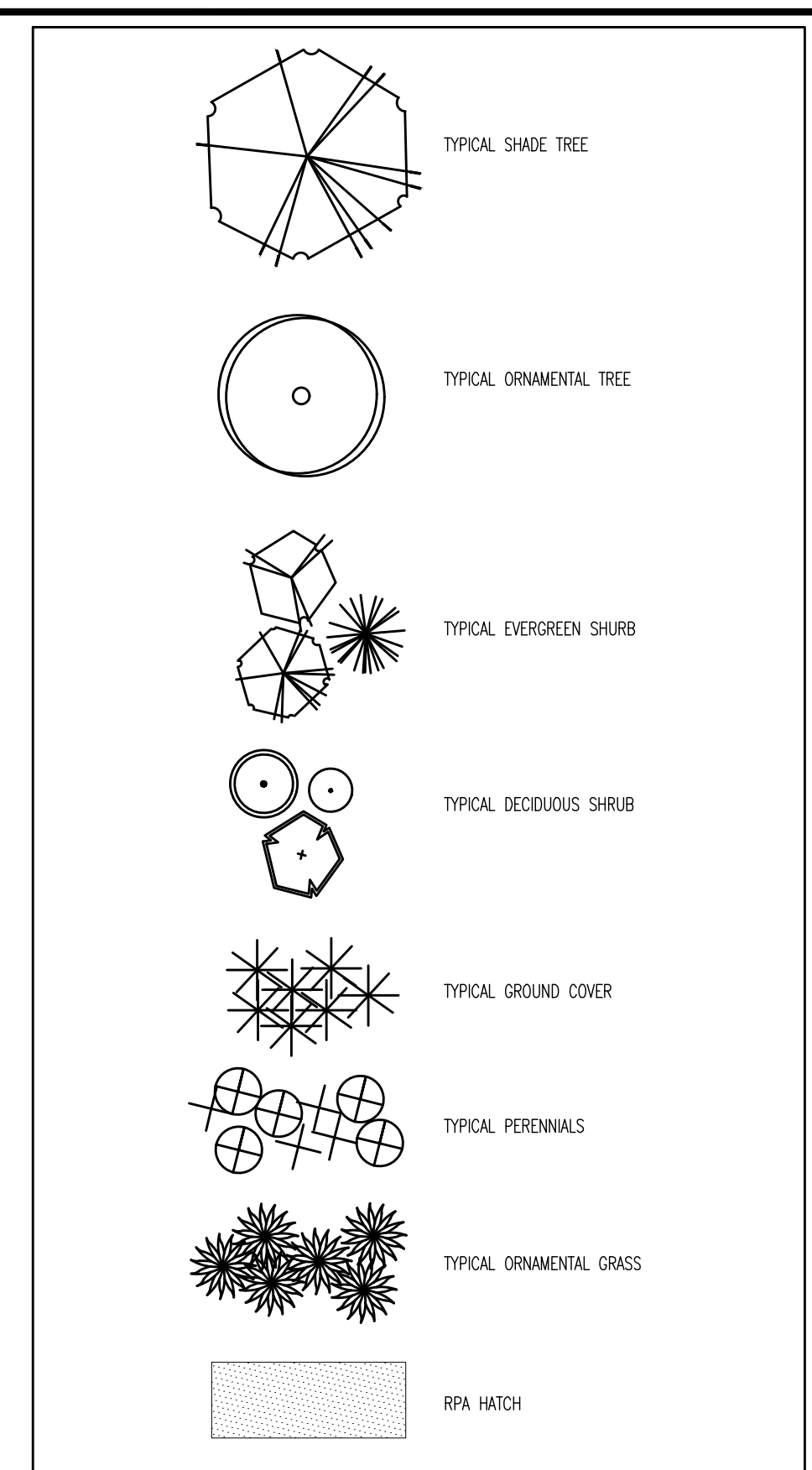
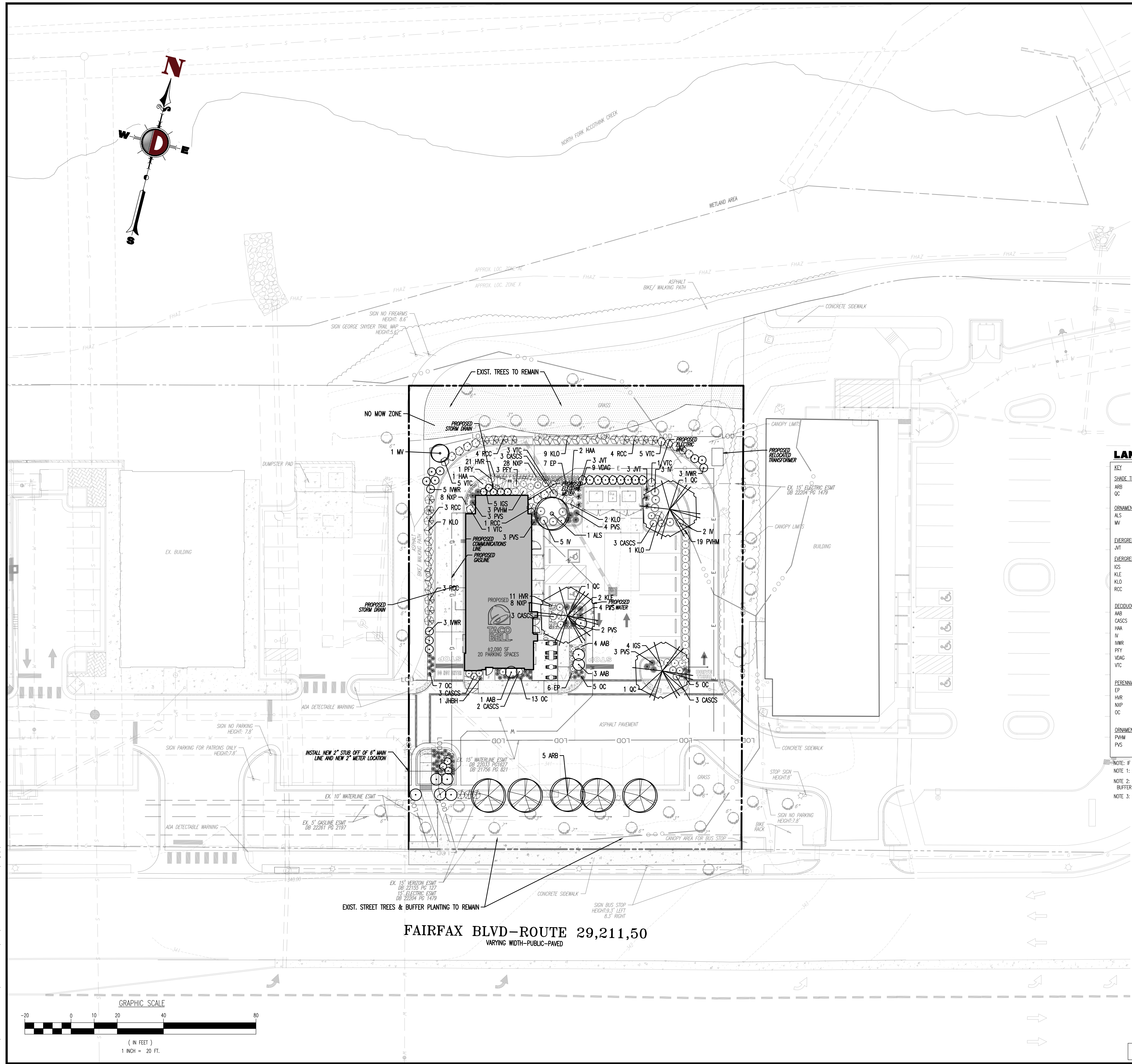

LANDSCAPE SCHEDULE

KEY	QTY	BOTANICAL NAME	COMMON NAME	SIZE	REMARKS
SHADE TREE(S)					
ARB	5	ACER RUBRUM 'BONWALL'	BONWALL RED MAPLE	2 1/2-3" CAL	B#B
OC	3	QUERCUS COCCINEA	SCARLET OAK	2 1/2-3" CAL	B#B
ORNAMENTAL TREE(S)					
ALS	1	AMELANCHIER LAEVIS 'SNOWCLOUD'	SNOWCLOUD SERVICEBERRY	8-10'	B#B
MV	1	MAGNOLIA VIRGINIANA	SWEETBAY MAGNOLIA	8-10'	B#B
EVERGREEN SHRUB(S)					
JVT	6	JUNIPERUS VIRGINIANA 'TAYLOR'	TAYLOR JUNPER	5-6'	B#B
EVERGREEN TREE(S)					
IGS	12	ILEX GLABRA 'SHAMROCK'	SHAMROCK INKERRY HOLLY	24-30"	#3 CAN
KLE	5	KALMIA LATIFOLIA 'ELF'	ELF MOUNTAIN LAUREL	24-30"	#3 CAN
KLO	19	KALMIA LATIFOLIA 'OLYMPIC FIRE'	OLYMPIC FIRE MOUNTAIN LAUREL	30-36"	#5 CAN
RCC	15	RHODODENDRON PERICLIMENOIDES	PINKER AZALEA	24-30"	#3 CAN
DECIDUOUS SHRUB(S)					
AMB	13	ARONIA ARBUTIFOLIA 'BRILLIANTISSIMA'	RED CHOKEBERRY	24-30"	#3 CAN
CASC	17	CLETHRA ALNIFOLIA 'SIXTEEN CANDLES'	SIXTEEN CANDLES SUMMERWEET	24-30"	#3 CAN
HNA	3	HYDRANGEA ABORESCENS 'ANNABELLE'	'ANNABELLE' HYDRANGEA	24-30"	#3 CAN
IV	10	IVEA VIRGINICA 'HENRY'S GARNET'	GARNET SWEETSPIRE	24-30"	#3 CAN
MWR	11	ILEX VERTICILLATA 'WINTER RED'	WINTER RED WINTERBERRY HOLLY	30-36"	#5 CAN
PFY	4	POTENTILLA FRUTICOSA 'HAPPY FACE YELLOW'	HAPPY FACE YELLOW POTENTILLA	24-30"	#3 CAN
VDAG	9	VIBURNUM DENTATUM VAR. DEAMI 'ALL THAT GLOWS'	ALL THAT GLOWS VIBURNUM	24-30"	#3 CAN
VTC	15	VIBURNUM TRILOBUM 'COMPACTUM'	COMPACT AMERICAN CRANBERRIBUSH	24-30"	#3 CAN
PERENNIAL(S)					
EP	13	EDIMNASCIA PURPUREA	PURPLE CONEFLOWER	2 GAL	CONTAINER
HNR	32	HEMORRHOIDIS VARIETIES	PEACH-RED-YELLOW DAYLILY	1 GAL	CONTAINER
NXP	44	NEPETA X 'PISPEKE'	LITTLE TRUDY CATMINT	1 GAL	CONTAINER
OC	49	OSMUNDA CINNAMOMEA	CINNAMON FERN	2 GAL	CONTAINER
ORNAMENTAL GRASS(S)					
PVM	22	PANICUM VIRGATUM 'HEAVY METAL'	HEAVY METAL SWITCH GRASS	2 GAL	CONTAINER
PVS	19	PANICUM VIRGATUM 'SHENANDOAH'	SHENANDOAH SWITCH GRASS	2 GAL	CONTAINER

NOTE: IF ANY DISCREPANCIES OCCUR BETWEEN AMOUNTS SHOWN IN THE PLAN AND THE PLANT LIST, THE PLAN SHALL DICATE.
 NOTE 1: DETAILED LANDSCAPING PLANTINGS, HARDSCAPE DESIGN, AND LIGHTING INFORMATION WILL BE PROVIDED AT TIME OF SITE PLAN.
 NOTE 2: DUMPSTER ENCLOSURE SHOULD BE CONSTRUCTED OF CONCRETE BLOCK W/ DUR-O-WALL FINISH AND INCLUDES AN EVERGREEN BUFFER AROUND THE EXTERIOR.
 NOTE 3: PER ZONING ORDINANCE SECTION 4.5.5.C.1 NO TRANSITIONAL YARDS ARE REQUIRED TO ADJACENT CR AND/ OR IL DISTRICT LOTS.

SITE TREE COVERAGE REQUIREMENTS

TREE CANOPY CALCULATIONS
 TOTAL SITE AREA = 28,921 SF
 - TREE CANOPY REQUIRED (10%) = 2,892 SF
 - TREE CANOPY PROVIDED = 5,875 SF (21%)

- (A) PROPOSED EIGHT (8) SHADE TREES @ 250 SF OF EACH = 2,000 SF
- (B) EXISTING SEVEN (7) SHADE TREES @ 250 SF OF EACH = 1,750 SF
- (A) PROPOSED TWO (2) ORNAMENTAL TREES @ 125 SF OF EACH = 125*2 = 250 SF
- (B) EXISTING FIFTEEN (15) ORNAMENTAL TREES @ 125 SF OF EACH = 125*15 = 1,875 SF

STREET TREES

BOUNDARY	LENGTH	REQUIRED TREES	PROVIDED TREES
FAIRFAX BOULEVARD	143.8 LF	4 TREES	5 TREES

NOTE: 5 PROPOSED TREES AND 22 EXISTING TREES INCLUDED IN THE CALCULATIONS
 NOTE: STREET TREES INSIDE FAIRFAX BOULEVARD RIGHT-OF-WAY BEHIND CURB WILL BE REPLACED IN KIND OR RELOCATED PER DIRECTION FROM THE CITY AS NEEDED.

INTERIOR PARKING LOT

NUMBER OF PROVIDED SPACES	20 SPACES
REQUIRED TREES	2 (20/10 = 2)
PROVIDED TREES	3

SEE SHEET 09 OF 15 FOR LANDSCAPE PLAN NOTES

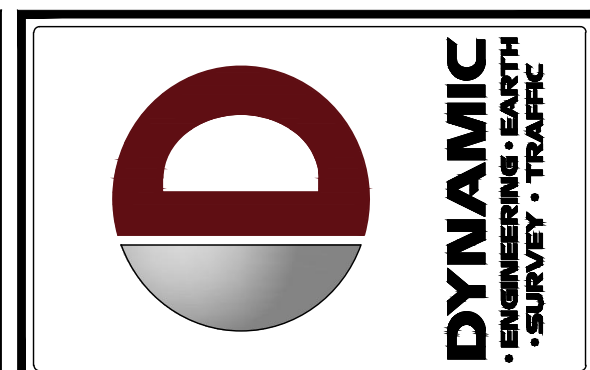

REV.	DATE	COMMENTS
2	08/19/24	GDP SET THIRD SUBMITTAL
1	07/22/24	GDP SET SECOND SUBMITTAL
0	07/18/24	GDP SET FIRST SUBMISSION

THIS PLAN SET IS FOR PERMITTING PURPOSES ONLY AND MAY NOT BE USED FOR CONSTRUCTION

PROJECT: **SOUTHPIAP**
 PROPOSED TACO BELL FAST FOOD RESTAURANT W/ DRIVE-THRU
 BOULEVARD MARKETPLACE, PARCEL D
 10120 FAIRFAX BOULEVARD
 CITY OF FAIRFAX, FAIRFAX COUNTY, VIRGINIA

811 PROTECT YOURSELF
 ALL STATES REQUIRE NOTIFICATION OF EXCAVATORS, DESIGNERS, OR ANY PERSON PREPARING TO DIGGING THE EARTH'S SURFACE ANYWHERE IN ANY STATE
 FOR STATE SPECIFIC DIRECT PHONE NUMBERS VISIT: WWW.CALL811.COM

DYNAMIC ENGINEERING
 LAND DEVELOPMENT CONSULTING • PERMITTING
 GEOTECHNICAL • ENVIRONMENTAL
 TRAFFIC • SURVEY • PLANNING & ZONING
 125 West Street - Suite 201
 Annapolis, MD 21412
 410.567.5000
 Offices conveniently located at:
 Annapolis, MD • 410.567.5000
 Chantilly, VA • 703.879.9229
 Fairfax, VA • 703.551.7200
 Falls Church, VA • 703.747.4218
 Herndon, VA • 703.461.8222
 Reston, VA • 703.461.8222
 Silver Spring, MD • 301.591.4400
 Washington, DC • 202.462.0000
 Dulles, VA • 703.461.8222
 Dulles, VA • 703.461.8222
 Annapolis, MD • 410.567.5000

MARCA A. ROLLER
 Landscape Architect
 LICENSED LANDSCAPE ARCHITECT
 VIRGINIA LICENSE NO. 22245

CONNOR J. MCNAMUS
 Professional Engineer
 VIRGINIA LICENSE NO. 55000

TITLE: **CONCEPTUAL LANDSCAPE PLAN AND TABULATIONS**

SCALE: (H) AS SHOWN (V) NOTED DATE: 01/18/2024
 PROJECT No: 3486-22-01538
 SHEET No: **7** Rev. #:
 OF 19 2

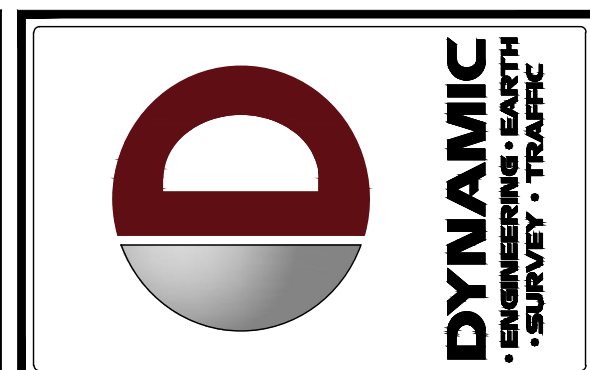

DATE	REV.	COMMENTS
08/19/24	2	GDP SET THIRD SUBMITTAL
07/22/24	1	GDP SET SECOND SUBMITTAL
01/18/24	0	GDP SET FIRST SUBMISSION

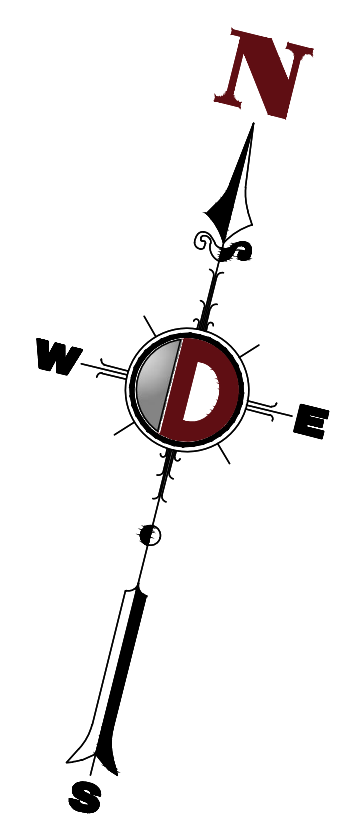

DESIGNED BY:	CREATED BY:
REVISION BY:	CM
JAC	JJ
JAC	JJ

PROJECT: SOUTHAPAC PROPOSED TACO BELL FAST FOOD RESTAURANT W/ DRIVE-THRU BOULEVARD MARKETPLACE, PARCEL D 10120 FAIRFAX BOULEVARD CITY OF FAIRFAX, FAIRFAX COUNTY, VIRGINIA

811 PROTECT YOURSELF
 ALL STATES REQUIRE NOTIFICATION OF DIGITATORS, DESIGNERS, OR ANY PERSON PREFERRING TO DESIGN THE SAFETY SURFACE ANYWHERE IN ANY STATE
 FOR STATE SPECIFIC DIRECT PHONE NUMBERS VISIT: WWW.CALL811.COM

DYNAMIC ENGINEERING
 LAND DEVELOPMENT CONSULTING • PERMITTING
 GEOTECHNICAL • ENVIRONMENTAL
 TRAFFIC • SURVEY • PLANNING & ZONING
 125 West Street - Suite 201
 Annapolis, MD 21412
 T: 410.567.5000
 Offices conveniently located at:
 Annapolis, MD • 410.567.5000
 Chantilly, VA • 703.771.1111
 Chesapeake, VA • 757.531.1111
 Fairfax, VA • 703.771.1111
 Falls Church, VA • 703.771.1111
 Herndon, VA • 703.771.1111
 Loudoun County, VA • 703.771.1111
 Northern Virginia • 703.771.1111
 Reston, VA • 703.771.1111
 Silver Spring, MD • 301.771.1111
 Washington, DC • 202.771.1111
 www.dynamiccec.com

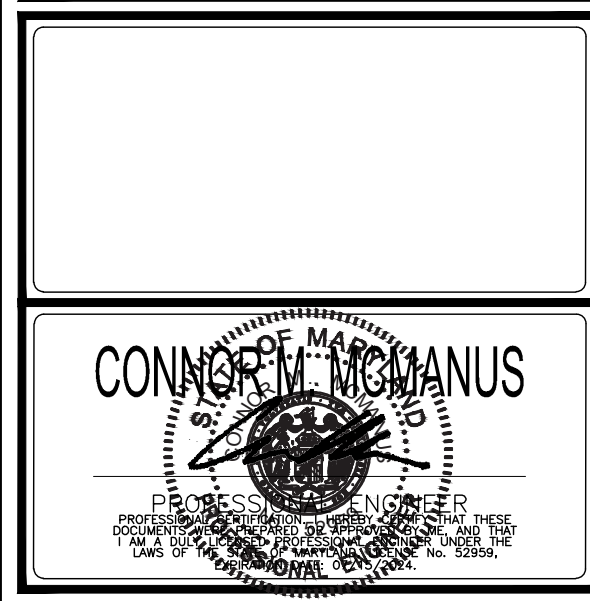

TITLE:	DATE:
SIGNAGE AND STRIPING DETAILS	01/18/2024
SCALE: (H) AS NOTED (V) ---	PROJECT No: 3486-22-01538
SHEET No: 11	Rev. #: 11

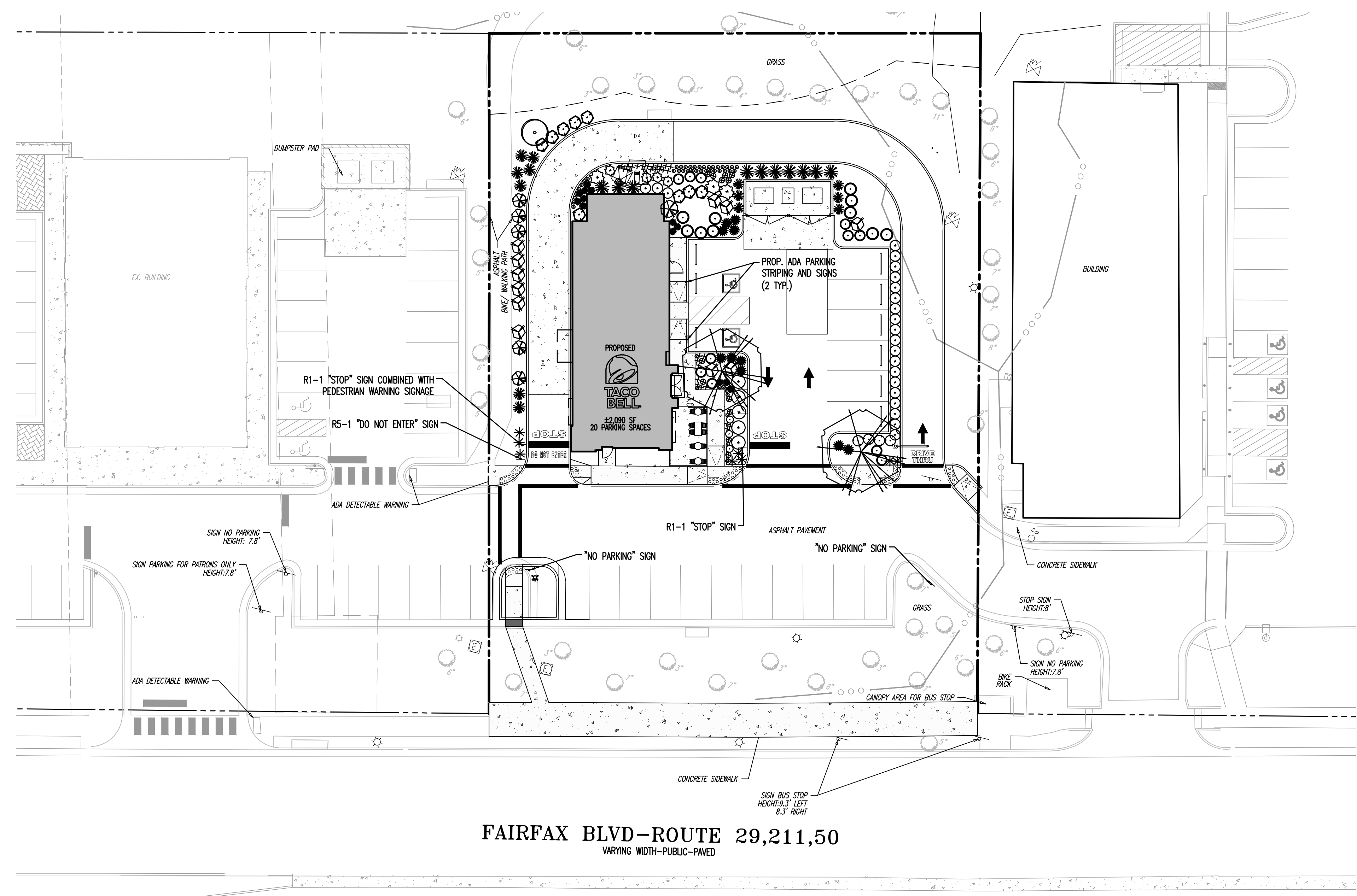
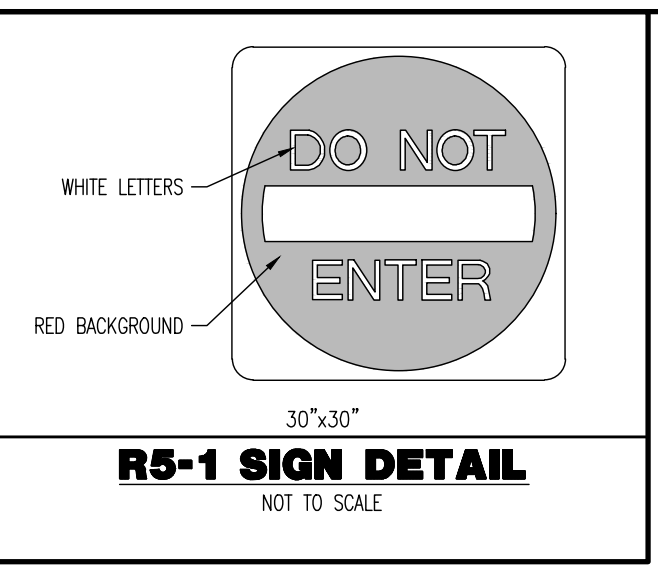
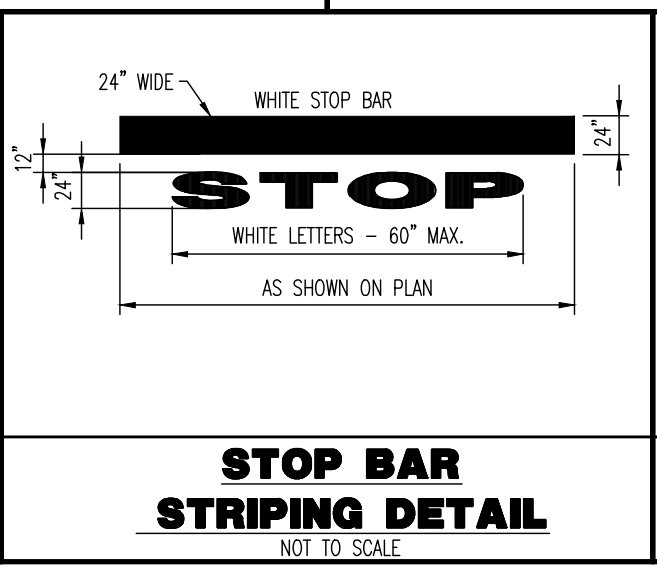
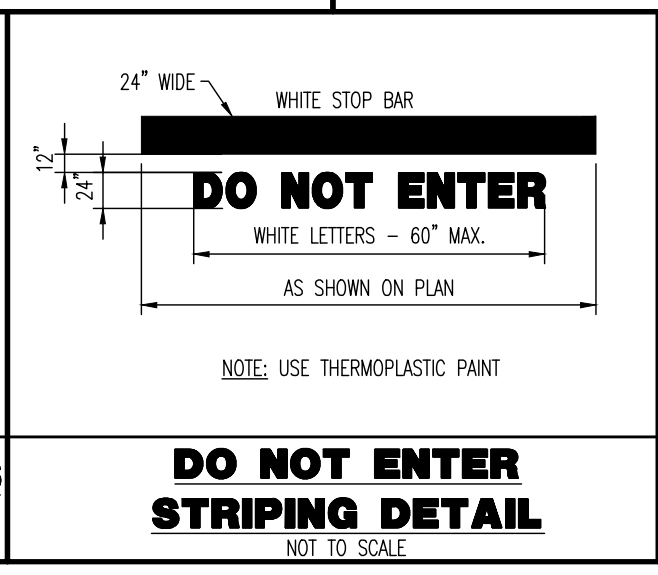
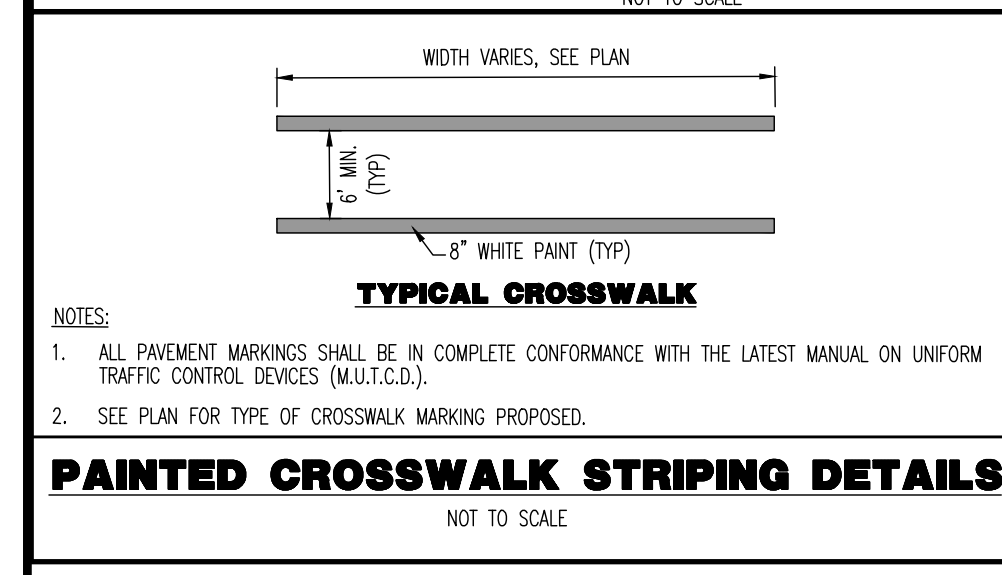
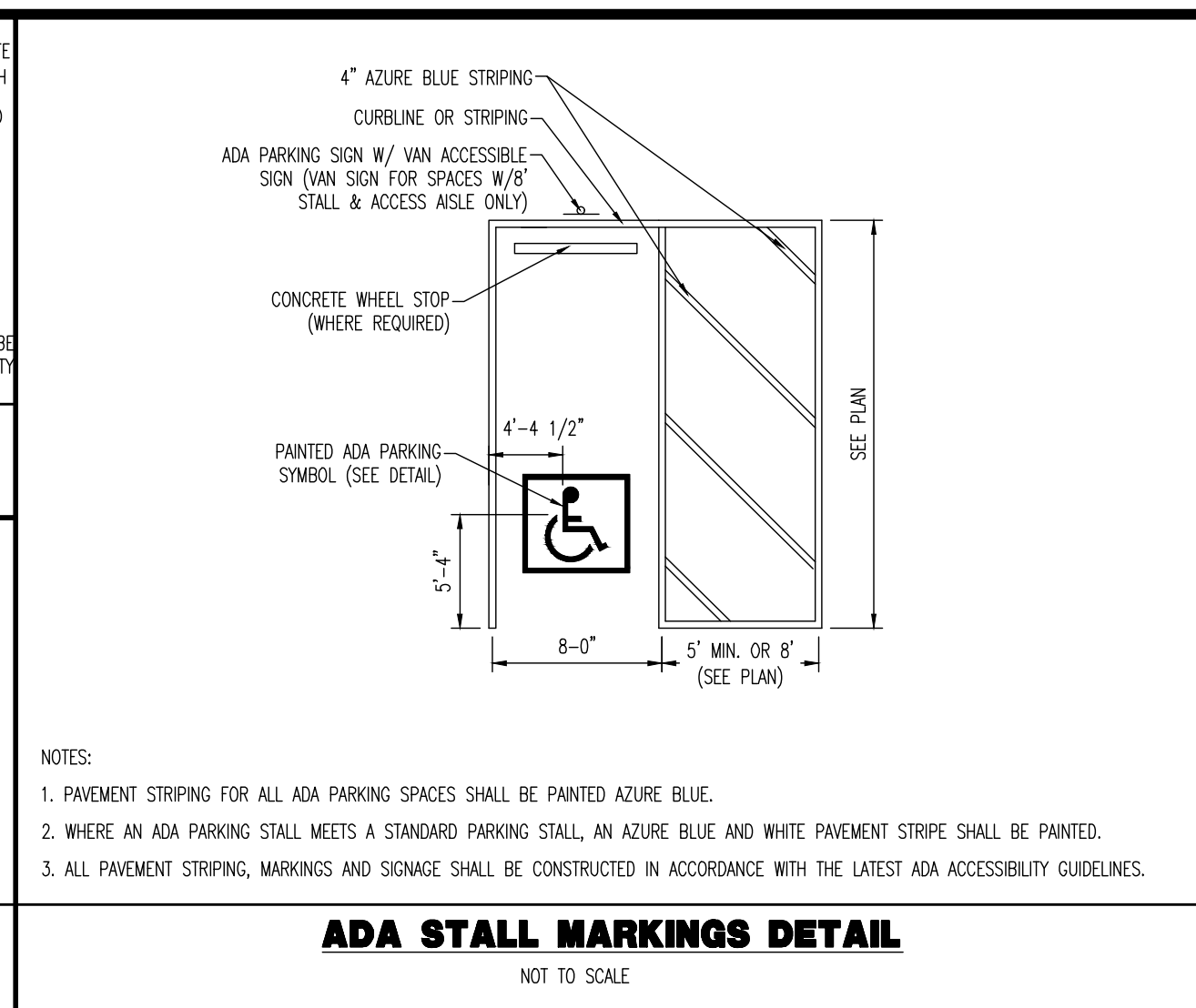
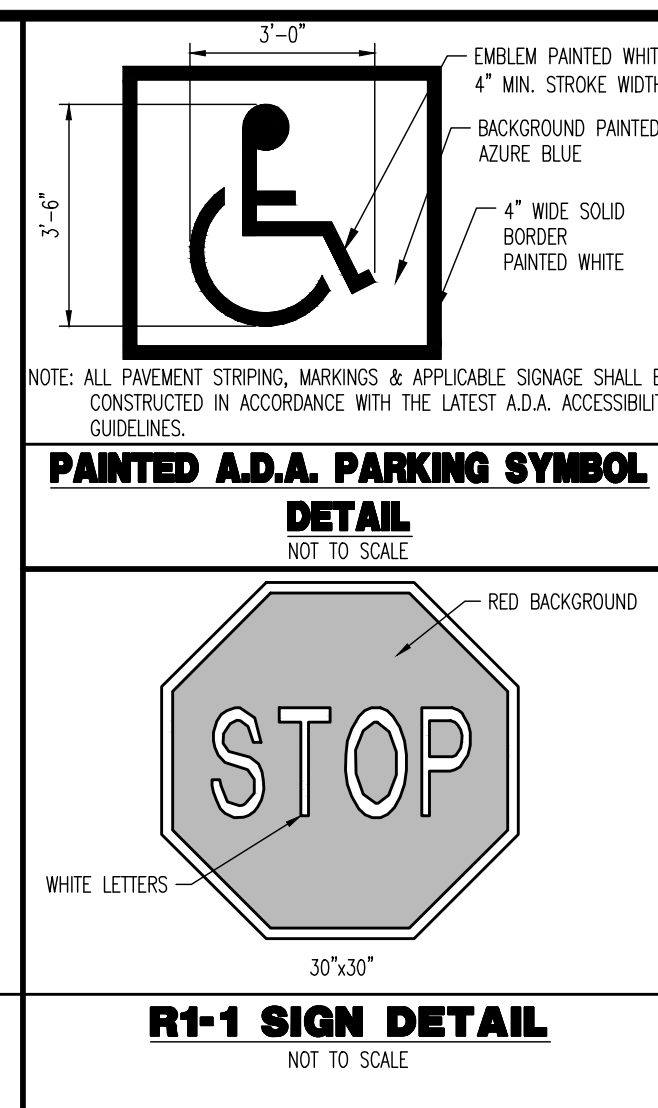
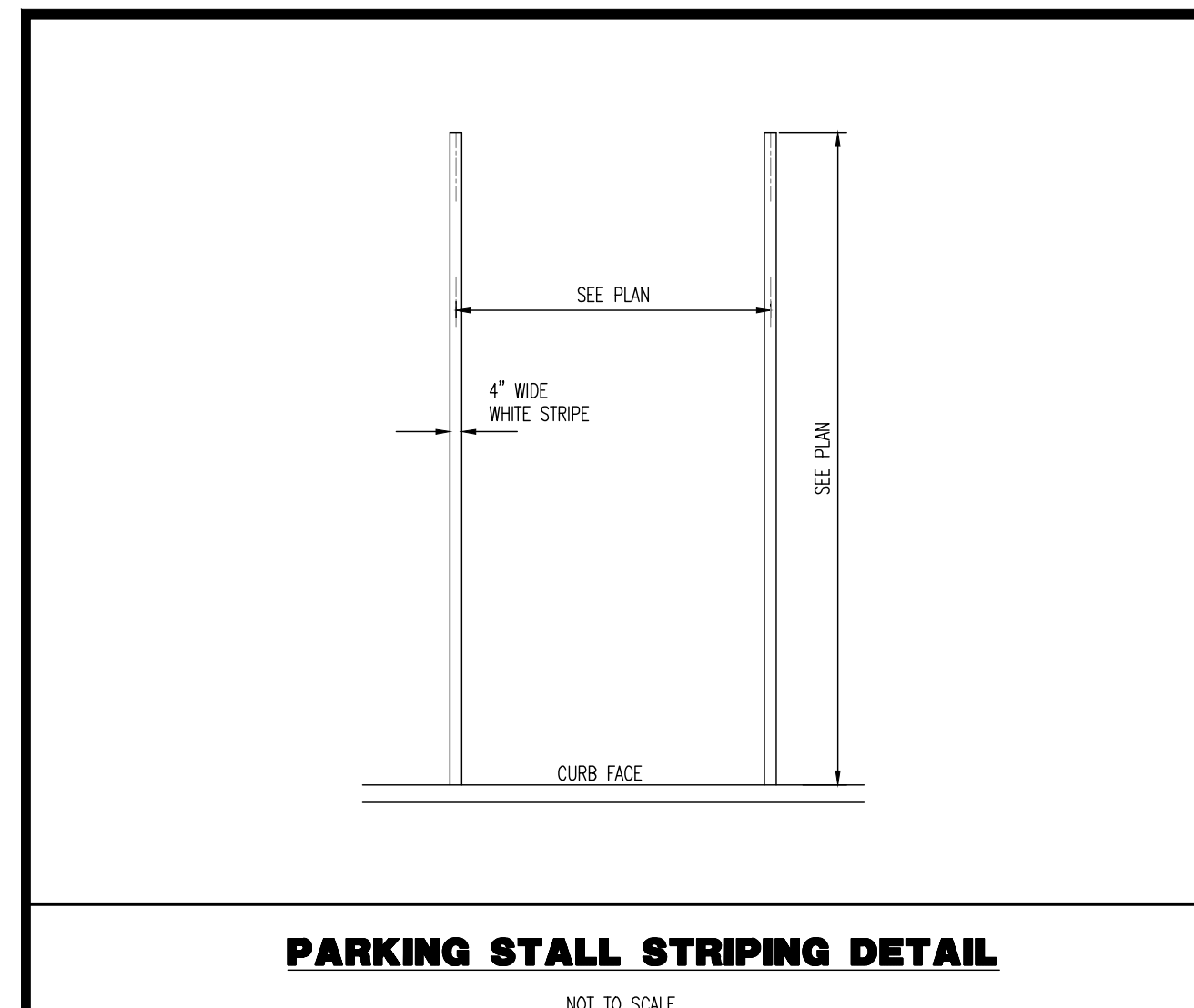

FAIRFAX BLVD-ROUTE 29,211,50
 VARYING WIDTH-PUBLIC-PAVED

NOTE: PROPOSED WAYFINDING SIGNAGE TO BE INSTALLED WITHIN FAIRFAX BOULEVARD AND FAIR WOODS PARKWAY FOR BOULEVARD MARKETPLACE SHOPPING CENTER / TACO BELL. SIGN WORDING/GRAPHICS AND ULTIMATE PLACEMENT TO BE COORDINATED WITH THE CITY TRANSPORTATION ENGINEER. ANY ADDITIONAL SIGNAGE PROPOSED OR REQUESTED IS SUBJECT TO REVIEW/APPROVAL BY THE CITY OF FAIRFAX PRIOR TO SITE PLAN APPROVAL

Plotted: 08/19/24 - 5:53 PM, By: ezhang
 File: \\deeplocal\desf\desf\DATA\DEFC\PROJECTS\3486\ABD\Capital\22-01538\Fairfax_VA\DWG\Special\Exemption\Plan\034862201538SD0.dwg, ---> 10 SIGNAGE AND STRIPING DETAILS
 COPYRIGHT © 2024 - DYNAMIC ENGINEERING CONSULTANTS, PC - ALL RIGHTS RESERVED



VIPER Area/Site

FEATURES

- Low profile LED area/site luminaire with a variety ofIES distributions for lighting applications such as auto dealership, retail, commercial, and campus parking lots
- Featuring two different optical technologies, Strike and Micro Strike Optics, which provide the best distribution patterns for retrofit or new construction
- Rated for high vibration applications including bridges and overpasses. All sizes are rated for 1.5G
- Control options including photo control, occupancy sensing, NX Distributed Intelligence™, wiSCAPE and 7-Pin with networked controls
- New customizable lumen output feature allows for the wattage and lumen output to be customized in the factory to meet whatever specification requirements may entail
- Field interchangeable mounting provides additional flexibility after the fixture has shipped



CONTROL TECHNOLOGY

NX DISTRIBUTED INTELLIGENCE™

wiSCAPE

SPECIFICATIONS

CONSTRUCTION

- Die-cast housing with hidden vertical heat fins are optimal for heat dissipation while keeping a clean smooth outer surface
- Corrosion resistant, die-cast aluminum housing with 1000 hour powder coat paint finish
- External hardware is corrosion resistant

OPTICS

- Micro Strike Optics (60, 320, 480, or 720 LED counts) maximize uniformity in applications and come standard with mid-power LEDs which evenly illuminate the entire luminous surface area to provide a low glare appearance. Catalog logic found on page 2
- Strike Optics (66, 72, 108, or 162 LED counts) provide best in class distributions and maximum pole spacing in new applications with high powered LEDs. Strike optics are held in place with a polycarbonate bezel to mimic the appearance of the Micro Strike Optics so both solutions can be combined on the same application. Catalog logic found on page 3

INSTALLATION

- Mounting patterns for each arm can be found on page 11
- Optional universal mounting block for ease of installation during retrofit applications. Available as an option (ASQU) or accessory for square and round poles.
- All mounting hardware included

DATE: LOCATION: Fairfax, VA
 TYPE: A PROJECT: Taco Bell
 CATALOG #: VP-2-320L-315-4K7-4F-UNV-A-DBT

MICROSTRIKE OPTICS

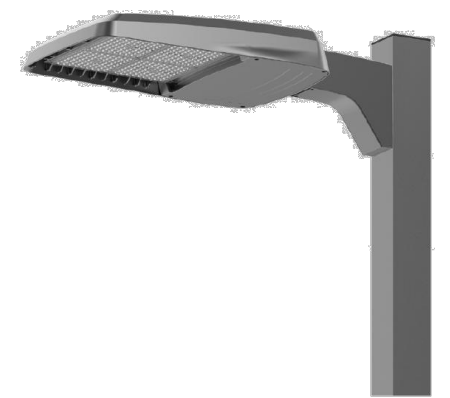

INSTALLATION (CONTINUED)

- Knuckle arm filter option available for 2-3/8" OD tenon
- For products with EPA less than 1 mounted to a pole greater than 20ft, a vibration damper is recommended

ELECTRICAL

- Universal 120-277 VAC or 347-480 VAC input voltage, 50/60 Hz
- Ambient operating temperature -40°C to 40°C
- Drivers have greater than 90% power factor and less than 29% THD
- LED drivers have output power over-voltage, over-current protection and short circuit protection with auto recovery
- Field replaceable surge protection device provides 20KA protection meeting ANSI/IEEE C62.412 Category C High and Surge Location Category C3. Automatically takes fixture off-line for protection when device is compromised

CONTROLS

- Photo control, occupancy sensor programmable controls, and Zigbee wireless controls available for complete on/off and dimming control
- Please consult brand or sales representative when combining control and electrical options as some combinations may not operate as anticipated depending on your application
- 7-pin ANSI C136.41-2013 photocell receptacle option available for twist lock photocells or wireless control modules (control accessories sold separately)
- 0-10V Dimming Drivers are standard and dimming leads are extended out of the luminaire unless control options require connection to the dimming leads. Must specify if wiring leads are to be greater than the 6" standard

KEY DATA	
Lumen Range	5,000-80,000
Wattage Range	36-600
Efficacy Range (LPW)	92-155
Weight lbs. (kg)	13.7-30.9 (6.2-13.9)



VIPER Area/Site

DIMENSIONS

SIZE 1

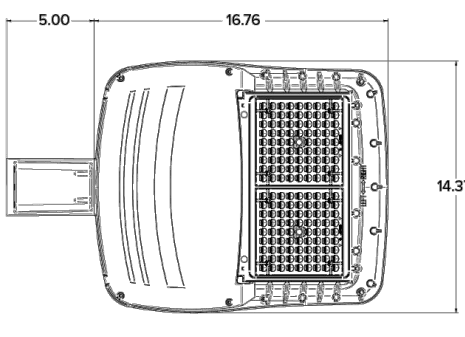

SIZE 2

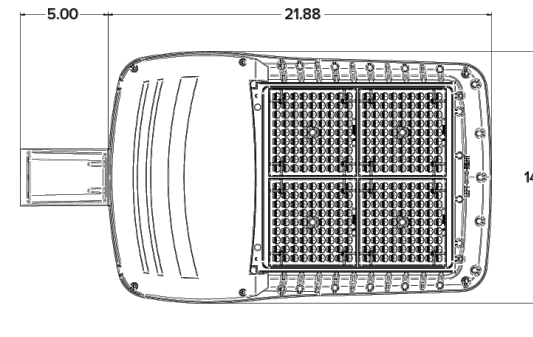

SIZE 3

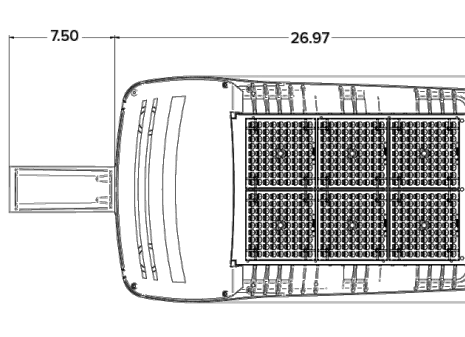

SIZE 4

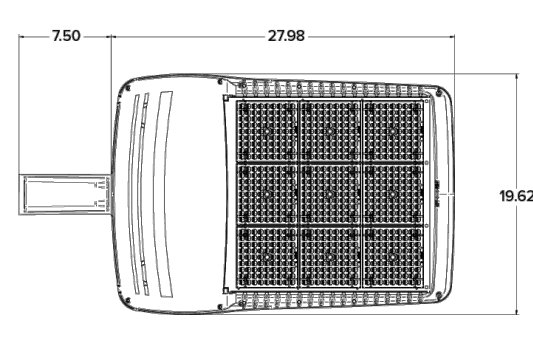

	EPA				Config.	Weight	
	VP1 (Size 1)	VP2 (Size 2)	VP3 (Size 3)	VP4 (Size 4)		lbs	kgs
Single Fixture	0.454	0.555	0.655	0.698		VP1 (Size 1) 13.7	6.2
Two at 180	0.908	1.10	1.310	1.396		VP2 (Size 2) 16.0	7.26
Two at 90	0.583	0.711	0.857	0.948		VP3 (Size 3) 25.9	11.7
Three at 90	1.037	1.266	1.512	1.646		VP4 (Size 4) 30.8	13.9
Three at 120	0.943	1.155	1.392	1.680			
Four at 90	1.166	1.422	1.74	1.896			

KEY DATA	
Lumen Range	5,000-80,000
Wattage Range	36-600
Efficacy Range (LPW)	92-155
Weight lbs. (kg)	13.7-30.9 (6.2-13.9)

Page 113 Rev. 01/12/22 BEA-VIPER-S-SPCC © 2022 Beacon Products, a division of Hubbell Lighting, Inc. Specifications subject to change without notice. 701 Millennium Boulevard • Greenville, SC 29607 | Tel: 864.678.1000 | Website: www.beaconproducts.com



Page 1013 Rev. 01/12/22 BEA-VIPER-S-SPCC © 2022 Beacon Products, a division of Hubbell Lighting, Inc. Specifications subject to change without notice. 701 Millennium Boulevard • Greenville, SC 29607 | Tel: 864.678.1000 | Website: www.beaconproducts.com



VIPER Area/Site

MICROSTRIKE OPTICS - ORDERING GUIDE

Example: VP-2-320L-145-3K7-2-R-UNV-A3-BLT

VP	Series	Optic Platform	Size	Light Engine	CCT/CRI	Distribution	Optic Rotation	Voltage
2	VP Viper	Micro Strike	1	160L-35*	5500 lumens	AP AP-Amber Phosphor Converted	L Optic rotation left	UNV 120V
				160L-50*	7500 lumens	3 Type 3	R Optic rotation right	277V
				160L-75	10000 lumens	4E Type 4	Wide	120 120V
				160L-100	12500 lumens	4W Type 4	Wide	208 208V
				160L-115	15000 lumens	50M Type 5	Wide	240 240V
				160L-135	18000 lumens	3K8 3000K, 80 CRI	Square Medium	277 277V
				160L-160	20000 lumens	3K8 3500K, 80 CRI	Square Wide	347 347V
				320L-145	24000 lumens	3K9 3000K, 90 CRI	Square Wide	480 480V
				320L-170	24000 lumens	4K7 4000K, 70 CRI	Square Wide	
				320L-215	33000 lumens	4K8 4000K, 80 CRI	Square Wide	
				320L-255	36000 lumens	4K9 4000K, 90 CRI	Square Wide	
				320L-315*	40000 lumens	5K7 5000K, 70 CRI	Square Wide	
3	VP Viper	Micro Strike	2	480L-320	44000 lumens	5K8 5000K, 80 CRI	Square Wide	
				480L-340	48000 lumens			
				480L-390	50000 lumens			
				480L-425	55000 lumens			
				480L-470	60000 lumens			
				720L-435	60000 lumens			
				720L-475	65000 lumens			
				720L-495	70000 lumens			
				720L-465*	75000 lumens			
				720L-600*	80000 lumens			
				CLO	Custom Lumen Output*			

APPLICANT TO UTILIZE 2700 OR 3000K LED LIGHTING TO ALIGN WITH CITY TYPICAL ROW LIGHTING. FINAL FIXTURE / LIGHT LEVEL SELECTION TO BE REVIEWED AND APPROVED BY CITY PUBLIC WORKS AT SITE PLAN STAGE

Mounting	DBT	Options	Network Control Options
A Arm mount for square pole/flat surface	BLT Back Matte Textured	F Fluting	NXSPW-14F NX Wireless, PR Occupancy Sensor, Dimming Daylight Harvesting, 14**
A Arm mount for round pole*	BLS Back Matte Smooth	2PF Dual Power Feed	NXSPW-40F NX Wireless, PR Occupancy Sensor, Dimming Daylight Harvesting, 40**
ASQU Universal arm mount for square pole	DBT Dark Bronze Matte Textured	2DR Dual Driver	NXSP-14F NX PR Occupancy Sensor, Dimming Daylight Harvesting, 14**
A-U Universal arm mount for round pole*	TE Toolless Entry	BC Backlight Control	NXSP-40F NX PR Occupancy Sensor, Dimming Daylight Harvesting, 40**
AAU Adjustable arm for pole mounting (universal drill pattern)	DES Dark Bronze Glass Smooth	TB Terminal Block	NOWE NX Wireless Enabled (module + radio)**
AA-U Adjustable arm mount for round pole*	GTT Graphite Matte Textured		WR wiSCAPE™ In-Fixture Module**
ADU Decorative upswept arm (universal drill pattern)	LGS Light Gray Glass Smooth		WRSC wiSCAPE™ Module and Occupancy Sensor**
AD-U Decorative upswept arm mount for round pole*	LGT Light Gray Glass Textured		BT5-14F Bluetooth® Programmable, PR Occupancy/Daylight Sensor *
MAF Mast arm fitter for 2-3/8" OD horizontal arm	PSS Platinum Silver Smooth		BT5-40F Bluetooth® Programmable, PR Occupancy/Daylight Sensor, up to 12' mounting height *
K Knuckle	WHT White Matte Textured		79R 7-pin Receptacle *
T Trunion	WHS White Glass Smooth		79R-SC 7-pin Receptacle with shorting cap *
WB Wall Bracket, horizontal tenon with MAF	VGT Verde Green Textured		3PR 3-pin Receptacle with shorting cap *
WM Wall mount bracket with decorative upswept arm	CC Custom Color		3PR-SC 3-pin Receptacle with shorting cap *
WA Wall mount bracket with adjustable arm			3PR-TL 3-pin Receptacle with shorting cap *

1 - Items with a grey background can be done as a custom order. Contact brand representative for more information
 2 - Replace " " with "1" for 2.5"-3.4" OD pole, "3" for 3.5"-4.0" OD pole, "4" for 4.1"-5.25" OD pole, "5" for 5.5"-6.5" OD pole
 3 - Networked Controls cannot be combined with other control options
 4 - Not available with 2PF option
 5 - Not available with Dual Driver option
 6 - Some voltage restrictions may apply when combined with controls
 7 - Not available with 480V

Page 210 Rev. 01/12/22 BEA-VIPER-S-SPCC © 2022 Beacon Products, a division of Hubbell Lighting, Inc. Specifications subject to change without notice. 701 Millennium Boulevard • Greenville, SC 29607 | Tel: 864.678.1000 | Website: www.beaconproducts.com



VIPER Area/Site

MOUNTING

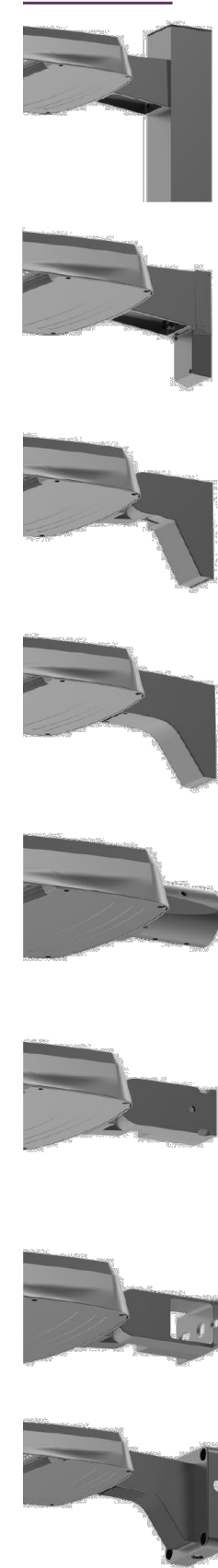

ASQ-STRAIGHT ARM MOUNT

Fixture ships with integral arm for ease of installation. Compatible with Hubbell Outdoor B3 drill pattern. For round poles add applicable suffix (2/3/4/5)

ASQU-UNIVERSAL ARM MOUNT

Universal mounting block for ease of installation. Compatible with drill patterns from 2.5" to 4.5" and Hubbell drill pattern S2. For round poles add applicable suffix (2/3/4/5)

AAU-ADJUSTABLE ARM FOR POLE MOUNTING

Rotatable arm mounts directly to pole. Compatible with drill patterns from 2.5" to 4.5" and Hubbell drill pattern S2. For round poles add applicable suffix (2/3/4/5). Rotatable in 15° aiming angle increments. Micro Strike configurations have a 45° aiming limitation. Strike configurations have a 30° aiming limitation.

ADU-DECORATIVE UPSWEPT ARM

Upswept Arm compatible with drill patterns from 2.5" to 4.5". For round poles add applicable suffix (2/3/4/5)

MAF-MAST ARM FITTER

Fits 2-3/8" OD horizontal tenons.

K-KNUCKLE

Knuckle mount 15° aiming angle increments for precise aiming and control, fits 2-3/8" tenons or pipes. Micro Strike configurations have a 45° aiming limitation. Strike configurations have a 30° aiming limitation.

T-TRUNNION

Truncheon for surface end crossarm mounting using (1) 3/4" or (2) 1/2" size through bolts. Micro Strike configurations have a 45° aiming limitation. Strike configurations have a 30° aiming limitation.

WM-WALL MOUNT

Compatible with universal arm mount, adjustable arm mount, and decorative arm mount. The WA option uses the same wall bracket but replaces the decorative arm with an adjustable arm.

Page 1113 Rev. 01/12/22 BEA-VIPER-S-SPCC © 2022 Beacon Products, a division of Hubbell Lighting, Inc. Specifications subject to change without notice. 701 Millennium Boulevard • Greenville, SC 29607 | Tel: 864.678.1000 | Website: www.beaconproducts.com



SES POLES

SQUARE STEEL STRAIGHT POLES (SSP)

Specifications

The Square Steel Straight Pole has been successfully installed in projects of all types for over 30 years and has become the most popular and economical pole option for all site lighting applications including retail, commercial, industrial and residential projects.

The popularity of this series is due to its full offering of sizes, heights and standard colors with complete offering of mounting options, accessories and select styles/colors stocked for immediate shipping.

- Square Steel Straight Shaft
- One piece construction
- 2-3/8" OD tenon, Open Top or Factory drilled Side Mount Options available
- Steel Base Plate
- 3 size options for anchor bolts. All anchor bolts fully galvanized with 2 nuts and washer (bolts ordered as separate line item and paper template included as component of pole)
- Square base cover available (ordered as separate line item)
- Pole finished in weather proof powder coat paint in 4 standard colors
- 3" x 5" Gasketed hand hole standard

Dimensions

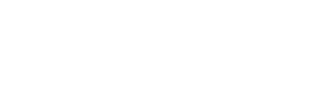
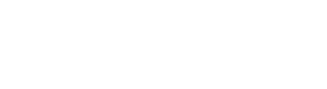
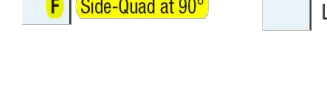
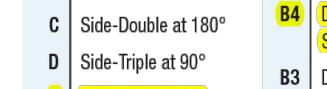
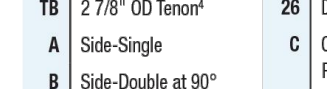
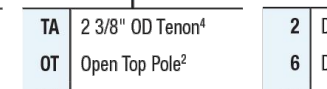
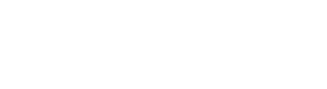
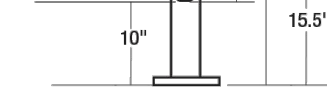
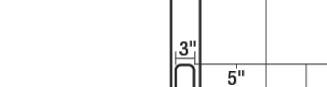
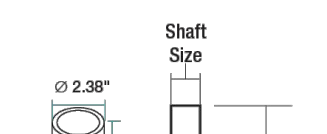

All DETAILS ON THIS SHEET WERE PROVIDED BY OTHERS AND ARE FOR INFORMATIONAL PURPOSE ONLY. DYNAMIC ENGINEERING TO BE HELD HARMLESS IN THE EVENT OF ERRONEOUS INFORMATION CONTAINED WITHIN THESE DETAILS AND/OR STRUCTURE FAILURE.

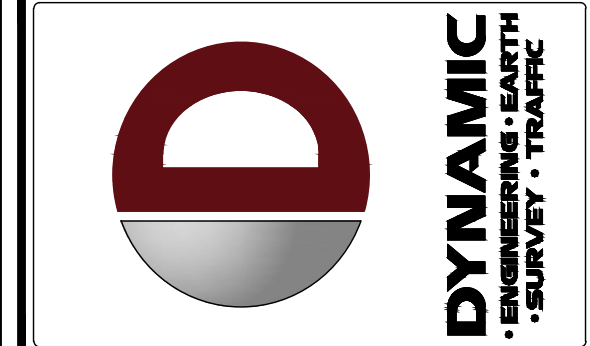

REV.	DATE	COMMENTS
2	08/19/24	GDP SET THIRD SUBMITTAL
1	07/22/24	GDP SET SECOND SUBMITTAL
0	07/18/24	GDP SET FIRST SUBMISSION

THIS PLAN SET IS FOR PERMITTING PURPOSES ONLY AND MAY NOT BE USED FOR CONSTRUCTION

PROJECT: SOUTHPIV W/ DRIVE THRU PROPOSED TACO BELL FAST FOOD RESTAURANT W/ DRIVE THRU MARKETPLACE, PARCEL D 10120 FAIRFAX BOULEVARD, CITY OF FAIRFAX, FAIRFAX COUNTY, VIRGINIA

DATE: 01/18/2024

SCALE: (H) AS NOTED (V) ---

811 PROTECT YOURSELF

ALL STATES REQUIRE NOTIFICATION OF DIGITARIANS, DESIGNERS, OR ANY PERSON PREFERRING TO DESIGN THE SURFACE ANYWHERE IN ANY STATE

FOR STATE SPECIFIC DIRECT PHONE NUMBERS VISIT: WWW.CALL811.COM

DYNAMIC ENGINEERING

LAND DEVELOPMENT CONSULTING • PERMITTING GEOTECHNICAL • ENVIRONMENTAL TRAFFIC • SURVEY • PLANNING • ZONING

125 West Street - Suite 201 Annapolis, MD 21412 T: 410.567.5000

Offices conveniently located at:

Chesapeake Beach, MD • 410.567.5000
 Chevy Chase, MD • 301.591.1111
 Crystal Beach, MD • 410.567.5000
 Fort Belvoir, MD • 410.567.5000
 Fort Detrick, MD • 301.591.1111
 Fort Meade, MD • 410.567.5000
 Fort Monmouth, MD • 410.567.5000
 Fort Rucker, MD • 410.567.5000
 Fort Totten, MD • 410.567.5000
 Fort Voss, MD • 410.567.5000
 Fort Wainwright, MD • 410.567.5000
 Fort Whiting, MD • 410.567.5000
 Fort Wood, MD • 410.567.5000
 Fort York, MD • 410.567.5000
 Fort Ziegler, MD • 410.567.5000
 Fort ...

CONNECTICUT PROFESSIONAL ENGINEER

CONNECTIONS

CONNECTIONS

TITLE: LIGHTING DETAILS

SCALE: (H) AS NOTED (V) --- DATE: 01/18/2024

PROJECT No: 3486-22-01538

SHEET No: 14 Rev. #: 14

Site Information

Post-Development Project (Treatment Volume and Loads)

Enter Total Disturbed Area (acres) → 0.46

Maximum reduction required:	10%
The site's net increase in impervious cover (acres) is:	1.19
Post-Development TP Load Reduction for Site (lb/yr):	0.83

Pre-ReDevelopment Land Cover (acres)

	A Soils	B Soils	C Soils	D Soils	Totals
Forest (acres) -- undisturbed, protected forest or reforested land		0.58			0.58
Mixed Open (acres) -- undisturbed/infrequently maintained grass or shrub land				1.00	1.00
Managed Turf (acres) -- disturbed, graded for yards or other turf to be mowed/managed				1.03	1.03
Impervious Cover (acres)				0.55	0.55
					3.16

Post-Development Land Cover (acres)

	A Soils	B Soils	C Soils	D Soils	Totals
Forest/Open Space (acres) -- undisturbed, protected forest or reforested land		0.58			0.58
Mixed Open (acres) -- undisturbed/infrequently maintained grass or shrub land					0.00
Managed Turf (acres) -- disturbed, graded for yards or other turf to be mowed/managed				0.84	0.84
Impervious Cover (acres)				1.74	1.74
Area Check	OK.	OK.	OK.	OK.	3.16

* Forest & Mixed Open areas must be protected in accordance with the Virginia Runoff Reduction Method or other applicable DEQ guidelines

Site Results (Water Quality Compliance) VRRM 4.1, 2024

Area Checks	D.A. A	D.A. B	D.A. C	D.A. D	D.A. E	AREA CHECK
FOREST (ac)	0.00	0.00	0.00	0.00	0.00	OK.
MIXED OPEN (ac)	0.00	0.00	0.00	0.00	0.00	OK.
MIXED OPEN AREA TREATED(ac)	0.00	0.00	0.00	0.00	0.00	OK.
MANAGED TURF AREA (ac)	0.18	0.02	0.00	0.00	0.00	OK.
MANAGED TURF AREA TREATED (ac)	0.18	0.02	0.00	0.00	0.00	OK.
IMPERVIOUS COVER (ac)	0.70	1.04	0.00	0.00	0.00	OK.
IMPERVIOUS COVER TREATED (ac)	0.70	1.04	0.00	0.00	0.00	OK.
AREA CHECK	OK.	OK.	OK.	OK.	OK.	

Site Treatment Volume (ft³) 6,825

Runoff Reduction Volume and TP By Drainage Area

	D.A. A	D.A. B	D.A. C	D.A. D	D.A. E	TOTAL
RUNOFF REDUCTION VOLUME ACHIEVED (ft ³)	0	0	0	0	0	0
TP LOAD AVAILABLE FOR REMOVAL (lb/yr)	0.75	0.91	0.00	0.00	0.00	1.66
TP LOAD REDUCTION ACHIEVED (lb/yr)	0.38	0.45	0.00	0.00	0.00	0.83
TP LOAD REMAINING (lb/yr)	0.38	0.45	0.00	0.00	0.00	0.83
NITROGEN LOAD REDUCTION ACHIEVED (lb/yr)	0.00	0.00	0.00	0.00	0.00	0.00

Total Phosphorus

FINAL POST-DEVELOPMENT TP LOAD (lb/yr)	2.24
TP LOAD REDUCTION REQUIRED (lb/yr)	0.83
TP LOAD REDUCTION ACHIEVED (lb/yr)	0.83
TP LOAD REMAINING (lb/yr):	1.41
REMAINING TP LOAD REDUCTION REQUIRED (lb/yr):	0.00

**No further TP load reduction required (Required - Achieved < 0.005 lb/yr)

Total Nitrogen (For Information Purposes)

POST-DEVELOPMENT LOAD (lb/yr)	29.63
NITROGEN LOAD REDUCTION ACHIEVED (lb/yr)	0.00
REMAINING POST-DEVELOPMENT NITROGEN LOAD (lb/yr)	29.63

STORMFILTER (BMP) SIZING COMPUTATIONS

(FROM MANUFACTURER, CONTECH STORMWATER SOLUTIONS, www.contech-cpl.com)



Sizing Summary

Boulevard Marketplace Stormwater Treatment System/Design Summary
Fairfax City, VA

Information provided:

- West Side - Area 2
 - Total Area = 1.3 acres
 - Rational C Factor = 0.79
- East Side
 - Total Area = 0.77 acres
 - Rational C Factor = 0.80
- Presiding agency = VDCR

Assumptions:

- Design storm = Modified Rational method
- Rainfall intensity = 0.35in/hr (currently accepted by the VDCR)
- Media = Zeolite/Perlite/GAC (90% TP removal credit)
- Drop required from inlet to outlet = 1.75' for 12", 2.3' for 18", 3.05' for 27" cartridge heights
- Depth required from rim to outlet = 5.6' minimum

Size estimates:

The Stormwater Management StormFilter® is a passive, siphon-actuated, flow-through stormwater filtration system consisting of a structure that houses rechargeable, media-filled filter cartridges. The StormFilter works by passing stormwater through the media-filled cartridges, which trap particulates and adsorb pollutants such as dissolved metals, nutrients, and hydrocarbons. Depending on site constraints, CONTECH offers three different StormFilter cartridge sizes: 12", 18", and 27" tall. The StormFilter system is VDCR verified and as a result has received approval for 80% TSS and 90% TP removal.

The StormFilter is a flow-based system utilizing cartridges flowing at 2 gpm/ft² of filter media. The system is sized by calculating the peak water quality flow rate associated with the design storm. The water quality flow rate was calculated using the Modified Rational Method assuming a rainfall intensity of 0.35 inches per hour.

West Side - Area 2:

Given the information above the treatment flow rate was determined to be:

$$Q_{max} = CIA = 0.79 \times 0.35 \times 1.3 = 0.36 \text{ cfs}$$

$$N_{cartridges} = \frac{Q_{max} \times 449 \text{ gpm/ft}^2}{SA_{available} \times Q_{operating}} = \frac{0.36 \text{ cfs} \times 449 \text{ gpm/ft}^2}{7.5 \text{ ft}^2 \times 2 \text{ gpm/ft}^2} = 10.8 \rightarrow \text{use (11) 18" cartridges}$$

To accommodate a treatment flow rate of 0.36 cfs, CONTECH Stormwater Solutions recommends using a 96" Precast Manhole StormFilter system with (11) 18" tall cartridges (see attached detail). The 18" tall cartridge contains 7.5 square feet of media surface and a radial media flow depth of seven inches. The

©2006 CONTECH Stormwater Solutions 521 Progress Drive, Suite H, Linthicum, MD 21090 TS-0025
contechstormwater.com Toll-Free: 866.740.3318 Fax: 866.378.8511



Sizing Summary

estimated cost of this system, complete and delivered to the job site, is available upon request. The contractor is responsible for setting the StormFilter vault and all external piping.

East Side:

Given the information above the treatment flow rate was determined to be:

$$Q_{max} = CIA = 0.80 \times 0.35 \times 0.77 = 0.22 \text{ cfs}$$

$$N_{cartridges} = \frac{Q_{max} \times 449 \text{ gpm/ft}^2}{SA_{available} \times Q_{operating}} = \frac{0.22 \text{ cfs} \times 449 \text{ gpm/ft}^2}{7.5 \text{ ft}^2 \times 2 \text{ gpm/ft}^2} = 6.6 \rightarrow \text{use (7) 18" cartridges}$$

To accommodate a treatment flow rate of 0.21 cfs, CONTECH Stormwater Solutions recommends using a 72" Precast Manhole StormFilter system with (7) 18" tall cartridges (see attached detail). The 18" tall cartridge contains 7.5 square feet of media surface and a radial media flow depth of seven inches. The estimated cost of this system, complete and delivered to the job site, is available upon request. The contractor is responsible for setting the StormFilter vault and all external piping.

Online / Office:

The Precast StormFilter is designed as an offline system to reduce the chances of sediment washout during higher intensity storms. CONTECH Stormwater Solutions offers a high-flow bypass, the StormGate, which provides a combination weir-orifice control structure to limit the flow to the StormFilter.

Maintenance:

The StormFilter requires regular maintenance to operate effectively. The expected maintenance interval for systems in Virginia is 12-24 months, but may vary depending on weather and site conditions. CONTECH Stormwater Solutions Inc. offers full maintenance services to all of our clients, as well as a cartridge exchange program to facilitate owner provided maintenance. Please contact CONTECH Stormwater Solutions or navigate to contechstormwater.com for more information in this regard.

Thank you for the opportunity to present this to you and your client.

©2006 CONTECH Stormwater Solutions 521 Progress Drive, Suite H, Linthicum, MD 21090 TS-0025
contechstormwater.com Toll-Free: 866.740.3318 Fax: 866.378.8511

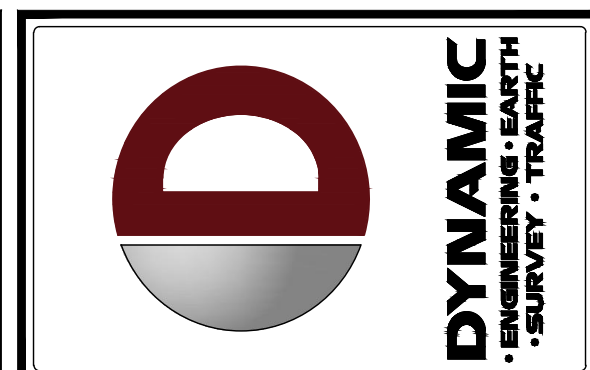

REV.	DATE	COMMENTS
0	07/18/24	CDP SET FIRST SUBMISSION
1	07/22/24	CDP SET SECOND SUBMITTAL
2	08/19/24	CDP SET THIRD SUBMITTAL

THIS PLAN SET IS FOR PERMITTING PURPOSES ONLY AND MAY NOT BE USED FOR CONSTRUCTION

PROJECT: **SOUTHPAW PROPOSED TACO BELL FAST FOOD RESTAURANT W/ DRIVE-THRU**
BOULEVARD MARKETPLACE, PARCEL D
10120 FAIRFAX BOULEVARD
CITY OF FAIRFAX, FAIRFAX COUNTY, VIRGINIA

811 PROTECT YOURSELF
ALL STATES REQUIRE NOTIFICATION OF EXCAVATORS, DESIGNERS, OR ANY PERSON PREPARING TO DIGGING THE EARTH'S SURFACE ANYWHERE IN ANY STATE.
FOR STATE SPECIFIC DIRECT PHONE NUMBERS VISIT: WWW.CALL811.COM

DYNAMIC ENGINEERING
LAND DEVELOPMENT CONSULTING • PERMITTING
GEOTECHNICAL • ENVIRONMENTAL
TRAFFIC • SURVEY • PLANNING & ZONING
125 West Street - Suite 201
Annapolis, MD 21412
T: 410.567.5000
Offices conveniently located at:
Lynch, VA • 703.713.1111
Chesapeake, VA • 757.427.9227
Baltimore, MD • 410.531.3333
York, PA • 717.764.2118
Newport News, VA • 757.241.2118
Hollywood, FL • 305.955.4888
Fort Myers, FL • 239.338.4449
Miami, FL • 305.424.2118
Houston, TX • 281.787.4449
Dallas, TX • 972.424.2118
Del Rio, TX • 361.521.2000
Annapolis, MD • 410.567.5000
www.dynamiccec.com

MARLA A. ROLLER
LICENSED LANDSCAPE ARCHITECT
VIRGINIA LICENSE No. 406002245



TITLE: **SWM AND BMP ANALYSIS**

SCALE: (H) AS NOTED DATE: 01/18/2024
PROJECT No: 3486-22-01538
SHEET No: **16** OF 19 Rev. #:

Plotted: 08/19/24 - 5:54 PM, By: ezhang File: \\deeplocal\defilers\DATA\PROJECTS\3486 ABE0 Capital\22-01538 Fairfax VA\DWG\Special Exception Plans\04482201538SWM.dwg. ---> SWM BMP ANALYSIS

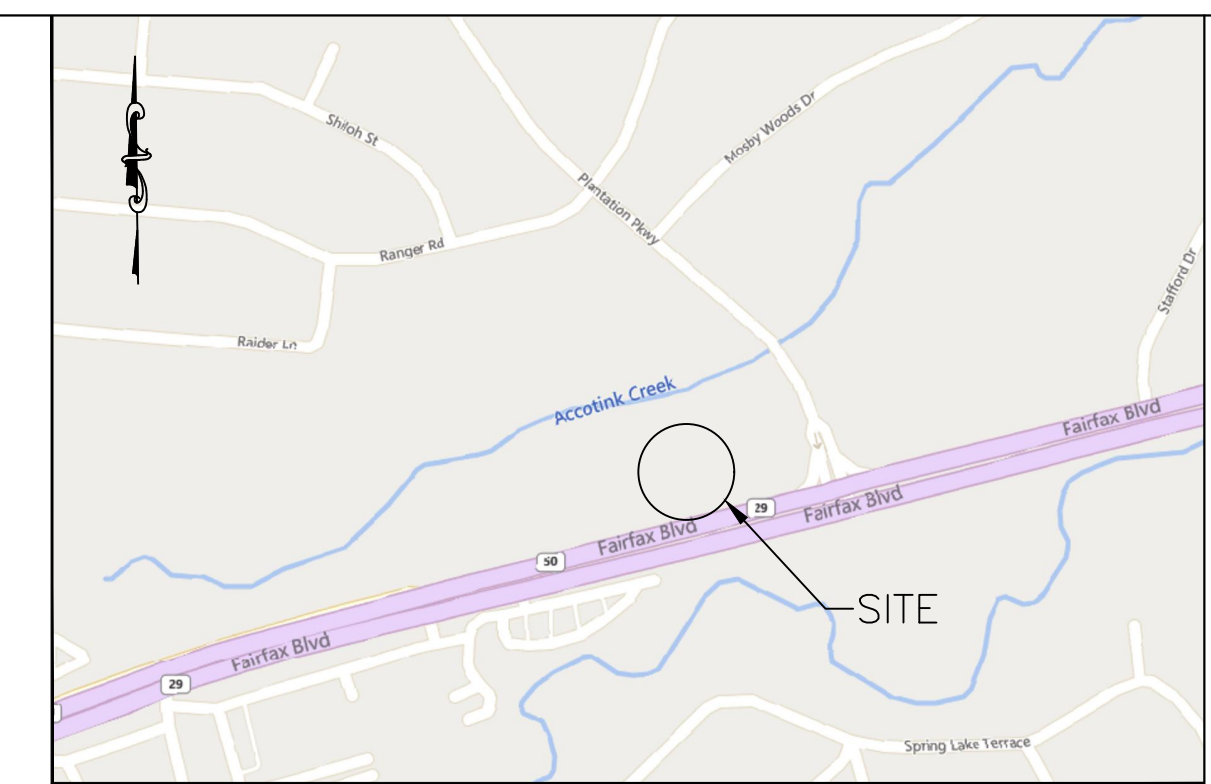
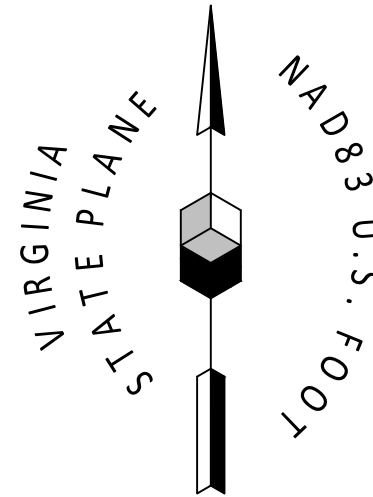

LOCATION MAP

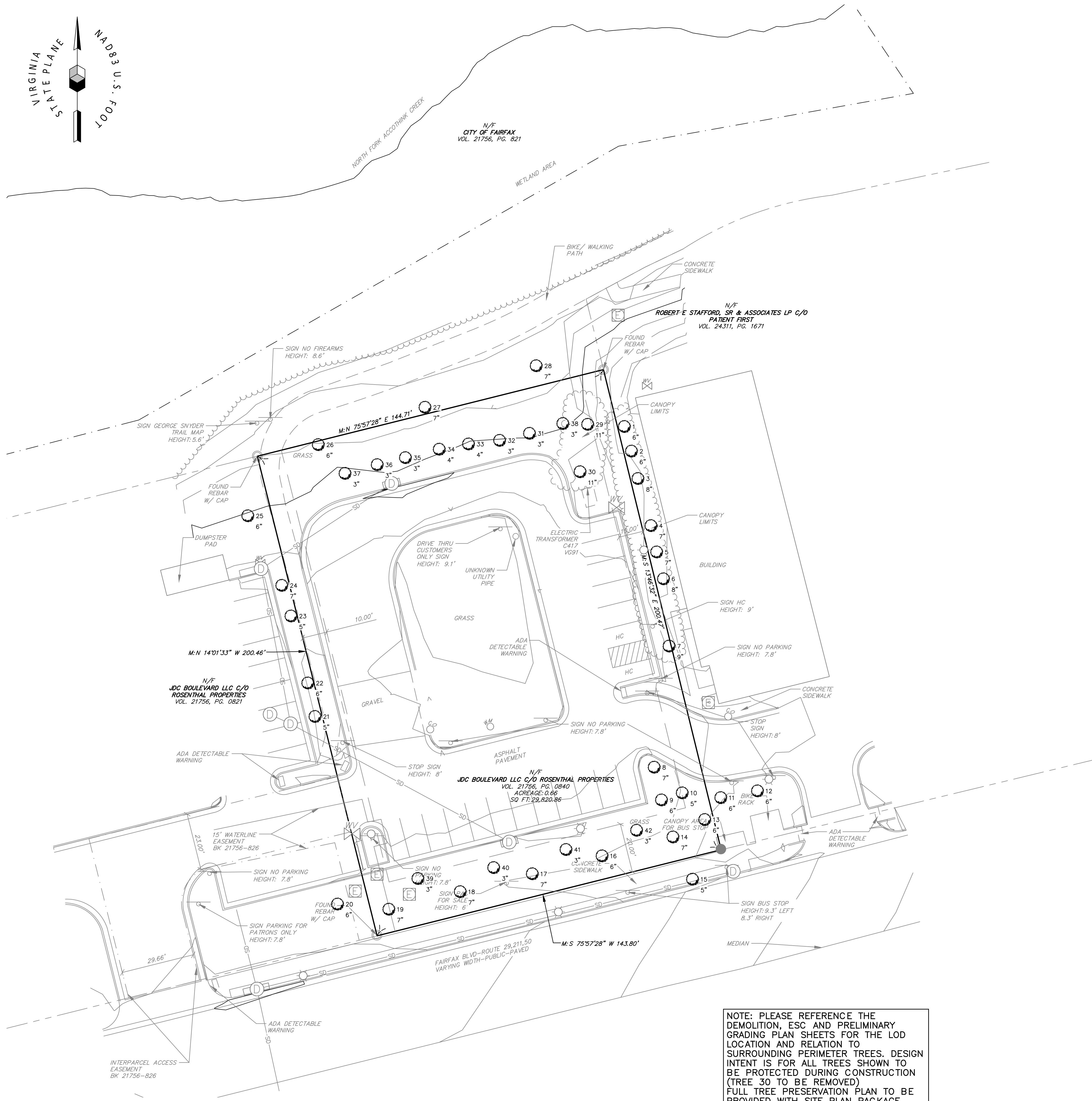

Tree Inventory			
Tree No.	Caliper	Name	Notes
1	6"	REDBUD	
2	6"	REDBUD	
3	8"	REDBUD	
4	7"	REDBUD	
5	7"	REDBUD	
6	8"	REDBUD	
7	9"	OAK	
8	7"	OAK	
9	6'6"5/4"	BIRCH	Mult-stem
10	5'5"5/4"	BIRCH	Mult-stem
11	6"	MAPLE	
12	6"	MAPLE	
13	6'6"6"5"	BIRCH	Mult-stem
14	7"	LINDEN	
15	5"	CHERRY	
16	6"	LINDEN	
17	7"	LINDEN	
18	7"	LINDEN	
19	7"	LINDEN	
20	6"	PERSIMMON	
21	5'3"	BIRCH	Mult-stem
22	6'5"5/4"	BIRCH	Mult-stem
23	5'5"4"	BIRCH	Mult-stem
24	7'6"5"	BIRCH	Mult-stem
25	6'5"4"	BIRCH	Mult-stem
26	6"	OAK	
27	7"	OAK	
28	7"	OAK	
29	11"	OAK	
30	11"	OAK	
31	3'3"3"2"	SERVICEBERRY	Mult-stem
32	3'3"3"2"	SERVICEBERRY	Mult-stem
33	4'3"3"2"	SERVICEBERRY	Mult-stem
34	4'3"3"2"2"2"2"	SERVICEBERRY	Mult-stem
35	3'3"2"2"2"	SERVICEBERRY	Mult-stem
36	3'3"2"2"2"	SERVICEBERRY	Mult-stem
37	3'3"2"2"2"	SERVICEBERRY	Mult-stem
38	3'3"2"2"2"	SERVICEBERRY	Mult-stem
39	3'3"2"2"2"	SERVICEBERRY	Mult-stem
40	3'3"2"2"2"	MAGNOLIA MULTI	Mult-stem
41	3'3"2"2"2"2"	MAGNOLIA MULTI	Mult-stem
42	3'2"2"1"1"	MAGNOLIA MULTI	Mult-stem

GENERAL NOTES
 TREE IDENTIFICATION IS THE OPINION OF THE SURVEYOR ONLY AND HAS NOT BEEN CONFIRMED BY A CERTIFIED ARBORIST.

NOTE: PLEASE REFERENCE THE DEMOLITION, ESC AND PRELIMINARY GRADING PLAN SHEETS FOR THE LOD LOCATION AND RELATION TO SURROUNDING PERIMETER TREES. DESIGN INTENT IS FOR ALL TREES SHOWN TO BE PROTECTED DURING CONSTRUCTION (TREE 30 TO BE REMOVED) FULL TREE PRESERVATION PLAN TO BE PROVIDED WITH SITE PLAN PACKAGE.



Raymond Bruce Chamber

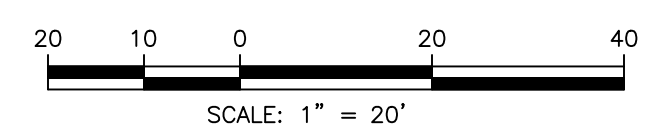

1 M/G 5/8/23 SHEET 2 TREE SURVEY ADDED

REV: BY: DATE: STATUS:

THIS PLAN SHALL NOT BE MOVED WITHOUT WRITTEN PERMISSION. ANY ALTERATIONS, AUTHORIZED OR OTHERWISE, SHALL BE AT THE USER'S SOLE RISK.

Cornerstone
Energy Services

111 CHINGHAM ROUND ROAD
ANNAPOLIS, MD 21401

410-220-5615

TREE SURVEY
OF:
10120 FAIRFAX BLVD
FAIRFAX, VA

RECORD OWNER:
JDC BOULEVARD, LLC
C/O ROSENTHAL PROPERTIES

FOR:
SOUTH PAW-DAVID PANELLA
354 AMITY ROAD, SUITE 200
WOODBRIIDGE, CT 06525

DRAWN NP/MG/AR

PROJECT NO. 22320.10

SHEET SIZE 24" x 36"

CHECKED RD

DATE 5/04/22

SCALE 1" = 20'

SHEET 2 OF 2

Plotted: 08/19/24 - 4:25 PM, by: ezhang
 File: P:\VECEPC PROJECTS\3486 ABD\Capital\22-01538 Fairfax_VA\Draw\Exhibits (hearings)\2024-06-21 Hearing\DWG\034862201538\BT_2024-06-19.dwg, ----> VEH_CIRC_EXHIBIT

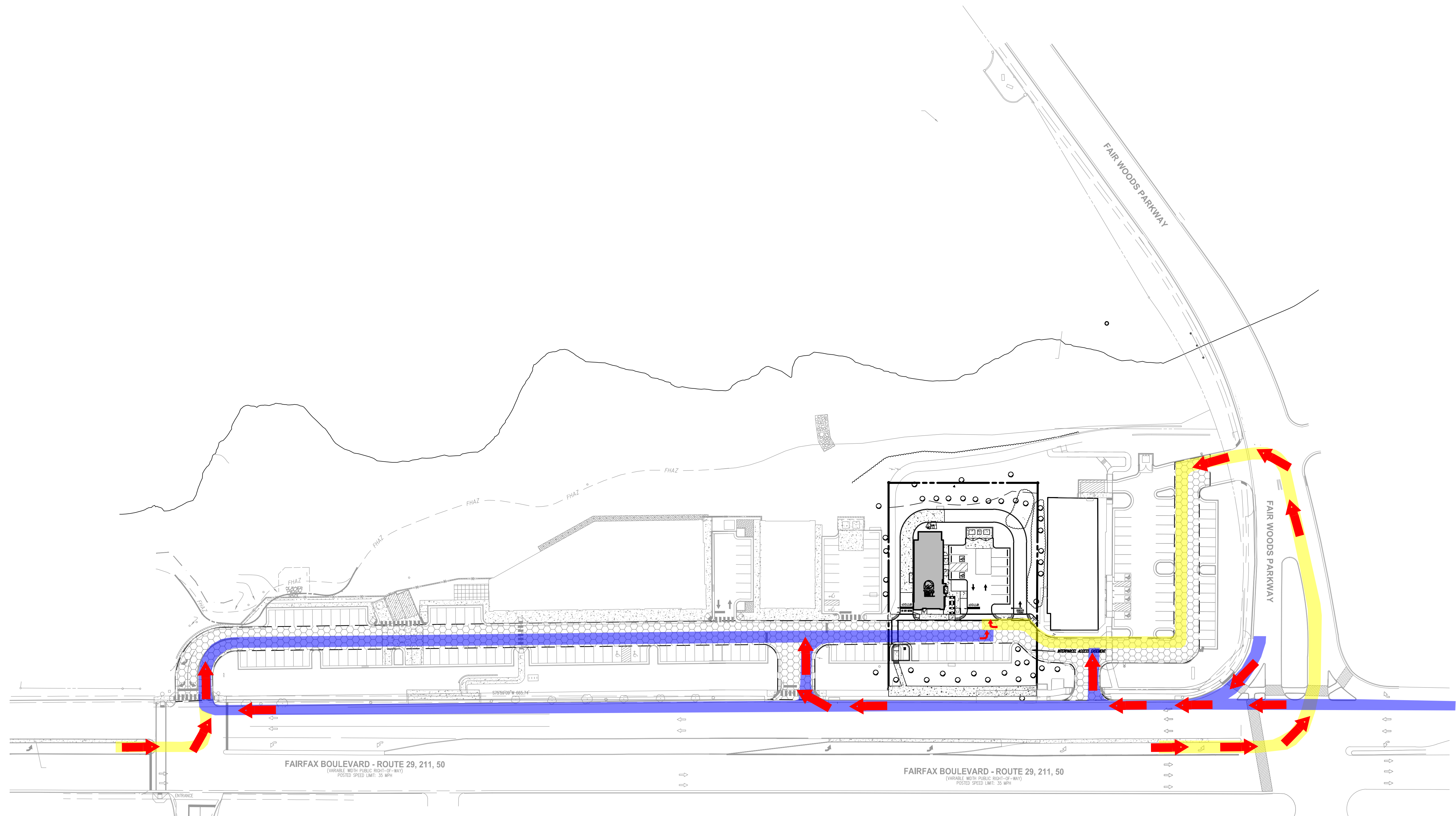

	VEHICULAR CROSS ACCESS EASEMENT AGREEMENT AREA
	VEHICULAR ACCESS TO SITE WEST BOUND
	VEHICULAR ACCESS TO SITE EAST BOUND

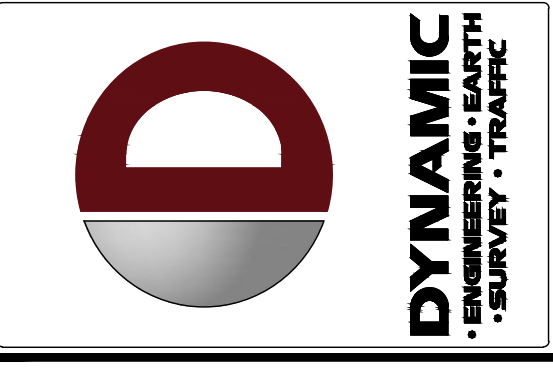
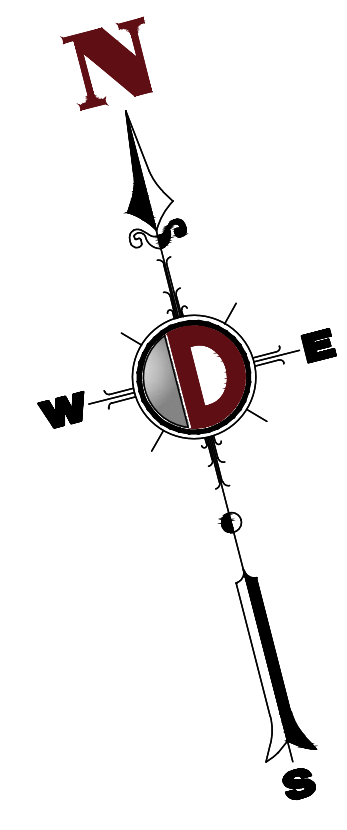
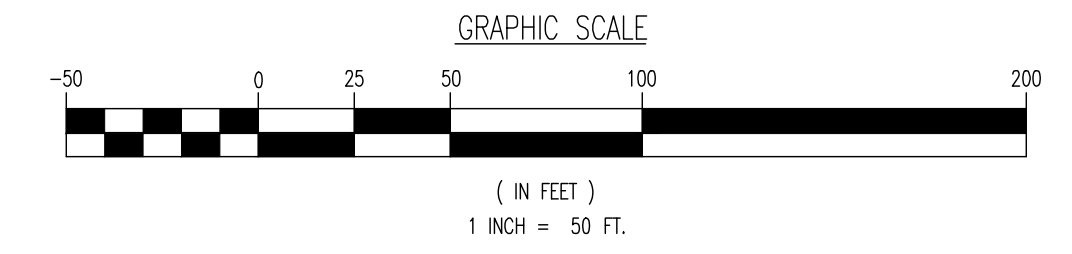

REV.	DATE	COMMENTS
2	08/19/24	GDP SET THIRD SUBMITTAL
1	07/22/24	GDP SET SECOND SUBMITTAL
0	01/18/24	GDP SET FIRST SUBMISSION

THIS PLAN SET IS FOR PERMITTING PURPOSES ONLY AND MAY NOT BE USED FOR CONSTRUCTION

OWNER: EZ
 DESIGNER: JJJ
 CHECKER: CM

PROJECT: **SOUTHPAW**
 PROPOSED TACO BELL FAST FOOD RESTAURANT W/ DRIVE-THRU
 BOULEVARD MARKETPLACE, PARCEL D
 10120 FAIRFAX BOULEVARD
 CITY OF FAIRFAX, FAIRFAX COUNTY, VIRGINIA

811 PROTECT YOURSELF
 ALL STATES REQUIRE NOTIFICATION OF EXCAVATORS, DESIGNERS, OR ANY PERSON PREFERRING TO DESIGN THE SAFETY SURFACE ANYWHERE IN ANY STATE
 FOR STATE SPECIFIC DIRECT PHONE NUMBERS VISIT: WWW.CALL811.COM

DYNAMIC ENGINEERING
 LAND DEVELOPMENT CONSULTING • PERMITTING
 GEOTECHNICAL • ENVIRONMENTAL
 TRAFFIC • SURVEY • PLANNING & ZONING
 125 West Street - Suite 201
 Annapolis, MD 21412
 T: 410.567.5000
 Offices conveniently located at:
 Land Development • 410.567.5000
 Chesapeake Bay • 410.567.5000
 Northern Virginia • 703.742.1218
 Northern Virginia • 703.742.1218
 Mississippi • 601.525.4888
 Southeastern Pennsylvania • 717.298.4400
 High Speed Rail • 703.742.1218
 Houston, Texas • 281.797.4400
 Dallas, Texas • 214.352.4400
 Dallas, Texas • 214.352.4400
 Annapolis, Maryland • 410.567.5000

www.dynamiccec.com

MARLA A. ROLLER
 LICENSED LANDSCAPE ARCHITECT
 VIRGINIA LICENSE No. 406002245

CONNOR M. MCMANUS
 PROFESSIONAL ENGINEER
 VIRGINIA LICENSE No. 406002245
 EXPIRES: 07/16/2024

TITLE:
VEHICLE CIRCULATION EXHIBIT

SCALE: (H) AS NOTED DATE: 01/18/2024
 PROJECT No: 3486-22-01538

SHEET No: **18** OF 19 Rev. #: 2

Plotted: 08/19/24 - 4:25 PM, By: ezhang
 File: P:\DCEPC PROJECTS\3486 ABD\024-06-21 Hearing\DWG\34862201538\BT_2024-06-19.dwg, ----> PED CIRC EXHIBIT

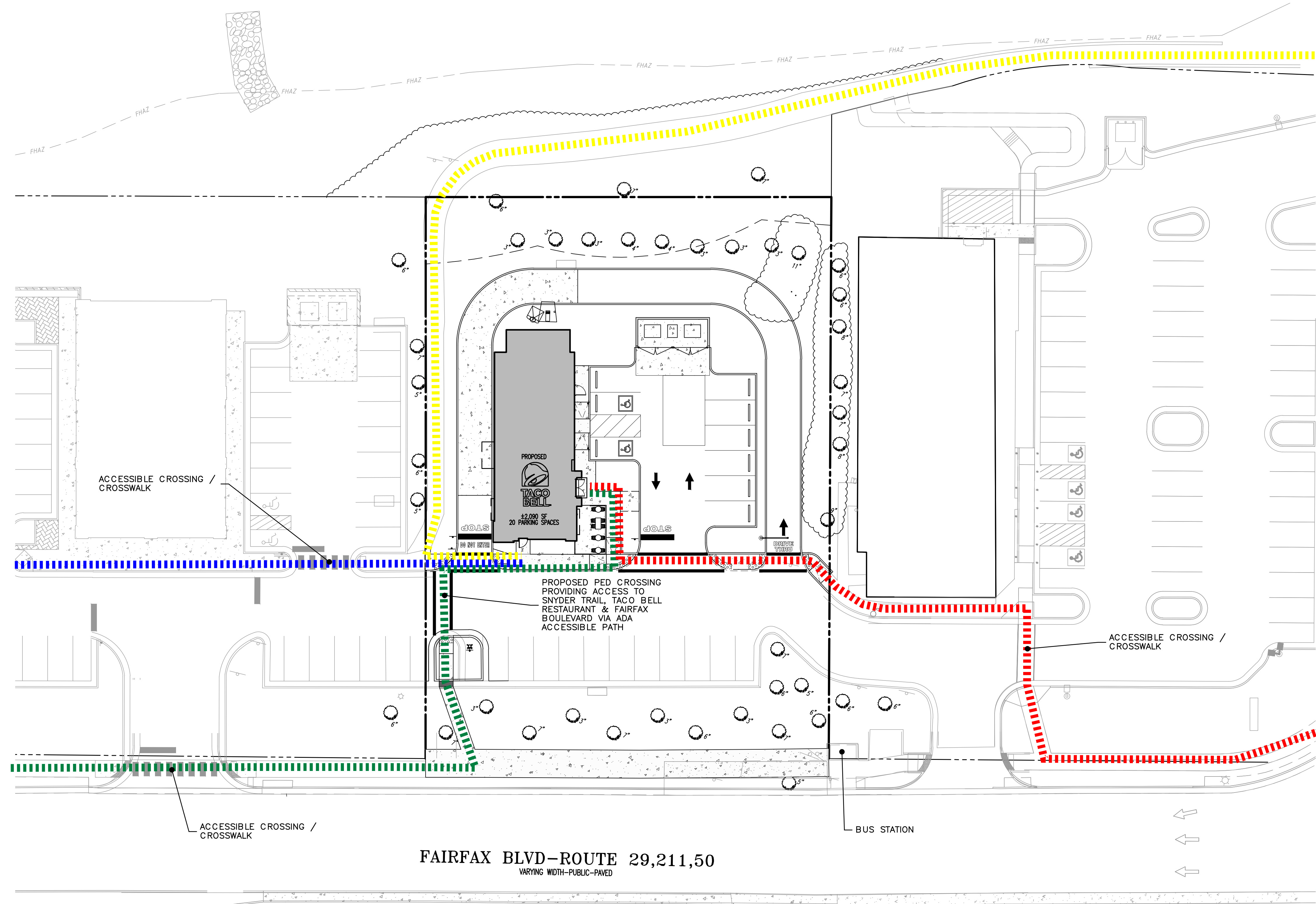

- SITE PED ACCESS - FROM PARCEL A / SHOPPING CENTER
- SITE PED ACCESS - FAIRFAX BOULEVARD EAST / FAIR WOODS PKWY
- SITE PED ACCESS - GEORGE SNYDER TRAIL
- SITE PED ACCESS - FAIRFAX BOULEVARD WEST

FAIRFAX BLVD-ROUTE 29,211,50
 VARYING WIDTH-PUBLIC-PAVED

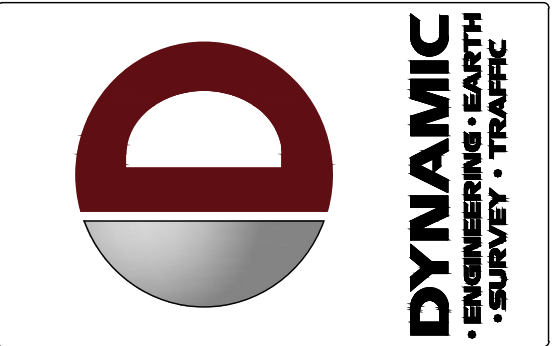
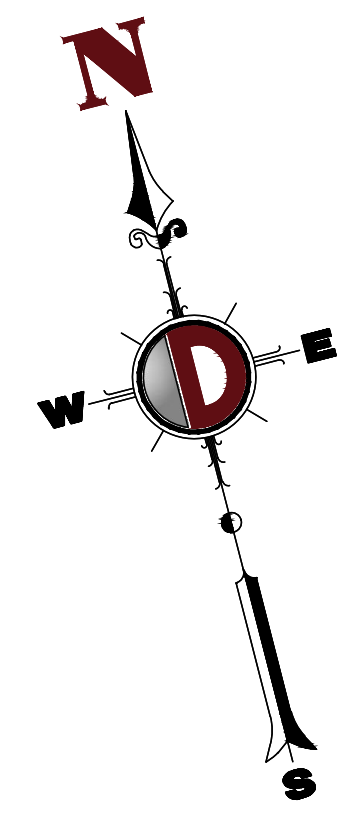
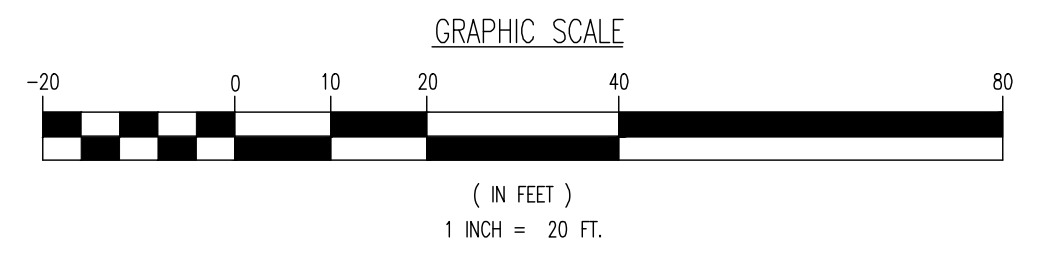

REV.	DATE	COMMENTS
2	08/19/24	GDP SET THIRD SUBMITTAL
1	07/22/24	GDP SET SECOND SUBMITTAL
0	07/18/24	GDP SET FIRST SUBMISSION

THIS PLAN SET IS FOR PERMITTING PURPOSES ONLY AND MAY NOT BE USED FOR CONSTRUCTION

OWNER: EZ
 DESIGNER: JJJ
 CHECKED BY: CM
 DRAWN BY: CM

PROJECT: **SOUTHPAW**
 PROPOSED TACO BELL FAST FOOD RESTAURANT W/ DRIVE-THRU
 BOULEVARD MARKETPLACE, PARCEL D
 10120 FAIRFAX BOULEVARD
 CITY OF FAIRFAX, FAIRFAX COUNTY, VIRGINIA

811 PROTECT YOURSELF
 ALL STATES REQUIRE NOTIFICATION OF EXCAVATORS, DESIGNERS, OR ANY PERSON PREPARING TO DIGGING THE EARTH'S SURFACE ANYWHERE IN ANY STATE
 FOR STATE SPECIFIC DIRECT PHONE NUMBERS VISIT: WWW.CALL811.COM

DYNAMIC ENGINEERING
 LAND DEVELOPMENT CONSULTING • PERMITTING
 GEOTECHNICAL • ENVIRONMENTAL
 TRAFFIC • SURVEY • PLANNING & ZONING
 125 West Street - Suite 201
 Annapolis, MD 21412
 T: 410.567.5000
 Offices conveniently located at:
 Chicago, IL • 773.311.1111
 Charlotte, NC • 704.521.1111
 Denver, CO • 303.733.1111
 Fort Worth, TX • 817.333.1111
 Houston, TX • 281.333.1111
 Indianapolis, IN • 317.333.1111
 Jacksonville, FL • 904.333.1111
 Las Vegas, NV • 702.333.1111
 Little Rock, AR • 501.333.1111
 Memphis, TN • 901.333.1111
 Miami, FL • 305.333.1111
 New York, NY • 212.333.1111
 Phoenix, AZ • 602.333.1111
 Raleigh, NC • 919.333.1111
 San Antonio, TX • 214.333.1111
 San Diego, CA • 619.333.1111
 Seattle, WA • 206.333.1111
 Tampa, FL • 813.333.1111
 Washington, DC • 202.333.1111
 Wichita, KS • 316.333.1111

MARLA A. ROLLER
 LICENSED LANDSCAPE ARCHITECT
 VIRGINIA LICENSE No. 406002245

CONNOR M. MCMANUS
 PROFESSIONAL ENGINEER
 VIRGINIA LICENSE No. 5500000000
 EXPIRES 07/16/2024

TITLE:
PEDESTRIAN CIRCULATION EXHIBIT

SCALE: (H) AS NOTED DATE: 01/18/2024
 PROJECT No: 3486-22-01538

SHEET No: **19** OF 19
 Rev. #: 2