

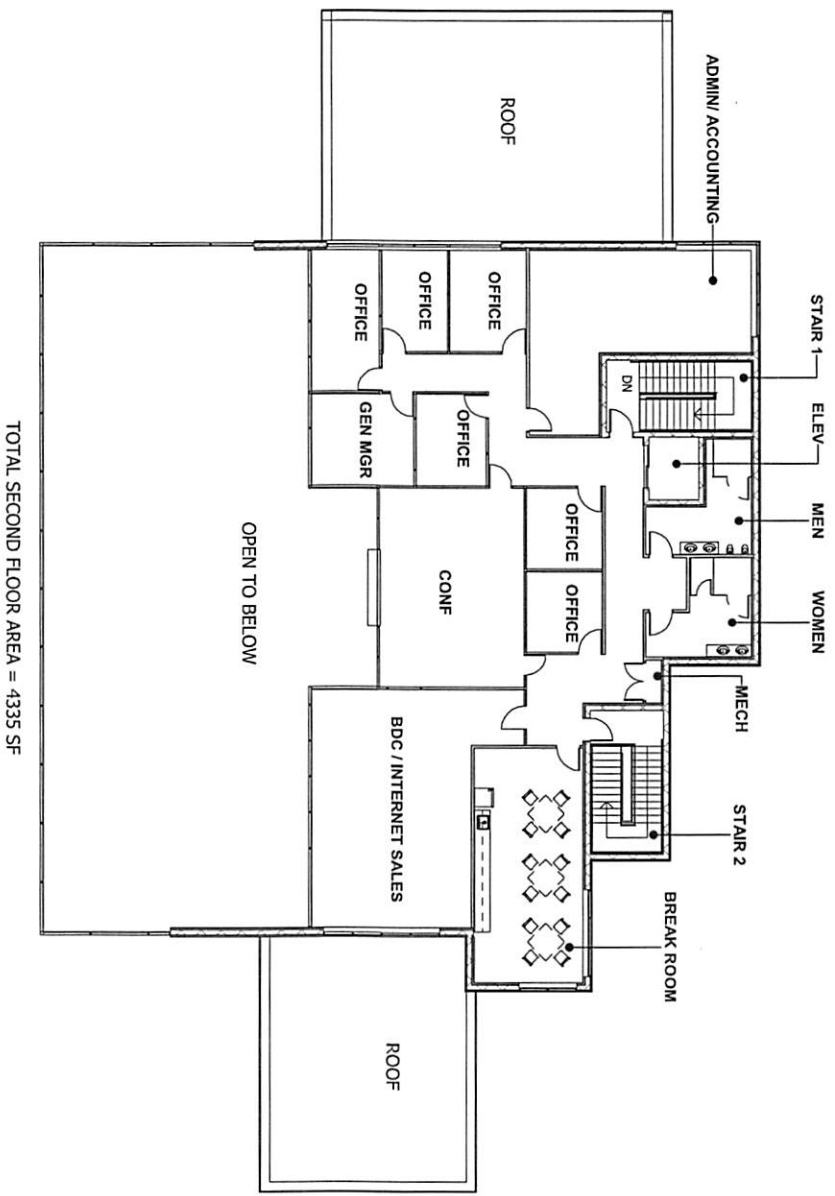

2 - SALES BUILDING - SECOND FLOOR PLAN

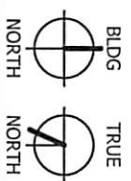

TOTAL SECOND FLOOR AREA = 4335 SF



KIA FAIRFAX SHOWROOM  
22115A  
1/16" = 1'-0"  
08/23/2024

**A H** AMMON HEISLER SACHS  
**S a** architects

300 West Port Street - Suite 275  
Baltimore, Maryland 21201  
P: 410.752.3510  
F: 410.752.8358

# 7 - SERVICE BUILDING - FLOOR PLANS

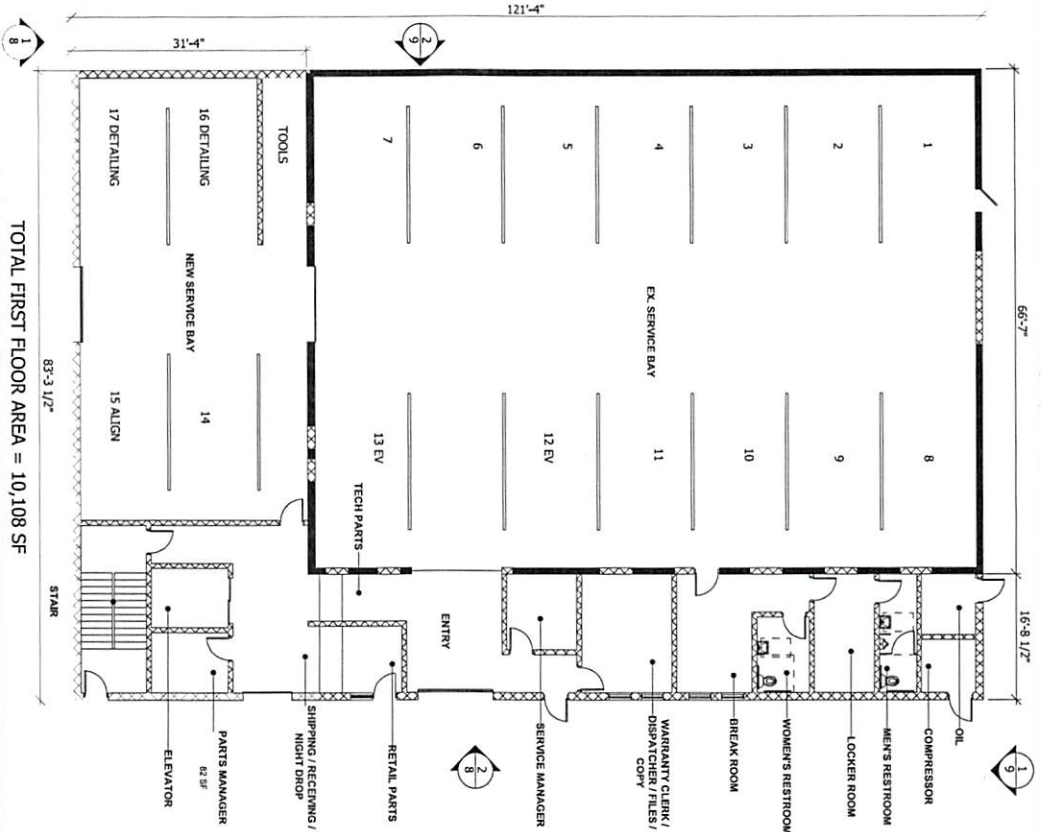

TOTAL FIRST FLOOR AREA = 10,108 SF



TOTAL SECOND FLOOR AREA = 2,741 SF

KIA SERVICE BUILDING  
22115B

1/16" = 1'-0"  
08/23/2024

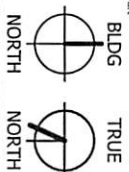

**A H** AMMON HEISLER SACHS  
**S a** architects

300 West Park Street - Suite 275  
Baltimore, Maryland 21201

P - 410.752.3510  
F - 410.752.8358