

EXISTING	LEGEND	PROPOSED
---	PROPERTY LINE	---
---	EDGE PAVEMENT	---
---	CENTERLINE	---
-x-x-	FENCE LINE	-x-x-
8" TC	SANITARY SEWER	8" TC
EX. STM.	STORM SEWER	EX. STM.
MANHOLE	MANHOLE	MANHOLE
TREES	TREES	TREES
CONTOUR LINE	CONTOUR LINE	90
RPA	RESOURCE PROTECTION AREA	RPA
WETLANDS	WETLANDS	WETLANDS
WATER EDGE	WATER EDGE	WATER EDGE
HDPE DRAINAGE PIPE	HDPE DRAINAGE PIPE	HDPE DRAINAGE PIPE
SPOT ELEVATION	SPOT ELEVATION	442.5
BUILDINGS	BUILDINGS	BUILDINGS

NO.	KEY	SYMBOL	DESCRIPTION
3.05	SSF	--- ---	SUPER SILT FENCE
3.32	PS	---PS---	PERMANENT SEEDING
LOD	LOD	---LOD---	LIMITS OF DISTURBANCE (SEE NOTE 7)

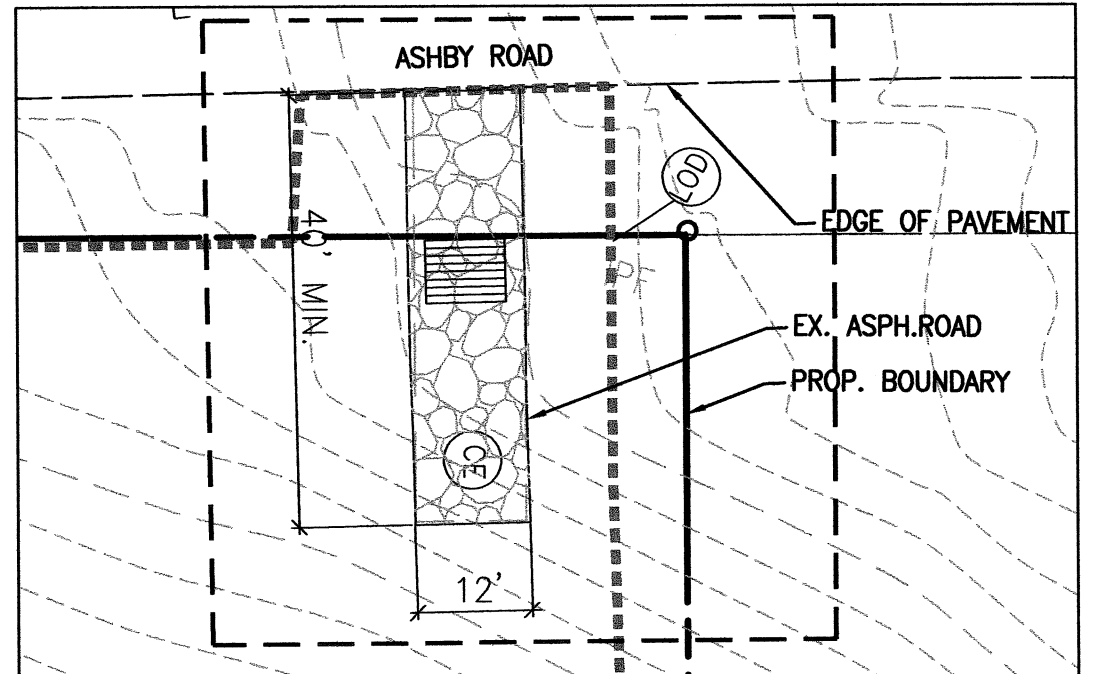

CONSTRUCTION ENTRANCE
SCALE: 1" = 20'

NOTES:

1. CONTRACTOR RESPONSIBLE TO NOT ENCROACH ADJACENT PROPERTY BOUNDARY.
2. PLAN ALIGNMENT OF WOOD CHIP TRAIL AND WOOD BRIDGES IS FOR PLANNING ONLY. ACTUAL ALIGNMENT WILL BE ESTABLISHED BY ON-SITE WALK WITH CLIENT AND CONTRACTOR.
3. STABILIZED STONE DUST TRAIL SHALL BE ADA COMPLIANT. CONTRACTOR RESPONSIBLE TO NOT EXCEED 5% LONGITUDINAL SLOPE OR 2% CROSS SLOPE AT ANY POINT ALONG TRAIL.
4. THE EXISTING UNDERGROUND UTILITIES SHOWN HEREON ARE BASED UPON AVAILABLE INFORMATION. THE CONTRACTOR SHALL BE RESPONSIBLE FOR CALLING MISS UTILITY TO DETERMINE THE EXACT LOCATION OF ALL UTILITIES BEFORE COMMENCING WORK AND IS RESPONSIBLE FOR ANY DAMAGES WHICH OCCUR BY HIS FAILURE TO LOCATE OR PRESERVE THESE UNDERGROUND UTILITIES.
5. IT SHALL BE THE RESPONSIBILITY OF THE CONTRACTOR TO VERIFY FIELD CONDITIONS PRIOR TO CONSTRUCTION AND TO NOTIFY WHGA IF THE FIELD CONDITIONS ARE NOT IN CONFORMANCE WITH THE APPROVED PLANS.
6. CONTRACTOR RESPONSIBLE TO RESTORE AND/OR REPAIR ANY OBJECT/ SITE CONDITIONS DAMAGED DURING CONSTRUCTION TO THE SATISFACTION OF THE OWNER.
7. LIMITS OF DISTURBANCE ALONG WOOD CHIP TRAIL (NOT SHOWN IN PLANS) ARE 2' EITHER SIDE OF TRAIL EXCEPT WHERE TREE REMOVAL REQUIRED.
8. CONTRACTOR TO PROVIDE "ADD ALTERNATE" FOR ENTIRE WOOD CHIP TRAIL TO BE STABILIZED STONE DUST PER DETAIL A, SHEET 4.
9. CONTRACTOR TO PROVIDE SHOP DRAWING OF BOARDWALK FOR REVIEW/APPROVAL BY THE CITY OF FAIRFAX.
10. CONTRACTOR TO PROVIDE "DEDUCT ALTERNATE" FOR SECTION OF WOOD CHIP TRAIL BETWEEN THE TWO WOOD BRIDGES, INCLUDING THE BRIDGES AND BOARDWALK. REMOVAL OF DEAD TREES AND UNDERBRUSH SHALL ALSO BE PART OF THIS ALTERNATE.

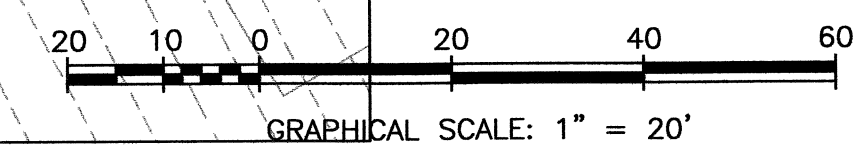

NO.	DESCRIPTION	REVIEW	APPROVED	DATE
REVISION APPROVED BY DIVISION OF DESIGN REVIEW				

REVISIONS

SURVEY	BY OTHERS
DESIGN	
DRAWN	
CHECKED	

William H. Gordon Associates, Inc.
 CIVIL ENGINEERING · SURVEY · LANDSCAPE ARCHITECTURE · LAND PLANNING · SITE SECURITY CONSULTING · GIS
 4501 Doby Drive · Chantilly, Virginia 20151
 (703) 263-1900 · METRO (703) 803-9506 · FAX (703) 263-0766

DATE: JANUARY 2013

SCALE: HORIZ: VERT: SEAL

ROBERT W. WALKER
 Lic. No. 37609
 1/21/13
 PROFESSIONAL ENGINEER

SITE PLAN

ASHBY POND TRAIL PROJECT
CITY OF FAIRFAX, VIRGINIA

JOB	3000-0101
CADD	2840_TRAIL
SHEET	2 OF 5

COPYRIGHT © 2007. NO REPRODUCTION OR USE OF THIS DRAWING IS ALLOWED IN PART OR IN WHOLE BY ANY PROCESS WITHOUT PRIOR WRITTEN AUTHORIZATION FROM WILLIAM H. GORDON ASSOCIATES, INC.